

N-Bolts M12

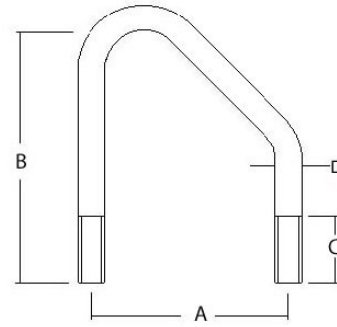

- Mild steel grade 43A to BS4360
- Supplied with 4 full nuts, 2 flat washers & 2 spring washers
- Finish spun galvanised

- Cut threads
- Material grade 303 – Nuts & washers A2
- All dimensions in millimetres

Part Number	A	B	C	D	Angle Size	Weight Kg
NB021	61	70	35	12	45 x 45	0.231
NB016	65	100	50	12	50 x 50	0.282
NB017	75	110	50	12	60 x 60	0.301
NB015	80	100	35	12	65 x 65	0.289
NB006	85	105	35	12	70 x 70	0.304
NB007	90	110	35	12	75 x 75	0.312
NB008	95	120	40	12	80 x 80	0.340
NB009	100	130	40	12	85 x 85	0.344
NB018	105	140	50	12	90 x 90	0.366
NB010	115	145	40	12	100 x 100	0.384
NB011	135	170	50	12	120 x 120	0.435
NB023	145	180	50	12	130 x 130	0.446
NB012	165	200	50	12	150 x 150	0.491
NB027	175	210	50	12	160 x 160	0.528
NB013	215	260	50	12	200 x 200	0.615
NB028	265	300	50	12	250 x 250	0.735
NB019	130	165	50	12	4 ½" x 4 ½"	0.420
NB020	142	177	50	12	5" x 5"	0.458
NB024	170	200	50	12	6" x 6"	0.503
NB025	218	255	50	12	8" x 8"	0.609