

EUROPEAN Veterinary Distributors 2010 - 2011



SPECIALIST LABORATORY EQUIPMENT • CRITICAL CARE PRODUCTS • DIAGNOSTIC KITS • LABORATORY CONSUMABLES • BIOCHEMISTRY REAGENTS

WOODLEY
EQUIPMENT COMPANY

WOODLEY EQUIPMENT COMPANY LTD

Supplying distribution partners with specialist laboratory equipment Woodley Equipment Company prides itself on being a market leading supplier of laboratory equipment, diagnostic and critical care products to the veterinary industry in the UK and Europe.

The company has an evolving portfolio of products with UK and European Distribution rights, along with a proven track record and outstanding customer loyalty in the form of repeat business and client referrals.

Features of our ranges include:

- Classic, tried and tested technology
- Reliability with low running costs and maximum flexibility
- Ease of use whilst maintaining accuracy.
- Value for money
- First class customer support
- Dedicated technical support specialists
- State of the art service department

Technical Support

We have a technical support department staffed with biomedical scientists who deliver proven high quality after-sales care to resolve your issues over the phone.

Woodley Equipment Company Limited was established in the UK in 1989 and operates from offices and warehouse premises in the North West of England as well as it's specialist Wet Chemistry division in the South East of England.

Woodley is an ISO 9001 : 2000 certified company, recognising the quality of administrative and management systems.

For further information about Woodley's extensive portfolio or to enquire about distributorship please email sales@woodleyequipment.com or call +44 (0)1204 669033.

“Woodley Equipment Company has a proven track record and outstanding customer loyalty”





epoc Portable Blood Gas, Electrolyte & Critical Care Analyser

A cost effective, state of the art point of care solution

The epoc, developed by the founder of the i-STAT®* analyser, is the first wireless point of care testing solution to use Smart Card technology. The epoc provides immediate blood gas, electrolyte and critical care biochemistry results directly to a hand-held PDA (included) and wirelessly interfaces to an electronic data manager (EDM) and Bluetooth printer. It is a completely affordable analyser that is easy to use and requires no refrigeration of consumables.

Key features:

- Accurate blood gas, electrolyte and critical care biochemistry results in 30 seconds
- Room temperature cartridge storage
- 100µl sample volume, eliminating overflow issues
- Wireless system that interfaces to an electronic data manager (EDM) and Bluetooth printer
- Does not require regular software updates
- Easy to use with touch screen technology
- Completely portable hand-held system with rechargeable battery
- Ready to use anytime, anywhere in-practice, theatre, client site or yard
- Integrated calibration and quality checks
- Bar-coded smart cards for error free identification
- 2000 patient results stored on analyser
- Ability to input all patient data, temperature and even ventilator settings
- Cartridge batch numbers automatically linked to patient results
- New parameters continually being developed



3 Simple Steps TO ACCURATE & IMMEDIATE RESULTS



Step 1



Step 2



Step 3



Lower System and Consumable Costs than other Leading Portable Clinical Care Analysers including the i-STAT® system*

* i-STAT® is a registered trade mark of Abbott Point of Care Inc



Veterinary Glucose Monitor



Making testing quick and easy with Biosensor auto code technology

- Animal validated 1.5µl blood sample
- 4 reminder alarms for worry free testing
- 8 second countdown
- 300 result memory with date and time
- Accurate results
- Large, easy to read, LCD screen
- Easy to use

- Hypoglycaemic and hyperglycaemic indicator alarms
- PC download option
- Ideal for clients needing to monitor blood glucose levels at home

Complete kit includes:

- Meter
- Test strips
- Control
- User guide
- Carry case
- Cat and dog code chip
- Lancet
- Lancet tips



The EDGE™ Handheld Lactate Analyser

The **EDGE™** Lactate Analyser is a handheld device that measures lactate concentration in blood.

The **EDGE™** only needs a small drop of blood (<3µl).

The test strips have a siphoning action which draws the blood in and then measures using an advanced biosensor specific for lactate concentration in blood. A numeric result is displayed via an easy to read, large LCD screen in less than 45 seconds with both date and time. The result is comparable to laboratory reference standard.

The **EDGE™** holds up to 300 results, each with date and time displayed. Users can transfer results on to a PC for in-depth analysis.

- Advance Biosensor Test Strips
- Low Blood Volume Required
- Fast Siphoning Action
- Fast Testing Time
- Large LCD Display
- Date and Time Stamped Memory
- Easy Operation
- Small Size
- PC Interface

The **EDGE™** Starter Kit contains:
 1 Meter Kit (meter, battery, monitor checker, 5 strips, code cards, 5 lancets, lancet device, user guide and kit bag)



Parasep® Faecal Filters

Fast and Accurate Worm Egg Counts

Developed in conjunction with leading veterinary institutions, and validated by the VLA (Veterinary Laboratories Agency). These filters offer an easy to use and much improved method of determining Worm Egg Counts (WEC) on Cattle, Sheep and Horses. They are single use devices for in-vitro use only.

Flotation methods for WEC can require several specific gravity solutions to cover different parasites. The two common flotation methods, 'Modified McMaster' and 'Improved Modified McMaster', both use Saturated NaCl and are both catered for with Veterinary Parasep.

Key advantages you will notice are:

Cleaner, safer method

- the enclosed filtration environment keeps user contact with harmful vapours and aerosols to a minimum.

No possibility of cross contamination

- being single use and disposable prevents any possibility of sample carryover.

More accurate and consistent results

- egg counts can be affected using traditional techniques, by unintentional inconsistent sample mixing.

No labourious, time consuming 'clean up' of sinks, shaker bottles and sieves - all the filtration mixing and shaking is performed inside the Veterinary Parasep tube.

Procedure

Step 1.

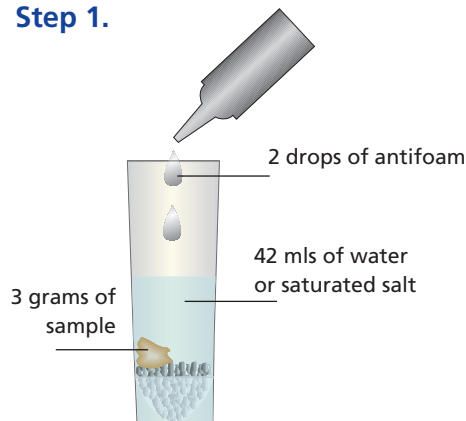

Step 2.

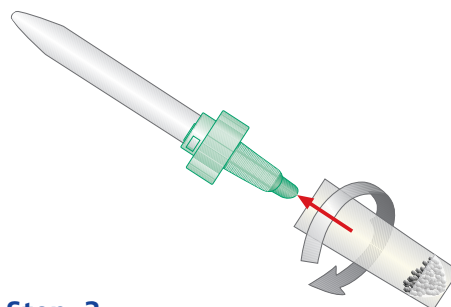

Step 3.

Improved Modified McMaster

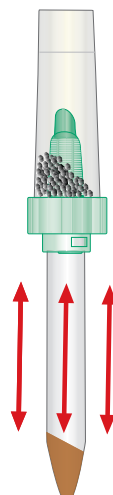

Validated by the Veterinary Laboratories Agency for repeatable and accurate Worm Egg Counts with Ovine, Bovine and Equine faecal samples.



Quantum Vet Diagnostics Wet Chemistry Solutions:

Quantum Vet Diagnostics (a division of Woodley Equipment) are the exclusive distributor in the UK & Europe of the Synermed® International Near-Infrared Diagnostic Reagents for use with wet chemistry analysers. These reagents avoid serious inaccuracies due to lipaemia, haemolysis and icterus and are supplied in liquid stable form - ready-to-use.

With over 130 wet chemistry customers, Quantum have a proven track record for outstanding service and support as well as state of the art wet chemistry solutions.

Quantum has its own in-house laboratory staffed with biomedical scientists and manufacturer trained service engineers to provide first class technical support.

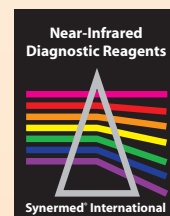



Benchtop Centrifuge Range

Horizon 642E

Unique horizontal rotor design allows for the test tubes to be inserted at a convenient 45 degree angle, they are then gently rotated to a full horizontal position as the motor accelerates.

Clinispin Micro

Designed for all routine blood and fluid separations, as well as the centrifugation of urine specimens.

Clinispin HCT

The Clinispin HCT is designed for rapid haematocrit separations in a compact, sturdy and inexpensive unit.



Vision Professional Microscopes

Each Vision model is chosen for its particular features to fill many microscopy needs in a variety of applications. Vision microscopes are equipped with precision DIN*optics (*Deutsche Industrie Normen, a recognised universal industry standard for microscope objectives). All microscopes are packed in fitted protective styrofoam and various upgraded accessories are available upon request.

Also available in the microscope range are accessories such as the microscope service kit.

Woodley offer a wide range of low cost camera attachments to compliment their microscope range.

Woodley Endoscope Range

The Vetscope II endoscope offers cutting edge fibreoptic technology at a fraction of the cost of conventional endoscopes. This scope uses plastic fibres, rather than glass. The VetScope II is more affordable, more durable and provides incredibly good optics. Also available in the endoscope range is the Flexible Microfibrescope with built in illumination handle. Available in 25cm x 1.40mm or 50cm x 1.40mm



RapidVet®-H Blood Typing Kits For good transfusion practice

These fast in-house blood typing and crossmatch kits are essential for transfusion and breeding decisions. They are easy to use, economical and can be stored at room temperature.

For Canine DEA 1.1

Rapid Vet H offers an in-house blood typing card test for canine DEA 1.1+ and DEA 1.1- blood types.

For Feline A, B, & AB.

An in-house blood typing card test for feline A, B, & AB blood types.

RapidVet®-H CrossMatch Kits

- The test is performed in-practice in 10 minutes
- The test is easy and the results are clear
- Simple to use and quick to run
- Part of the RapidVet®-H range
- Use Crossmatch along with the Canine & Feline blood typing kits
- Will detect all major canine and feline blood group incompatibilities
- Available in kits of 3 tests
- Room temperature storage



RapidVet-D Blue

Rapid Dermatophyte testing for dogs, cats, rabbits and horses. A simple 72 hour, room temperature incubation, in-practice test to detect the presence of veterinary dermatophytes in companion animals.