



Time Electronics
Calibration, Test and Measurement

CalBench

Power Supply Modules
Short Form



Power Supply Modules

Fixed and adjustable AC and DC power modules

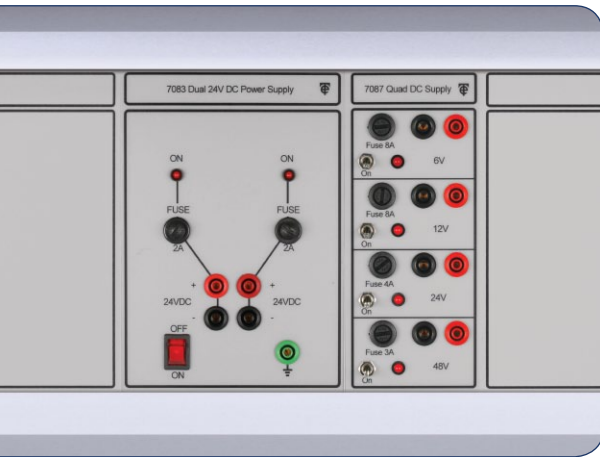

7083 and 7087 Fixed DC Power Supplies

Fixed DC power supplies suitable for powering loop signal instrumentation.

7083 – 2 independent 24V (2A) floating supplies

- 4mm shrouded output sockets
- Ripple: Typically 240mV
- Regulation: Typically 2%
- Over-volt and current overload protection

7087 – 4 fixed independent floating supplies: 6V (8A), 12V (8A), 24V (4A), 48V (3A)

- 4mm shrouded output sockets
- Ripple and Noise: 50mV or 1% pk-pk, whichever is greater
- Over-volt and current overload protection
- Supplies can be connected in series to obtain an alternative output voltage



7075 Fixed 110V DC Power Module

The 7075 provides an isolated DC supply. Output is pre-specified between 96 and 144 volts with a current capacity up to 7.5 amps. Output voltage and current are monitored on two analogue moving coil meters, access is from two 4mm shrouded sockets.

- 96V to 144V preset single fixed output
- Output Current 7.5A max (limit to 800 watts)
- 4mm shrouded output sockets
- Line regulation: $\pm 0.1\%$
- Load regulation: $\pm 0.5\%$
- Output accuracy: $\pm 1.5\%$ of reading
- Output ripple (> 50Hz): < 50mV rms
- Hold up time: > 5mS

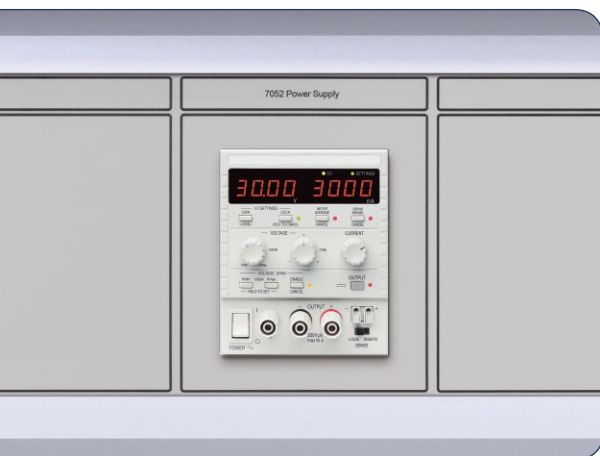

7052 Adjustable DC Power Supply

A high performance linear regulated DC power supply with true analog controls and digital functionality.

- 0 to 30V, 0.1mA to 3A (90W maximum)
- High accuracy four digit meters have a fixed resolution for consistent readings
- Low current range gives 0.1mA meter resolution and finer low current setting
- S-Lock function - instantly lock settings
- V-Span function - customise the voltage range
- Independent, isolated tracking, ratio tracking
- DC output switches and "view limits" button
- Safety binding post terminals
- Programmable version available (USB or RS-232) - 7052P

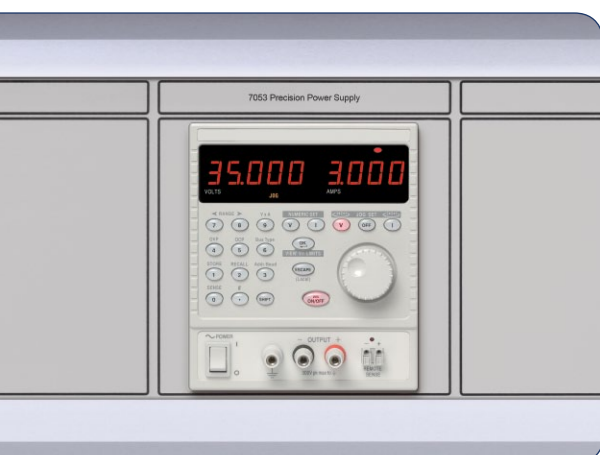

7053 Precision Adjustable DC Power Supply

A DC linear power supply with high accuracy, resolution, stability and noise. Multiple output ranges provide increased current capability at lower voltages. An advanced user interface gives superior control, combining speed with safety.

- Single Output, 3 ranges: 0 to 56V, 0 to 2A. 0 to 25V, 0 to 4A. 0 to 56V, 0 to 500mA
- 112W maximum output power
- 1mV setting resolution at all output voltages
- Setting by direct numeric entry or spin wheel
- Multiple non-volatile setting memories with preview
- OVP and OCP trips with alarm output
- Selectable remote sense terminals
- Programmable version available (USB, RS-232 or GPIB) - 7053P



7054 and 7055 High Voltage Adjustable DC Supplies

Precision linear regulated DC power supplies with high power density and smart analog controls for voltages up to 120V or 250V.

- 7054: 0 to 120V / 0.01mA to 750mA (90W maximum)
- 7055: 0 to 250V / 0.01mA to 375mA (94W maximum)
- High accuracy four digit meters have a fixed resolution for consistent readings
- Low current range gives 0.1mA meter resolution and finer low current setting
- S-Lock function - instantly lock settings
- V-Span function - customise the voltage range
- Isolated analog remote control of voltage and current
- Low current range and current meter averaging
- Programmable version available (USB or RS-232) - 7054P and 7055P



7056 Dual Adjustable DC Power Supply

A quad-mode dual output power supply with two identical outputs as per the 7052, with tracking and parallel modes.

- Dual outputs of 0 to 30V, 0.1mA to 3A (90W maximum)
- Single output of 0 to 30V, 0.2mA to 6A (180W maximum)
- 4 modes: Independent, isolated tracking, isolated ratio tracking, & true parallel
- In parallel mode power is channelled to the Master output for supply up to 6A
- In tracking mode the outputs can be wired in series to generate 0 to 60V
- High accuracy four digit meters have a fixed resolution for consistent readings
- Low current range gives 0.1mA meter resolution and finer low current setting
- Safety binding post terminals
- Programmable version available (USB or RS-232) - 7056P



7088 Adjustable AC Power Supply

The 7088 provides variable 50Hz AC power up to 10A. Two meters monitor the output voltage and current which is available from the front panel socket.

- Variable output voltage from 0 to 110% above line input
- 0 to 265V 50Hz, 10A at 240V input
- 0 to 121V 50Hz, 10A at 110V input
- Simple front panel analogue deviation control
- 0 to 10A output current
- Input fuse 10A slow blow
- Output circuit breaker: 10A (medium response time)
- AC moving iron meters to standard DIN specification
- Various socket types: UK 13A, Euro Schuko 16A, Indian Round Pin 15A, US 15A



Additional Power Modules

Further AC and DC power modules can be fitted in the bench consoles. These include fixed AC supplies, variable AC/DC supplies, 3 phase controllers, and custom fitted modules for specific user requirements.

- 7076 – 110V Fixed 8A AC Module (shown)
- 7043 – 3 phase mains controller module (shown)
- 7086 – 60V DC 3A Adjustable Power Supply (also see 7053)
- 7046 – Variable AC/DC Power Supply. AC 500VA, DC 400W, Freq 40 - 500Hz
- 7047 – Variable AC/DC Power Supply. AC 1000VA, DC 800W, Freq 40 - 500Hz
- 9758B – DC Electronic Load, 80A, 80V, 300W (see page 23)
- 7063 – Isolated mains output sockets for 7082 mains power module
- Customer specified power modules (supplies, sockets, controllers etc)

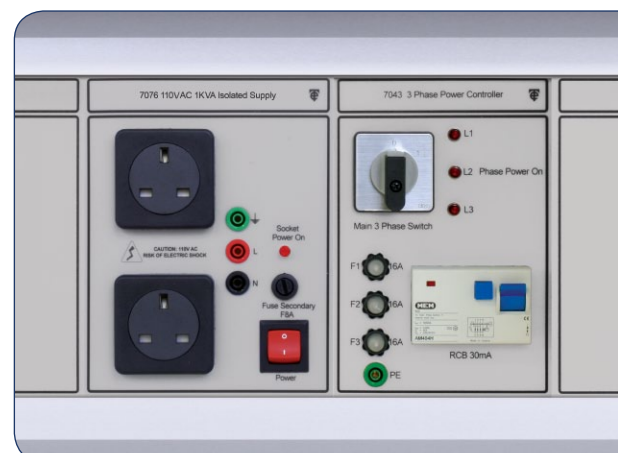



CalBench

Power Supply Modules

Code	Description	Module Width
7082	Mains Power Controller (fitted as standard, socket type to be selected)	270mm
- 7063	Isolated mains output sockets for 7082 Mains Power Module	
7075	110V Fixed 7.5A DC Module with 2 shrouded 4mm safety sockets	160mm
7076	110V Fixed 10A AC Module	150mm
7043	3 phase mains controller Module	150mm
7083	Dual 24V DC Power Supply – 2 x 24v (2A)	131mm
7087	Quad DC Power Supply – 6V(8A), 12V(8A), 24V(4A), 48V(3A)	80mm
7052	30V DC 3A Adjustable Power Supply – Digital (programmable version 7052P)	150mm
7053	56V DC 4A Adjustable Power Supply – Digital (programmable version 7053P)	200mm
7086	60V DC 3A Adjustable Power Supply – Digital	168mm
7054	120V DC 750mA Adjustable Power Supply (programmable version 7054P)	150mm
7055	250V DC 375mA Adjustable Power Supply (programmable version 7055P)	150mm
7056	Dual Adjustable Power Supply, 2 x 30V DC 3A – Digital (programmable version 7056P)	295mm
7088	Adjustable AC Supply 0 – 270V/10A (or 110% above line voltage)	350mm
7046	Variable AC/DC Power Supply. AC 500VA, DC 400W, Frequency 40 – 500Hz	295mm
7047	Variable AC/DC Power Supply. AC 1000VA, DC 800W, Frequency 40 – 500Hz	500mm



Time Electronics

Calibration, Test and Measurement

Time Electronics Ltd., Unit 11 Sovereign Way,
Botany Industrial Estate, Tonbridge, Kent, TN9 1RH. United Kingdom.

T: +44 (0) 1732 355993 F: +44 (0) 1732 770312 E: mail@timeelectronics.co.uk

www.timeelectronics.com