

## The highlifter - quality at working height

The highlifter can transport and lift a pallet to the right ergonomic working height, and is very gentle to surroundings, pallets and goods. The highlifter has an elegant design with rounded corners.

The design prevents industrial injuries and strain on the user - focus is put on safety and ergonomic working conditions of the user. As an example, the ergonomically correct shape of the handle ensures a relaxed hold for the user.

High quality is ensured through an extended test programme and in cooperation with experts in Health and Safety.



### Technical Specifications

Loads of 1,500 kg can be transported and lifted up to 400 mm with the high-lifter. From 400 mm the lifting capacity is 1,000 kg.

Optimum user-friendliness

- low own weight
- central location of all control buttons
- ergonomic handle

Long operating life and low maintenance costs

- reliable cylinder construction
- strong construction
- use of quality materials

Optimum stability

- low overall height
- fork length of 1200 mm
- supporting feet at steering wheel
- tandem wheels on scissors legs



The tandem wheels have a brake effect and are not hostile to the floor.



Ergonomic handle ensures the user a relaxed hold.



Level control (optional extra) ensures a constant working height.



Very low power for the pump function, foot protection and neutral position are important features of HL 1005.



Optional extras: remote control, level control, brake, separate or built-in charger.

Product (measured in mm)	HL 1005						EHL 1004					
	1500*						1500*					
Capacity in kg	1500*						1500*					
Lifting height $h_3$	500	600	800	800	800	800	500	600	800	800	800	800
Fork length $l$	700	900	1200	1520	2000	2000	700	900	1200	1520	2000	2000
Overall height $h_1$	540						540					
Fork span $b_5$	480, 540, 680			540, 680			480, 540, 680			540, 680		
Length without forks $l_2$	356						451					
Overall length $l_1$	1056	1256	1556	1876	2356		1151	1351	1651	1971	2451	
Overall height with handle $h_4$	1225						1195					
Lowered height $h_{13}$	85		90		110		85		90		110	
Fork width $e$	163						163					
Turning angle of the wheels	230°						180°					
Gangway $A_{st}$	1830 (pallet: 1200 x 800)						1890 (pallet: 1200 x 800)					
Lifting speed with/without load							0,05/0,08 m/s					
Lifting speed normal/quick	10/35 mm per pump											
Lowering speed	Without load 0,093 m/s						With/without load: 0,07/0,05 m/s					
Pump motor							0,9 kW 12 V					
Weight with 1200 mm forks (no battery)	97 kg						104 kg					

\* The capacity changes from 1500 to 1000 kg at the lifting height 400 mm.

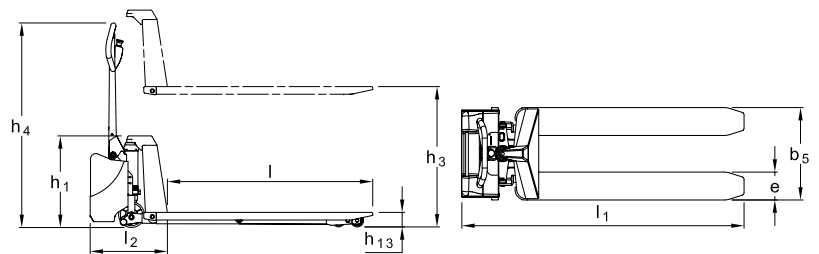

Can be marked with name/department.



Available as manual, electric, stainless and explosion proof.



Patented cylinder construction gives low overall height.

*We also offer tailor-made solutions.  
Please ask for further information or visit our website*