

REGMATIC

5/2 Way Namur Mount Solenoid Valve Series 20

Figure No	Voltage
20024AC	24 V AC
20110AC	110 V AC
20220AC	220 V AC
20024DC	24VDC
20048DC	48 V DC
20110DC	110 V DC

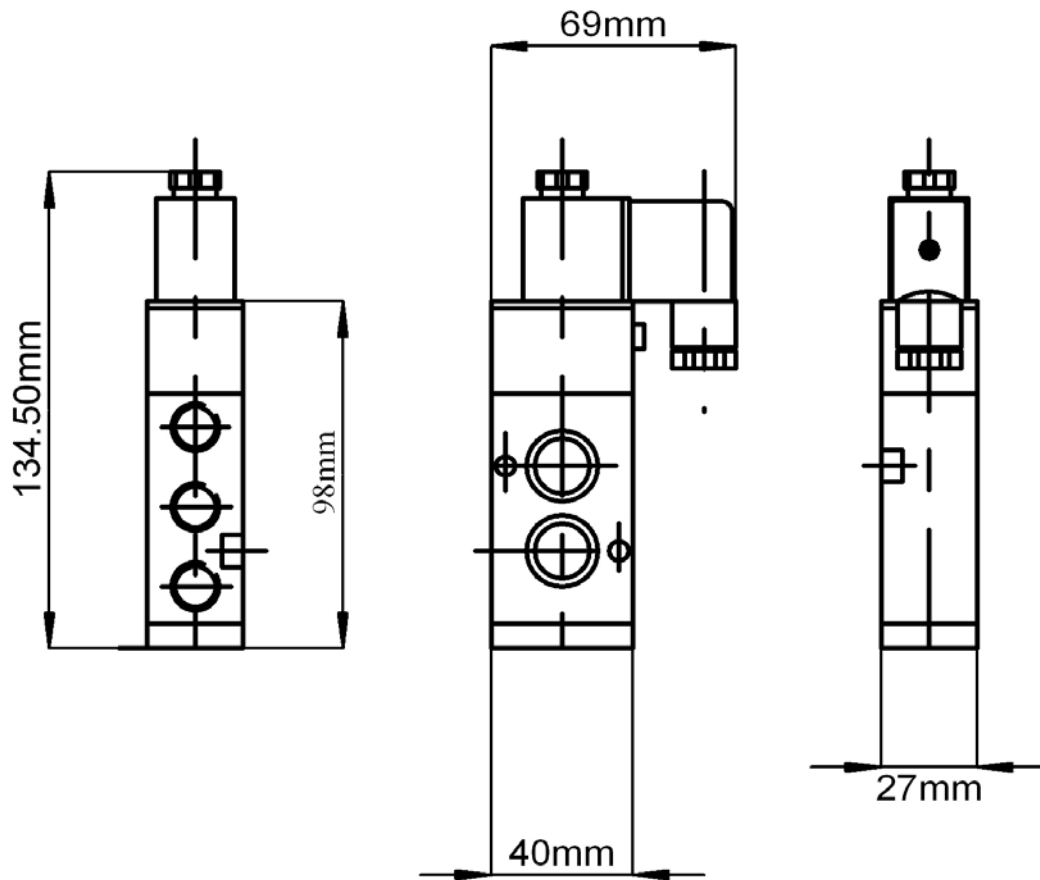

Technical data:

Protection class IP 65
 Relative duty cycle 100 %
 Voltage tolerance +/-10 %

Working pressure 1.5-8Bar
 Area/ Flow coefficient 14 mm², cv = 0.78
 Power consumption AC = 5.5 VA, DC = 4.8 W

Approvals by ATEX, CSA and UL

Can also be supplied with coils for EEx ia 11 T6 and T4 and
 EEx m 11 T4



Unit 27 Upper Mills Est , Bristol Road
 Stonehouse . GLOS . GL10 2BJ . UK
 Tel. 01453 821666 Fax 01453 822298
 www.cee-vee.co.uk sales@cee-vee.co.uk