



Clay plain tiles

Clay plain tiles have been used to cover roofs in Britain for around eight hundred years, becoming dominant in the nineteenth century.

Clay heritage

They form much of the character of the roofs seen in the South East of England and the Midlands, where the largest deposits of suitable clay are located.

Clay tiles are popular as a roof covering because of their extreme versatility; almost any detail can be reliably formed by a skilled craftsman using a good plain tile.

Contents

- 4-7 Acme single camber
- 8-11 Hawkins
- 12-15 Acme double camber
- 16-19 Ashdowne
- 20 Clay interlocking tiles
- 21 Ventilation & dry fix systems
- 22-23 Fittings & accessories
- 24-27 Design details

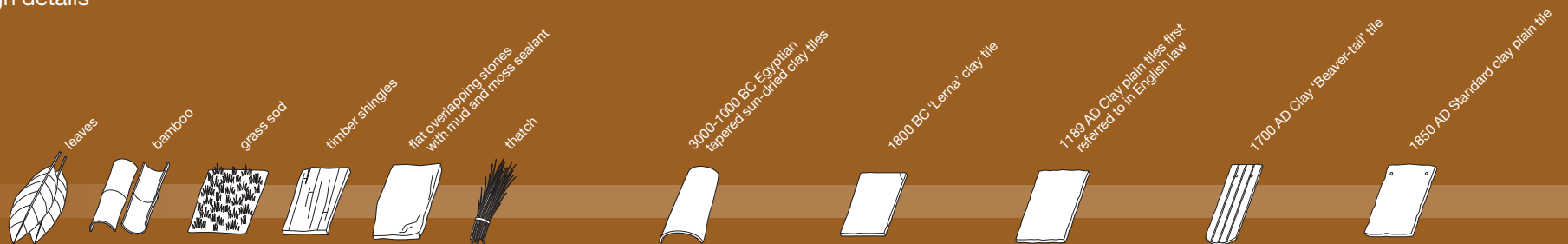



Marley Eternit is the UK's leading manufacturer of clay plain tiles and fittings, which are ideal for roofing or vertical hanging on both new and refurbishment projects.

Marley Eternit's clay plain tiles have **excellent environmental credentials** and can achieve an **A+ rating*** in the Building Research Establishment's (BRE) Green Guide to Specification.

Clay innovation

Our extensive range contains colour, texture and camber options which meet the aesthetic and performance demands of all types of roofing applications, with dry fix and ventilation systems allowing rapid, weathertight installation and compliance with Building Regulations.

All products are **made from the highest quality Etruria Marl**. This naturally occurring material is generally accepted as the finest clay for strength and durability.

Advances in our clay technology means **beautiful clay roofs are now more affordable than ever**, making them a real option for any roofing project.

Our **kite marked manufacturing plant** with its state-of-the-art handling, processing and firing systems, ensures that this beautiful, natural product is enhanced by the very latest technology.

* based on generic rating for UK produced clay plain tiles - (Element Ref: 812410006)

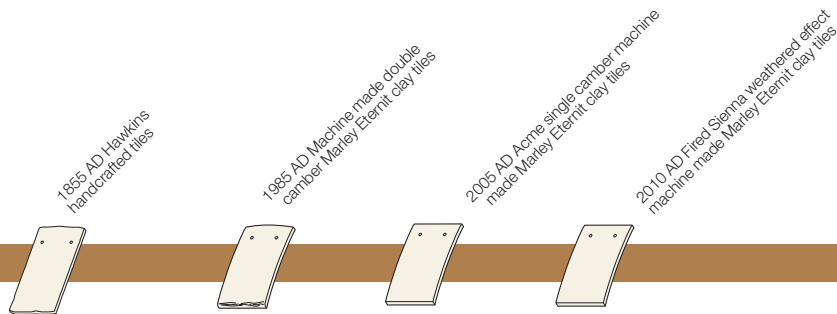

EMS 180608

BS EN 1304



Acme single camber



**For roof pitches
down to 30°**

The Acme single camber clay plain tile allows the creation of contemporary low pitch roof designs with the warmth and character of clay.

This affordable option is ideal for social housing projects and also suited to refurbishment and new build projects alike.

Combined with a comprehensive range of fittings and accessories allows far-reaching design scope, always underpinned by the natural and ever-improving beauty of a natural clay tile roof.

A+ Marley Eternit's clay plain tiles have excellent environmental credentials and can achieve an A+ rating* in the Building Research Establishment's (BRE) Green Guide to Specification.

* based on generic rating for UK produced clay plain tiles - (Element Ref: 812410006)

Acme single camber Grey Sandfaced



Acme single camber Red Smooth

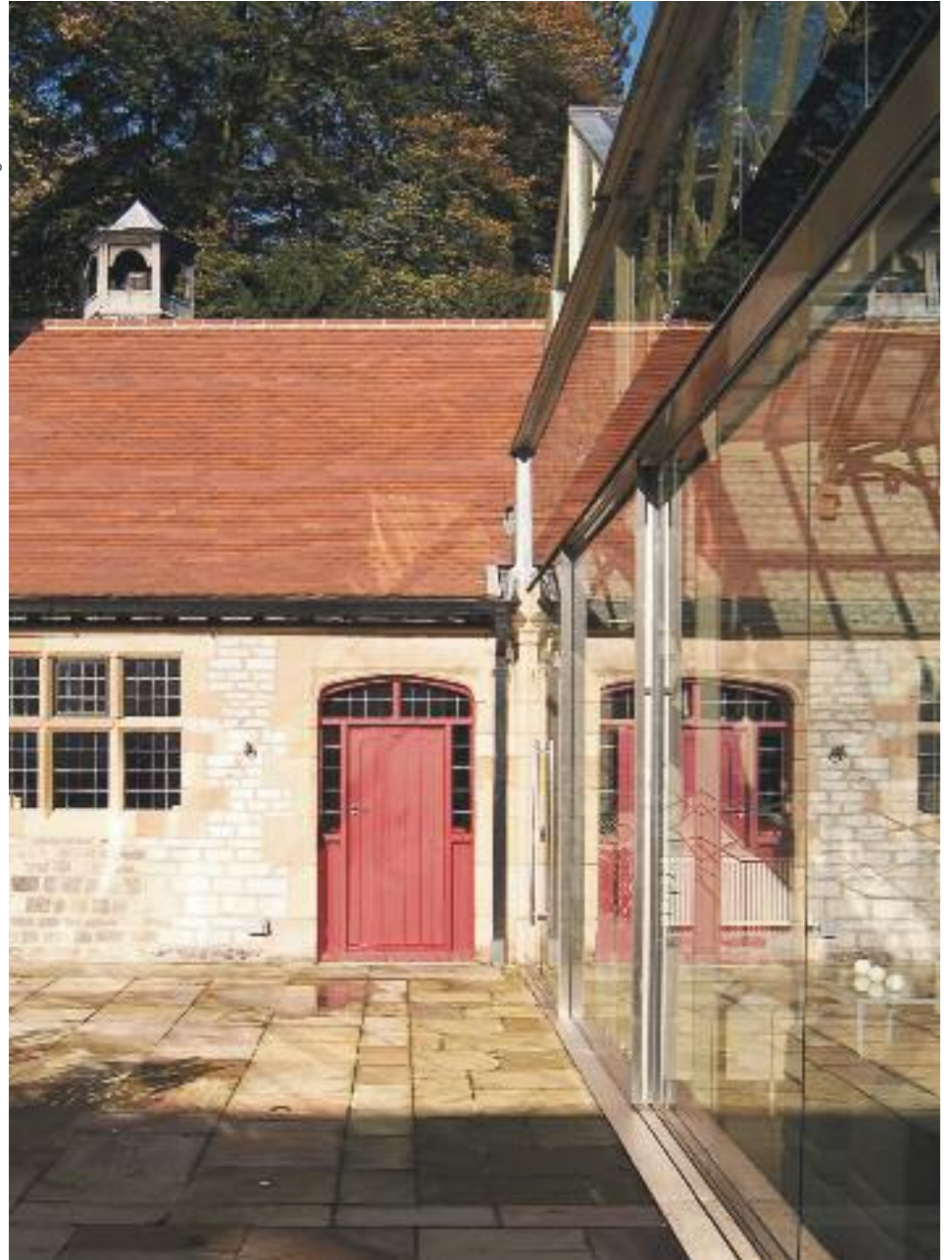

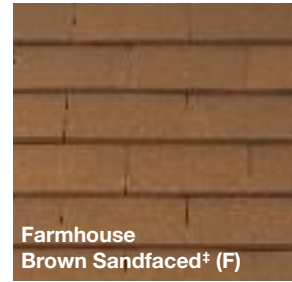
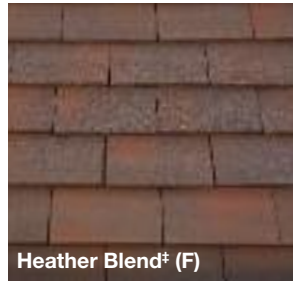
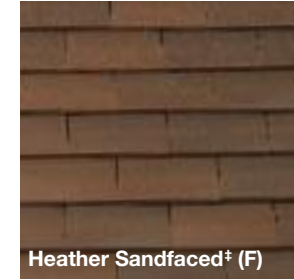
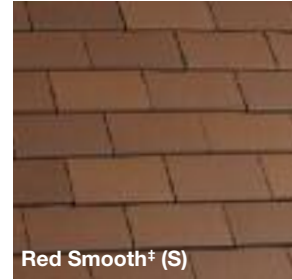

Key (F) Fine Sanded finish (S) Smooth finish

Acme single camber single camber



**For roof pitches
down to 30°**

Technical data

Size of tile	265mm x 165mm	
Minimum pitch*	30°	
Maximum pitch	90°	
Minimum headlap	65mm (roof)	37.5mm (vertical)
Maximum gauge	100mm (roof)	115mm (vertical)
Cover width	165mm (nominal)	
Covering capacity (net)	60 tiles/m ² at 100mm gauge (roof) 53 tiles/m ² at 115mm gauge (vertical)	
Weight of tiling (approx.)	64kg/m ² (0.63 kN/m ²) at 100mm gauge (roof) 56kg/m ² (0.55 kN/m ²) at 115mm gauge (vertical)	
Battens required (net)	10.0 lin.m/m ² at 100mm gauge (roof) 8.7 lin.m/m ² at 115mm gauge (vertical)	
Batten size recommended	38 x 25mm for rafters/supports not exceeding 600mm centres (fixed to BS 5534)	
Tile nails	38mm x 2.65mm	

* The minimum recommended pitch and lap may be influenced by special circumstances, please refer to the Technical Advisory Service.

‡ The body colour of Acme smooth clay plain tiles is red/brown with minor tonal variations which result from the natural clay material. Acme sandfaced clay plain tiles are surfaced with selected sand before firing.



→ More information and samples

web www.marleyeternit.co.uk/samples

advice Tel 01283 722588

E-mail info@marleyeternit.co.uk

→ Fittings

pages 20-23

Tel 01283 722588

Feature tiles

Available in a range of colours and shapes.

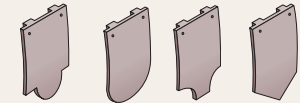

For advice on the use of feature tiles in main roof areas, contact the Technical Advisory Service.

Club

Bullnose

Fishtail†

Hexagonal†

† Made to order (subject to minimum order quantities)

Hawkins Dark Heather



Hawkins Fired Sienna



Hawkins



**For roof pitches
down to 30°**

The name 'Hawkins' carries with it a heritage of 150 years manufacture and installation.

Its unique range of five affordable colours have been specially designed to match the prevailing roof colours throughout the Midlands and the range is specified widely for private housing within the area.

A+ Marley Eternit's clay plain tiles have excellent environmental credentials and can achieve an A+ rating* in the Building Research Establishment's (BRE) Green Guide to Specification.

Fired Sienna finish

Irregularities and imperfections in this new surface finish achieve the appearance of a weathered reclaimed tile with all the benefits of a precision-engineered clay tile.

* based on generic rating for UK produced clay plain tiles - (Element Ref: 812410006)



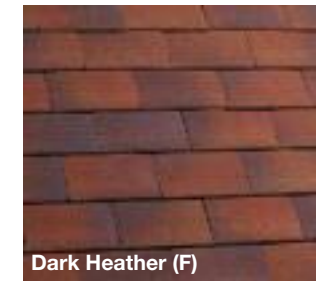
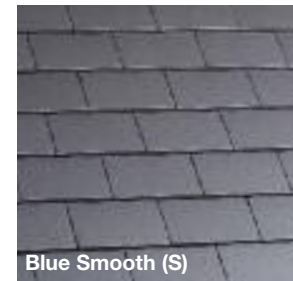
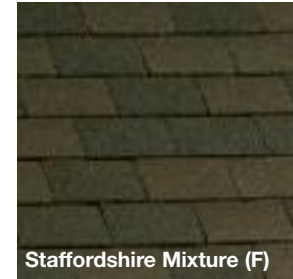
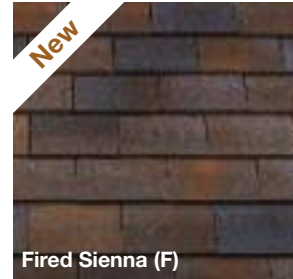

Key (F) Fine Sanded finish (S) Smooth finish

Hawkins



**For roof pitches
down to 30°**

Technical data

Size of tile	265mm x 165mm	
Minimum pitch*	30°	
Maximum pitch	90°	
Minimum headlap	65mm (roof)	37.5mm (vertical)
Maximum gauge	100mm (roof)	115mm (vertical)
Cover width	165mm (nominal)	
Covering capacity (net)	60 tiles/m ² at 100mm gauge (roof) 53 tiles/m ² at 115mm gauge (vertical)	
Weight of tiling (approx.)	64kg/m ² (0.63 kN/m ²) at 100mm gauge (roof) 56kg/m ² (0.55 kN/m ²) at 115mm gauge (vertical)	
Battens required (net)	10.0 lin.m/m ² at 100mm gauge (roof) 8.7 lin.m/m ² at 115mm gauge (vertical)	
Batten size recommended	38 x 25mm for rafters/supports not exceeding 600mm centres (fixed to BS 5534)	
Tile nails	38mm x 2.65mm	

* The minimum recommended pitch and lap may be influenced by special circumstances, please refer to the Technical Advisory Service.

→ More information and samples

web www.marleyeternit.co.uk/samples
advice Tel 01283 722588
E-mail info@marleyeternit.co.uk

→ Fittings

pages 20-23
Tel 01283 722588

Feature tiles

Available in a range of colours and shapes.

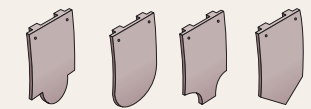

For advice on the use of feature tiles in main roof areas, contact the Technical Advisory Service.

† Made to order (subject to minimum order quantities)



Acme double camber Dark Brindle



Acme double camber Antique



Acme double camber



Acme double camber clay plain tiles have both a longitudinal and latitudinal camber able to create highly textured roofscapes with accentuated light and shade.

The tiles' distinctive colour range (including brindle colours) adds character to buildings of every sector.



Marley Eternit's clay plain tiles have excellent environmental credentials and can achieve an A+ rating* in the Building Research Establishment's (BRE) Green Guide to Specification.

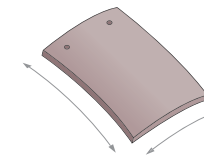

Double camber tile

* based on generic rating for UK produced clay plain tiles - (Element Ref: 812410006)



Acme double camber Antique



Acme double camber Smooth Brindle

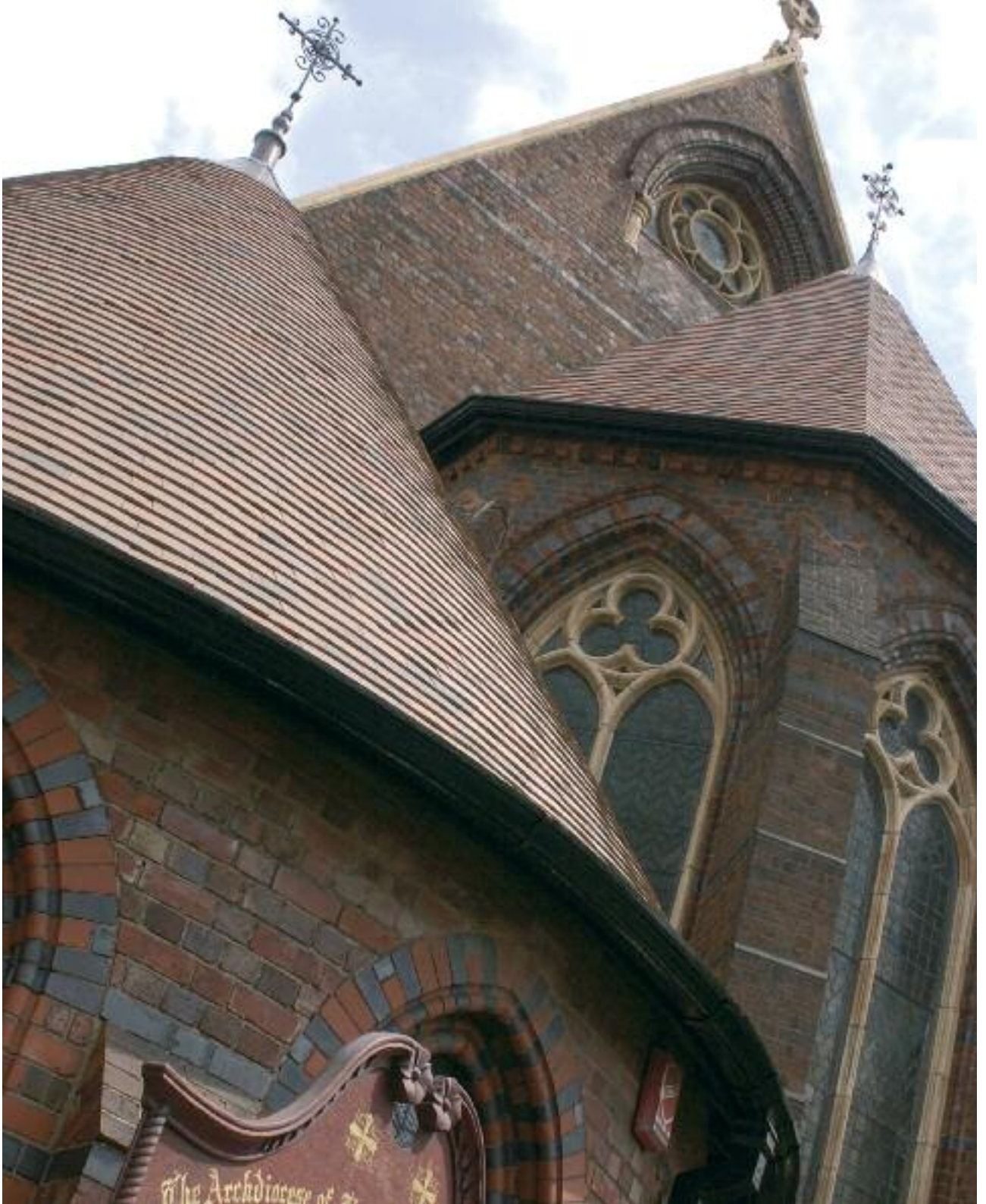

Acme double camber





Burnt Flame[‡] (S)



Dark Brindle[‡] (S)

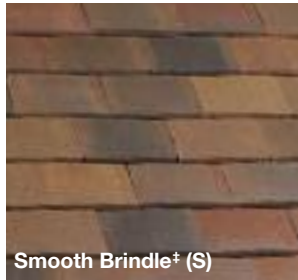

Smooth Brindle[‡] (S)



Antique[‡] (S)

Key (F) Fine Sanded finish (S) Smooth finish

Technical data

Size of tile	265mm x 165mm	
Minimum pitch*	35°	
Maximum pitch	90°	
Minimum headlap	65mm (roof)	37.5mm (vertical)
Maximum gauge	100mm (roof)	115mm (vertical)
Cover width	165mm (nominal)	
Covering capacity (net)	60 tiles/m ² at 100mm gauge (roof) 53 tiles/m ² at 115mm gauge (vertical)	
Weight of tiling (approx.)	64kg/m ² (0.63 kN/m ²) at 100mm gauge (roof) 56kg/m ² (0.55 kN/m ²) at 115mm gauge (vertical)	
Battens required (net)	10.0 lin.m/m ² at 100mm gauge (roof) 8.7 lin.m/m ² at 115mm gauge (vertical)	
Batten size recommended	38 x 25mm for rafters/supports not exceeding 600mm centres (fixed to BS 5534)	
Tile nails	38mm x 2.65mm	

* The minimum recommended pitch and lap may be influenced by special circumstances, please refer to the Technical Advisory Service.

‡ The body colour of Acme smooth clay plain tiles is red/brown with minor tonal variations which result from the natural clay material. In the case of brindle tiles, controlled variation of the kiln atmosphere during firing is used to produce a blend of natural fired colours. Acme sandfaced clay plain tiles are surfaced with selected sand before firing.



Acme double camber Smooth Brindle

→ More information and samples

web www.marleyeternit.co.uk/samples

advice Tel 01283 722588

E-mail info@marleyeternit.co.uk

→ Fittings

pages 20-23

Tel 01283 722588

Feature tiles

Available in a range of colours and shapes.

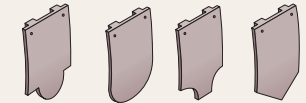

Club

Bullnose

Fishtail†

Hexagonal†

For advice on the use of feature tiles in main roof areas, contact the Technical Advisory Service.

† Made to order (subject to minimum order quantities)



Ashdowne



Ashdowne handcrafted clay plain tiles offer a warm, mellow appearance, with a granular texture and slight random irregularities that make each tile unique.

These unique, traditional tiles – complemented by traditional roofing skills – are the perfect choice for bringing character and warmth to both refurbishment and new build projects.



Marley Eternit's clay plain tiles have excellent environmental credentials and can achieve an A+ rating* in the Building Research Establishment's (BRE) Green Guide to Specification.

* based on generic rating for UK produced clay plain tiles - (Element Ref: 812410006)

Ashdowne Ashurst



Ashdowne Aylesham and Aylesham Mix



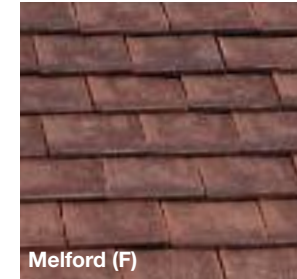

Melford (F)



Ashurst (F)

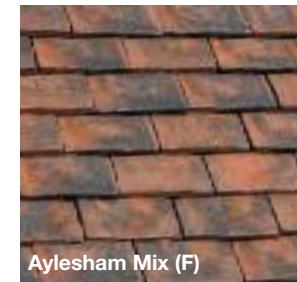

Aylesham Mix (F)

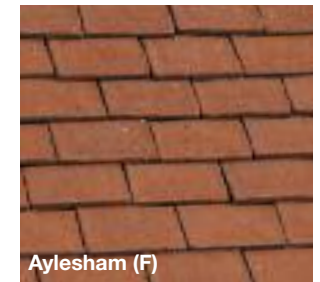

Aylesham (F)

Key (F) Fine Sanded finish

Ashdowne



Technical data

Size of tile	265mm x 165mm	
Minimum pitch*	35°	
Maximum pitch	90°	
Minimum headlap	65mm (roof)	37.5mm (vertical)
Maximum gauge	100mm (roof)	115mm (vertical)
Cover width	165mm (nominal)	
Covering capacity (net)	60 tiles/m ² at 100mm gauge (roof) 53 tiles/m ² at 115mm gauge (vertical)	
Weight of tiling (approx.)	75kg/m ² (0.74 kN/m ²) at 100mm gauge (roof) 66kg/m ² (0.65 kN/m ²) at 115mm gauge (vertical)	
Battens required (net)	10.0 lin.m/m ² at 100mm gauge (roof) 8.7 lin.m/m ² at 115mm gauge (vertical)	
Batten size recommended	38 x 25mm for rafters/supports not exceeding 600mm centres (fixed to BS 5534)	
Tile nails	38mm x 2.65mm	

* The minimum recommended pitch and lap may be influenced by special circumstances, please refer to the Technical Advisory Service.

→ More information and samples

web www.marleyeternit.co.uk/samples

advice Tel 01283 722588

E-mail info@marleyeternit.co.uk

→ Fittings

pages 20-23

Tel 01283 722588

Feature tiles

Available in a range of colours and shapes.

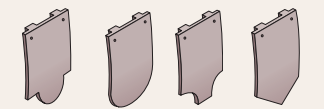

For advice on the use of feature tiles in main roof areas, contact the Technical Advisory Service.

† Made to order (subject to minimum order quantities)



Clay interlocking tile range

In addition to clay plain tiles, Marley Eternit's clay product portfolio includes a range of clay interlocking tiles.

→ For more information on the clay interlocking tiles range

Tel 01283 722588
E-mail info@marleyeternit.co.uk
web www.marleyeternit.co.uk/samples
literature 'Clay interlocking tiles'

Sandringham Burnished Red



Sandringham clay interlocking tile

- ✓ Precision engineered to ensure perfect edges and exact fittings.
- ✓ For use in new build and renovation roofing projects.
- ✓ The tile has a variable gauge of 20mm in the cover length and 6mm in the cover width. Irregularities in the construction of the roof can be effortlessly accommodated.



Domino Grey



Domino clay interlocking tile

- ✓ Highly engineered, high performing yet simple and rapid to install and fix.
- ✓ Perfectly flat and laid to broken bond giving a crisp, contemporary appearance of a small format flat tile.
- ✓ The tile has a variable gauge of 11mm in the cover length and 3mm in the cover width for greater flexibility.



Ventilation & dry fix systems

The components shown are dedicated clay plain tile ventilation components. The following Marley Eternit systems can also be used:

- **UNIVERSAL** 10mm eaves vent system
- **UNIVERSAL** 25mm eaves vent system
- **UNIVERSAL** RidgeFast system[§]
- **UNIVERSAL** HipFast system[§]

§ subject to ridge/hip tile angle

Clay ridge ventilators

Available in a range of colours and angles. Clay ridge ventilators provide a net ventilation area of 10,000mm²/m per vent. They should be installed at 2 metre centres to achieve a ventilation area of 5,000mm²/m at the ridge. Suitable for natural, mechanical or soil pipe ventilation.

* Made to order (subject to minimum order quantities)

‡ Red Smooth only

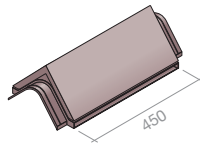

Plain angle ridge vent*

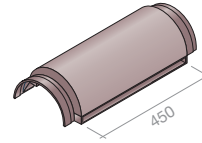

Half round ridge vent*

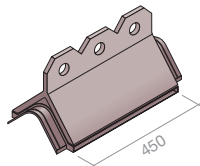

Decorative ridge vent**

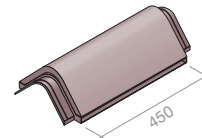

Hogs back ridge vent*

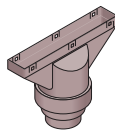

Ridge vent pipe adaptor

In-line clay tile vent

Available in a range of bases with real clay tile slips on the visible edge (3 tiles wide) to match tile colours. The clay tile vent provides a net ventilation area of 7,500mm² per vent. It should be installed at 1.5m centres to achieve a ventilation area of 5,000mm²/m at high level or at 0.75m centres to achieve a ventilation area of 10,000mm²/m at low level. Suitable for natural, mechanical or soil pipe ventilation.

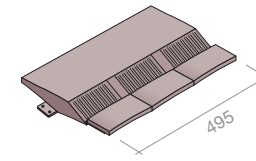

In-line clay tile vent

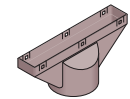

In-line tile vent adaptor

UNIVERSAL Plain tile contour vent

Ventilation area of 10,000mm² (high impact resistant PVC in Terracotta, Grey, Brown, Clay Brown and Clay Red).

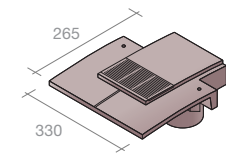

Plain tile contour vent

→ More

literature 'Ventilation and dry fix roofing systems'
Tel 01283 722588

web www.marleyeternit.co.uk/samples

advice Tel 01283 722588
E-mail info@marleyeternit.co.uk

Fittings & accessories

Acme single camber Grey Sandfaced



Ridges, hips and valleys

Available in a range of colours and angles. Security fixing is available for all ridges.
For details of the full range of hips and valleys, please contact the Technical Advisory Service.

* Made to order (subject to minimum order quantities) † Angle ridge wing length will vary depending on ridge angle
‡ Other angles made to order (subject to minimum order quantities) § For use at 30° please contact the Technical Advisory Service
** Red Smooth only

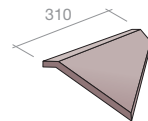

Arris hip ‡§
30-45° pitch
130-145° angles

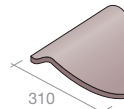

Granny bonnet hip
40-60° pitch

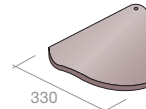

Semi-bonnet hip §
30-40° pitch

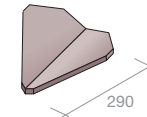

Valley ‡
30-50° pitch
130-150° angles

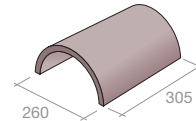

Half round ridge §
30-50° pitch

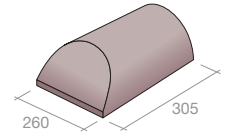

Half round ridge hip end*
30-50° pitch

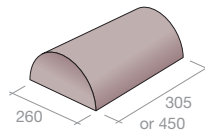

Half round ridge stop end*
30-50° pitch

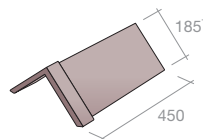

Capped angular ridge
30-50° pitch
75-135° angles

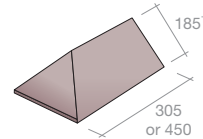

Angular ridge hip end*
30-50° pitch
All angles made to order

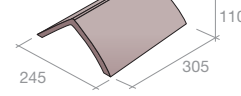

Hogs back ridge
30-45° pitch

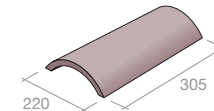

Third round hip
30-45° pitch

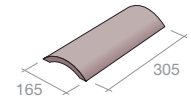

Baby ridge*
30-45° pitch

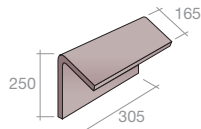

Mono ridge*
30-45° pitch

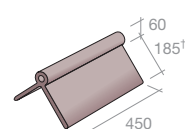

Plain roll top

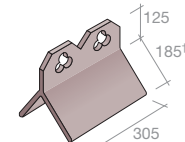

Club crested ridge ‡

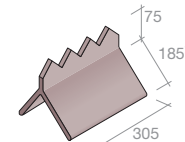

Cocks comb crested ridge ‡

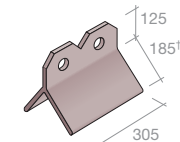

Two hole crested ridge ‡

Hawkins Staffordshire Mixture



Important note: All of the above fittings can be use with all Clay Plain Tiles, but should not be used on a rafter pitch below 35° with Acme double camber and Ashdowne clay plain tiles.

Finials

Available in a range of colours.

* Made to order

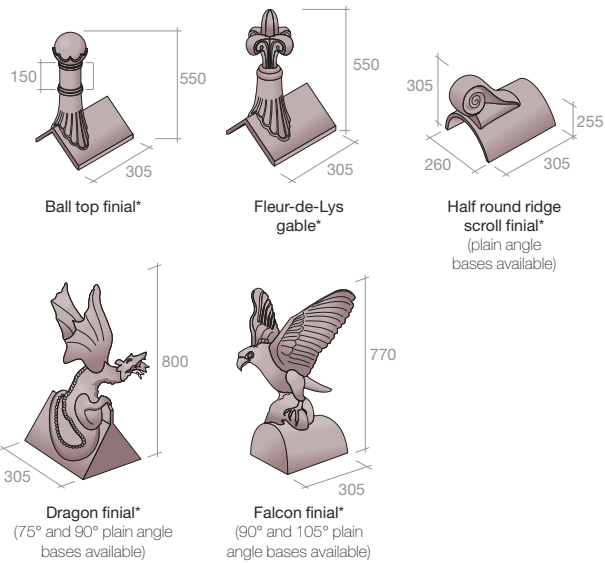

Plain tile fittings

Available in a range of colours.

* Made to order (subject to minimum order quantities)

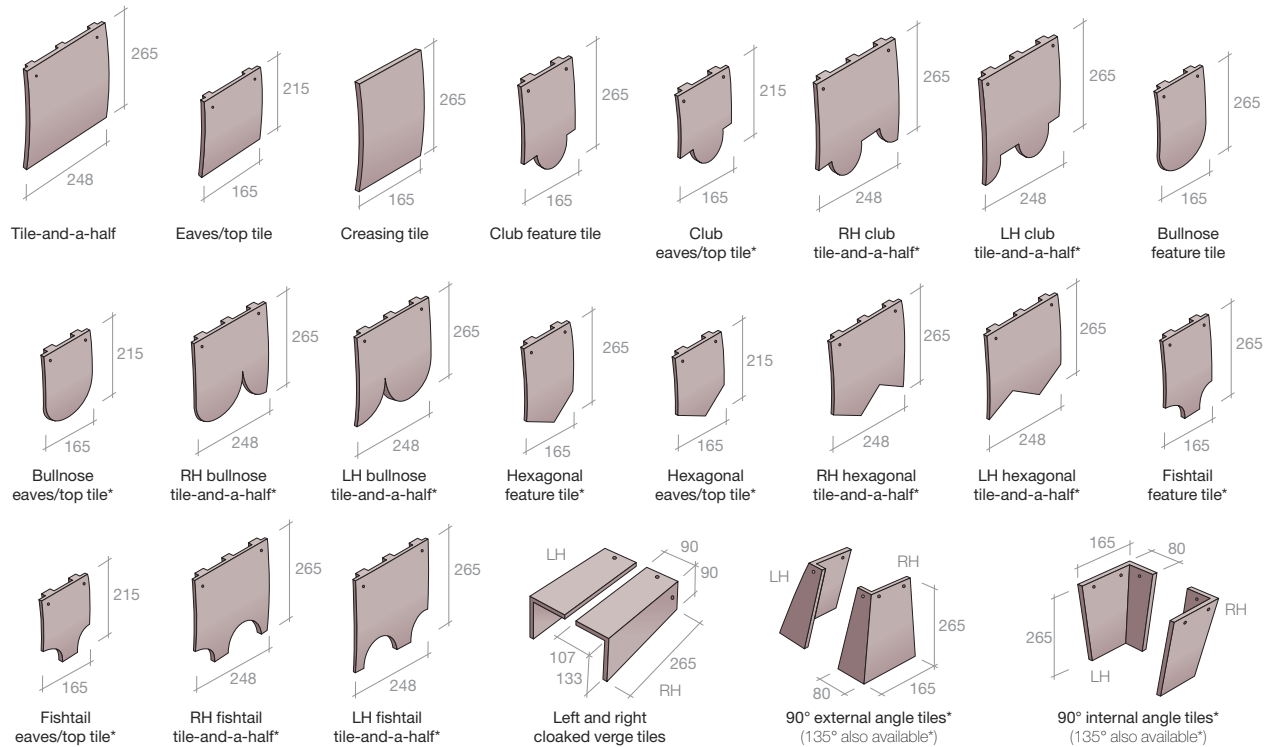

Design details

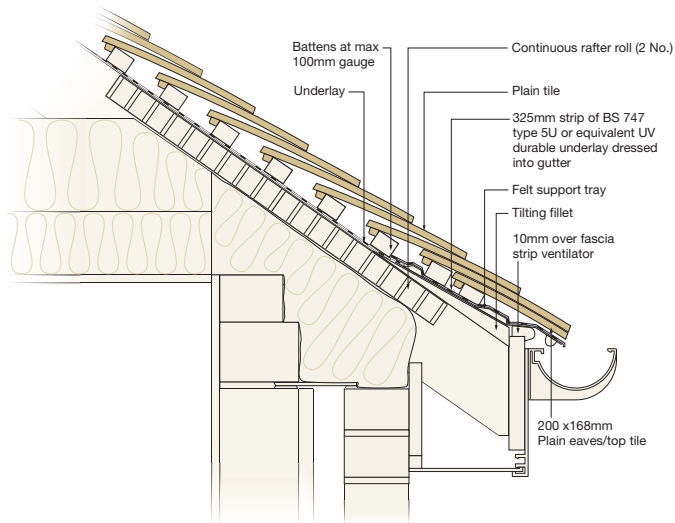

UNIVERSAL 10mm eaves vent system

Suitable for all tiles and slates.

- eaves ventilation to satisfy 10mm or 25mm conditions
- eaves to ridge ventilation for pitches of 15°-50°
- continuous rafter roll compresses insulation to allow free air passage (use two rolls to compress deep insulation)
- strip ventilator has discreet ventilation grille and is nailed to fascia or timber fillet
- suitable with or without soffit board
- use comb filler strip with deep profiled tiles
- mechanically fix all tiles at eaves

→ CAD detail 353

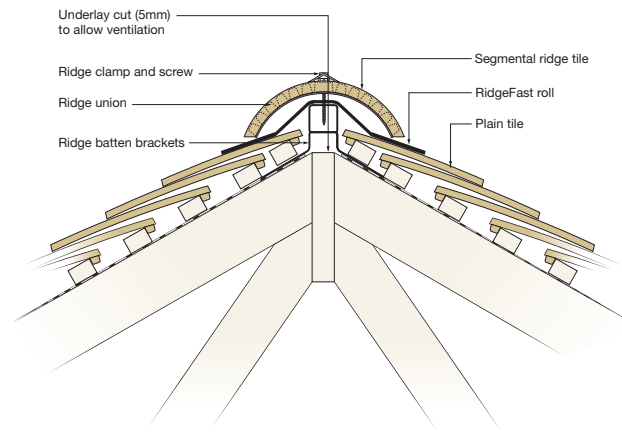

UNIVERSAL RidgeFast dry ridge system

Suitable for all tiles and slates using standard ridges. When using 350mm ridges or hips, the additional hip union pack should be used.

- maximum rafter pitch 60°
- provides 5,000mm²/m free vent area at ridge apex
- ensure gap is provided in roof underlay to vent roof void
- use one or two thicknesses of 50mm x 25mm batten to fit batten brackets
- mechanically fix all top course tiles
- use block end ridge tile or PVC ridge end cap at ridge end

→ CAD detail 790

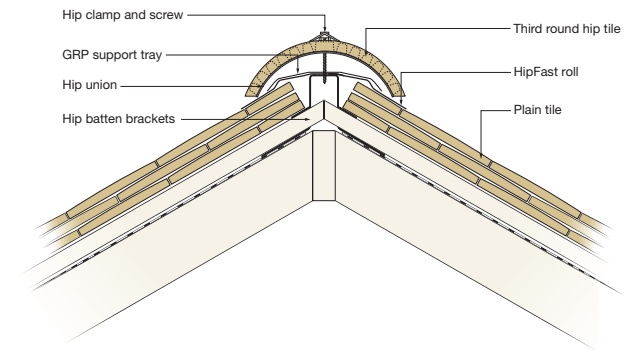

UNIVERSAL HipFast dry hip system

Suitable for all interlocking tiles and plan angles and where the pitch either side of the hip varies by a maximum 5°. Provides additional ventilation to the roof void when a 5mm gap is provided in the underlay and is used in conjunction with either eaves or ridge ventilation systems, or vent tiles. When using 350mm ridges or hips, the additional hip union pack should be used.

- maximum rafter pitch 60°
- provides additional ventilation to the roof void when a 5mm gap in the underlay is used in conjunction with either eaves or ridge ventilated systems or ventilation tiles
- use one or two thicknesses of 50mm x 25mm batten to fit batten brackets
- use block end hip tile at eaves
- mechanically fixes each hip tile via hip unions and clamps
- complete hip at ridge with soaker flashing

→ CAD detail 511

→ More

These drawings and an online library of similar technical details are available to download at: www.marleyeternit.co.uk/cad

→ More

These drawings and an online library of similar technical details are available to download at:
www.marleyeternit.co.uk/cad

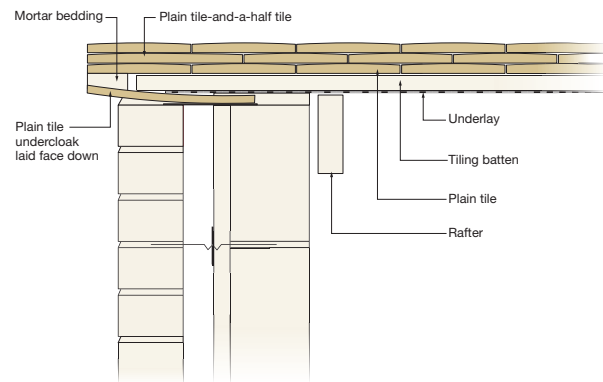

Bedded verge with plain tiles

Suitable for all plain tiles.

- form using tile and tile-and-a-half tiles in alternate courses
- use undercloak of either fibre cement laid with slope away from outer wall or plain tiles laid face down and overhanging wall
- verge overhang to be 38mm-50mm
- fully nail all tiles at verge where possible
- mortar bedding to comply with tensile board strength in BS 5534

→ CAD detail 447

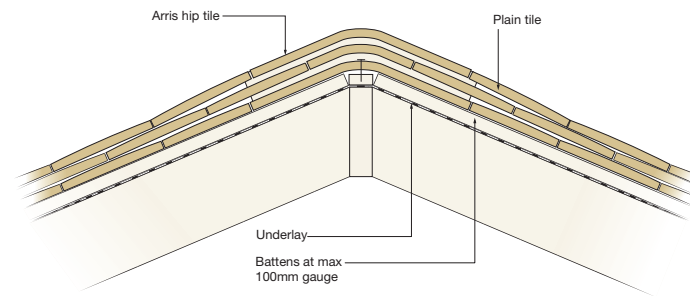

Arris hip with clay plain tiles

Suitable for all plain tiles.

- maximum rafter pitch 50°
- use on hips with plan angle of 90° and equal pitches on adjacent roof slopes
- fix to hip batten using 65mm x 3,35mm aluminium nail
- bed top of tiles with 3:1 sand/cement mortar to BS 5534
- complete hip at ridge or top abutment with lead saddle

→ CAD detail 597

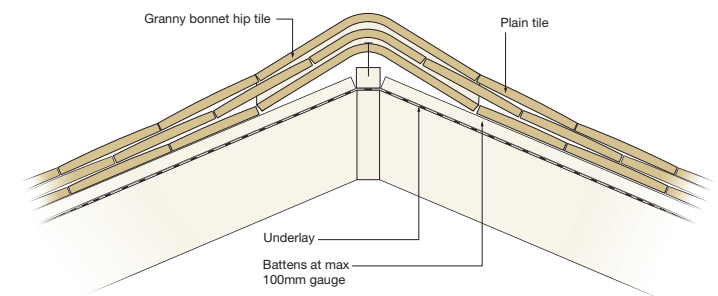

Granny bonnet hip with clay plain tiles

Suitable for all plain tiles.

- maximum rafter pitch 60° (clay) and 50° (concrete)
- use on hips with plan angle of 90° and equal pitches on adjacent roof slopes
- fix to hip batten using 70mm x 3,35mm aluminium nail
- bed and point with 3:1 sand/cement mortar to BS 5534
- complete hip at ridge or top abutment with lead saddle

→ CAD detail 597

Design details

→ More

These drawings and an online library of similar technical details are available to download at:
www.marleyeternit.co.uk/cad

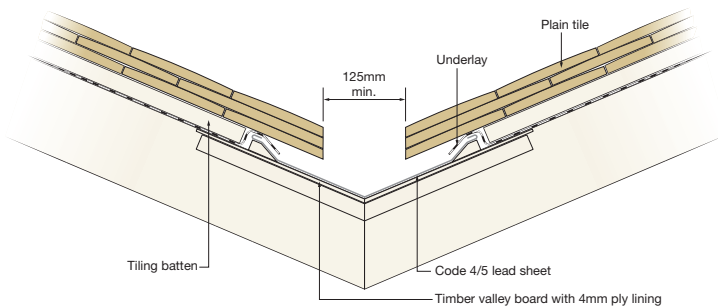

Sheet metal valley with plain tiles

Suitable for concrete or clay plain tiles.

- minimum rafter pitch 35°
- suitable for all plan angles and where the pitch either side of the valley varies
- provide continuous support for metal valley lining using timber lay boards inset between rafters with 4mm ply lining board over
- form 125mm minimum gap between raking cut tiles
- carry metal lining into gutter at eaves
- use tile-and-a-half tiles to minimise small cut tiles
- nail all adjacent tiles to the valley
- complete top of valley with a lead saddle

→ CAD detail 615

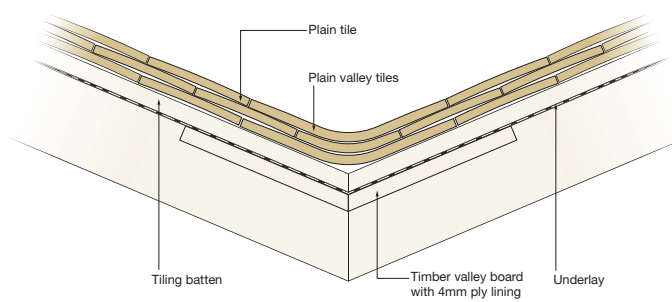

Valley tile with plain tiles

Suitable for concrete or clay plain tiles.

- minimum rafter pitch 50°
- suitable for a plan angle of 90° only and equal pitches either side of the valley
- provide continuous support for valley tile using timber lay boards or battens inset between rafters
- form 125mm minimum gap between raking cut tiles
- use tile-and-a-half tiles adjacent to valley tile to avoid small cuts
- complete top of valley with a lead saddle

→ CAD detail 630



Winchester cut with plain tiles

This gable end detail may be used for both concrete and clay plain tiles, and avoids the use of small triangular pieces of tile by providing a secure fixing of a tile-and-a-half against the rake of the gable.

- best suited for roof pitches of 40° and above
- fix batten parallel with rake of verge and level with vertical tiling battens
- use tile-and-a-half at end of each course and cut to rake (all tiles should be of uniform cut)
- cut adjacent tile to raking cut tile-and-a-half
- use Code 3 lead soakers (200mm x 200mm) where side laps are less than 55mm
- at apex use a tile-and-a-half turned through 45° and cut to shape

→ CAD detail 960

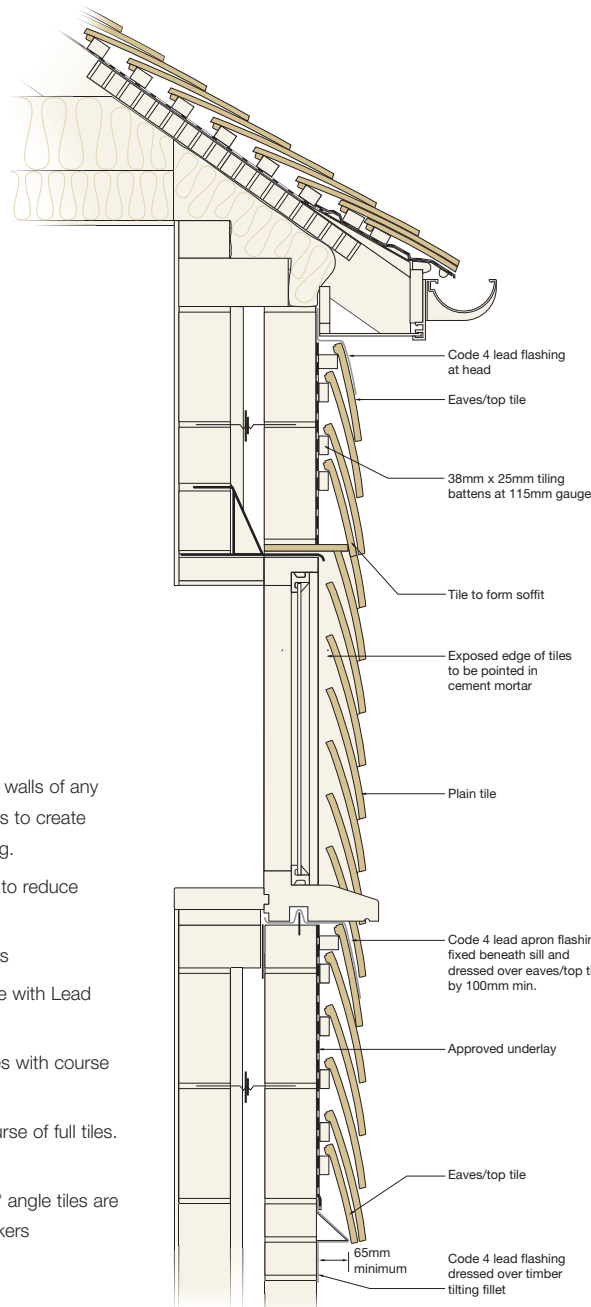

Vertical tiling with plain tiles

Plain tiling is an excellent, weatherproof and attractive cladding to the vertical walls of any building. Feature and ornamental tiles may also be used with normal plain tiles to create decorative patterns. Fibre cement slates can also be used for vertical cladding.

- use counterbattens over masonry construction (38mm x 25mm minimum) to reduce direct fixing. Special masonry fixings may be required
- ensure tiling details do not interfere with the opening of windows and doors
- lead flashings and soakers should be used around openings in accordance with Lead Sheet Association details
- use double course of tiles at eaves, by laying first course of eaves/tops tiles with course of full tiles over
- at top of wall or under a sill, use a course of eaves/tops tile laid over a course of full tiles. Dress a Code 4 lead cover flashing over by 100mm
- use internal and external angle tiles at all 90° corners. Purpose made 135° angle tiles are also available. For other angles, close mitre tiles and use Code 3 lead soakers
- all tiles should be twice nailed

→ CAD detail 910/920

→ More

These drawings and an online library of similar technical details are available to download at:
www.marleyeternit.co.uk/cad

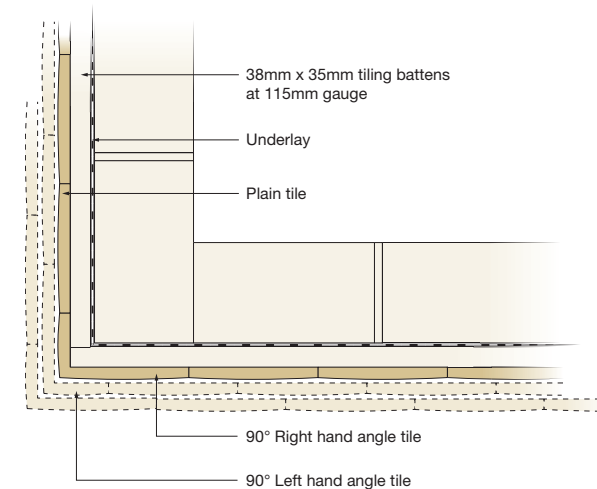

90° external angle tiles

Vertical angle tiles are available in left and right handed formats to fit 90° and 135° angle external corners of wall elements and are designed to bond with standard plain tiles. The following guidance notes apply to this detail:

- counter-battens, where used, should be fixed 20mm in from the end of the tiling battens at the corner, to prevent the end nail or screw fixing from splitting the tile batten
- Cut ends of the tiling battens should be alternated to coincide with the short leg of the external angle tiles.
- Fix left and right handed external angle tiles in alternate courses up the external corner to fit with the adjacent standard plain tiles.
- Avoid cutting the angle tiles to fit with the adjacent tiles.
- Secure each vertical angle tile by twice nailing.

→ CAD detail 941



Technical Advisory Service

Marley Eternit provides a free Technical Advisory Service which is staffed by personnel with specialist knowledge of the use of all Marley Eternit roofing products and systems. Services include:



Fixing specifications

Bespoke fixing specifications can be provided, taking into account location, dimensions and degree of exposure for individual buildings.

→ To create your own fixing specification, visit:

www.marleyeternit.co.uk/tilefix



Estimating tile quantities

Calculation of all materials required for any roofing project including tiles, battens, underlay, ancillary fittings and accessories.

→ For a materials estimate, visit:

www.marleyeternit.co.uk/estimator



National Building Specification clauses (NBS)

All essential clauses for Marley Eternit roof specifications are available, detailing all work items in section H65 'Single lap roof tiling', H60 'Plain roof tiling' and H61 'Fibre cement slates'.



www.marleyeternit.co.uk/specrite

Marley Eternit Assured Roofing Specification Scheme

Operated through Marley Eternit's Technical Advisory Service, this unrivalled and comprehensive advice and support service for specifiers of major roofing projects offers the following:

- In-depth technical advice
- Project-specific fixing specifications
- Project-specific NBS clauses

Level of cover

Marley Eternit offer 15 years cover for design performance, fixing specification and for product durability when correctly installed in accordance with our recommendations and the requirements of BS 5534.

Technical Advisory Service

contact tel 01283 722588
e-mail info@marleyeternit.co.uk

→ For instant NBS clauses, visit:



Customer Services

Marley Eternit is committed to providing outstanding customer care and is staffed by experienced personnel in departments dedicated to providing the following services:

Advice, literature and samples

- All current product and technical literature can be downloaded from: www.marleyeternit.co.uk/downloads
- For samples, visit: www.marleyeternit.co.uk/samples
tel 01283 722588
e-mail info@marleyeternit.co.uk

Quotations and ordering information

- tel 08705 626400
e-mail info@marleyeternit.co.uk

Stockist information

To find details for stockists of Marley Eternit products, visit: www.marleyeternit.co.uk/stockists

- tel 08705 626400
e-mail info@marleyeternit.co.uk

Customer Services

tel 01283 722588
e-mail info@marleyeternit.co.uk

Training centre

We have a purpose-built training centre where we are able to impart our expertise through a range of practical and classroom courses.

→ tel 08705 626400

Marley Eternit roofing ranges

- Clay and concrete plain tiles
- Fibre cement slates
- Interlocking slates
- Interlocking tiles
- Ventilation and dry fix roof accessories
- Fittings and accessories

Marley Eternit also offer comprehensive ranges of Claddings, Building Boards, Profiled Sheeting and accessories.

Information for all these products is available on request.

→ www.marleyeternit.co.uk tel 01283 722588

For further information

T 01283 722588 F 01283 722219 E info@marleyeternit.co.uk

www.marleyeternit.co.uk/clay



an **Etex** GROUP company

Marley Eternit Limited, Lichfield Road, Branston, Burton on Trent, DE14 3HD

This publication is based on the latest data available at the time of printing. Due to product changes, improvements and other factors, the Company reserves the right to change or withdraw information contained herein without prior notice. For specific applications users should refer to the Technical Advisory Service and relevant Standards and Codes of Practice for guidance. The photography shown in the document should not necessarily be taken as recommendations of good practice. The printing process restricts the exact representation of colours. For true colour reference, please request product samples.