

# MAC TORQUE TIE



The MAC TORQUE TIE has a unique setting system for fast installation of remedial wall ties. The illustration below shows the torque nut which has a shear neck the dimension of which has been pre-determined to fail at the correct torque ensuring correct setting of the inner leaf expander. The Mac Torque Tie is suitable for use in solid base materials such as brick or concrete.

The Mac Torque Tie complies with BRE digest 329/401, CIRIA 117 and DDI40 for remedial wall ties systems.

## MAC TORQUE TIE SPECIFICATIONS

| Code    | Drill Ø<br>mm | Tie<br>length mm | Nominal<br>cavity width mm | Ultimate kN |              |              |
|---------|---------------|------------------|----------------------------|-------------|--------------|--------------|
|         |               |                  |                            | Concrete    | Brick 15N/mm | Block >7N/mm |
| MTQ6200 | 12            | 200              | 45 – 70                    | 8           | 6            | 3            |
| MTQ6225 | 12            | 225              | 70 – 95                    | 8           | 6            | 3            |
| MTQ6255 | 12            | 255              | 100 – 125                  | 8           | 6            | 3            |

## THE BENEFITS

- Corrosion resistant
- Quick and easy to install
- Reliable and economical
- Suitable for most wall materials
- Independent setting in each leaf
- Unique convex shape expanders
- Low torque
- Manufactured to BS EN ISO 9000
- M6 thread-high buckling strength
- 12mm hole for neat finish
- Torque nut
- Fast installation
- Tested installation

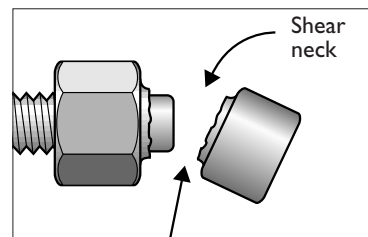

European Patent No. 0146453 B1

### TECHNICAL INFORMATION

**SPECIFICATIONS:**  
 Material A2, 300 series,  
 Austenitic Stainless Steel  
 Expanders 12mm diameter  
 Thread diameter of Rod M6

**ACCESSORIES:**  
 FT5HS Hex Setting Tool  
 TBQ100 Fixed Head Torque Wrench

**TORQUE SETTING:**  
 6.8Nm (5lb.ft)

**NOTE:** Drill bits to conform to  
 DIN 8035

## APPLICATION METHOD

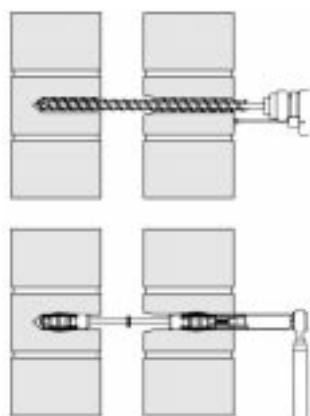

**DRILL**  
 Drill 12mm diameter hole in brickwork within 10° upwards, setting depth gauge on drilling machine to give between 55-65mm hole depth in inner leaf.

**SET INNER**  
 Blow out hole, insert the tie to full depth of hole in inner leaf. Fit hex setting tool (FT5HS) on to torque wrench (TBQ100). Tighten inner expander with pre-set torque nut. After shearing off the torque nut continue turning the setting tool (FT5HS) until wrench indicates you have reached the pre-determined torque for outer leaf. Remove setting tool.