

Manufactured in the U.S.A. by our affiliated company, HP-Omni Manufacturing and Zephyr, major suppliers to Boeing Aircraft. Our Clecos are plier operated, spring loaded with a durable steel plated body. Designed for sheets that require precise holding of the material while other operations are completed. Fasteners are the standard button plunger type "Clecos." Use TP74 manual plier or US902 pneumatic installation tool for ease of operation.

CLECO FASTENERS



"C" Type		
Part No.	Material Capacity	Drill Size
C-1/16	0" - 1/4"	1/16"
C-3/32	0" - 1/4"	#40
C-1/8	0" - 1/4"	#30
K-27	0" - 1/4"	#27
C-5/32	0" - 1/4"	#20
K-4.5mm	0" - 1/4"	#16
C-3/16	0" - 1/4"	#10
K-7/32	0" - 1/4"	#2
K-1/4	0" - 1/4"	1/4"



"CHD" Type (Heavy Duty)		
Part No.	Material Capacity	Drill Size
CHD-3/32	0" - 1/2"	#40
CHD-1/8	0" - 1/2"	#30
CHD-5/32	0" - 1/2"	#20
CHD-3/16	0" - 1/2"	#10
KHD-7/32	0" - 1/2"	#2
KHD-1/4	0" - 1/2"	1/4"



"CL" Type		
Part No.	Material Capacity	Drill Size
CL-3/32	1/4" - 1/2"	#40
CL-1/8	1/4" - 1/2"	#30
CL-5/32	1/4" - 1/2"	#20
CL-3/16	1/4" - 1/2"	#10



Mini "CC" Type (Heavy Duty)		
Part No.	Material Capacity	Drill Size
CC-3/32	0" - 1/4"	#40
CC-1/8	0" - 1/4"	#30
CC-5/32	0" - 1/4"	#20
CC-3/16	0" - 1/4"	#10

Note: TP75NM can be installed on fasteners at an extra charge.



"KEL" Type		
Part No.	Material Capacity	Drill Size
KEL-3/32	1/2" - 3/4"	#40
KEL-1/8	1/2" - 3/4"	#30
KEL-5/32	1/2" - 3/4"	#20
KEL-3/16	1/2" - 3/4"	#10

HEX/WING NUT TEMPORARY FASTENERS

- Spin-free design allows nut to completely back off
- High clamping force
- Metric fasteners available



Hole Diameter	Part No. Hex Nuts	Grip Range	Part No. Wing Nut	Grip Range	Color Code	Drill Size
3/32"	CHN-FW-3/32	0" - 1/2"	CWN-FW-3/32	0" - 1/2"	Silver	#40
	CHNL-FW-3/32	0" - 1"	CWNL-FW-3/32	0" - 1"		
	KHNEL-FW-3/32	1/2" - 1-1/2"	KWNL-FW-3/32	1/2" - 1-1/2"		
1/8"	CHN-FW-1/8	0" - 1/2"	CWN-FW-1/8	0" - 1/2"	Copper	#30
	CHNL-FW-1/8	0" - 1"	CWNL-FW-1/8	0" - 1"		
	KHNEL-FW-1/8	1/2" - 1-1/2"	KWNL-FW-1/8	1/2" - 1-1/2"		
5/32"	CHN-FW-5/32	0" - 1/2"	CWN-FW-5/32	0" - 1/2"	Black	#20
	CHNL-FW-5/32	0" - 1"	CWNL-FW-5/32	0" - 1"		
	KHNEL-FW-5/32	1/2" - 1-1/2"	KWNL-FW-5/32	1/2" - 1-1/2"		
3/16"	CHN-FW-3/16	0" - 1/2"	CWN-FW-3/16	0" - 1/2"	Brass	#10
	CHNL-FW-3/16	0" - 1"	CWNL-FW-3/16	0" - 1"		
	KHNEL-FW-3/16	1/2" - 1-1/2"	KWNL-FW-3/16	1/2" - 1-1/2"		
7/32"	KHN-FW-7/32	0" - 1/2"	KWN-FW-7/32	0" - 1/2"	Silver	7/32"
	KHNL-FW-7/32	0" - 1"	KWNL-FW-7/32	0" - 1"		
1/4"	KHN-FW-1/4	0" - 1/2"	KWN-FW-1/4	0" - 1/2"	Copper	1/4"
	KHNL-FW-1/4	0" - 1"	KWNL-FW-1/4	0" - 1"		
	KHNEL-FW-1/4	1/2" - 1-1/2"	KWNL-FW-1/4	1/2" - 1-1/2"		
5/16"	KHN-FW-5/16	0" - 1/2"	KWN-FW-5/16	0" - 1/2"	Black	5/16"
	KHNL-FW-5/16	0" - 1"	KWNL-FW-5/16	0" - 1"		
	KHNEL-FW-5/16	1/2" - 1-1/2"	KWNL-FW-5/16	1/2" - 1-1/2"		
	KHNK-FW-5/16	1-1/2" - 2-1/2"	KWNK-FW-5/16	1-1/2" - 2-1/2"		

NO-MAR SHEET METAL FASTENERS

- Instantly spins up or down with the flick of a finger
- Specially designed tip provides maximum gripping strength
- No-mar plastic caps are color coded for easy identification

Part No.	Standard Length		
	Material Capacity	Drill Size	Color Code
TPSSL-3/32	0" - 1/4"	#40	Red
TPSSL-1/8	0" - 1/4"	#30	Yellow
TPSSL-5/32	0" - 1/4"	#20	Blue
TPSSL-3/16	0" - 1/4"	#10	Black
TPSEL-3/32	0" - 1/2"	#40	Red
TPSEL-1/8	0" - 1/2"	#30	Yellow
TPSEL-5/32	0" - 1/2"	#20	Blue
TPSEL-3/16	0" - 1/2"	#10	Black
TPSEL-1/4	0" - 1/2"	1/4"	White



TPSSL

Air Tool Services
Zenith House Aqueduct Street Preston
Lancashire PR1 7TB

Air Tool Services
01772 557700
www.airtoolservices.co.uk

SIDE GRIP TYPE SHEET METAL FASTENERS

"Side Grip" Type		
Part No.	Material Capacity	Reach
CSG-1/2-1/2	0" - 1/2"	1/2"
CSG-3/4-1/2	0" - 3/4"	1/2"
CSG-1/2-1	0" - 1/2"	1"
CSG-3/4-1	0" - 3/4"	1"



SIDE GRIP TYPE SHEET METAL FASTENERS

- Apply in a fraction of the time required for ordinary screw clamps
- Assures uniform pressure
- Steel alloy yoke & steel spring provides 70 lbs. of force

Part No.	Throat Depth	Jaw Capacity
AIT542	2"	0" - 7/16"
AIT543	3"	1/4" - 1/2"



QUICK-CLAMP LEVER LOCKS

Part No.	Clamp Capacity	Jaw Depth
W1	0" - 5/32"	1"
W2	0" - 5/32"	1-1/2"



PROTECTIVE CAPS FOR SHEET METAL FASTENERS

- Caps are easily installed
- Caps installed on fastener at extra charge
- TP75NM for all except CC Series
- Polyurethane - Black

Part No.	Hole Diameter
TP75NM	1/16" - 3/16"
TP109NM	3/32" - 1/4"



TP75NM



TP109NM

TEMPORARY FASTENER PLIERS

- Designed for the installation of C, CC, CHD, M, MHD, CSG, etc.
- Compatible with all spring loaded type fasteners: Cleko-Lok, Monogram and Zephyr

Part No.	Type
TP74	Pliers without grips
TP74V	With vinyl handle grips
TP74B	Reverse Plier



TP74V



TP74B

SPRING TEMPORARY FASTENER INSTALLATION TOOL

- 6' hose included

Standard Nose		
Part No.	Overall Length	Weight
US902	5-1/2"	.75 lbs.

Extended Nose		
Part No.	Overall Length	Weight
US902E	9-1/2"	1.0 lbs.



US902



US902E

WING/HEX BODY TEMPORARY FASTENER DRIVER

Developed to install all types of wing nut and hex nut reusable fasteners. Can be used with any power tool that has a 1/4" capacity chuck or a 1/4" hex female spindle. We recommend a driving tool with an adjustable clutch since damage to the aircraft structure can occur if excessive torque is applied.

Part No.	Overall Length	Weight
TP835	3-1/2"	.14 lbs.



TP835



SIOUX HEX BODY TEMPORARY FASTENER INSTALLATION TOOL

Pistol Grip				
Part No.	RPM (no load)	Torque	Overall Length	Weight
SR9A-25	2500	55 in-lbs.	9-1/4"	2.7 lbs.

"Z" Handle Type				
Part No.	RPM (no load)	Torque	Overall Length	Weight
2S2300SR	2500	55 in-lbs.	5-3/4"	2.6 lbs.



SR9A-25

APEX® SLOTTED INSERT BITS



445-1X

1/4" Hex				
Part No.	Screw Size	Blade Thickness	Blade Width	OAL
445-1X	4F-5R	.034"	3/16"	1"
445-2X	6F-8R	.040"	7/32"	1"
445-3X	8F-10R	.042"	1/4"	1"
445-4X	10F-12R	.046"	9/32"	1"
445-5X	12F-14R	.050"	5/16"	1-1/2"
445-6X	14F-16R	.055"	23/64"	1-1/2"



480-2X

5/16" Hex				
Part No.	Screw Size	Blade Thickness	Blade Width	OAL
485-1X	8F-10R	.042"	3/16"	1-1/2"
485-2X	10F-12R	.046"	7/32"	1-1/2"
485-3X	12F-14R	.050"	1/4"	1-1/2"
445-4X	14F-16R	.055"	19/64"	1-1/2"

APEX® SLOTTED INSERT BITS

- Longer lengths available

1/4" Hex				
Part No.	Screw Size	Blade Thickness	Blade Width	OAL
320-1X	4F-5R	.034"	.187"	1-15/16"
320-2X	6F-8R	.036"	.250"	1-15/16"
320-4X	8F-10R	.042"	.275"	1-15/16"
320-5X	10F-12R	.046"	.312"	1-15/16"
320-6X	12F-14R	.050"	.360"	1-15/16"



320-2X

LIMITED CLEARANCE PHILLIPS INSERT BITS

1/4" Hex Drive		
Part No.	Point Size	OAL
446-1X	1	1"
446-2X	2	1"
446-3X	3	1"



446-2X

APEX® PHILLIPS INSERT BITS

1/4" Hex Drive		
Part No.	Point Size	OAL
440-1X	1	1"
440-2X	2	1"
440-3X	3	1"
440-4X	4	1-5/16"



480-2X

5/16" Hex Drive		
Part No.	Point Size	OAL
480-1X	1	1-1/4"
480-2X	2	1-1/4"
480-3X	3	1-1/4"
480-4X	4	1-1/4"

Air Tool Services
 Zenith House Aqueduct Street Preston
 Lancashire PR1 7TB

Air Tool Services
 01772 557700
www.airtoolservices.co.uk

APEX® PHILLIPS ACR INSERT BITS

- ACR anti-camout bits prevent workpiece damage and permit higher torque
- Special wing-face ribs grip screw recesses to prevent stripping



480-2-ACR2-RX

1/4" Hex Insert ACR			
Part No.	Type	Point	OAL
440-1-ACR1-RX	Removal	1	1"
440-1-ACR1-DX	Driving	1	1"
440-1-ACR1X	Both	1	1"
440-2-ACR2-RX	Removal	2	1"
440-2-ACR2-DX	Driving	2	1"
440-2-ACR2X	Both	2	1"
440-2-ACR2-DX	Both	2	1"
440-3-ACR3-RX	Removal	3	1"
440-3-ACR3-DX	Driving	3	1"
440-3-ACR3X	Both	3	1"

5/16" Hex Insert ACR			
Part No.	Type	Point	OAL
480-2-ACR2-RX	Removal	2	1-1/4"
480-2-ACR2X	Both	2	1-1/4"
480-3-ACR3X	Both	3	1-1/4"
480-3-ACR3X	Both	4	1-1/4"

APEX® PHILLIPS ACR POWER BITS

- ACR anti-camout bits prevent workpiece damage and permit higher torque
- Special wing-face ribs grip screw recesses to prevent stripping



492-ACR2-RX

1/4" Hex Power ACR			
Part No.	Type	Point	OAL
491-ACR1-RX	Removal	1	1-15/16"
491-ACR1-DX	Driving	1	1-15/16"
491-ACR1X	Both	1	1-15/16"
492-ACR2-RX	Removal	2	1-15/16"
492-ACR2-DX	Driving	2	1-15/16"
492-ACR2X	Both	2	1-15/16"

1/4" Hex Power ACR			
Part No.	Type	Point	OAL
493-ACR3-RX	Removal	3	1-15/16"
493-ACR3-DX	Driving	3	1-15/16"
493-ACR3X	Both	3	1-15/16"

APEX® BIT HOLDERS



855

Hex Bit Holder			
Part No.	Drive	Hex Size	OAL
825	1/4" sq.	1/4"	1"
838	3/8" sq.	1/4"	1-1/2"
835	3/8" sq.	5/16"	1-1/2"
858	1/2" sq.	1/4"	1-3/4"
855	1/2" sq.	5/16"	1-3/4"



M490

Hex Bit Holder			
Part No.	Drive	Hex Size	OAL
490	1/4" sq.	1/4"	2-1/8"
M490	1/4" sq.	1/4"	2-31/32"
498	1/4"	5/16"	2-3/8"
M498	1/4"	5/16"	3-1/16"

Note: "M" for magnetic.

APEX® TORQ-SET BITS



212-2

1/4" Hex Insert		
Part No.	Point	OAL
212-0	0	1"
212-1	1	
212-2	2	
212-3	3	
212-4	4	
212-5	5	
212-6	6	
212-8	8	
212-10	10	
212-1/4	1/4"	



212-6-ACR 212-10-ACR

1/4" Hex Insert ACR		
Part No.	Point	OAL
212-6-ACR	6	1-1/4"
212-8-ACR	8	
212-10-ACR	10	
212-1/4-ACR	1/4"	



212-8A

5/16" Hex Insert		
Part No.	Point	OAL
212-8A	8	1-1/4"
212-10A	10	
212-1/4A	1/4"	
212-5/16A	5/16"	
212-3/8A	3/8"	

Note: ACR removal only.

5/16" Hex Insert ACR (Removal)		
Part No.	Point	OAL
212-1/4A-ACR	1/4"	1-1/4"
212-5/16A-ACR	5/16"	



170-0



170-2



170-ACR

1/4" Hex Power Drive		
Part No.	Point	OAL
170-0	0	1-1/4"
170-1	1	
170-2	2	
170-3	3	
170-4	4	
170-5	5	
170-6	6	
170-6-ACR	6	
170-8	8	
170-8-ACR	8	
170-10	10	
170-10-ACR	10	
170-1/4R	1/4"	
170-5/16R	5/16"	
170-3/8R	3/8"	



170-8A

170-10A

5/16" Hex Power Drive		
Part No.	Point	OAL
170-8A	8	1-1/4"
170-10A	10	
170-1/4A	1/4"	
170-5/16A	5/16"	
170-3/8A	3/8"	



170-1/4

7/16" Hex Power Drive		
Part No.	Point	OAL
170-1/4	1/4"	1-1/4"
170-5/16	5/16"	
170-3/8	3/8"	
170-7/16	7/16"	



170-1/4-ACR

7/16" Hex Power Drive ACR*		
Part No.	Point	OAL
170-1/4-ACR	1/4"	1-1/4"
170-5/16-ACR	5/16"	

Note: ACR removal only.



170-1/2

5/8" Hex Power Drive		
Part No.	Point	OAL
170-1/2	1/2"	1-1/4"
170-9/16	9/16"	
170-5/8	5/8"	

APEX® TRI-WING BITS



TWD-2

1/4" Hex Insert				
Part No.	Point Size	Screw Size Tension Head	Screw Size Shear Head	OAL
TWD-0	0	0-80	-	1"
TWD-1	1	2-56	4-40	
TWD-2	2	4-40	6-32	
TWD-3	3	6-32	8-32	
TWD-4	4	8-32	10-32	
TWD-4-ACR	4	8-32	10-32	
TWD-5	5	10-32	1/4"-28	
TWD-5-ACR	5	10-32	1/4"-28	
TWD-6	6	1/4"	5/16"	
TWD-7	7	5/16"	3/8"	



TWA-6

5/16" Hex Power Drive				
Part No.	Point Size	Screw Size Tension Head	Screw Size Shear Head	OAL
TWA-6	6	1/4"-28	5/16"-24	1-1/4"
TWA-7	7	5/16"-24	3/8"-24	
TWA-8	8	3/8"-24	7/16"-20	



TW-6

7/16" Hex Power Drive				
Part No.	Point Size	Screw Size Tension Head	Screw Size Shear Head	OAL
TW-6	6	1/4"-28	5/16"-24	1-1/4"
TW-7	7	5/16"-24	3/8"-24	



TW-2

1/4" Hex Power Drive				
Part No.	Point Size	Screw Size Tension Head	Screw Size Shear Head	OAL
TW-0	0	0-80	-	1-1/4"
TW-1	1	2-56	4-40	
TW-2	2	4-40	6-32	
TW-3	3	6-32	8-32	
TW-4	4	8-32	10-32	
TW-5	5	10-32	1/4"-28	
TWB-6	6	1/4"-28	5/16"-24	
TWB-7	7	5/16"-24	3/8"-24	
TWB-8	8	3/8"-24	7/16"-20	



TWE-4

5/16" Hex Insert				
Part No.	Point Size	Screw Size Tension Head	Screw Size Shear Head	OAL
TWE-4	4	8-32	10-32	1-1/4"
TWE-5	5	10-32	1/4"-28	

Note: ACR removal only.

APEX® HI-TORQUE BITS



HTN-B-2

1/4" Hex - 1-1/4" OAL					
Part No.	Screw Size	Body Dia.	Blade Thickness	Blade Width	Recess
HTN-B-1	3,4,5,6	9/32"	.049"	.274"	1
HTN-B-2	8	5/16"	.059"	.295"	2
HTN-B-3	10	3/8"	.059"	.377"	3
HTN-B-4	1/4	1/2"	.073"	.502"	4



HTS-3A

3/8" Square Drive - 1-1/4" OAL					
Part No.	Screw Size	Body Dia.	Blade Thickness	Blade Width	Recess
HTS-3A	10	9/32"	.049"	.274"	3
HTS-4A	1/4	5/16"	.059"	.295"	4
HTS-5	5/16	3/8"	.059"	.377"	5
HTS-6	3/8	1/2"	.073"	.502"	6



HTS-2

1/4" Square Drive - 1" OAL					
Part No.	Screw Size	Body Dia.	Blade Thickness	Blade Width	Recess
HTS-0	0,1,2	1/2"	.029"	.167"	0
HTS-1	3,4,5,6	1/2"	.049"	.274"	1
HTS-2	8	1/2"	.059"	.295"	2
HTS-3	10	1/2"	.059"	.377"	3
HTS-4	1/4	1/2"	.073"	.502"	4



HTS-7

1/2" Square Drive - 1-1/4" OAL					
Part No.	Screw Size	Body Dia.	Blade Thickness	Blade Width	Recess
HTS-7	7/16	1"	.112"	.884"	7
HTS-8	1/2	1"	.142"	.995"	8
HTS-9	9/16	1-1/4"	.162"	1.136"	9
HTS-10	5/8	1-1/4"	.182"	1.250"	10
HTS-12	3/4	1-1/4"	.216"	1.500"	12

HI-TORQUE BITS

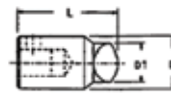

1/4" Square Drive - 1" OAL					
Part No.	Screw Size	Body Dia.	Blade Thickness	Blade Width	Recess
ZHTS-0	0,1,2	1/2"	.029"	.167"	0
ZHTS-1	3,4,5,6	1/2"	.049"	.274"	1
ZHTS-2	8	1/2"	.059"	.295"	2
ZHTS-3	10	1/2"	.059"	.377"	3
ZHTS-4	1/4	1/2"	.073"	.502"	4

3/8" Square Drive - 1-1/4" OAL					
Part No.	Screw Size	Body Dia.	Blade Thickness	Blade Width	Recess
ZHTS-3A	10	9/32"	.049"	.274"	3
ZHTS-4A	1/4	5/16"	.059"	.295"	4
ZHTS-5A	5/16	3/8"	.059"	.377"	5
ZHTS-6A	3/8	1/2"	.073"	.502"	6

1/2" Square Drive - 1-5/8" OAL					
Part No.	Screw Size	Body Dia.	Blade Thickness	Blade Width	Recess
HTS-7	7/16	1"	.112"	.884"	7
HTS-8	1/2	1"	.142"	.995"	8

Air Tool Services
Zenith House Aqueduct Street Preston
Lancashire PR1 7TB

Air Tool Services
01772 557700
www.airtoolservices.co.uk

SIoux® RATCHET WRENCHES

- For light duty assembly and repair work
- Reverse button and teasing throttle
- Composite grip
- Steel angle head



5009



5011

1/4" Drive						
Part No.	RPM (no load)	Max. Torque	Square Drive	Bolt Capacity	Weight	OAL
SX5009	265	5-15 ft-lbs.	1/4	5/16	1.5 lbs.	6.6"

3/8" Drive						
Part No.	RPM (no load)	Max. Torque	Square Drive	Bolt Capacity	Weight	OAL
SX50011	185	50 ft-lbs.	3/8	7/16	2.6 lbs.	10.8"

1/2" Drive						
Part No.	RPM (no load)	Max. Torque	Square Drive	Bolt Capacity	Weight	OAL
SX50013	185	50 ft-lbs.	1/2	7/16	2.6 lbs.	10.8"

SIoux® IMPACT WRENCHES

- Built-in air regulator for positive speed and torque control
- Friction ring socket retainer



SX5038B



SX5045

3/8" Pistol Grip						
Part No.	RPM (no load)	Max. Torque	Square Drive	Bolt Capacity	Weight	OAL
SX5038B	8500	185 ft-lbs.	3/8	3/8	3.7 lbs.	6.3"

3/8" Pistol Grip						
Part No.	RPM (no load)	Max. Torque	Square Drive	Bolt Capacity	Weight	OAL
SX5045	9500	175 ft-lbs.	3/8	3/8	2.5 lbs.	7.6"

3/8" Pistol Grip						
Part No.	RPM (no load)	Max. Torque	Square Drive	Bolt Capacity	Weight	OAL
SX5000	8000	425 ft-lbs.	1/2	5/8	5.6 lbs.	7.4"

REVERSIBLE IMPACT DRIVER

- Two knurled bands for sure grip
- Quick action reversing ring
- May also be used with impact sockets
- Includes metal case

Part No.	Square Drive	Bits Included
TP130	3/8"	#2 & 3 Phillips, 5/16" & 9/32" Slotted



TP130

Air Tool Services
Zenith House Aqueduct Street Preston
Lancashire PR1 7TB

Air Tool Services
01772 557700
www.airtoolservices.co.uk

JET ECONOMY SCREWDRIVERS

- Quick action reversing valve and quick change chuck
- Variable speed trigger for positive control on pistol models
- Ball and needle bearing construction for efficient performance
- Adjustable clutch



JSM-812

Pistol Grip 0.5 HP - 1/4" Hex				
Part No.	RPM (no load)	Torque Range	Weight	OAL
JSM-812	1800	45 to 115 in-lbs.	4 lbs.	7"

Lever Grip 0.5 HP - 1/4" Hex				
Part No.	RPM (no load)	Torque Range	Weight	OAL
JSM-842	1800	45 to 115 in-lbs.	4 lbs.	10"
JSM-843	800	45 - 145 in-lbs.	3.5 lbs.	11"

CLECO SCREWDRIVERS

- Designed to handle high-volume assembly line tasks
- Ergonomically designed housing is low vibration and lightweight
- Reversible motor with low-force tapered trigger (sliding knob)
- 1/4" quick change
- External torque adjustment
- Made in the U.S.A.



14TTA

Pistol Grip 0.5 HP - 1/4" Hex					
Part No. Large Handle	Screw Size	RPM (no load)	Max. Torque	Weight	OAL
14TTA04Q	#10	1100	3 to 40 in-lbs.	1.9 lbs.	8.3"

1/4" SQUARE ANGLE ATTACHMENT

- 1/4" square drive - male
- 1/4" square drive - female
- Takes 1/4" hand ratchets only
- Not recommended for power tools

Angle Attachment		
Part No.	Head Height	OAL
5-3	1-5/8"	7-1/4"



5-3

BRUTUS® SCREW EXTRACTOR

- Used on tip caps for copters
- Chosen to standardize aircraft and missile maintenance DOD wide
- Works on Phillips, Tri-Wing and Hi-Torque
- Heat-treated, plated and built for a lifetime
- Folds up for easy storage with accessory compartment in handle



TP855

Part No.	For Screws	Weight	OAL (open)
TP855	#8 to #14	3.2 lbs.	17"
TP855-7	1/4" to 3/8"	4.5 lbs.	18-3/4"

Note: Bits and ratchet not included.

STRAIGHT-FLUTE SCREW EXTRACTOR SETS

- Straight flute extractors will not expand material removed (easier removal)
- Includes plastic pouch

Part No.	Description	Extractor Included
AIT53625	4 pc. set	#2, 3, 4 & 5
TP9500A	5 pc. set	#1, 2, 3, 4 & 5
AIT53645	6 pc. set	#1, 2, 3, 4, 5 & 6



TP9500A



AIT53625

SPIRAL FLUTE SCREW EXTRACTOR SETS

- Spiral flute extractors have an aggressive left hand spiral design for extra power
- Includes plastic pouch

Part No.	Description	Extractor Included
AIT52425	4 pc. set	#2, 3, 4 & 5
AIT53535	5 pc. set	#1, 2, 3, 4 & 5
AIT53545	6 pc. set	#1, 2, 3, 4, 5 & 6



AIT53535

SPIRAL FLUTE SCREW EXTRACTOR & DRILL BIT SET

- Spiral flute extractors have an aggressive left hand spiral design for extra power
- Each extractor is packaged with the correct size cobalt drill bit
- Metal index case

10 Piece Kit includes:

- Spiral Flute Extractors (#1, 2, 3, 4 & 5), Cobalt Drill Bits (5/64", 7/64", 5/32", 1/4" & 19/64") & Plastic Pouch

Part No.	Description
IRW11119	Complete Set



IRW11119

CYLINDRICAL BODY TEMPORARY FASTENER INSTALLATION TOOL

- No 'fastener to tool' orientation problems, drives all diameter and grip accommodations
- Patented roller bearing drive system allows faster installation and removal
- A lightweight and compact tool with adjustable clamping loads from 100 to 600 lbs.



W500-30-931

Part No.	Description
CBHT-01	Manual Installation & Removal Tool
W500-30-931	Pneumatic Installation & Removal Tool

CYLINDRICAL BODY TEMPORARY FASTENERS

- Lightweight and efficient fasteners with a unique cylindrical design
- Longer lasting reusability with a maximum 100 lbs. clamping pressure
- Larger diameter available
- Metric sizes available; please inquire



CBXL

Hole Diameter	Part No. Standard	Grip Range	Color Code	Drill Size
3/32"	CBX-3/32	0" - 1/2"	Zinc	#40
	CBXL-3/32	1/2" - 1"		
	CBXEL-3/32	1/2" - 1-1/2"		
1/8"	CBX-1/8	0" - 1/2"	Copper	#30
	CBXL-1/8	1/2" - 1"		
	CBXEL-1/8	1/2" - 1-1/2"		
	CBXK-1/8	2" - 2-1/2"		
5/32"	CBX-5/32	0" - 1/2"	Black	#20
	CBXL-5/32	1/2" - 1"		
	CBXEL-5/32	1/2" - 1-1/2"		
	CBXK-5/32	2" - 2-1/2"		
3/16"	CBX-3/16	0" - 1/2"	Brass	#10
	CBXL-3/16	1/2" - 1"		
	CBXEL-3/16	1/2" - 1-1/2"		
	CBXK-3/16	2" - 2-1/2"		
7/32"	CBX-7/32	0" - 1/2"	Zinc	#2
	CBXL-7/32	1/2" - 1"		
	CBXEL-7/32	1/2" - 1-1/2"		
	CBXK-7/32	2" - 2-1/2"		
1/4"	CBX-1/4	0" - 1/2"	Copper	F
	CBXL-1/4	1/2" - 1"		
	CBXEL-1/4	1/2" - 1-1/2"		
	CBXK-1/4	2" - 2-1/2"		