

# 4°TempShell Element and Frame

Ordernumber: A 1000 29uk / A 1000 30uk



4 °C  
(+/-2) °C

Sealing  
possible



LCD-thermometer  
indicates actual  
temperature

## Ideal for medications and biologicals

Dimensions of one pair of  
4°TempShell elements :

Outer: 270 x 155 x 65\* mm

Inner: 210 x 110 x 30\* mm

\* Every add. frame increase size by 30 mm

Weight approx.: 800g

- designed to transport medication, erythrocytes, samples, etc
- liquid crystal thermometer indicates actual temperature
- create various inner volumes
- constant temperature for long terms (depending on insulation)
- protects your product against freezing, avoiding damage to the product (e.g. lysis).

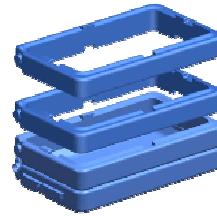

### MODULAR PASSIVE SYSTEM

Create different volumes using delta T's 4°TempShell Frames to transport multiple blood bags, organs, biologicals, medication and pharmaceuticals.

### APPLICATION

For the transportation and storage of samples, blood products, cell cultures, stem cells antibodies, proteins and temperature sensitive medications.

The 4°TempShell should always be used in conjunction with an insulated transporter i.e. the **MonoTripleBox**, **MiniVaqBox**, or the **SilverBag series**, 10l, 16l, 30l



### GUARANTEED PROTECTION DURING STORAGE AND TRANSPORTATION

Whatever the climate, may it be tropical or arctic, be ensured that the 4°TempShell element will maintain a temperature between 2-8°C.

Thanks to the 4°TempShell, your products can be transported for hours or even days.

The 4°TempShell must simply be pre-cooled to the required temperature. Once pre-cooled, the fluid will have solidified which can easily be seen through the transparent casing.

Also available as 4°element  
order no.:

<b>200ml</b>	A 1000 25 uk
<b>1 L</b>	A 1000 27 uk
<b>3 L</b>	A 1000 28 uk

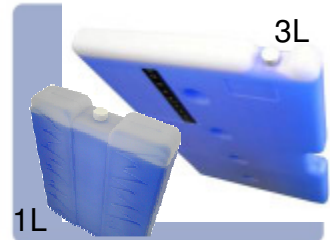

delta T GmbH  
Kerkraider Str. 11  
D-35394 Gassen

email: info@deltaT.de  
For: ++49/6 41/4 80 92- 40  
Fax: ++49/6 41/4 80 92- 42