

# Product Information

Dirt strainer, DN 17



**A.u.K. Müller**

Solenoid valves  
Control valves  
Special valves and systems

A.u.K. Müller GmbH & Co. KG  
Dresdener Str. 162  
D-40595 Düsseldorf/Germany

Tel.: +49(0)211-7391-0  
Fax: +49(0)211-7391-281

e-mail: [info@akmueller.de](mailto:info@akmueller.de)  
Internet: [www.akmueller.de](http://www.akmueller.de)

**Series I2.017.800**



## Characteristics

- Three-stage filter insert
- Two-stage filter also available
- Filter inserts are replaceable



## Applications

- Drinking water supplies
- Filter insert for servo controlled valves inlet of 3/4" BSP / 19 mm internal diameter

## Description

The three-stage dirt strainer combines three consecutively arranged filters of different mesh sizes in one housing.

It ensures coarse, medium and small particles are filtered out of the flowing medium.

The large filter area allows for a high flow rate, despite the smallest filter mesh size being just 0,2 mm.

The dirt strainer is available with G 3/4 male or female thread allowing easy integration in existing applications.

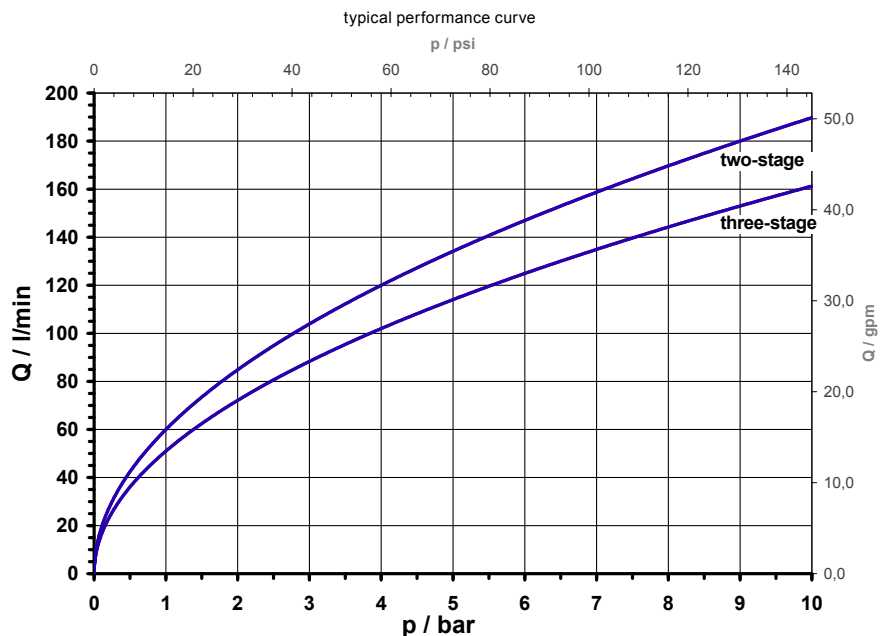



**Series I2.017.800**

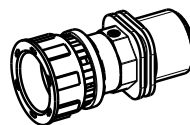
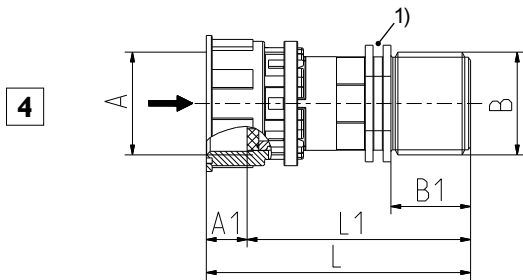
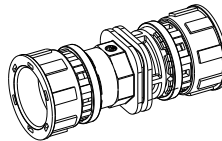
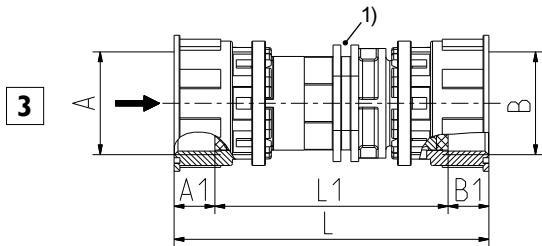
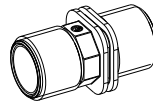
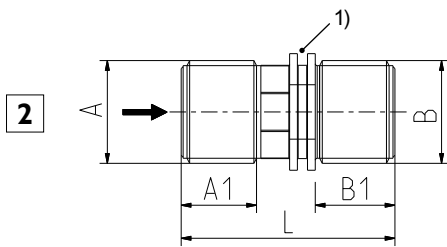
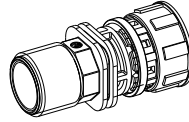
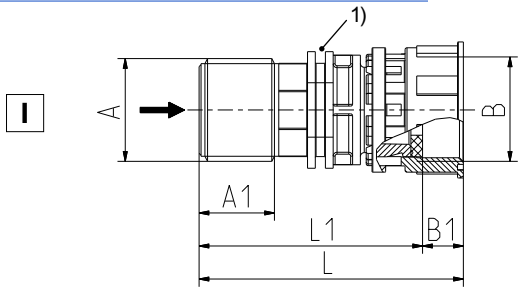

1) Groove for flange

**Technical Data**

Type	Dirt strainer	
Construction	mechanical three-stage filter optional two-stage filter	
Fitting position	any	
Media	cold and heated potable water and physically and chemically similar media	
T-Medium	90	°C max.
DN	17	mm
p-Operating	10	bar max.
Cv-value three-stage	51	l/min
two-stage	60	l/min

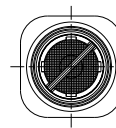
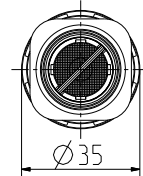

**Materials**

Socket	PA 66 glass fibre reinforced	
Socket of filter stack	PPE	
Filter	stainless steel	
Mesh sizes	0,5 mm	
	0,315 mm	
	0,2 mm	
Seal	EPDM	
	1, 3, 4	

**Options**

Type	ID	Material	Inlet			Outlet		Length
			Ø A	A1	L1	Ø B	B1	
1	092450	PA 66	G 3/4	20,0	57,5	G 3/4 female gland nut	10,0	68,0
2	092451	PA 66	G 3/4	20,0	-	G 3/4	20,0	55,0
3	092452	PA 66	G 3/4 female gland nut	20,0	60	G 3/4 female gland nut	10,0	81,0
4	092453	PA 66	G 3/4 female gland nut	20,0	57,5	G 3/4	20,0	68,0

Three-stage filter staple Version | Two-stage filter staple on request



1) Optional: flange ID: 001245



### Series I2.017.800

#### Filter staple assembly - three stage ID: 008829

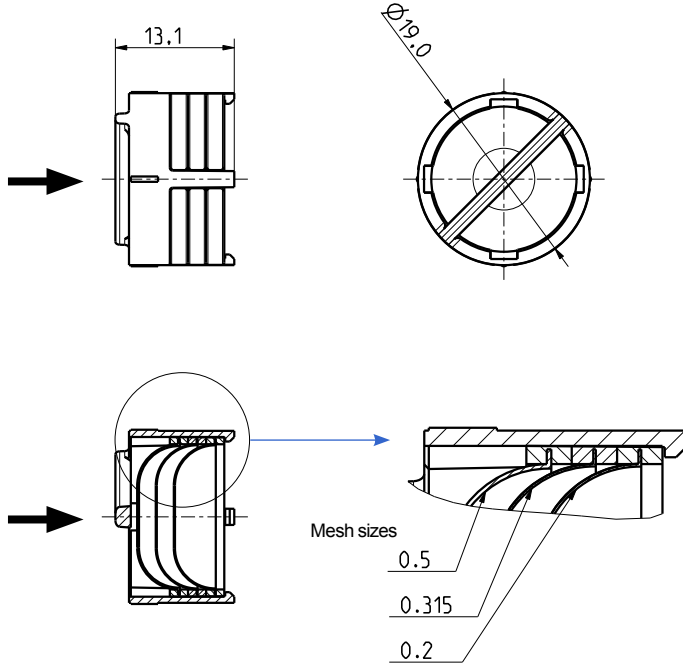

Three-stage filter staple in inlet of valve G 3/4  
 Ø19 inner diameter.  
 (e.g. 01.010.126)

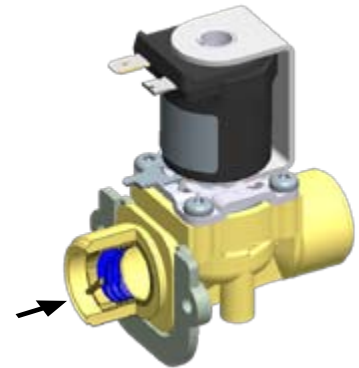

A 0.2 mm mesh size is not recommended for use in hot water applications in hard water areas. The increased levels of lime scale present in the medium may cause the filter to become clogged quickly.

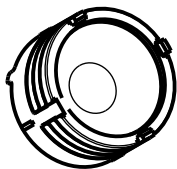

#### Filter staple assembly - two stage ID: 008828

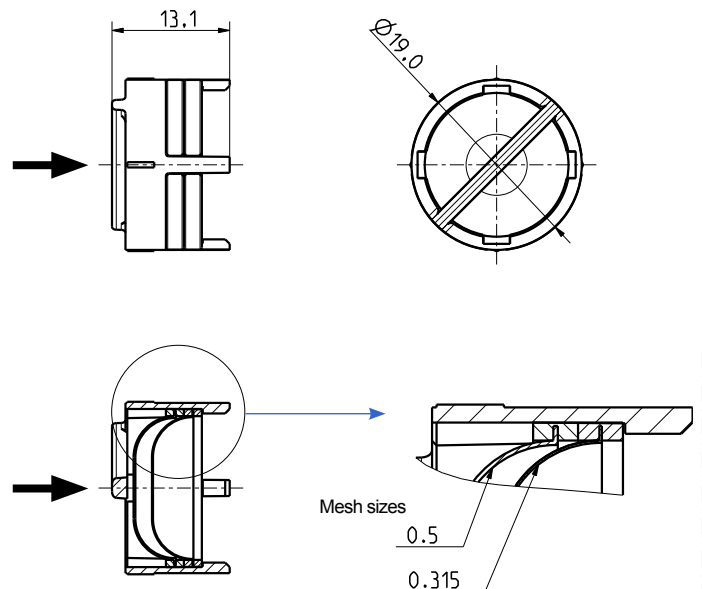

Two-stage filter staple in inlet of valve G 3/4  
 Ø19 inner diameter.  
 (e.g. 01.010.126)

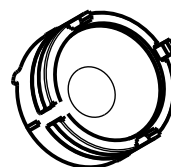
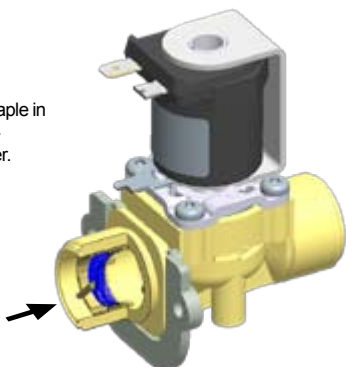



Series I2.017.800

Replacement the filter staple

 Only pull  
Do not twist

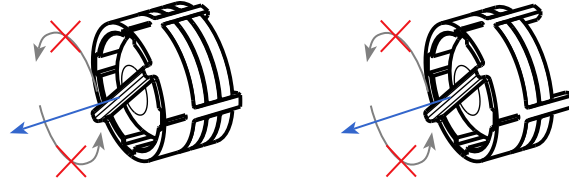

Filter insert detail

