

September 2013

Rooflights & Glazing

Flat Glass Bespoke Glass Rooflights

'Natural Daylight supplied here'



Rooflights & Glazing UK Ltd, Unit 5 Ironbridge Ind Est, 397 Retford Road, Sheffield, S13 9WA. Company Registration: 05694006
Tel: 0114 4081000 Fax: 0114 2385511 Website: www.rooflightsandglazing.co.uk Email: sales@rooflightsandglazing.co.uk



Flat Glass Bespoke Glass Rooflights

Tel: 0114 4081000
Fax: 0114 2385511

Flat Glass Bespoke Glass Rooflights

Outstanding **aesthetics** – from both external and internal viewpoints

Can be supplied in virtually any shape, including square, rectangular, circular, elliptical, triangular, hexagonal, octagonal and irregular shapes

Single or multiple **double** or **triple** glazed units can be contained within a single frame to cater for a wide range of sizes made to order.

Non-fragile, CWCT and ACR compliant.



Double & triple glazed single pane units

Flat Glass Bespoke rooflights can be supplied in a wide range of sizes and configurations. Maximum standard sizes for rooflights using a single glazing pane are:

- 2.2m x 2.2m square
- 1.6m x 3.0m rectangular
- 2.3m diameter circular/elliptical

Larger sizes can be accommodated by utilising multiple glazing panes. These can be configured with or without transoms/glazing bars, depending on the design of the rooflight.



Double and triple glazed multi-pane rooflights for larger configurations

Where larger rooflights are required, over and above single maximum pane sizes, we can supply multi-section Flat Glass Rooflights. These provide the same characteristics and sleek profile as the single pane units and can be configured with or without transoms/glazing bars. Maximum spans up to 5.0m can be accommodated. There is no limit on the length of the rooflight. Bay centres depend on span width.

Standard Flat Glass specification

Double glazed units

6/8mm clear toughened outer
16/18mm argon filled cavity
6.8/8.8mm **LOW E** laminated inner

Triple glazed units

6mm clear toughened outer
16mm argon filled cavity
6mm toughened middle
16mm argon filled cavity
6.8mm **LOW E** laminated inner



All outer panes have sandblasted borders for improved aesthetics. In addition to the above standard specification, glazing can be tailored to meet specific requirements – please contact our sales office for details.

Frame specification

Glazing elements are contained within a **thermally enhanced**, welded aluminium frame, for installation to a builders' curb. All frames are polyester powder coated to the **standard RAL colour range** (see page 4)

Thermal Value

Total product U-values for double glazed Flatglaze Bespoke rooflights are as low as **1.4 W/m²k**, exceeding the requirement for Part L compliance. Triple glazed units achieve total product U-values as low as **1.2W/m²k**.

Non Fragility

All units have been independently tested and provide non-fragility to CWCT Class 2 / ACR[M] Class B compliance.



Popular shapes for Flat Glass rooflights

Flat Glass Bespoke rooflights can be specified in virtually any shape.

Popular options are:

Square; Rectangular; Circular; Elliptical; Triangular, Hexagonal, Octagonal, Trapezoidal & Irregular.

Other special configurations can be designed to order. See our shape chart to the right.

Glazing

In addition to the standard glazing specification as listed on page 2, glazing can be specified as: tinted; solar control; dirt resistant; obscured; toughened inner glazing panes; as well as a wide range of other options. Glazing can be tailored to meet specific requirements – please contact our sales office for details.

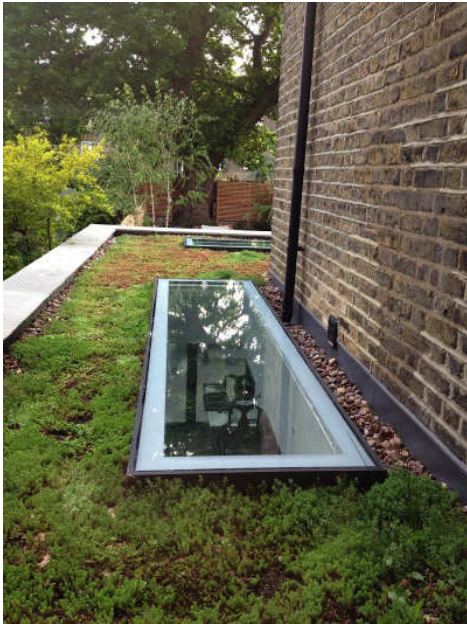

Frame finish

Flat Glass aluminium frames are polyester powder coated in our **standard RAL colours**;

- Jet Black: RAL 9005
- Pure White: RAL 9010
- Slate Grey: RAL 7015

Wall abutment

Flat Glass Bespoke rooflights can be designed to accommodate wall abutment on up to three sides if required.

Walk-on units

Single-pane Flat Glass Bespoke rooflights can be supplied to walk-on specification in square and rectangular shapes up to a maximum area of 3m² or 1.7m x 1.7m; and as circular units up to 2m diameter. Square, Rectangular & Circular.

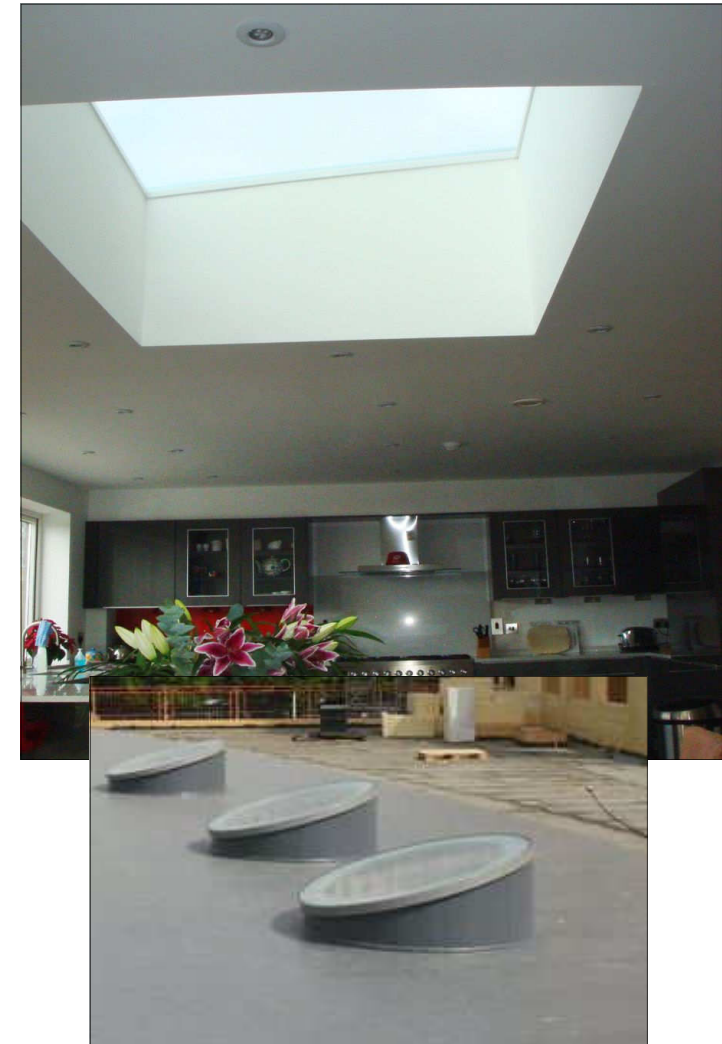

Flat Glass Bespoke Rooflights

Practical designs, high quality components Flat Glass Bespoke rooflights are designed to provide high performance and long service life in a package that's practical, cost-effective and easy to install Shown opposite are some typical configurations.

Installation

Flat Glass rooflights are suitable for use with all popular flat roof finishes. They are designed for installation to a timber kerb to the specifications outlined below.

Builders' kerbs

Kerbs should be installed with a minimum recommended pitch of 5°. A nominal thickness of 75mm is recommended for fixed units.

Delivery

Standard Flat Glass rooflights are manufactured to order – 3 to 4 weeks delivery. Will be longer for special requirements - Please check.

Specifying rooflight size

When fitting to a builder's curb, each Flat Glass unit is bespoke and manufactured to customers' exact requirements. All dimensions provided to LRC should be External and/or internal. (See diagram).

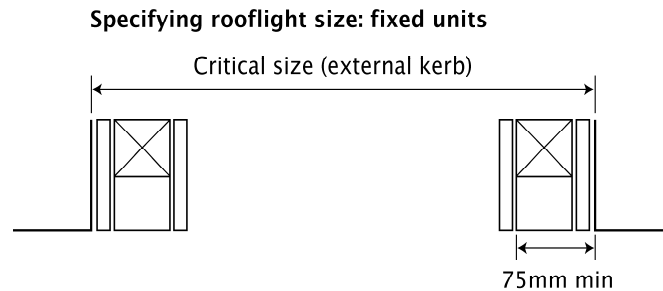

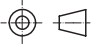

Flat Glass Double Glazed Fixed Option

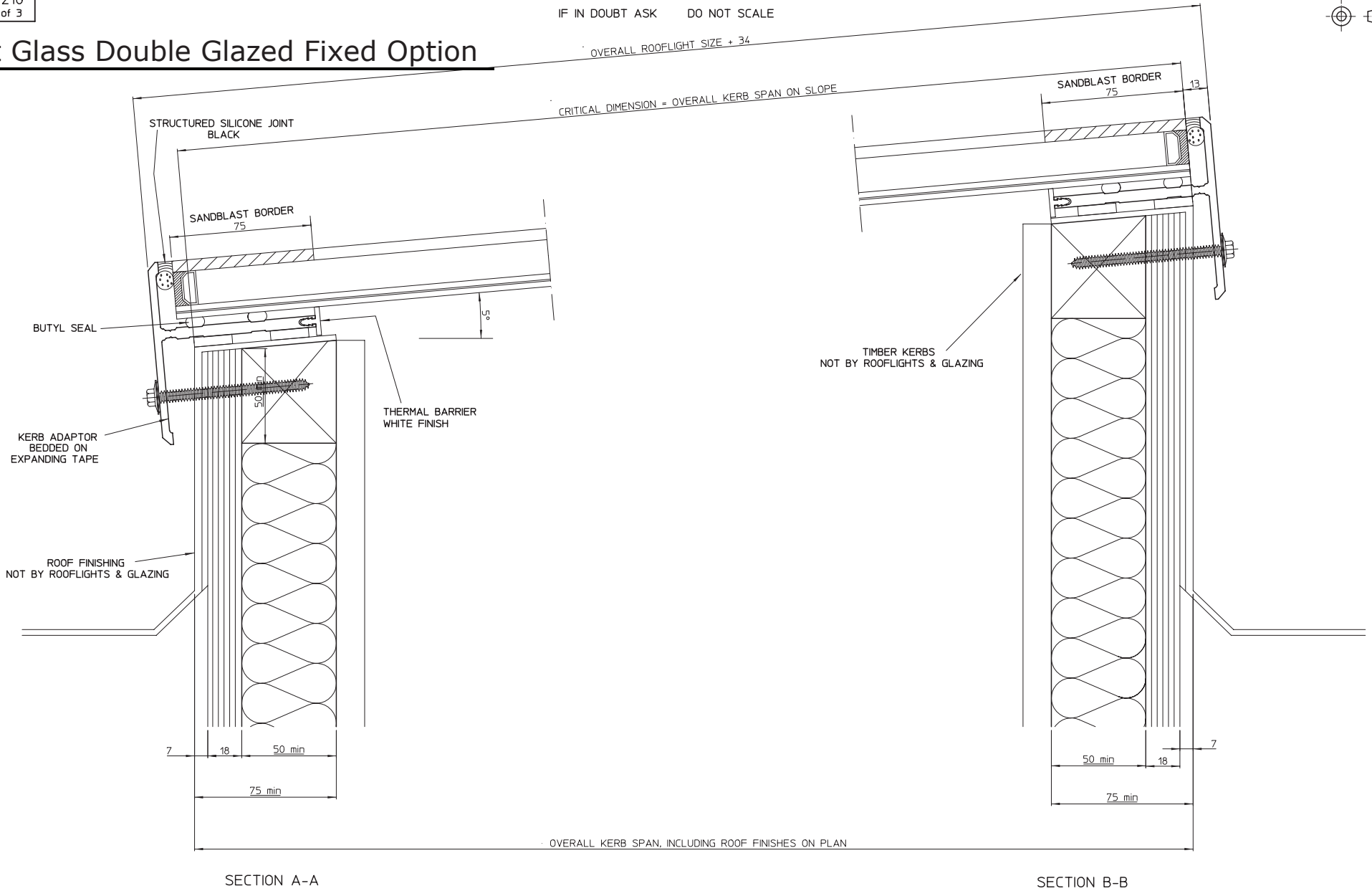

SECTION A-A

SECTION B-B

| | | | | | | | | | | | | | |
|---|---------|-----------------------------------|-------|----------|---|---|--|-------------|--------------|------------|--------|---------|------|
| THIS DRAWING MUST NOT BE COPIED OR PASSED TO A THIRD PARTY WITHOUT WRITTEN CONSENT FROM ROOFLIGHTS AND GLAZING LIMITED. | CHECKED | TOLERANCE UNLESS OTHERWISE STATED | +5 | MATERIAL | GLASS ALUMINIUM | Unit 5, Ironbridge Industrial Estate, 397 Reifford Road, Sheffield, South Yorkshire, S13 9WA Tel: 0114 408 1000 • Fax: 0114 238 5511 • E-mail: sales@rooflightsglazing.co.uk | ROOFLIGHTS & GLAZING UK LTD | | | | | | |
| | DATE | DIMENSIONS IN | MM | FINISH | POLYESTER POWDER COATING, RAL COLOUR 7016 70% GLOSS | | | | | | | | |
| | DRAWN | D. PUGH | SCALE | 1:1 @ A1 | REV | | | | | AMENDMENTS | SIGNED | CHECKED | DATE |
| | DATE | 4-11-2011 | | | | | | | | | | | |
| | | | | | | TITLE: | QUOTE N°: | DRAWING N°: | REV | | | | |
| | | | | | | | A1 | RG-80-210 | SHEET 2 of 3 | | | | |

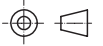

Flat Glass Double Glazed Fixed Option

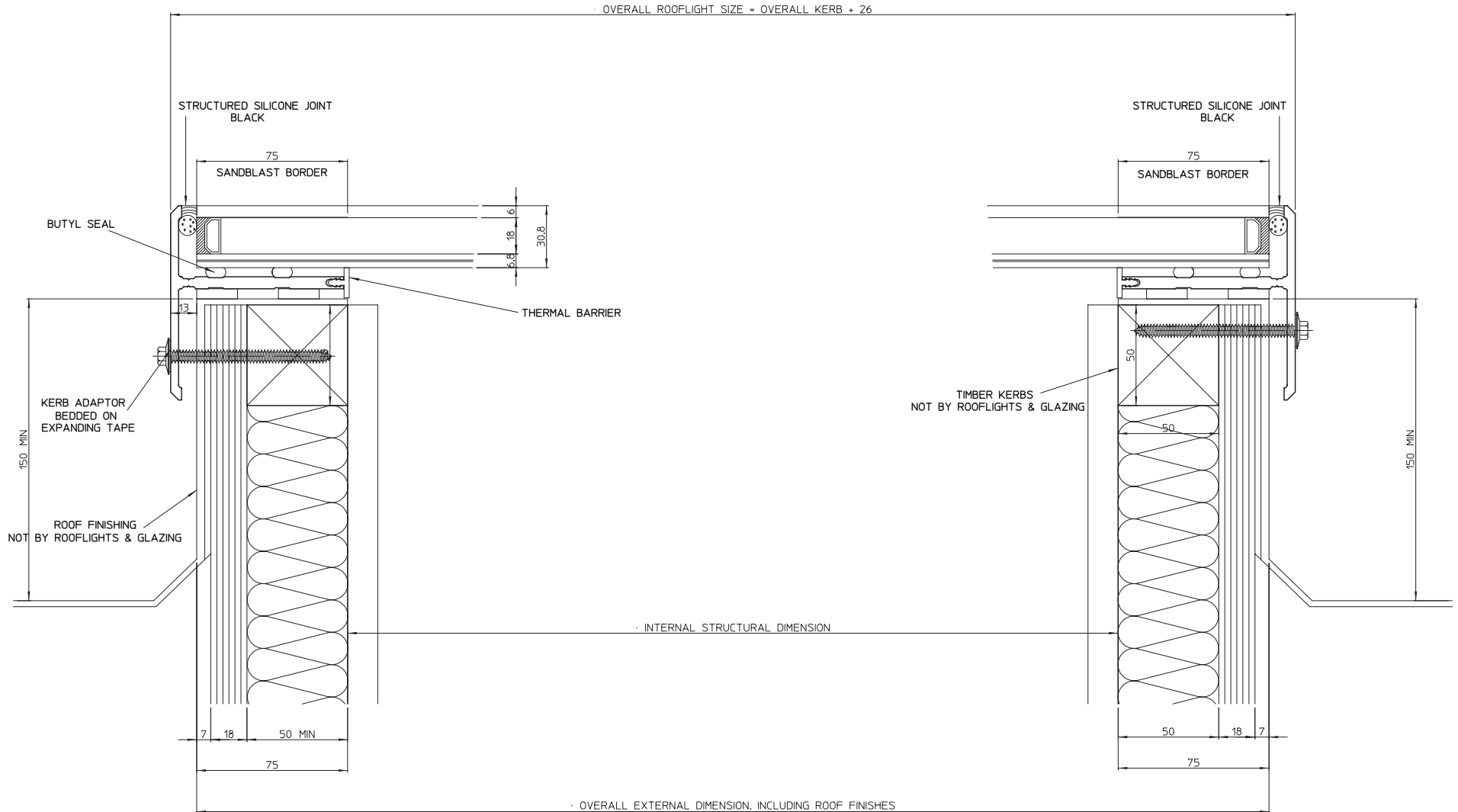

SECTION C-C

SECTION D-D

| | | | | | | | | | | |
|---|-----------|-----------------------------------|--|---|------------|--------|---------|----------|---|-----|
| THIS DRAWING MUST NOT BE COPIED OR PASSED TO A THIRD PARTY WITHOUT WRITTEN CONSENT FROM ROOFLIGHTS AND GLAZING LIMITED. | CHECKED | TOLERANCE UNLESS OTHERWISE STATED | MATERIAL | Unit 5, Ironbridge Industrial Estate, 397 Reford Road, Sheffield, South Yorkshire, S13 9WA Tel: 0114 408 1000 • Fax: 0114 238 5511 • E-mail: sales@rooflightsglazing.co.uk | | | A1 | QUOTE N° | DRAWING N° RG-80-210 SHEET 3 of 3 | REV |
| | DATE | DIMENSIONS IN | GLASS ALUMINIUM | ROOFLIGHTS & GLAZING UK LTD | | | | | | |
| | D. PUGH | MM | FINISH POLYESTER POWDER COATING, RAL COLOUR T.B.A. 70% GLOSS | TITLE: | | | | | | |
| DATE | 4-11-2011 | SCALE | 1:1 @ A1 | REV | AMENDMENTS | SIGNED | CHECKED | DATE | | |

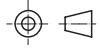

Flat Glass Triple Glazed Fixed Option

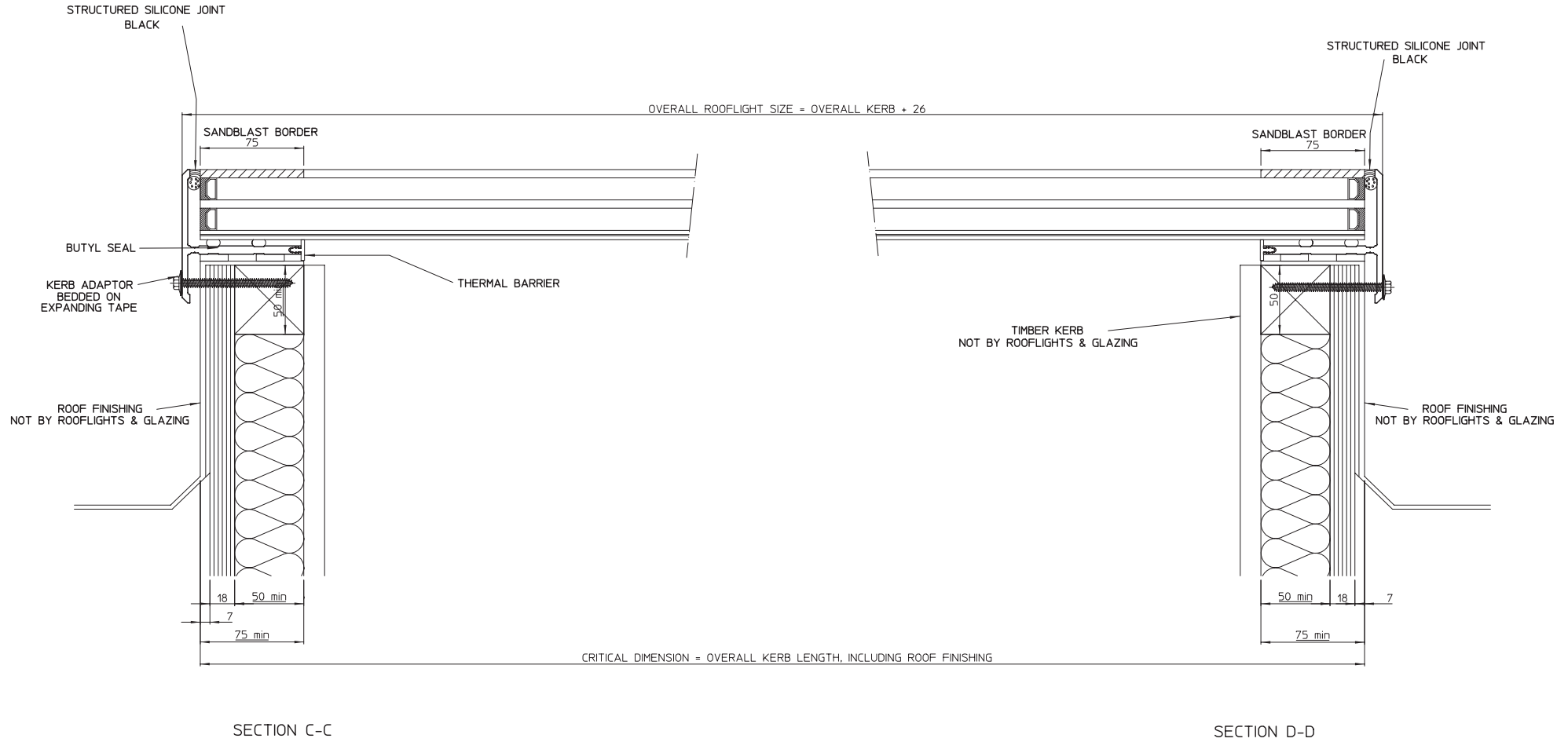

SECTION C-C

SECTION D-D

| | | | | | | |
|---|------------|-----------------------------------|--|--|-----------|--------------|
| THIS DRAWING MUST NOT BE COPIED OR PASSED TO A THIRD PARTY WITHOUT WRITTEN CONSENT FROM ROOFLIGHTS AND GLAZING LIMITED. | CHECKED | TOLERANCE UNLESS OTHERWISE STATED | MATERIAL | Unit 5, Ironbridge Industrial Estate, 397 Renford Road, Sheffield, South Yorkshire, S13 9WA ROOFLIGHTS & GLAZING UK LTD Tel: 0114 408 1000 • Fax: 0114 238 5511 • E-mail: sales@rooflightsglazing.co.uk | | |
| | DATE | ±5 | GLASS ALUMINIUM | | | |
| | DRAWN | DIMENSIONS IN | FINISH | | | |
| | R. PADDICK | MM | POLYESTER POWDER COATING COLOUR T.B.A. | | | |
| DATE | SCALE | | | TITLE: | QUOTE NO. | DRAWING NO. |
| 13-Oct-2010 | 1:15 @ A1 | | | | | RG-80-210 |
| | | | | | | SHEET 3 OF 3 |
| | REV | AMENDMENTS | SIGNED | CHECKED | DATE | |