

Grade 80 "Economy" Clevis Grab Hooks

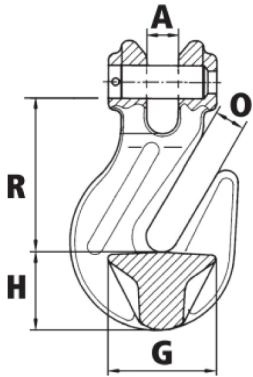

- Grade 80 alloy steel.
- Painted finish.
- Marked with manufacturers mark/ID, grade 8, size and part number.
- Minimum breaking load is 4 x W.L.L, proof load is 2 x W.L.L.

code	chain dia. (mm)	A (mm)	O (mm)	H (mm)	R (mm)	G (mm)	W.L.L (tonnes)	weight (kgs/each)
K1751	7/8	10	9.5	23	65.3	30	2	0.30
K1752	10	12.7	13	31	82	44	3.15	0.65
K1753	13	16.5	16.5	43	113	56	5.3	1.70
K1754	16	20	20	49	129.5	71	8	2.50



Grade 80 "Economy" Eye Type Grab Hooks



- Grade 80 alloy steel.
- Painted finish.
- Marked with manufacturers mark/ID, grade 8, size and part number.
- Minimum breaking load is 4 x W.L.L, proof load is 2 x W.L.L.
- Spare safety catch kits available.

code	chain dia. (mm)	O (mm)	F (mm)	H (mm)	R (mm)	G (mm)	W.L.L (tonnes)	weight (kgs/each)
K1701	7/8	10	15	23	64	30	2	0.27
K1702	10	13	20.5	30	82	44	3.15	0.56
K1703	13	16.5	25	42	106	56	5.3	1.38
K1704	16	18	29	45	114	71	8	2.27

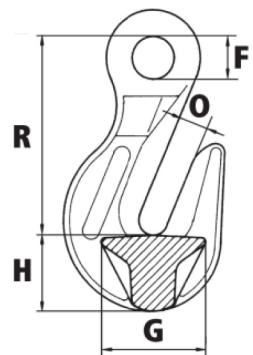

NEVER EXCEED MAXIMUM CAPACITY

Ensure operator follows safe use instruction guidelines