

Technical data sheet

Type 337

Foot valve
System MI

Applications and special features



- Operates in any position
- Low head loss
- Does not generate hammering
- Closing system : EPDM tubular membrane collapsing towards the center of strainer at the intake
- Sealing guaranteed by the flexible membrane against the machined internal part of the casing
- On membrane check valves, the opening regulated by the elasticity and the thickness of the membrane is very progressive and can be obtained as a result of a few centimeters of W/C. Because of this, this check valve is particularly suitable for variable flow pumps and pulsatory operation.

Technical description

DN	PFA in bar	PS in bar				Cat.	References	Vvs-nr
		L1	L2	G1	G2			
2	50	6	6	x	x	3.3	149B 2572	
2 ^{1/2}	65	6	6	x	x	3.3	149B 2574	
3	80	6	6	x	x	3.3	149B 2575	
4	100	6	6	x	x	3.3	149B 2577	

Important notice :

The indicated pressure for the different categories of fluids (L1/L2/G1/G2) is under no condition a guarantee of use. Therefore, it is essential to validate the use of products under given operating conditions. The operating instructions are available on our web site www.danfoss-socla.com or by requesting from our sales department.

- **Connection** : Female (BSP).
- **Permissible operating pressure PFA - water-** (for supply, distribution and disposal of water) : See table
- **Maximum permissible pressure PS - other mediums:** See table
- **T° :** Mini. 0 °C
Maxi. 60 °C
- **Mediums :** Clear liquids, dirty and sandy liquids
- **Approvals :** ACS (France)
- **Normes construction internationales :**
Directive 97/23/CE
Thread connection NF E 03-005 ISO 228

Overall dimensions

	A	B	C	Weight
“	mm	mm	mm	kg
2	50	160	86	1,5
2 ^{1/2}	65	190	116	2,7
3	80	206	131	3,1
4	100	231	144	4,2

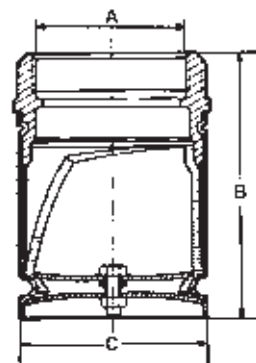

Technical data sheet Type 337 - Foot valve

Spare parts list and materials

Nb	Description	Materials	EURO	ANSI
1	CASING	Cast iron + epoxy	EN-GJL-250	ASTM A 48 35 B
2	MEMBRANE	EPDM		
3	STRAINER	Galvanised steel		
4	SCREW AND NUTS	Galvanised steel		
5	NUT	Galvanised steel		
6	PLATE	Galvanised steel		

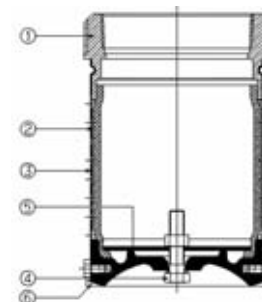

Working principle

DN		Opening pressure in mm/WC	Kv	ζ
"	mm			
2	50	Near 0	113,00	0,77
2 ^{1/2}	65		191,00	0,77
3	80		221,00	0,77
4	100		289,00	0,77

Direction for use :

- Solid line : Valve completely open
- Dotted line : opening stage of valve

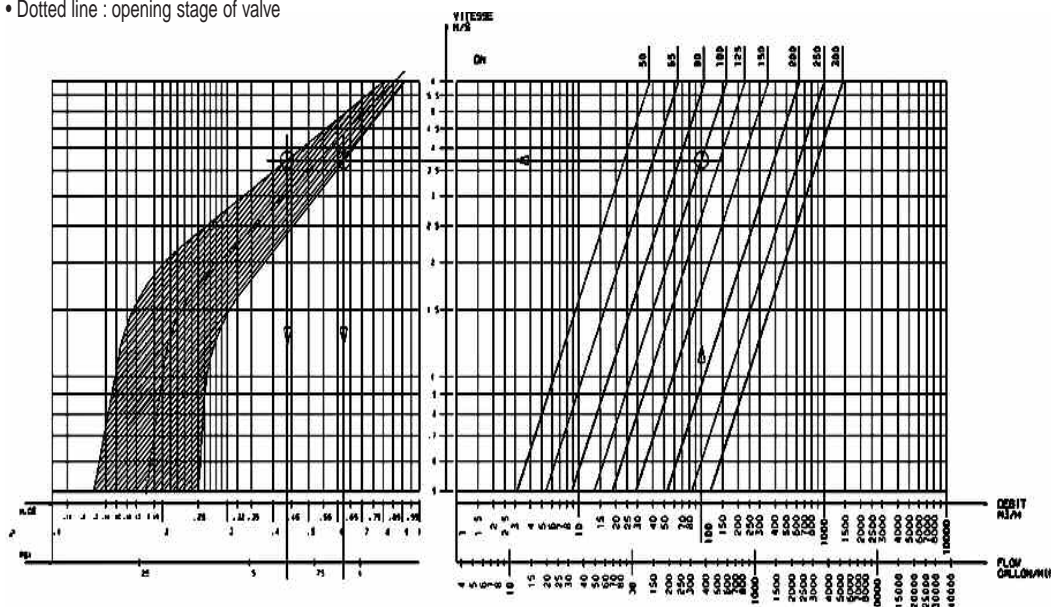

Calculation example :

Check valve DN100 : flow 100 m³/H
Headloss between 0,44 and 0,62 m.CE

Danfoss can accept no responsibility for possible errors in catalogue, brochures and other printed material. Danfoss reserve the right to alter its products without notice. This also applies to products already agreed. All trademarks in this material are the property of the respective companies. Danfoss and the logo type are trademarks of Danfoss A/S. All right reserved.