

# s95.2 tree planter



## description

Aluminium planter with powder coated finish and galvanized steel base. Rim in brushed stainless steel.

## dimensions

Various size options available.

## options

Choice of colours.

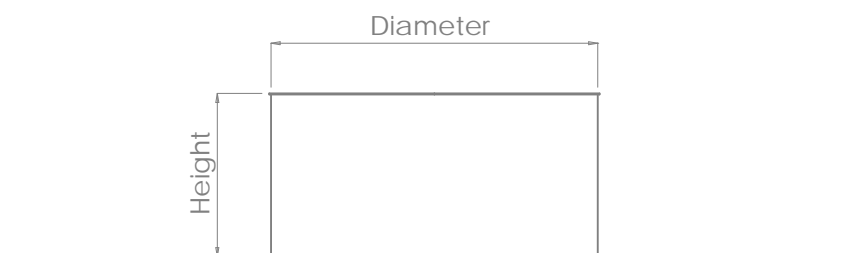
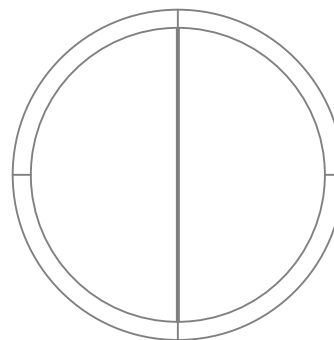

# s95.2 Care and Maintenance Guidelines

The s95.2 planter is constructed from powder coated aluminium with a brushed stainless steel rim. These materials have been selected for their excellent outdoor durability as well as their aesthetic properties.

Some care is required to maintain the product's original appearance. The extent to which maintenance is required will depend on a number of factors including environmental conditions, construction activity and level of use.

## Maintaining the painted aluminium

The s95.2 is finished in polyester powder, a plastic coating which is baked onto the components prior to assembly. This is a highly durable finish which will last for many years. To maintain the original appearance of the metalwork it should be cleaned regularly using warm soapy water.

Avoid the use of abrasive cleaners as they may damage the surface finish. Should the paint become chipped or scratched it can be touched up using acrylic based paint.

Where the surface becomes damaged clean with a wire brush or sand, then paint with a spirit or synthetic based top coat. For further advice contact Omos on + 353 45 899802.

## Maintaining the stainless steel surface

Prior to shipping all our stainless steel has been passivated to ASTM A380 and ASTM 976 01-8.1 to ensure the highest standard.

Clean the stainless steel rim using warm water with a mild detergent with a non abrasive cloth or sponge. Heavier stains may require the use of a nylon scouring pad. As a rule always start with the least severe method of cleaning as the use of scouring pads or scotch bright may result in altering the surface texture. In the case of brushed finishes the surface consists of uniform fine 'scratches' running in one direction so where abrasive cleaning is required always use a straight back and forward rubbing action in the direction of the grain.

Rust spots or 'tea stains' can occur on the surface of the material, these are normally caused by contamination from ordinary mild steel, particular in areas where construction work has been undertaken. Such stains can be removed using an abrasive pad as described above.

In cases where the surface is severely stained as a result of severe environmental conditions or scratched due to misuse, it may still be possible to restore the original finish. Contact Omos for advice on such issues.

There are many stainless steel polishes available to enhance the surface finish. Omos recommends 'Avesta Finishing chemicals' and can advise where to purchase.

**Above right,** s95.2 tree planters in powder coated aluminium with stainless steel rim.

