

# Solid & Clamp Type Collars

(tolerance & dimensions can differ from standard) Clamp Type Dimensions available via the product web pages

Please note  $d1$ ,  $d2$ ,  $b$  and set screw dimensions & tolerances may differ from the standard due to material sourcing, Please ask for details at enquiry stage

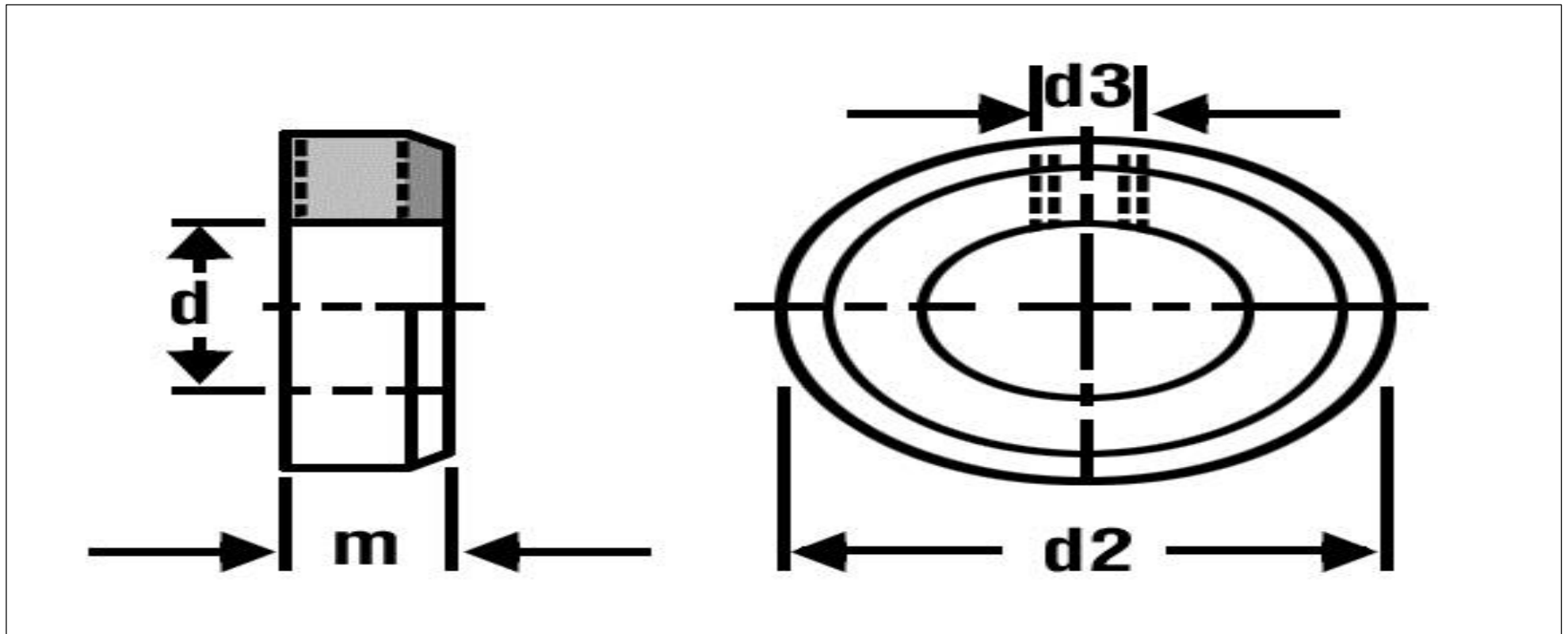

# Solid & Clamp Type Collars

(tolerance & dimensions can differ from standard) Clamp Type Dimensions available via the product web pages

## ENGINEERS Shaft Collars ( Imperial) – BS4185 Part2 1967 – Mild Steel and Stainless Steel A2 & A4

I/D d (H7)	1/4	5/16	3/8	7/16	1/2	9/16	5/8	11/16	3/4	13/16	7/8	15/16	1"	1.1/8	1.1/4	1.3/8
<b>H7</b>	0.0006			0.0007						0.0008				0.001		
	0			0						0				0		
O/D d2 (h14)	5/8	11/16	3/4	7/8	1"	1"	1.1/8	1.1/4	1.1/4	1.3/8	1.1/2	1.5/8	1.5/8	1.3/4	2"	2.1/8
<b>h14</b>	0			0						0				0		
	-0.16			-0.02						-0.025				-0.03		
Width m <b>+0 -0.010</b>	5/16	5/16	3/8	7/16	7/16	1/2	1/2	9/16	9/16	9/16	9/16	5/8	5/8	5/8	3/4	3/4
Set Screw d3	2BA	2BA	1/4BSW	1/4BSW	1/4BSW	1/4BSW	1/4BSW	5/16BSW	5/16BSW	5/16BSW	5/16BSW	5/16BSW	5/16BSW	5/16BSW	3/8BSW	3/8BSW

Please note d1, d2, b, and set screw dimensions & tolerances may differ from the standard due to material sourcing please ask for details at enquiry stage

I/D d (H7)	1.1/2	1.5/8	1.3/4	1.7/8	2"	2.1/8	2.1/4	2.3/8	2.1/2	2.5/8	2.3/4	2.7/8	3"	3.1/4	3.3/8	3.1/2
<b>H7</b>	0.001			0.0012						0.0014						
	0			0						0						
O/D d2 (h14)	2.1/4	2.1/2	2.3/4	3"	3"	3.1/4	3.1/4	3.1/2	3.1/2	3.3/4	3.3/4	4.1/4	4.1/4	4.1/2	4.3/4	4.3/4
<b>h14</b>	0			0						0						
	-0.03			-0.035						-0.04						
Width m <b>+0 -0.010</b>	3/4	3/4	7/8	7/8	7/8	7/8	1"	1"	1"	1.1/8	1.1/8	1.1/8	1.1/8	1.1/4	1.1/4	1.1/4
Set Screw d3	3/8BSW	3/8BSW	1/2BSW	1/2BSW	1/2BSW	1/2BSW	1/2BSW	1/2BSW	1/2BSW	1/2BSW	1/2BSW	1/2BSW	1/2BSW	1/2BSW	1/2BSW	1/2BSW
I/D d (H7)	3.3/4	4"														
<b>H7</b>	0.0014															
	0															
O/D d2 (h14)	5"	5.1/4														
<b>h14</b>	0															
	-0.04															
Width m <b>+0 -0.010</b>	1.1/4	1.1/4														
Set Screw d3	1/2BSW	1/2BSW														

Please note d1, d2, b, and set screw dimensions & tolerances may differ from the standard due to material sourcing please ask for details at enquiry stage

# Solid & Clamp Type Collars

(tolerance & dimensions can differ from standard) Clamp Type Dimensions available via the product web pages

## ENGINEERS Shaft Collars ( Metric ) – DIN705 – EN1A (230M07) EN3B (Welding) 9SMnPb28 and Stainless Steel A2, A4

I/D d (H8)	3mm	4mm	5mm	6mm	7mm	8mm	9mm	10mm	11mm	12mm	13mm	14mm	15mm	16mm	18mm	20mm
<b>H8</b>	+0.014	+0.018		+0.022				+0.027				+0.033				
	-0.00	-0.00		-0.00				-0.00				-0.00				
O/D d2 (h13)	7mm	8mm	10mm	12mm	12mm	16mm	18mm	20mm	20mm	22mm	22mm	25mm	25mm	28mm	32mm	32mm
<b>h13</b>	+0.00		+0.00				+0.00				+0.00					
	-0.22		-0.27				-0.33				-0.39					
Width m js14	5mm	5mm	6mm	8mm	8mm	8mm	10mm	10mm	10mm	12mm	12mm	12mm	12mm	12mm	14mm	14mm
	±0.150			±0.180					±0.215							
Set Screw d3	M2	M2.5	M3	M4	M4	M4	M5	M5	M5	M6	M6	M6	M6	M6	M6	M6

I/D d (H8)	22mm	24mm	25mm	26mm	28mm	30mm	32mm	34mm	35mm	36mm	38mm	40mm	42mm	45mm	48mm	50mm
<b>H8</b>	+0.033															
	-0.00															
O/D d2 (h13)	36mm	40mm	40mm	40mm	45mm	45mm	50mm	50mm	56mm	56mm	56mm	63mm	63mm	70mm	70mm	80mm
<b>h13</b>	+0.00						+0.00									
	-0.39						-0.46									
Width m js14	14mm	16mm	16mm	16mm	16mm	16mm	16mm	16mm	16mm	16mm	16mm	18mm	18mm	18mm	18mm	18mm
	±0.215															
Set Screw d3	M6	M8	M8	M8	M8	M8	M8	M8	M8	M8	M8	M10	M10	M10	M10	M10

# Solid & Clamp Type Collars

(tolerance & dimensions can differ from standard) Clamp Type Dimensions available via the product web pages

ENGINEERS Shaft Collars ( Metric) – DIN705 – EN1A (230M07) EN3B (Welding) 9SMnPb28 and Stainless Steel A2, A4

I/D d (H8)	55mm	56mm	58mm	60mm	63mm	65mm	70mm	75mm	80mm	85mm	90mm	95mm	100mm
<b>H8</b>													
O/D d2 (h13)	80mm	80mm	90mm	90mm	90mm	100mm	100mm	110mm	110mm	125mm	125mm	140mm	140mm
<b>h13</b>	+0.00		+0.00						+0.00				
	-0.46		-0.54						-0.63				
Width m	18mm	18mm	20mm	20mm	20mm	20mm	20mm	22mm	22mm	22mm	22mm	25mm	25mm
js14	±0.215		±0.260										
Set Screw d3	M10	M10	M10	M10	M10	M10	M10	M12	M12	M12	M12	M12	M12

# Solid & Clamp Type Collars

(tolerance & dimensions can differ from standard) Clamp Type Dimensions available via the product web pages

## ENGINEERS Shaft Collars ( Metric ) – BS4185 Part2 1967 - Mild Steel and Stainless Steel A2, A4

I/D d (H7)	6mm	7mm	8mm	9mm	10mm	12mm	15mm	17mm	20mm	22mm	25mm	28mm	30mm	32mm	35mm	40mm
<b>H7</b>	0.012		0.015				0.018									
	0		0				0			0				0		
O/D d2 (h14)	16mm	16mm	16mm	20mm	20mm	25mm	28mm	28mm	32mm	32mm	40mm	45mm	45mm	55mm	55mm	65mm
<b>h14</b>	0		0				0			0				0		
	-0.43		-0.52				-0.62			-0.62				-0.74		
Width m <b>+0 - 0.25</b>	8mm	8mm	8mm	10mm	10mm	12mm	12mm	14mm	14mm	14mm	16mm	16mm	16mm	18mm	18mm	20mm
Set Screw d3	M4	M4	M4	M6	M6	M6	M6	M6	M6	M6	M8	M8	M8	M8	M8	M10
<b>Preferred Stock Range B.S. 4185 : Part 2 : 1967</b>																
Please note d1, d2, b, and set screw dimensions & tolerances may differ from the standard due to material sourcing please ask for details at enquiry stage																
I/D d (H7)	45mm	50mm	55mm	60mm	65mm	70mm	75mm	80mm	85mm	90mm	95mm	100mm				
<b>H7</b>	0.025		0.03				0.035									
	0		0				0			0				0		
O/D d2 (h14)	70mm	80mm	80mm	90mm	100mm	100mm	110mm	110mm	125mm	125mm	140mm	140mm				
<b>h14</b>	0		0				0			0						
	-0.74		-0.87				-1			-1						
Width m <b>+0 - 0.25</b>	20mm	20mm	20mm	22mm	22mm	22mm	25mm	25mm	25mm	25mm	25mm	25mm				
Set Screw d3	M10	M10	M10	M10	M10	M10	M12	M12	M12	M12	M12	M12				
<b>Preferred Stock Range B.S. 4185 : Part 2 : 1967</b>																
Please note d1, d2, b, and set screw dimensions & tolerances may differ from the standard due to material sourcing please ask for details at enquiry stage																