

Hygiene Board

Versatile Hygienic Lining Panels



Hygiene Board provides an easily installed and effective food safe finish in a variety of environments. The composite design comprises of 15mm plasterboard, covered with a 0.5mm steel facing, finished with a food safe laminate.

The panel face is specially engineered along the edges to form a male / female slip joint connection for positive location, and silicone sealant can be applied for a durable, easy to clean hygienic surface with excellent corrosion resistance.

Key Features

- Food safe finish
- Tongue and groove joints
- Quick and easy to install
- Self finished

Applications

- Food preparation areas
- Hospitals
- Research facilities / laboratories
- Commercial kitchens

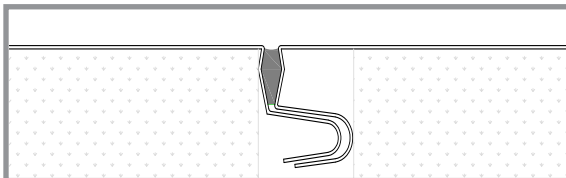

Panel Core & Finish

The panel core is 15mm plasterboard with a 0.5mm steel facing.

The standard panel finish is 120 micron white food safe laminate, however anti-static, stainless steel and 20 micron polyester finishes are also available.

If required 15mm fire rated plasterboard can also be supplied.

Panel Fixing

Panels are suitable for use as dry lining or as a stud fix, and can also be fitted with top and bottom fixing channels where required.

Panels fit together simply with an interlocking male / female slip joint, providing a flush finish with a 2-3mm gap for silicone sealing.

Dimensions & Weight

| | |
|---------------------------|------------------------|
| Thickness | 15.5mm |
| Weight | 18.9 kg/m ² |
| Maximum Dimensions | 1160mm x 3000mm |

Based on standard 15mm plasterboard with 0.5mm steel facing and food safe laminate finish.

Additional Panel Options

- Anti-static food safe laminate finish
- Stainless steel finish
- Polyester RAL 9010 finish
- Powder coated finish in any standard RAL colour
- Fire rated plasterboard
- 0.5mm galvanised steel backer with wash coat

A full range of complimentary trims and accessories are also available.