

Rencol

COMPONENTS

INDUSTRIAL MANUFACTURING SINCE 1923



Rencol

COMPONENTS

INDUSTRIAL MANUFACTURING
SINCE 1923

Rencol's flexible manufacturing capabilities, engineering expertise, global supply chain and market knowledge allow us to develop cost-effective product solutions that exceed our customers' expectations.

Who we are

In the early twentieth century Rencol developed engineered plastic solutions ranging from electric car batteries and recharging stations to the plastic "Joylight" internal combustion engine.

By the 1970s our focus on components had emerged and the Rencol name became synonymous with high quality plastic knobs, handles and handwheels.

Today, we continue to grow, adapt and innovate:

- Our product range is extensive, industry-standard and growing.
- Our manufacturing partners are in key international locations, each chosen for their expertise, compatibility with our values and cost effectiveness.
- Our distribution network is worldwide and expanding.
- Our global supply chain has been in successful continuous operation for over a decade.

We are here to help

Exceptional customer service is central to our company philosophy. Our customer service team, on-site engineers, product designers and supply chain experts are here to advise and assist at all stages of the purchase and fulfilment process.

Call or email to:

- Check price and availability
- Make technical queries and request product advice
- Request samples
- Place and progress your order
- Request CAD drawings

Visit our website to:

- Request a quotation
- View product specifications and MOQs
- Find your local distributor
- Request CAD drawings
- Request a catalogue

Tel: +44 (0) 117 916 0090

Fax: +44 (0) 117 982 2235

Email: sales@rencol.com

Website: www.rencol.com

Office opening hours:

Monday to Friday
8.30 AM to 5.00 PM (GMT)



*Nick Dowden, 30 years with Rencol.
Customer Service Manager*

Index

Technical Specifications & Key

Material performance data, tolerances, colour options, quality certifications and product icon key.



Page 5

Model 01F PH Female Thermoplastic T-Handle

Page 6



Model 01M PH Male Thermoplastic T-Handle

Page 7



Model 02F PH Female Duroplast T-Handle

Page 8



Model 02M PH Male Duroplast T-Handle

Page 9



Model 03M PH Male Thermoplastic Fixed Revolving Handle

Page 10



Model 04M PH Male Duroplast Fixed Revolving Handle

Page 11



Model 05F PH Female Thermoplastic Handle

Page 12



Model 05M PH Male Thermoplastic Handle

Page 13

SS



Model 05SF PH Self Fixing Thermoplastic Handle

Page 14



Model 06ST PH Thermoplastic Revolving and Folding Straight Handle

Page 15



Model 06TA PH Thermoplastic Revolving and Folding Tapered Handle

Page 16



Model 07F PH Female Duroplast Offset Tee Handle

Page 17



Model 08F PH Female Duroplast Handle

Page 18



Model 08M PH
Male Duroplast Handle

Page 19



Model 08CB PH
Duroplast Handle with
Moulded Clearance Bore

Page 20



Model 09 PH
Male Duroplast Revolving
Handle

Page 21



Model 01 PG
PVC Grip

Page 22



Model 02 PG
PVC Grip

Page 23

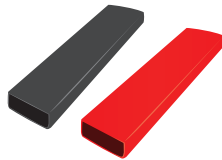

Modifications & Custom
Components

Custom colours, threads,
materials, sizes, finishes, etc.

Page 27



Technical Specifications & Key

Thermoplastic

Material: Nylon 6 + Polypropylene (PP)
Working temperatures: Nylon up to 130°C peak and 80°C continuous use. Polypropylene maximum 70°C.
Resistant to: alcohols, esters, aromatic hydrocarbons, dilute alkalis, ketones, oils, fuels, grease, fats, weatherability (including UV light - excludes coloured Nylon) and salt water.
With PP also avoid halogenated hydrocarbons and flammable materials (can hold static charge).

Reinforced Thermoplastic

Material: Nylon 6 glass filled
Working temperature: up to 180°C peak, 110°C continuous use.
Resistant to: alcohols, esters, aromatic hydrocarbons, dilute alkalis, ketones, oils, fuels, grease, fats, weatherability (including UV light) and salt water.

Duroplast

Material: Phenolic Based Duroplast (PF)
Working temperature: -30°C to 160°C
Resistant to: diluted mineral acids, alcohols, chlorinated hydrocarbons, aromatic hydrocarbons, detergents, grease, oils, weatherability (including UV light). Avoid high pressure or high impact loads (can shatter).

Soft-Touch Mouldings

Material: Polypropylene substrate, TPE over-mould. Rencol has standard parts already available in this design, used particularly extensively in both industrial and special needs market products.

Brass

Material: BS2874 CZ121. Especially recommended for any materials likely to have continued exposure to temperatures below -30°C, where most steel grades become brittle. Also used as a marine grade material when nickel plated.

Zinc Plated Steel

Material: EN1A leaded-bright zinc passivated.

Stainless Steel

Material: Standard grade is 304. For medical, catering or marine use recommended grade is 316 - has high chloride resistance.

Aluminium

Grades are 6061 and A380. Others available on request.

Colours

Colour options include black, red, yellow, green, blue, white and grey. Other colours are available on request. If you would like to see the colours before ordering, samples can be provided free of charge.







Thread Depths

Wherever possible thread depths are a minimum of 1.5 x the diameter of the thread.

Tolerances

In general, our products are produced to the following tolerances:
Bore sizes: $\pm 0.1\text{mm}$ (0.004in)
Outside dimensions: $\pm 0.5\text{mm}$ (0.020in)
Male thread length: $\pm 1\text{mm}$ (0.040in)

Key

-  **Colour options** - RAL colours on request.
-  **Heavy duty** - Particularly hard wearing item.
-  **Stainless steel** - Partly or totally stainless steel.
-  **Fixing from above**
-  **Fixing from below**
-  **Multi component build** - Assembly available.
-  **Soft touch** - TPE over mould. Oil resistant.



Rencol Components is **ISO 9001:2008 Certified**
Our components are **REACH & RoHS Compliant**

Material

High impact resistant thermoplastic

Standard colour

Black

Finish

Matt

Female insert material

Brass

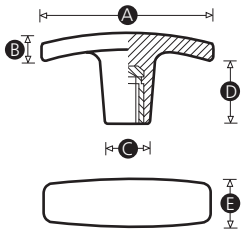

Part No.	A	B	C	D	E	Thread size
8514P	40	10	13	20	13	M5
5379P	50	9	14	16	16	M5
5380U	60	9	16	23	18	M6
5381X	71	15	18	19	19	M8
8589X	71	15	18	19	19	M10
8936V	80	14	26	26	27	M10
8937R	80	14	26	26	27	M12

Material

High impact resistant thermoplastic

Standard colour

Black

Finish

Matt

Male thread material

Zinc plated steel. Stainless steel available on application (MOQs apply).

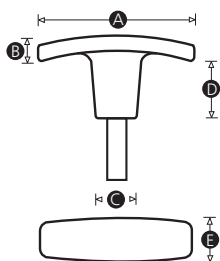

Part No.	A	B	C	D	E	Thread size	Thread length (mm)
8515W	40	10	13	20	13	M5	15
5382P	50	9	14	16	16	M5	15
5383S	50	9	14	16	16	M5	20
5384V	60	9	16	23	18	M6	20
5385Y	60	9	16	23	18	M6	25
5386Q	71	15	18	19	19	M8	20
5387T	71	15	18	19	19	M8	30
8592W	71	15	18	19	19	M10	20
8593S	71	15	18	19	19	M10	30
8942T	80	14	26	26	27	M10	30
8939U	80	14	26	26	27	M12	40

Material

Duroplast

Standard colour

Black

Finish

Matt textured

Female insert material

Brass

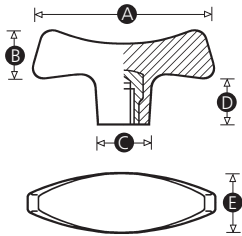

Part No.	A	B	C	D	E	Thread size
8865T	72	21	21	21	23	M8
4094W	72	21	21	21	23	M10

Material

Duroplast

Standard colour

Black

Finish

Matt textured

Male thread material

Zinc plated steel

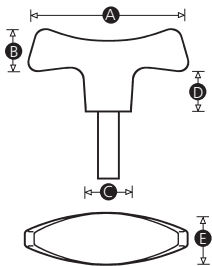

Part No.	A	B	C	D	E	Thread size	Thread length (mm)
6568W	72	21	21	21	23	M8	25
11129Q	72	21	21	21	23	M10	35

Material

High impact resistant thermoplastic

Standard colour

Black

Finish

Matt

Male thread material

Zinc plated steel with allen key fixing hole.

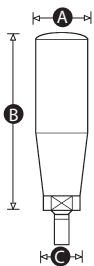

Part No.	A	B	C	Thread size
7757S	20	55	12	M6
7756W	23	67	18	M8
7753X	25	77	18	M8
7755P	25	77	18	M10
7752Q	27	87	20	M10
7751U	27	87	20	M12
7750Y	29	97	20	M10
7749R	29	97	20	M12

Material

Duroplast

Standard colour

Black

Finish

Gloss

Male thread material

Zinc plated steel

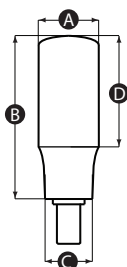

Part No.	A	B	C	D	Thread size
11856X	26	95	21.5	63	M10

Material

High impact resistant thermoplastic

Standard colour

Black

Finish

Matt

Female thread

Moulded

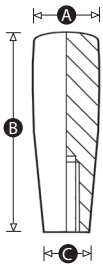

Part No.	A	B	C	Thread size
9123V	18	40	15	M6
9122Z	21	50	17	M8
9121S	23	65	19	M10
9120W	26	80	21	M12
13157W	28	90	22	M8
9119P	28	90	22	M12

SS

Material

High impact resistant thermoplastic

Standard colour

Black

Finish

Matt

Male thread material

Zinc plated steel or stainless steel

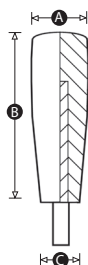

Part No.	A	B	C	Thread size	Thread length (mm)	Thread material
9128X	18	40	15	M6	10	Zinc plated steel
14283V	18	40	15	M6	10	Stainless Steel
9127Q	21	50	17	M8	12	Zinc plated steel
14284R	23	65	19	M8	10	Stainless Steel
9126U	23	65	19	M10	15	Zinc plated steel
14285Y	26	80	21	M8	10	Stainless Steel
9125Y	26	80	21	M12	20	Zinc plated steel
14286U	28	90	22	M10	15	Stainless Steel
9124R	28	90	22	M12	20	Zinc plated steel

Material

High impact resistant thermoplastic

Standard colour

Black

Finish

Matt

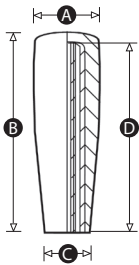

Part No.	A	B	C	D	To fit shaft diameter - H9 tolerance (mm)
9133Z	18	40	15	37	8
9132S	21	50	17	46	10
9131W	23	65	19	61	10
9130P	26	80	21	75	12
9129T	28	90	22	85	16

Material

High impact resistant thermoplastic

Standard colour

Black

Finish

Matt

Male thread material

Zinc plated steel

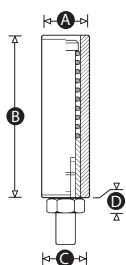

Part No.	A	B	C	D	Thread size	Thread length (mm)
5479P	25	82	25	7	M10	17
5480V	25	90	25	7	M10	17

Material

High impact resistant thermoplastic

Standard colour

Black

Finish

Matt

Male thread material

Zinc plated steel

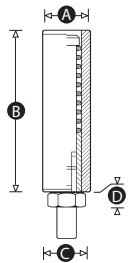

Part No.	A	B	C	D	Thread size	Thread length (mm)
7495V	20	50	14	6	M6	9
5478X	25	70	20	6	M8	10

Material

Duroplast

Standard colour

Black

Finish

Gloss

Thread

Moulded thread

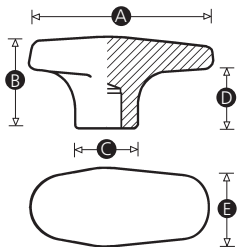

Part No.	A	B	C	D	E	Thread size
7473V	60	30	20	18	25	M6
2553P	60	30	20	18	25	M8
1073U	80	30	22	18	30	M8
1070V	80	30	22	18	30	M10
3119X	100	35	25	20	32	M10
1080P	100	35	25	20	32	M12

Material

Duroplast

Standard colour

Black

Finish

Gloss

Female thread

Moulded

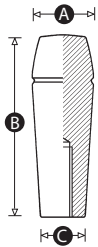

Part No.	A	B	C	Thread size
8272P	18	40	12	M6
1366P	18	40	12	M8
4129Q	20	60	14	M6
1375W	20	60	14	M8
1391Y	24	80	18	M6
1392U	24	80	18	M8
1408W	28	95	20	M8
8274S	28	95	20	M10
1407P	28	95	20	M12
1426Q	30	110	22	M10
8275Z	30	110	22	M12

Material

Duroplast

Standard colour

Black

Finish

Gloss

Male thread material

Zinc plated steel

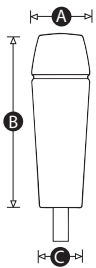

Part No.	A	B	C	Thread size	Thread length (mm)
4511S	18	40	12	M5	5
2885R	18	40	12	M6	10
4510P	20	60	14	M6	6
1378V	20	60	14	M6	12
1379R	20	60	14	M8	12
2900X	24	80	18	M6	15
4509U	24	80	18	M8	8
1397W	24	80	18	M8	15
1414U	28	95	20	M10	20
4508R	28	95	20	M8	12
4287W	30	110	22	M10	20
1435Y	30	110	22	M12	20

Material

Duroplast

Standard colour

Black

Finish

Gloss

Thread

Moulded clearance bore

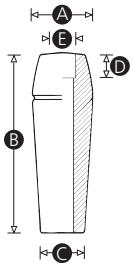

Part No.	A	B	C	D	E	Clearance bore (mm)
1367V	18	40	12	8	10	5
1368R	18	40	12	8	10	6
1384T	20	60	14	8	10	6
1385P	20	60	14	8	10	8
1401R	24	80	18	13	13	8
1400V	24	80	18	13	13	10
1421P	28	95	20	13	16	10
1422V	28	95	20	13	16	12
1438X	30	110	22	15	18	10
1439T	30	110	22	15	18	12

Material

Duroplast

Standard colour

Black

Finish

Gloss

Thread material

Zinc plated steel

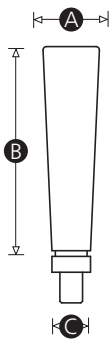

Part No.	A	B	C	Thread size	Thread length (mm)
14274Y	21	83	10	M8	12
14275U	25	104	12	M10	15
14276Q	25	120	16	M12	23

Material

Flexible PVC

Finish

Gloss

Standard colour

Red or black

Options

All RAL colours can be produced (MOQs apply).

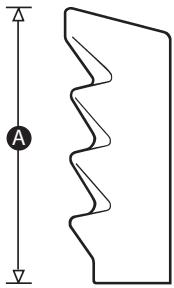

Part No.	A	Internal diameter (inches)	Internal diameter (mm)	Colour
786S	85	0.75	19	Black
770U	95	0.75	19	Black
771Y	95	0.75	19	Red
775S	110	0.87	22	Black
776W	110	0.87	22	Red
781U	115	1	25	Black
782Y	115	1	25	Red

Material

Flexible PVC

Finish

Gloss

Standard colour

Red or black

Options

All RAL colours can be produced (MOQs apply).

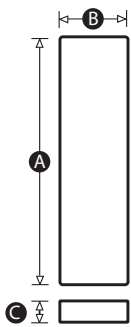
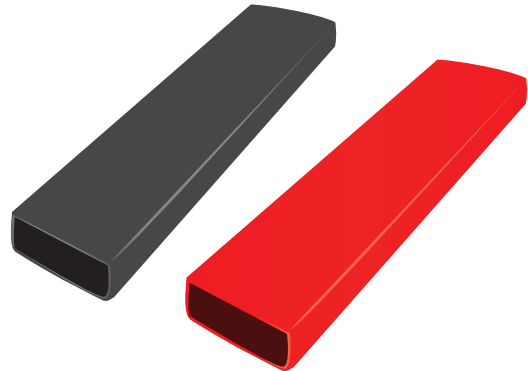

Part No.	A	B	C
13021Q	75	20	5
13023T	80	20	5
12461X	160	24	5
13025W	180	25	5

A large grid of graph paper for taking notes, consisting of 20 columns and 40 rows of small squares.

A large grid of graph paper for taking notes, consisting of approximately 30 columns and 40 rows of small squares.

Modifications & Custom Components

Diverse manufacturing capabilities and experienced on-site technical personnel allows Rencol Components to offer a wide range of product modifications and custom product solutions. We regularly adapt standard components or manufacture custom products to suit our customers' specific requirements. New tooling can be produced quickly and cost effectively with a typical MOQ of just 500 pieces.

Manufacturing Processes

Plastic & Metal Injection Moulding / Die casting / Machining / Forging / Stamping / Rapid Prototyping / 3D Printing

Modifications & Custom Options

Thread size & length / RAL Colours / Engraving / Pad-Printing & Screen-Printing / TPE Over mould / Materials / Finishes / Logos

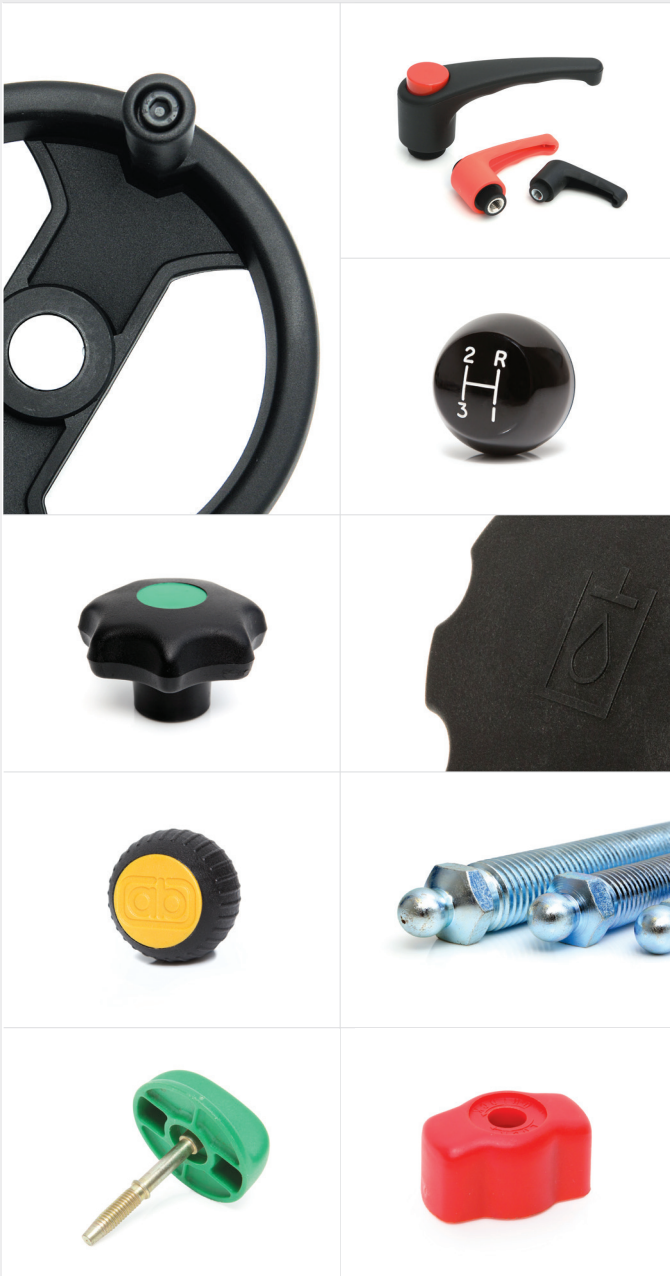



Rencol COMPONENTS

Head Office (UK):

Unit 2 Avonbridge Trading Estate
Atlantic Road
Avonmouth
Bristol BS11 9QD
United Kingdom

Tel: +44 (0) 117 916 0090

Fax: +44 (0) 117 982 2235

Email: sales@rencol.com

Website: www.rencol.com

Office opening hours:

Monday to Friday
8.30 AM to 5.00 PM (GMT)