



Queen Alexandra Hospital -
Portsmouth - Haydon
Mechanical & Electrical

Prefabrication of Pipework and Fittings

- > Bespoke Fittings
- > Manifolds
- > Coiled Risers & Laterals
- > Pre-flanged Pipes & Other Assemblies

Table of Contents

3	GF your global system provider
4 - 5	Materials
6 - 7	Customisation
8 - 9	Fabrication
10 - 11	Delivering Excellence
12 - 13	Prefabrication to Order
14 - 23	Fabricated Spigot Fittings in PE100
24 - 25	Fabricated Flanged Fittings ABS
26 - 27	Fabrication Process

GF Piping Systems Your global system provider

We are dedicated to designing, manufacturing and marketing piping systems for the safe and secure conveyance of liquids and gases.

We put customers first

- Customer needs guide our product development
- We offer customer support and training worldwide
- We measure your satisfaction

We act fast

- Local presence worldwide
- Superior logistics
- Speed in all details

We do what we say

- Tested quality
- Always reliable

Your competent partner to build, monitor and operate your network

- Always the right solution for building services
- Premium quality and performance
- Increased security throughout the system

- Technological expertise
- «One-stop shopping» around the world
- System solutions
- Know-how and experience
- Local support



INSTAFLEX PB

Typical Applications

- Building Services
- Hot and cold water services
- Chilled water systems
- Heating
- Compressed air lines

Size range: 16 - 225mm
 Pressure: PN16 @ 20°C
 Temperature range 0°C to 95°C
 Thermal Conductivity: 0.32W/m°C
 Expansion/ Contraction: 0.13mm/m°C
 Approvals: WRAS, BSi Kitemark, LR, GL, ABS, BV, DIBt, DNV, KTW, Maire de Paris, RINA
 Jointing: Socket fusion
 Electro fusion or Compression

PE

Typical Applications

- Building Services
- Cold water services
- Chilled water services

Size range: 20 - 630mm
 Pressure: PN10 & PN16 @ 20°C
 Temperature range -50°C to 60°C
 Thermal Conductivity: 0.43W/m°C
 Expansion/Contraction: 0.20mm/m°C
 Approvals: WRAS, BSi Kitemark
 Jointing: Socket fusion, Butt fusion & Electro fusion

ABS

Typical Applications

- Water Treatment
- Process cooling water
- Chilled water service
- Air conditioning systems in buildings
- Vacuum lines

Size range: 16 - 315mm
 Pressure: PN10 @ 20°C
 Temperature range -40°C to 60°C
 Thermal Conductivity: 0.17W/m°C
 Expansion/ Contraction: 0.1mm/m°C
 Approvals: WRAS, LR, GL, ABS, BV, DIBt, DNV, KTW, Maire de Paris, RINA
 Jointing: Solvent cement (Tangit Cement for ABS)



Materials



AQUASYSTEM

Typical Applications

- Building Services
- Hot & cold water services
- Chilled water systems
- Heating
- Compressed air lines

Size range: 20 - 160mm
 Pressure: PN10 @ 20°C
 Temperature range -0°C to 95°C
 Thermal Conductivity: 0.22W/m°C
 Expansion/Contraction: 0.15mm/m°C
 Approvals: KIWA, WRAS, CSTB, LR
 Jointing: Socket fusion, Electro fusion

COOL-FIT

Typical Applications

- Secondary refrigeration
- Air conditioning systems in buildings
- Chilled water systems

Size range: 16 - 315mm
 Pressure: PN10 @ 20°C
 Temperature range -50°C to 40°C
 Thermal Conductivity: 0.17W/m°C
 Expansion/Contraction: 0.04mm/m°C
 Approvals: WRAS, LR, GL, ABS, BV, DIBt, DNV, KTW, Maire de Paris, RINA
 Jointing: Solvent cement jointing (TANGIT cement for ABS)

PVC-C

Typical Applications

- Hot and cold water services
- Chemical process lines

Size range: 16 - 225mm
 Pressure: PN16 @ 20°C
 Temperature range 0°C to 80°C
 Thermal Conductivity: 0.15W/m°C @ 20°C
 Expansion/Contraction: 0.07mm/m°C
 Approvals: WRAS, GL, ABS, BV, DIBt, RINA
 Jointing: Solvent cement jointing (TANGIT for PVC-C & TANGIT Cleaning Fluid)

PVC-U

Typical Applications

- Water Treatment
- Swimming Pools
- Chemical Process Lines

Size range: 6 - 400mm
 Pressure: PN16 @ 20°C
 Temperature range 0°C to 60°C
 Thermal Conductivity: 0.15W/m°C @ 20°C
 Expansion/Contraction: 0.08mm/m°C
 Approvals: WRAS, GL, ABS, BV, DIBt, RINA
 Jointing: Solvent cement jointing (TANGIT for PVC-U & TANGIT Cleaning Fluid)





Customisation



Customisation

In addition to the wide range of pipe, fittings and valves GF also offer a customisation service.

Housed in a large, dedicated area of our Coventry facility, fully trained GF staff can pre-assemble pipe and fittings in any of our materials, using whichever joining method is most appropriate for the material.

We can translate our customer's drawings into convenient size assemblies for transportation using our CAD facility. Drawings can be sent and received by email or in a paper form.



The largest plastic pipe storage facilities in the UK.



Dedicated fabrication and assembly area.



Large coils can be fabricated for ease on installation on-site.



Utilising GF's own joining equipment ensure perfect reliable jointing.

Customisation



Fabrication



Fabrication

There are numerous advantages to using this service:

Pre-assembled pipe runs can be delivered to site to fit in with your precise schedule. Long pipe runs can be installed quickly and easily offering large savings on site labour costs and ensuring site deadlines are met. Plus, no-one knows our products like we do. You can be rest assured that all assembly work is carried out by staff who work with the products every day.

All jointing is carried out in our purpose built assembly area by qualified GF personnel. All joints are individually marked for traceability. No need for you to worry about jointing being carried out correctly on site - let our expert staff take care of it beforehand.



Fabricated assemblies delivered directly to site

Fabrication



Fabrication Process

Our aim at GF is to support you with your fabrication requirements and deliver you a professional service that our clients return to time and time again.

Our process is professional and leaves you worry free, you can plan in the delivery time to suit you as GF offer a 'just in time' service. We can deliver directly to site thus removing the likelihood of damage and storage problems.

Delivering excellence direct to site

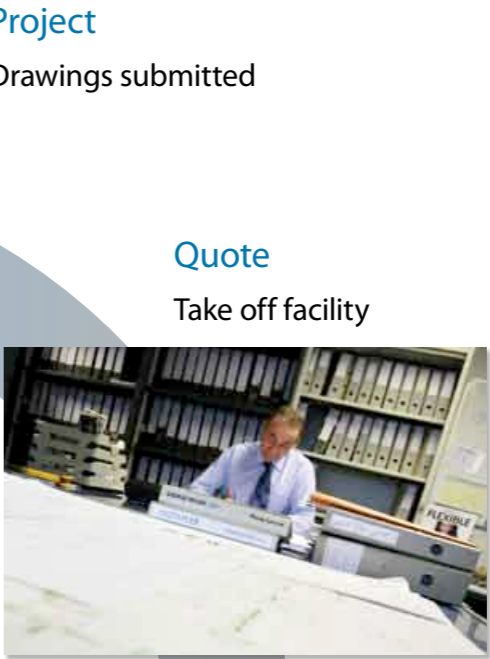

Our Fabrication Process



Fabrication Process

Fabrication Process



Fabrication Process

GF has a range of standard fabricated fittings in PE and ABS which include mitred and pipped variations across the complete size range which can be ordered direct through our distributors .

GF has also earned an enviable reputation in successful completion of significant prefabricated building services projects and recognise the customers needs in delivering specialist orders when required.

We have extensive experience in providing solutions for a wide range of private and public sector customers.



Standard fabricated angles can be ordered direct from our stock



+GF+

Prefabrication to order



Some of GF Piping Systems Prefabrication contracts have included:

- > Greater London Authority - London
- > Wembley Stadium - London
- > Queen Alexandra Hospital - Portsmouth
- > Highbury Luxury Apartments - London
- > Beetham Tower - Manchester
- > Royal Albert Hall - London
- > Edinburgh County Council - Edinburgh
- > Royal Festival Hall - London
- > Castle Howard - York

+GF+



Fabrication

Fabrication

Fabricated Spigot Fittings in PE100

Pupped Mitred Bend 90°, SDR11

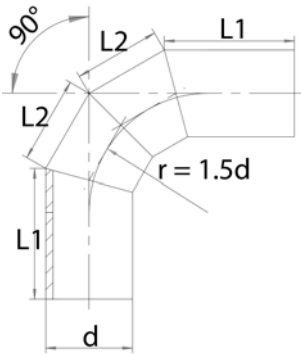

Model:

- Colour: black
- Production process: segment welded
- Conventional butt-welding according to DVS 2207 part 1
- For butt fusion or electrofusion welding

d [mm]	Code	kg	L1 [mm]	L2 [mm]
90	PIL008400	4.300	500	250
110	PIL008401	6.300	500	250
125	PIL008402	8.200	500	250
160	PIL008403	13.200	500	250
180	PIL008404	17.000	500	250
200	PIL008405	20.800	500	300
225	PIL008406	26.400	500	300
250	PIL008407	32.400	500	300
280	PIL008408	40.800	500	300
315	PIL008409	51.400	500	350
355	PIL008410	66.000	500	400
400	PIL008411	82.600	500	400
450	PIL008412	104.500	500	400
500	PIL008413	128.900	500	500
560	PIL008414	161.500	1000	600
630	PIL008415	204.600	1000	600

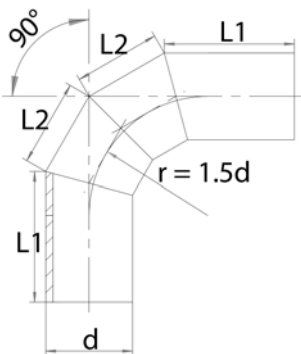

Pupped Mitred Bend 90°, SDR17

Model:

- Colour: black
- Production process: segment welded
- Conventional butt-welding according to DVS 2207 part 1
- For butt fusion or electrofusion welding

d [mm]	Code	kg	L1 [mm]	L2 [mm]
90	PIL008416	2.800	500	250
110	PIL008417	4.200	500	250
125	PIL008418	5.300	500	250
160	PIL008419	8.700	500	250
180	PIL008420	11.000	500	250
200	PIL008421	13.600	500	300
225	PIL008422	17.100	500	300
250	PIL008423	21.200	500	300
280	PIL008424	26.400	500	300
315	PIL008425	33.400	500	350
355	PIL008426	42.400	500	400
400	PIL008427	53.800	500	400
450	PIL008428	70.800	500	400
500	PIL008429	87.400	500	500
560	PIL008430	109.600	1000	600
630	PIL008431	138.700	1000	600

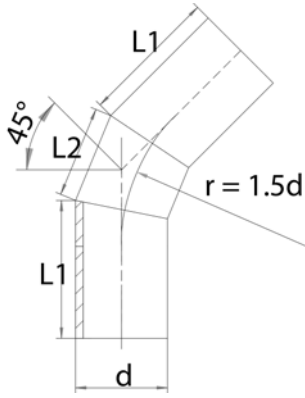

Puppel Mitred Bend 45°, SDR11

Model:

- Colour: black
- Production process: segment welded
- Conventional butt-welding according to DVS 2207 part 1
- For butt fusion or electrofusion welding

d [mm]	Code	kg	L1 [mm]	L2 [mm]
90	PIL008432	3.200	500	250
110	PIL008433	4.700	500	250
125	PIL008434	6.200	500	250
160	PIL008435	9.900	500	250
180	PIL008436	12.800	500	250
200	PIL008437	15.600	500	300
225	PIL008438	19.800	500	300
250	PIL008439	24.300	500	300
280	PIL008440	30.600	500	300
315	PIL008441	38.600	500	350
355	PIL008442	49.500	500	400
400	PIL008443	62.000	500	400
450	PIL008444	78.300	500	400
500	PIL008445	96.700	500	500
560	PIL008446	121.100	1000	600
630	PIL008447	153.500	1000	600

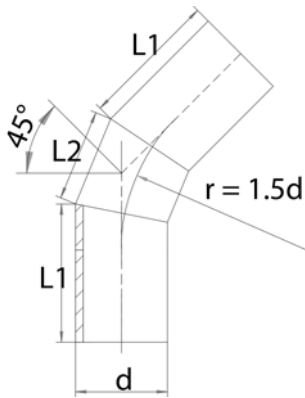

Puppel Mitred Bend 45°, SDR17

Model:

- Colour: black
- Production process: segment welded
- Conventional butt-welding according to DVS 2207 part 1
- For butt fusion or electrofusion welding

d [mm]	Code	kg	L1 [mm]	L2 [mm]
90	PIL008448	2.100	500	250
110	PIL008449	3.100	500	250
125	PIL008450	4.000	500	250
160	PIL008451	6.500	500	250
180	PIL008452	8.200	500	250
200	PIL008453	10.200	500	300
225	PIL008454	12.900	500	300
250	PIL008455	15.900	500	300
280	PIL008456	19.800	500	300
315	PIL008457	25.100	500	350
355	PIL008458	31.800	500	400
400	PIL008459	40.400	500	400
450	PIL008460	53.100	500	400
500	PIL008461	65.600	500	500
560	PIL008462	82.200	1000	600
630	PIL008463	104.100	1000	600

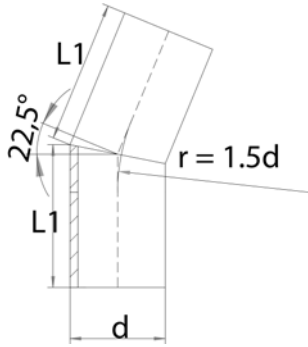

Pupped Mitred Bend 22.5°, SDR11

Model:

- Colour: black
- Production process: segment welded
- Conventional butt-welding according to DVS 2207 part 1
- For butt fusion or electrofusion welding

d [mm]	Code	kg	L1 [mm]
90	PIL008464	2.100	500
110	PIL008465	3.200	500
125	PIL008466	4.100	500
160	PIL008467	6.600	500
180	PIL008468	8.500	500
200	PIL008469	10.400	500
225	PIL008470	13.200	500
250	PIL008471	16.200	500
280	PIL008472	20.400	500
315	PIL008473	25.700	500
355	PIL008474	33.000	500
400	PIL008475	41.300	500
450	PIL008476	52.200	500
500	PIL008477	64.500	500
560	PIL008478	80.700	1000
630	PIL008479	102.300	1000

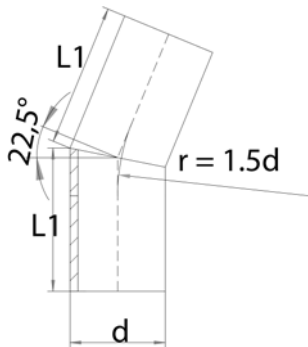

Pupped Mitred Bend 22.5°, SDR17

Model:

- Colour: black
- Production process: segment welded
- Conventional butt-welding according to DVS 2207 part 1
- For butt fusion or electrofusion welding

d [mm]	Code	kg	L1 [mm]
90	PIL008480	1.400	500
110	PIL008481	2.100	500
125	PIL008482	2.700	500
160	PIL008483	4.400	500
180	PIL008484	5.500	500
200	PIL008485	6.800	500
225	PIL008486	8.600	500
250	PIL008487	10.600	500
280	PIL008488	13.200	500
315	PIL008489	16.700	500
355	PIL008490	21.200	500
400	PIL008491	26.900	500
450	PIL008492	35.400	500
500	PIL008493	43.700	500
560	PIL008494	54.800	1000
630	PIL008495	69.400	1000

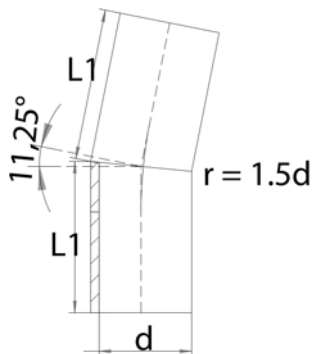

Puppel Mitred Bend 11.25°, SDR11

Model:

- Colour: black
- Production process: segment welded
- Conventional butt-welding according to DVS 2207 part 1
- For butt fusion or electrofusion welding

d [mm]	Code	kg	L1 [mm]
90	PIL008496	2.100	500
110	PIL008497	3.200	500
125	PIL008498	4.100	500
160	PIL008499	6.600	500
180	PIL008500	8.500	500
200	PIL008501	10.400	500
225	PIL008502	13.200	500
250	PIL008503	16.200	500
280	PIL008504	20.400	500
315	PIL008505	25.700	500
355	PIL008506	33.000	500
400	PIL008507	41.300	500
450	PIL008508	52.200	500
500	PIL008509	64.500	500
560	PIL008510	80.700	1000
630	PIL008511	102.300	1000

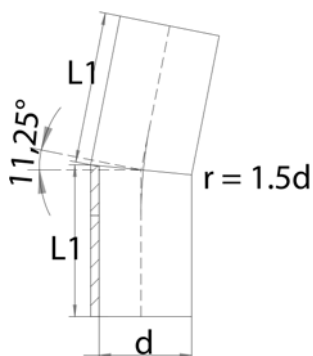

Puppel Mitred Bend 11.25°, SDR17

Model:

- Colour: black
- Production process: segment welded
- Conventional butt-welding according to DVS 2207 part 1
- For butt fusion or electrofusion welding

d [mm]	Code	kg	L1 [mm]
90	PIL008512	1.400	500
110	PIL008513	2.100	500
125	PIL008514	2.700	500
160	PIL008515	4.400	500
180	PIL008516	5.500	500
200	PIL008517	6.800	500
225	PIL008518	8.600	500
250	PIL008519	10.600	500
280	PIL008520	13.200	500
315	PIL008521	16.700	500
355	PIL008522	21.200	500
400	PIL008523	26.900	500
450	PIL008524	35.400	500
500	PIL008525	43.700	500
560	PIL008526	54.800	1000
630	PIL008527	69.400	1000

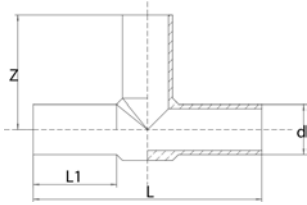

Puppé Equal Tee, SDR11

Model:

- Colour: black
- Conventional butt-welding according to DVS 2207 part 1
- For butt fusion or electrofusion welding

d [mm]	Code	kg	L1 [mm]	z [mm]	L [mm]
90	PIL008624	1.610	500	590	1180
110	PIL008625	2.620	500	610	1220
125	PIL008626	3.560	500	625	1250
160	PIL008627	6.400	500	660	1320
180	PIL008628	8.810	500	690	1380
200	PIL008629	11.240	500	700	1400
225	PIL008630	14.690	500	720	1440
250	PIL008631	17.860	500	772	1465
280	PIL008632	23.950	500	813	1540
315	PIL008633	31.150	500	848	1530
355	PIL008634	47.000	500	845	1665
400	PIL008635	59.650	500	860	1682
450	PIL008636	71.100	500	985	1900
500	PIL008637	107.750	500	1030	900
560	PIL008638	234.000	1000	1755	3510
630	PIL008639	307.800	1000	1815	3630

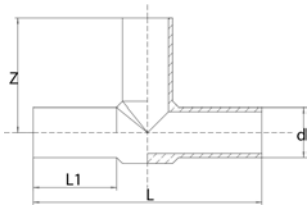

Puppé Equal Tee, SDR17

Model:

- Colour: black
- Conventional butt-welding according to DVS 2207 part 1
- For butt fusion or electrofusion welding

d [mm]	Code	kg	L1 [mm]	z [mm]	L [mm]
90	PIL008640	1.140	500	590	1180
110	PIL008641	1.810	500	610	1220
125	PIL008642	2.420	500	625	1250
160	PIL008643	4.440	500	660	1320
180	PIL008644	5.930	500	690	1380
200	PIL008645	7.760	500	700	1400
225	PIL008646	10.330	500	720	1440
250	PIL008647	12.200	500	772	1465
280	PIL008648	16.700	500	813	1540
315	PIL008649	22.350	500	848	1530
355	PIL008650	33.350	500	845	1665
400	PIL008651	43.950	500	860	1682
450	PIL008652	62.700	500	985	1900
500	PIL008653	74.450	500	1030	900
560	PIL008654	154.000	1000	1755	3510
630	PIL008655	202.100	1000	1815	3630

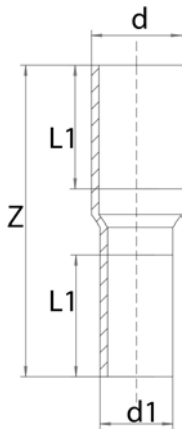

Puppel Reducer, SDR11

Model:

- Colour: black
- Conventional butt-welding according to DVS 2207 part 1
- For butt fusion or electrofusion welding

d [mm]	d1 [mm]	Code	kg	L1 [mm]	z [mm]
90	63	PIL008592	1.180	500	1075
110	90	PIL008593	1.840	500	1090
125	90	PIL008594	2.790	500	1212
160	110	PIL008595	3.910	500	1120
180	125	PIL008596	4.780	500	1136
200	180	PIL008597	5.920	500	1151
225	160	PIL008598	6.750	500	1160
250	200	PIL008599	10.450	500	1180
280	250	PIL008600	11.590	500	1070
315	250	PIL008601	15.220	500	1100
355	315	PIL008602	20.200	500	1245
400	355	PIL008603	25.450	500	1260
450	400	PIL008604	32.700	500	1230
500	450	PIL008605	40.550	500	1200
560	500	PIL008606	114.800	1000	2466
630	500	PIL008607	147.000	1000	2506

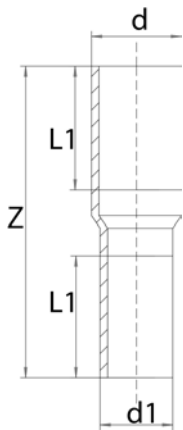

Puppel Reducer, SDR17

Model:

- Colour: black
- Conventional butt-welding according to DVS 2207 part 1
- For butt fusion or electrofusion welding

d [mm]	d1 [mm]	Code	kg	L1 [mm]	z [mm]
90	63	PIL008608	0.780	500	1075
110	90	PIL008609	1.220	500	1090
125	90	PIL008610	2.050	500	1212
160	110	PIL008611	2.490	500	1120
180	125	PIL008612	3.100	500	1136
200	180	PIL008613	3.870	500	1151
225	160	PIL008614	4.920	500	1160
250	200	PIL008615	7.120	500	1180
280	250	PIL008616	7.460	500	1070
315	250	PIL008617	9.800	500	1100
355	315	PIL008618	14.300	500	1245
400	355	PIL008619	16.770	500	1260
450	400	PIL008620	22.100	500	1230
500	450	PIL008621	27.350	500	1200
560	500	PIL008622	62.400	1000	2466
630	500	PIL008623	81.400	1000	2506

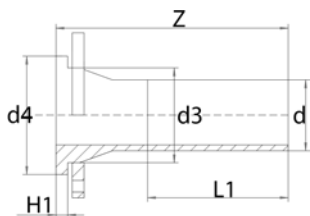

Puffed Flange Adaptor With PN16 Backing Ring, SDR11

Model:

- Material: PE100
- Colour: black
- For butt fusion or electrofusion welding
- Conventional butt-welding according to DVS 2207 part 1
- Material: Galvanised backing ring
- Drilling BS4504 PN16
- Gasket not included
- Gasket: Profile flange gasket EPDM No. 48 44 07
- *With Reducer

d [mm]	DN [mm]	Code	kg	L1 [mm]	z [mm]	d3 [mm]	d4 [mm]	H1 [mm]
* 90	50	PIL008528	3.200	500	715	75	102	14
90	80	PIL008529	4.300	500	640	105	138	17
* 110	80	PIL008530	5.100	500	750	105	138	17
110	100	PIL008531	5.600	500	660	125	158	18
* 125	80	PIL008532	6.100	500	885	105	138	17
125	100	PIL008533	6.400	500	770	125	158	18
* 160	100	PIL008534	7.900	500	820	125	158	18
160	150	PIL008535	10.400	500	700	175	212	25
* 180	100	PIL008536	8.800	500	857	125	158	18
180	150	PIL008537	11.300	500	700	175	212	25
* 200	150	PIL008538	13.600	500	845	175	212	25
200	200	PIL008539	16.000	500	700	235	268	32
* 225	150	PIL008540	15.200	500	860	175	212	25
225	200	PIL008541	17.400	500	700	235	268	32
* 250	200	PIL008542	21.300	500	903	235	268	32
250	250	PIL008543	18.500	500	620	291	320	35
* 280	200	PIL008544	22.900	500	725	235	268	32
280	250	PIL008545	20.700	500	615	291	320	35
* 315	250	PIL008546	27.800	500	730	291	320	35
315	300	PIL008547	26.100	500	620	335	370	35
* 355	300	PIL008548	33.400	500	728	335	370	35
355	350	PIL008549	34.800	500	618	373	430	40
* 400	350	PIL008550	43.800	500	750	373	430	40
400	400	PIL008551	55.800	500	640	427	482	46
* 450	400	PIL008552	67.800	500	868	427	482	46
450	450	PIL008553	73.800	500	638	514	585	60
* 500	450	PIL008554	88.300	500	838	530	585	60
500	500	PIL008555	76.000	500	638	530	585	60
* 560	500	PIL008556	158.600	1000	1335	530	585	60
560	600	PIL008557	150.000	1000	1135	642	685	60
* 630	500	PIL008558	192.000	1000	1335	530	585	60
630	600	PIL008559	171.600	1000	1135	642	685	60

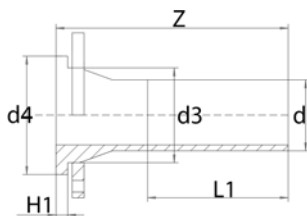

Puffed Flange Adaptor With PN16 Backing Ring, SDR17

Model:

- Material: PE100
- Colour: black
- For butt fusion or electrofusion welding
- Conventional butt-welding according to DVS 2207 part 1
- Material: Galvanised backing ring
- Drilling BS4504 PN16
- Gasket not included
- Gasket: Profile flange gasket EPDM No. 48 44 07
- *With Reducer

d [mm]	DN [mm]	Code	kg	L1 [mm]	z [mm]	d3 [mm]	d4 [mm]	H1 [mm]
* 90	50	PIL008560	2.800	500	715	75	102	14
90	80	PIL008561	3.900	500	640	105	138	17
* 110	80	PIL008562	4.400	500	750	105	138	17
110	100	PIL008563	4.900	500	660	125	158	18
* 125	80	PIL008564	5.200	500	885	105	138	17
125	100	PIL008565	5.300	500	770	125	158	18
* 160	100	PIL008566	6.300	500	820	125	158	18
160	150	PIL008567	8.900	500	700	175	212	25
* 180	100	PIL008568	6.900	500	857	125	158	18
180	150	PIL008569	9.400	500	700	175	212	25
* 200	150	PIL008570	10.900	500	845	175	212	25
200	200	PIL008571	13.600	500	700	235	268	32
* 225	150	PIL008572	11.600	500	860	175	212	25
225	200	PIL008573	14.500	500	700	235	268	32
* 250	200	PIL008574	17.300	500	903	235	268	32
250	250	PIL008575	15.300	500	620	291	320	35
* 280	200	PIL008576	19.300	500	725	235	268	32
280	250	PIL008577	16.600	500	615	291	320	35
* 315	250	PIL008578	19.700	500	730	291	320	35
315	300	PIL008579	20.000	500	620	335	370	35
* 355	300	PIL008580	26.000	500	728	335	370	35
355	350	PIL008581	27.100	500	618	373	430	40
* 400	350	PIL008582	33.300	500	750	373	430	40
400	400	PIL008583	46.000	500	640	427	482	46
* 450	400	PIL008584	54.600	500	868	427	482	46
450	450	PIL008585	62.800	500	638	514	585	60
* 500	450	PIL008586	72.500	500	838	530	585	60
500	500	PIL008587	61.700	500	638	530	585	60
* 560	500	PIL008588	102.300	1000	1335	530	585	60
560	600	PIL008589	123.400	1000	1135	642	685	60
* 630	500	PIL008590	121.300	1000	1335	530	585	60
630	600	PIL008591	136.200	1000	1135	642	685	60

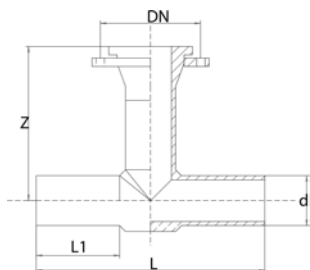

Pugged Flange Tee With PN16 Backing Ring, SDR11

Model:

- Material: PE100
- Colour: black
- For butt fusion or electrofusion welding
- Conventional butt-welding according to DVS 2207 part 1
- Material: Galvanised backing ring
- Drilling BS4504 PN16
- Gasket not included
- Gasket: Profile flange gasket EPDM No. 48 44 07
- Z Dimensions shown are standard - please contact GF if different lengths are required
- *With Reducer

d [mm]	DN [mm]	Code	kg	L1 [mm]	z [mm]	L [mm]
90	80	PIL008656	2.535	500	230	1180
* 110	80	PIL008657	2.501	500	230	1220
110	100	PIL008658	2.535	500	270	1220
* 125	80	PIL008659	4.220	500	477	1250
125	100	PIL008660	4.011	500	295	1250
* 160	80	PIL008661	4.286	500	275	1320
160	150	PIL008662	6.359	500	360	1320
* 180	80	PIL008663	12.431	500	670	1380
180	150	PIL008664	11.613	500	390	1380
* 200	80	PIL008665	13.015	500	625	1400
200	200	PIL008666	16.795	500	400	1400
* 225	80	PIL008667	6.731	500	305	1440
225	200	PIL008668	18.872	500	420	1440
* 250	80	PIL008669	12.518	500	569	1465
250	250	PIL008670	22.748	500	392	1465
* 280	80	PIL008671	28.412	500	821	1540
280	250	PIL008672	28.951	500	428	1540
* 315	80	PIL008673	32.196	500	879	1530
315	300	PIL008674	38.942	500	468	1530
* 355	80	PIL008675	38.587	500	998	1665
355	350	PIL008676	46.855	500	470	1665
* 400	80	PIL008677	49.457	500	998	1682
400	400	PIL008678	72.160	500	477	1682
* 450	80	PIL008679	59.454	500	1211	1900
450	450	PIL008680	94.550	500	588	1900
* 500	80	PIL008681	93.954	500	1211	1900
500	500	PIL008682	119.280	500	588	1900
* 560	80	PIL008683	191.757	1000	1860	3510
560	600	PIL008684	228.980	1000	890	3510
* 630	80	PIL008685	257.857	1000	1978	3630
630	600	PIL008686	269.200	1000	950	3630

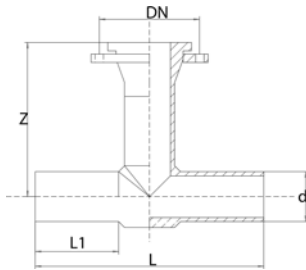

Puffed Flange Tee With PN16 Backing Ring, SDR17

Model:

- Material: PE100
- Colour: black
- For butt fusion or electrofusion welding
- Conventional butt-welding according to DVS 2207 part 1
- Material: Galvanised backing ring
- Drilling BS4504 PN16
- Gasket not included
- Gasket: Profile flange gasket EPDM No. 48 44 07
- Z Dimensions shown are standard - please contact GF if different lengths are required
- *With Reducer

d [mm]	DN [mm]	Code	kg	L1 [mm]	z [mm]	L [mm]
90	80	PIL008687	2.282	500	230	1180
* 110	80	PIL008688	2.251	500	230	1220
110	100	PIL008689	2.281	500	270	1220
* 125	80	PIL008690	3.798	500	477	1250
125	100	PIL008691	3.609	500	295	1250
* 160	80	PIL008692	3.857	500	275	1320
160	150	PIL008693	5.723	500	360	1320
* 180	80	PIL008694	11.187	500	670	1380
180	150	PIL008695	10.451	500	390	1380
* 200	80	PIL008696	11.713	500	625	1400
200	200	PIL008697	15.115	500	400	1400
* 225	80	PIL008698	6.057	500	305	1440
225	200	PIL008699	16.984	500	420	1440
* 250	80	PIL008700	11.226	500	569	1465
250	250	PIL008701	20.473	500	392	1465
* 280	80	PIL008702	25.570	500	821	1540
280	250	PIL008703	26.055	500	428	1540
* 315	80	PIL008704	28.976	500	879	1530
315	300	PIL008705	35.047	500	468	1530
* 355	80	PIL008706	34.971	500	998	1665
355	350	PIL008707	42.169	500	470	1665
* 400	80	PIL008708	44.513	500	998	1682
400	400	PIL008709	64.944	500	477	1682
* 450	80	PIL008710	53.508	500	1211	1900
450	450	PIL008711	85.095	500	588	1900
* 500	80	PIL008712	84.558	500	1211	1900
500	500	PIL008713	107.352	500	588	1900
* 560	80	PIL008714	172.581	1000	1860	3510
560	600	PIL008715	206.082	1000	890	3510
* 630	80	PIL008716	232.071	1000	1978	3630
630	600	PIL008717	242.280	1000	950	3630



Electrofusion Duckfoot Bend Kit

PE 100 SDR 11 (ISO S5)

16 bar Water

4mm pin connector

Limited path fusion indicator

Flange dimensions according to DIN 2502 / BS 4504

Kits consists of:

Duck foot bend

ELGEF Coupler

Full Face Flange with 500mm pipe length

Reducer (if required)

Nuts, bolts, washers (RILSAN coated) and gasket EPDM

d	Code	kg	DN [mm]
90	PIL009002	6.760	80
63	PIL009035	7.271	80
125	PIL009003	8.233	80
160	PIL009036	9.210	80
180	PIL009004	9.495	80

Fabricated Flanged Fittings ABS

Preflanged Bend 90 Degrees Short Pattern ABS

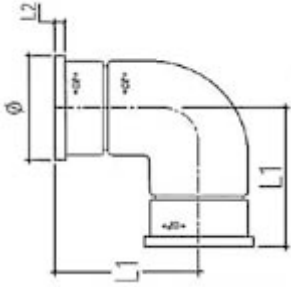

Metric

PN10 pressure rating

5 metre lengths (other lengths available on request)

Galvanised backing ring BS4504 PN10 drilling (excluding bolt sets and gasket)

Tolerance +/- 1%

Other prefabricated designs available - please contact +GF+

d	Code	L1 [mm]	L2 [mm]
225	PIL004185	165	12
280	PIL004187	199	14
315	PIL004188	225	16

Preflanged Elbow 90 Degrees ABS

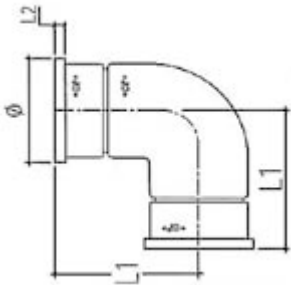

Metric

PN10 pressure rating

5 metre lengths (other lengths available on request)

Galvanised backing ring BS4504 PN10 drilling (excluding bolt sets and gasket)

Tolerance +/- 1%

Other prefabricated designs available - please contact +GF+

d	Code	L1 [mm]	L2 [mm]	DN [mm]
110	PIL004181	198	12	100
140	PIL004182	238	14	125
160	PIL004183	268	16	150
200	PIL004184	329	24	200
250	PIL004186	425	25	250

Preflanged Elbow 45 Degrees ABS

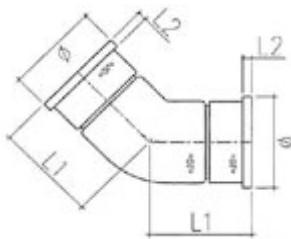

Metric

PN10 pressure rating

5 metre lengths (other lengths available on request)

Galvanised backing ring BS4504 PN10 drilling (excluding bolt sets and gasket)

Tolerance +/- 1%

Other prefabricated designs available - please contact +GF+

d	Code	L1 [mm]	L2 [mm]
110	PIL004189	165	12
140	PIL004190	199	14
160	PIL004191	225	16
200	PIL004192	271	24
225	PIL004193	306	25
250	PIL004194	342	23
280	PIL004195	373	23
315	PIL004196	420	27

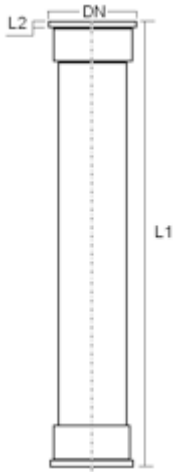

Preflanged Pipe 5.0m ABS

Metric

PN10 pressure rating

5 metre lengths (other lengths available on request)

Galvanised backing ring BS4504 PN10 drilling (excluding bolt sets and gasket)

Tolerance +/- 1%

Other prefabricated designs available - please contact +GF+

d	Code	L1 [mm]	L2 [mm]	DN [mm]	
110	PIL004173	5010.0	12.0	100	
140	PIL004174	5010.0	14.0	125	
160	PIL004175	5010.0	16.0	150	
200	PIL004176	5012.0	24.0	200	
225	PIL004177	5012.0	25.0	200	
250	PIL004178	5018.0	23.0	250	
280	PIL004179	5010.0	23.0	250	
315	PIL004180	5016.0	27.0	300	

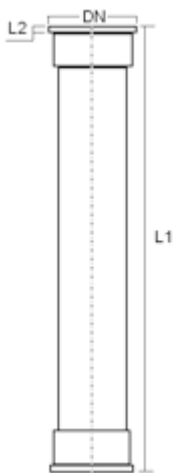

Preflanged Pipe 2.5m ABS

Metric

PN10 pressure rating

5 metre lengths (other lengths available on request)

Galvanised backing ring BS4504 PN10 drilling (excluding bolt sets and gasket)

Tolerance +/- 1%

Other prefabricated designs available - please contact +GF+

d	Code	L1 [mm]	L2 [mm]	DN [mm]	
110	PIL004165	2510.0	12.0	100	
140	PIL004166	2510.0	14.0	125	
160	PIL004167	2510.0	16.0	150	
200	PIL004168	2512.0	24.0	200	
225	PIL004169	2512.0	25.0	200	
250	PIL004170	2518.0	23.0	250	
280	PIL004171	2510.0	23.0	250	
315	PIL004172	2516.0	27.0	300	



Preflanged Tee 90 Degrees ABS

Metric

PN10 pressure rating

5 metre lengths (other lengths available on request)

Galvanised backing ring BS4504 PN10 drilling (excluding bolt sets and gasket)

Tolerance +/- 1%

Other prefabricated designs available - please contact +GF+

d	Code	L1 [mm]	I2 [mm]	L3 [mm]	DN [mm]	
110	PIL004197	198	396	12	100	
140	PIL004198	238	476	14	125	
160	PIL004199	269	538	16	150	
200	PIL004200	329	658	24	200	
225	PIL004201	371	742	25	200	
250	PIL004202	411	822	23	250	
280	PIL004203	451	901	23	250	
315	PIL004204	508	1016	27	300	



Fabrication Process

The fabrication operation process at GF is dynamic and consists of a highly motivated team composed of specialists and engineers. They possess extensive know how in the field of products and materials. They can advise on individual requirements and help specify on which products would best suit your needs. We offer a comprehensive process from technical support and design to final prefabrication, not to mention the fast and reliable delivery thanks to location of our distribution centre.

Call 024 7653 5535 to find your nearest Area Sales Manager to discuss your requirements

George Fischer Sales Limited
Paradise Way
Coventry CV2 2ST

www.georgefischer.co.uk
email: uk.ps@georgefischer.com

Delivering excellence direct to site



Fabrication Process

Place Order

Place the order through your local distribution partner



Standard Codes

Standard off the shelf prefabrication
Contact your local distributor to order

Special Items

Contact our Project Team and provide a sketch or drawing

Our Fabrication Process



Free Quotation Service

We will return your quotation with a drawing



Bespoke Design

We will advise and design to your needs any special requirements

Fabrication Process

GF Piping Systems > worldwide at home

Our sales companies and representatives ensure local customer support in over 100 countries.

www.georgfischer.co.uk

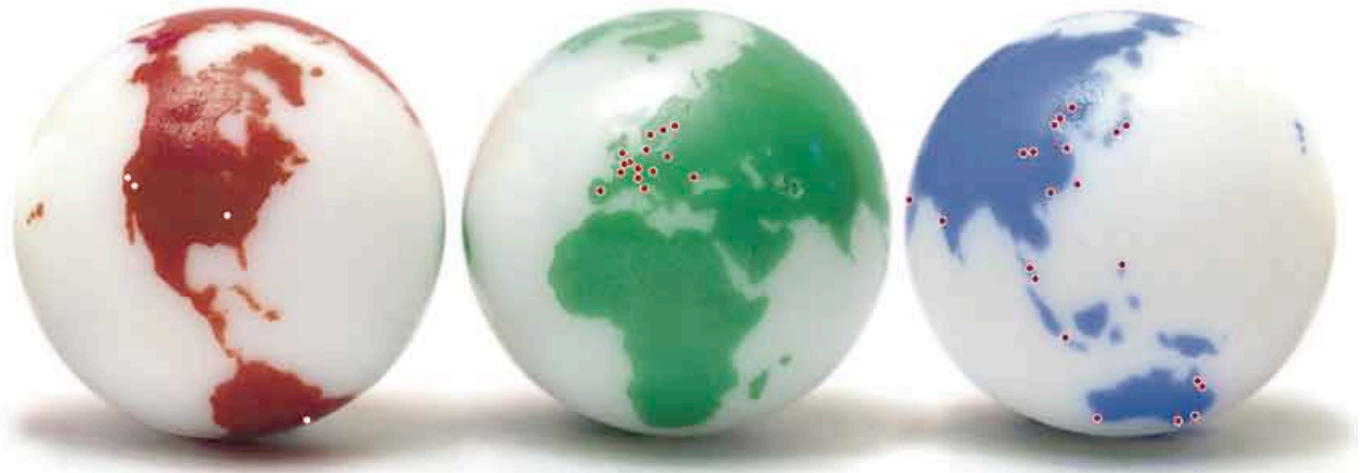

The technical data is not binding. They neither constitute expressly warranted characteristics nor guaranteed properties nor a guaranteed durability. They are subject to modification. Our General Terms of Sale apply.

Adding Quality to People's Lives

Australia
George Fischer Pty Ltd
Riverwood NSW 2210 Australia
Phone +61(0)2/9502 8000
australia.ps@georgfischer.com
www.georgfischer.com.au

Austria
Georg Fischer
Rohrleitungssysteme GmbH
3130 Herzogenburg
Phone +43(0)2782/856 43-0
austria.ps@georgfischer.com
www.georgfischer.at

Georg Fischer Fittings GmbH
3160 Traisen
Phone +43 (0)2762 90300
fittings.ps@georgfischer.com
www.fittings.at

Belgium / Luxembourg
Georg Fischer NV/SA
1070 Bruxelles/Brüssel
Phone +32(0)2/556 40 20
be.ps@georgfischer.com
www.georgfischer.be

Brazil
George Fischer Ltda
04795-100 São Paulo
Phone +55(0)11/5687 1311
br.ps@georgfischer.com

China
Georg Fischer
Piping Systems Ltd Shanghai
Pudong, Shanghai 201319
Phone +86(0)21/58 13 33 33
china.ps@georgfischer.com
www.cn.piping.georgfischer.com

Denmark / Iceland
Georg Fischer A/S
2630 Taastrup
Phone +45 (0)70 22 19 75
info.dk.ps@georgfischer.com
www.georgfischer.dk

France
Georg Fischer SAS
95932 Roissy Charles de Gaulle Cedex
Phone +33(0)1 41 84 68 84
fr.ps@georgfischer.com
www.georgfischer.fr

Germany
Georg Fischer GmbH
73095 Albershausen
Phone +49(0)7161/302-0
info.de.ps@georgfischer.com
www.georgfischer.de

India
Georg Fischer Piping Systems Ltd
400 076 Mumbai
Phone +91 224007 2001
in.ps@georgfischer.com
www.georgfischer.in

Italy
Georg Fischer S.p.A.
20063 Cernusco S/N (MI)
Phone +3902/921 861
it.ps@georgfischer.com
www.georgfischer.it

Georg Fischer TPA Srl
Via Bonazzi, 32
IT-40013 Castel Maggiore (BO)
Phone +39 051-632 42 11
tpa.ps@georgfischer.com
www.alprene.com

Japan
Georg Fischer Ltd
556-0011 Osaka,
Phone +81(0)6/6635 2691
jp.ps@georgfischer.com
www.georgfischer.jp

Korea
Georg Fischer Piping Systems
Guro-3 dong, Guro-gu, Seoul, Korea
Phone +82(0)2 2081 1450
Fax +82(0)2 2081 1453
kor.ps@georgfischer.com

Malaysia
Georg Fischer (M) Sdn. Bhd.
40460 Shah Alam, Selangor
Phone +60 (0)3-5122 5585
conne.kong@georgfischer.com

Mexico
Georg Fischer S.A. de C.V.
Apodaca, Nuevo Leon
CP66636 Mexico
Phone +52 (81)1340 8586
Fax +52 (81)1522 8906

Middle East
George Fischer Piping Systems
Dubai, United Arab Emirates
Phone +971 4 289 41 20
gfdubai@emirates.net.ae
www.piping.georgfischer.com

Netherlands
Georg Fischer N.V.
8161 PA Epe
Phone +31(0)578/678 222
nl.ps@georgfischer.com
www.georgfischer.nl

Georg Fischer WAGA NV
NL-8160 AG Epe
Phone +31 (0)578-678 378
waga.ps@georgfischer.com
www.waga.nl

Norway
Georg Fischer AS
1351 Rud
Phone +47(0)67 18 29 00
no.ps@georgfischer.com
www.georgfischer.no

Poland
Georg Fischer Sp. z o.o.
02-226 Warszawa
Phone +48(0)22/313 10 50
poland.ps@georgfischer.com
www.georgfischer.pl

Romania
Georg Fischer
Piping Systems Ltd
020257 Bucharest - Sector 2
Phone +40(0)21/230 53 80
ro.ps@georgfischer.com

Russia
Georg Fischer Piping Systems
Moscow 125047
Tel. +7 495 258 60 80
ru.ps@georgfischer.com

Singapore
George Fischer Pte Ltd
528 872 Singapore
Phone +65(0)67 47 06 11
sgp.ps@georgfischer.com
www.georgfischer.com.sg

Spain / Portugal
Georg Fischer S.A.
280046 Madrid
Phone +34(0)91/781 98 90
es.ps@georgfischer.com
www.georgfischer.es

Sweden / Finland
Georg Fischer AB
12523 Älvsjö-Stockholm
Phone +46(0)8 506 775 00
info.se.ps@georgfischer.com
www.georgfischer.se

Switzerland
Georg Fischer
Rohrleitungssysteme (Schweiz) AG
8201 Schaffhausen
Phone +41(0)52 631 30 26
ch.ps@georgfischer.com
www.piping.georgfischer.ch

Taiwan
Georg Fischer Piping Systems
San Chung City, Taipei Hsien
Phone +886 2 8512 2822 Ext. 15
Fax +886 2 8512 2823

United Kingdom / Ireland
Georg Fischer Sales Limited
Coventry, CV2 2ST
Phone +44(0)2476 535 535
uk.ps@georgfischer.com
www.georgfischer.co.uk

USA / Canada / Latin America / Caribbean
Georg Fischer LLC
Tustin, CA 92780-7258
Phone +1(714) 731 88 00
Toll Free 800/854 40 90
us.ps@georgfischer.com
www.us.piping.georgfischer.com

Export
Georg Fischer
Piping Systems (Switzerland) Ltd.
8201 Schaffhausen
Phone +41(0)52-631 30 26
Fax +41(0)52-631 28 93
export.ps@georgfischer.com
www.piping.georgfischer.ch