



**Waverley brownall**

## THE COMPANY



Waverley brownall has progressed to become a leading supplier of pipeline components, valves and instrumentation products; providing solutions for the most demanding applications.

Our philosophy is dominated by quality. Each Waverley brownall product is designed using state-of-the-art CAD technology and is subjected to rigorous quality control procedures.

Waverley has built its reputation for quality instrumentation among the largest industrial companies. Our products are used on systems where corrosion resistance, high pressures, clean room environments and high temperatures are critical factors.

A range of over 2000 standard products, manufactured in the UK or sourced from approved suppliers are available ex-stock to assure you of immediate delivery whilst our engineers provide complete technical support and can assist in the design and development of custom-made solutions.

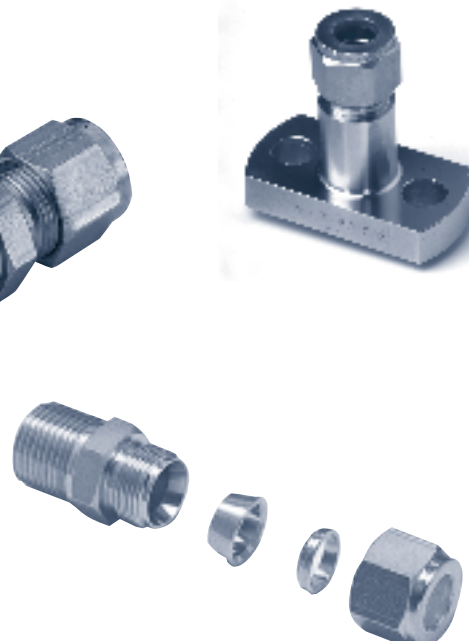
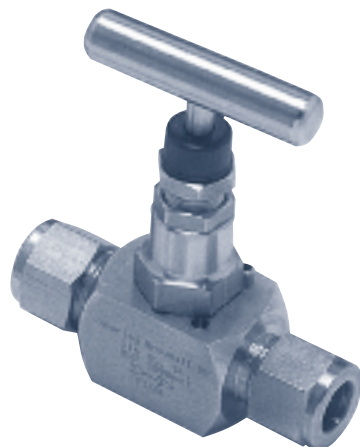
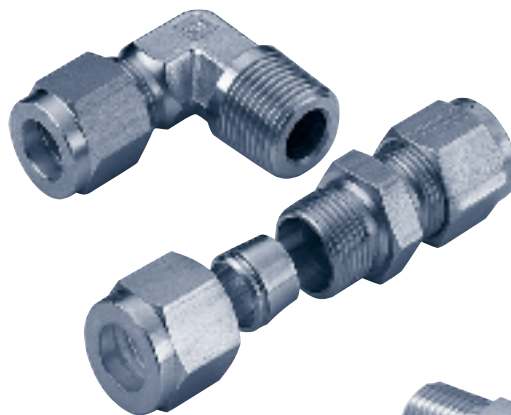
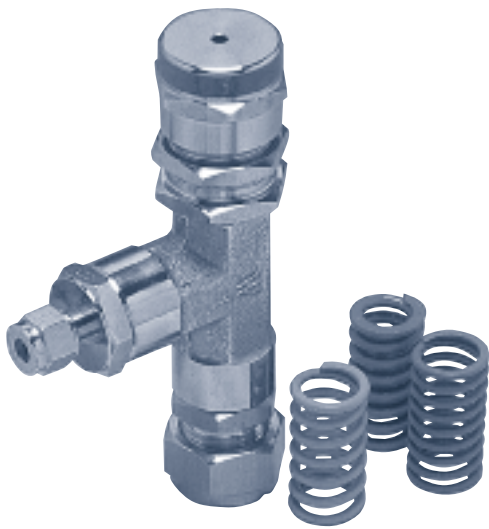

# APPROVALS

Our dedication to quality has led to us being awarded and maintaining BS EN ISO 9001 since 1986.

We also hold certificates of product conformance and approvals which include:

- LLOYDS** type approval to BS part 4
- LLOYDS** general approval for classified installations
- TUV** type approval
- AF KONTROLL** design approval
- BRITISH GAS** approved supplier
- BRITISH PETROLEUM** approved supplier
- BRITISH NUCLEAR FUELS** approved supplier
- SHELL** approved supplier
- TEXACO** approved supplier
- CEGB** approval
- POWERGEN** approved supplier
- EUROPEAN GAS TURBINES** approved supplier
- AMERICAN BUREAU OF SHIPPING** type approval



## UK Sales

Waverley brownall Ltd  
46, The Vintners, Temple Farm Industrial Estate  
Southend-on-Sea, Essex SS2 5RZ  
Tel: +44 (0)1702 600014  
Fax: +44 (0)1702 613600  
email: [sales@waverleybrownall.co.uk](mailto:sales@waverleybrownall.co.uk)  
[www.waverleybrownall.co.uk](http://www.waverleybrownall.co.uk)

Waverley brownall offer one of the widest ranges of O.D. compression fittings in the world.

Our compression fittings were developed to satisfy the stringent needs of a vast range of industries operating in the most exacting environments and conditions. The product range includes:

Ringlok® twin ferrule fittings. This is a high pressure fully gaugeable fitting produced in 316 Stainless Steel, Monel, 6MO Stainless, Titanium, Incoloy and Duplex. Available with BSPT, BSPP and NPT male and female stud threads.

Duoloc® single ferrule fittings. This is a high pressure fully gaugeable fitting which has been extensively used for onshore application for over 30 years. Produced in 316 Stainless Steel and plated Carbon Steel these fittings are available with BSPT, BSPP and NPT male and female threads.

**The Waverley brownall range of compression fittings are available to suit both imperial and metric tube sizes from 1/8" O.D to 1" O.D. and from 4mm to 25mm O.D.**

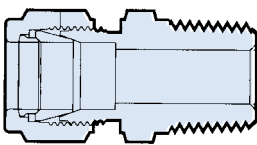

**Male Stud Coupling  
BSPT or NPT**

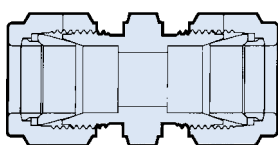

**Straight Coupling**

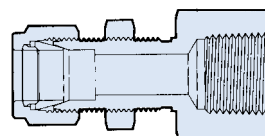

**Female Bulkhead Coupling  
BSPT or NPT**

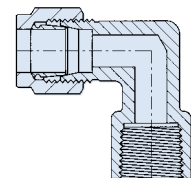

**Female Stud Elbow  
BSPT or NPT**

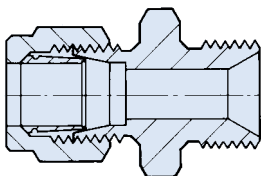

**Male Stud Coupling  
BSPP**

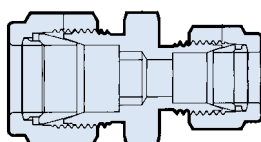

**Reducing Coupling**

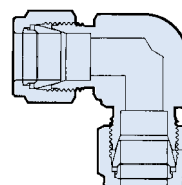

**Equal Elbow**

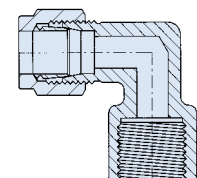

**Female Stud Elbow  
BSPP**

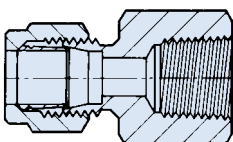

**Female Stud Coupling  
BSPT or NPT**

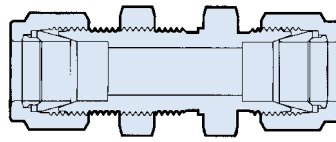

**Bulkhead Coupling**

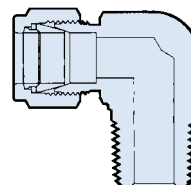

**Male Stud Elbow  
BSPT or NPT**

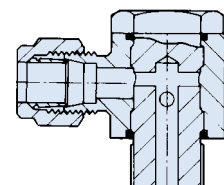

**Banjo Coupling**

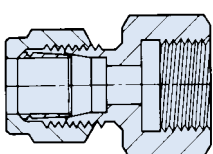

**Female Stud Coupling  
BSPP**

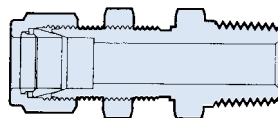

**Male Bulkhead Coupling  
BSPT or NPT**

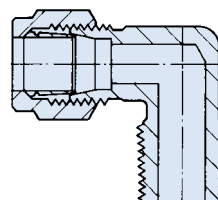

**Male Stud Elbow  
BSPP**

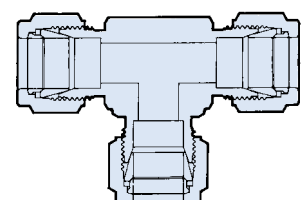

**Equal Tee**

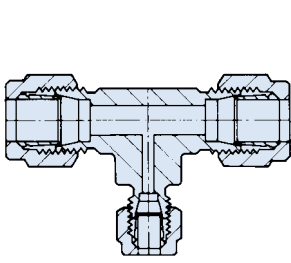

**Tee Unequal Branch**

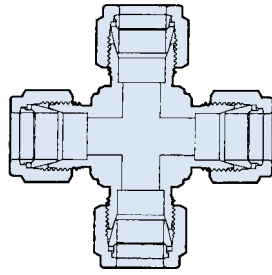

**Equal Cross**

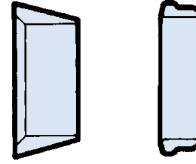

**Front and Back Rings**

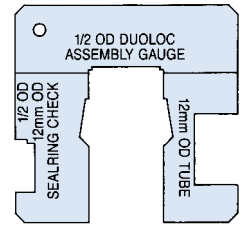

**Assembly Check Gauge Duoloc**

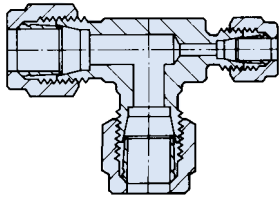

**Tee Unequal Run**

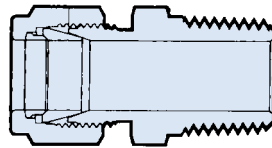

**Thermocoupling  
BSPT or NPT**



**Single Ferrule**

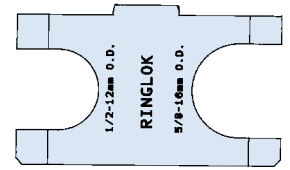

**Assembly Check Gauge Ringlok**

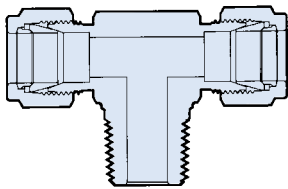

**Tee Male Stud Branch  
BSPT or NPT**

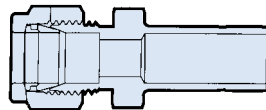

**Reducing Adaptor**

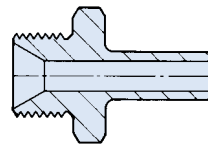

**Male Standpipe BSPP**

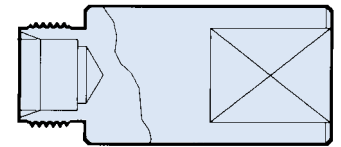

**Pre-forming Tool**

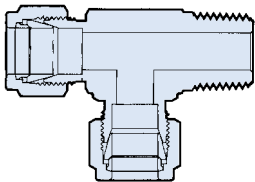

**Tee Male Stud Run  
BSPT or NPT**

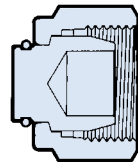

**Blanking Plug**

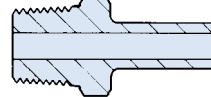

**Male Standpipe  
BSPT or NPT**

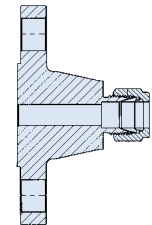

**Flange Connector**

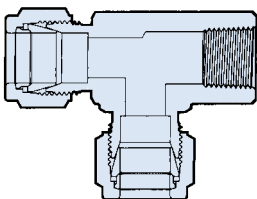

**Tee Female Stud Run  
BSPT or NPT**

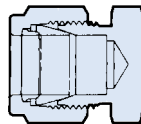

**Blanking End**

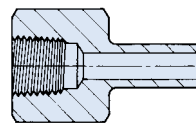

**Female Standpipe  
BSPT or NPT**

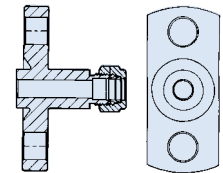

**Flange Adaptor**

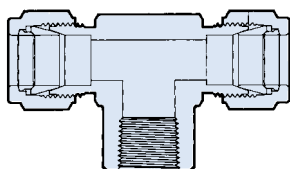

**Tee Female Stud Branch  
BSPT or NPT**

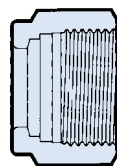

**Compression Nut**

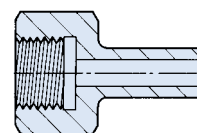

**Female Standpipe  
BSPP**

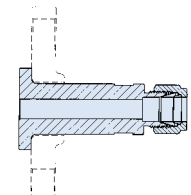

**Lapped Joint**

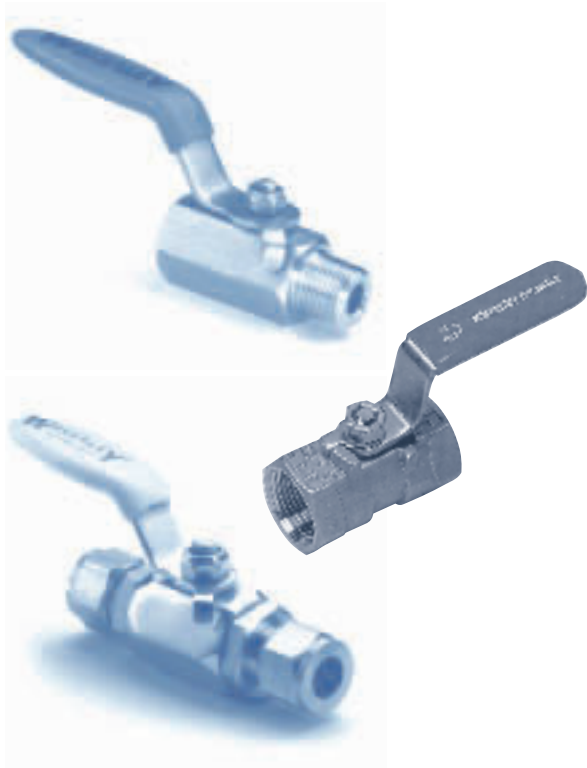

Waverley brownall 316 bar stock Ball Valves are available in 1000lb, 3000lb or 6000lb class with a wide range of thread forms and end connections. These valves are designed to be compact and reliable, and are manufactured in the UK to exacting standards. The size range extends from 1/4" to 1" in NPT, BSPT and BSPP thread forms or with O.D. compression ends ranging from 1/4" (6mm) to 1" (25mm) in either single (Duoloc®) or twin (Ringlok®) ferrule types.

The low cost range of cast 316 Ball Valves are rated to 1000 psi and are available in single piece reduced bore or two and three piece full bore models.

The size range extend from 1/4" to 2" in all three body types.



**Male/Female 1000lb Class  
BSPT or NPT**



**Male/Male 1000lb Class  
BSPT or NPT**



**Female/Female 1000lb Class  
BSPP, BSPT or NPT**

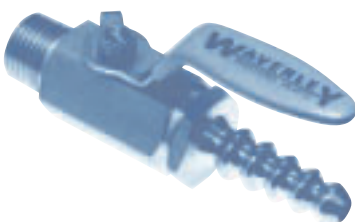

**Male/Straight Hose Tail 1000lb Class  
BSPT or NPT**



**Female/Straight Hose Tail 1000lb Class  
BSPT or NPT**



**Male 90° Hose Tail 1000lb Class  
BSPT or NPT**



**Female 90° Hose Tail 1000lb Class  
BSPT or NPT**

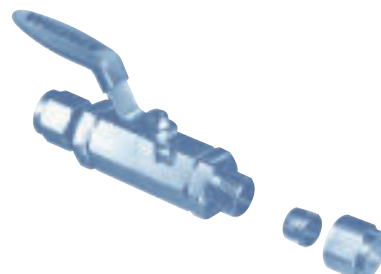

**Duoloc® Single Ferrule OD Compression  
1000lb Class**

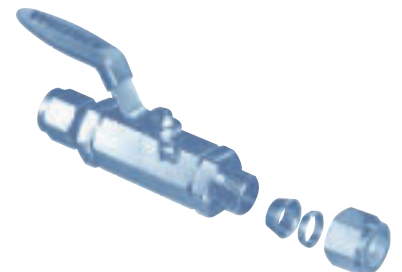

**Ringlok® Twin Ferrule OD Compression  
1000lb Class**



**Female/Female 3000lb and 6000lb Class  
BSPP, BSPT or NPT**



**Male/Female 3000lb and 6000lb Class  
BSPP, BSPT or NPT**



**Male/Male 3000lb and 6000lb Class  
BSPP, BSPT or NPT**

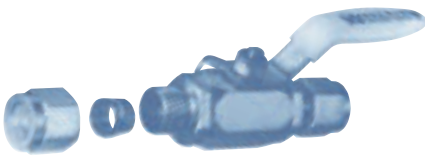

**Duoloc® Single Ferrule OD Compression  
3000lb and 6000lb Class**



**Ringlok® Twin Ferrule OD Compression  
3000lb and 6000lb Class**



**Combination of ends  
3000lb and 6000lb Class**

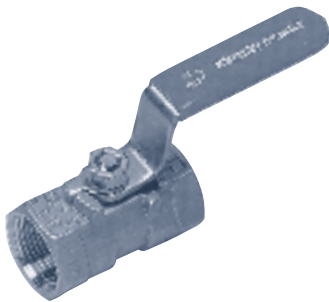

**Single Piece Cast Valve 1000lb Class**



**Two Piece Full Bore 1000lb Class**

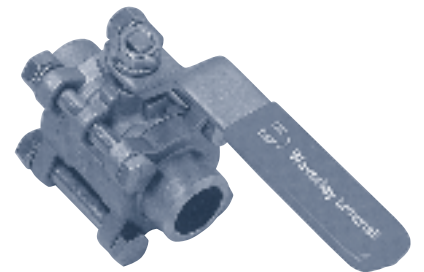

**Three Piece Full Bore 1000lb Class**



**Lockable Handle available for all valves**



**Three way Ball Valve**



**Actuated Ball Valve**

## CHECK VALVES

The Waverley brownall CV series Check Valves are designed to give unidirectional flow control of liquids and gases with a minimal pressure drop. The valves are precision machined from 316 stainless steel bar stock and are available with either PTFE or Viton seals. The CV series valves have a safe working pressure up to 3000psi and can be supplied with a choice of springs to give a variety of cracking pressures. Inlet and outlet port connections range from 1/4" to 1" in NPT, BSPT and BSPP thread forms or with O.D. compression ends in either single (Duoloc®) or twin (Ringlok®) ferrule types.

The Mini series check valve is a compact one piece body check valve for unidirectional control of flow up to 6000psi. Available with 1/4" or 1/2" NPT male connections. The Mini series valve is also available with an adjustable spring to give a variety of cracking pressures.

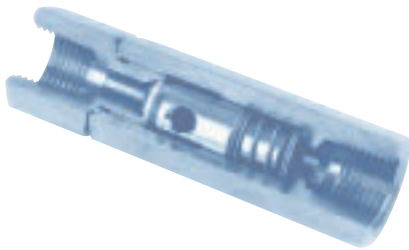

**Female/Female  
BSPP, BSPT or NPT**



**Male/Female  
BSPP, BSPT or NPT**



**Male/Male  
BSPP, BSPT or NPT**



**Duoloc® Single Ferrule OD Compression**



**Ringlok® Twin Ferrule OD Compression**



**Mini Series Check Valve**



The Waverley brownall Pressure Relief Valve is a precision manufactured valve produced from high tensile forgings and 316 stainless steel bar stock with a safe working pressure up to 6000psi. The valves have a special design feature which enables a large variety of end connectors to be used in any combination. The size range extends from 1/4" to 1" in BSPT, BSPP or NPT female or male ends, and O.D. compression ends in either single (Duoloc®) or twin (Ringlok®) ferrule connectors.

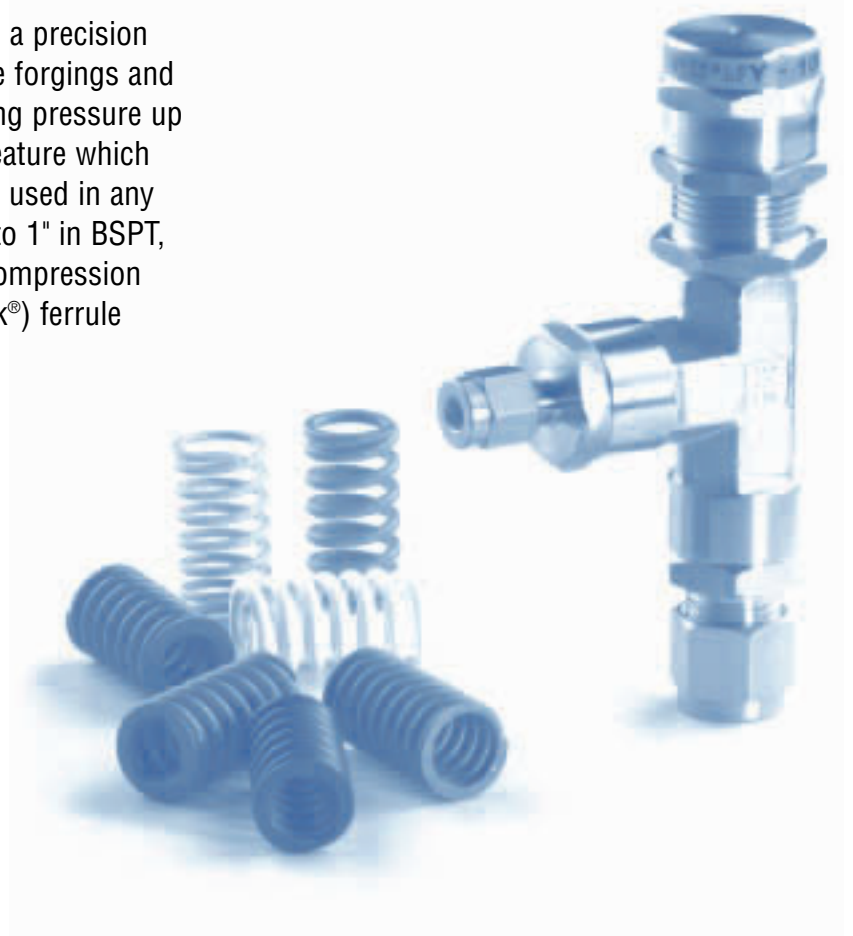

## INLINE FILTER



The Waverley brownall Inline Tee Filter is a general purpose product which is designed to provide a simple solution for removing system contamination from flow media. It is designed for liquid or gas applications and for pressures up to 6000psi. It also incorporates a variety of elements and inlet and outlet port connections including O.D. compression ends in either single (Duoloc®) or twin (Ringlok®) ferrule connectors.

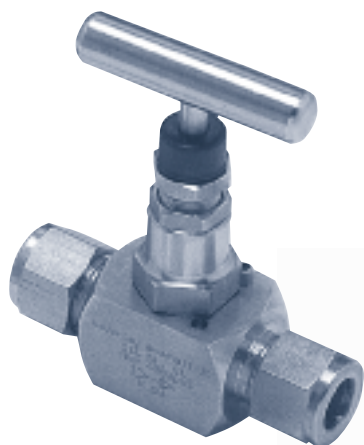

The Waverley brownall Needle Valve is designed and manufactured in the UK to the highest standards to meet the requirements of the severe applications anticipated for this type of valve.

The valves are available with a wide range of end connections from 1/4" to 1/2" in male or female with NPT and BSP threads. It is also available with single (Duoloc®) or twin (Ringlok®) compression ends from 1/4" OD to 1/2" OD or 6mm OD to 12mm OD.

The design incorporates a split stem with a non rotating ball tip which ensures accurate seating and a bubble tight seal. The standard material is 316L stainless steel and available for applications up to 10,000psi and temperatures of 400°C. Each valve can also be supplied with a vent plug.

Waverley brownall 316 stainless steel Manifolds are available as 2 way, 3 way and 5 way in either direct or remote format. Connections are 1/2" NPT as standard with an extended operating pressure up to 10,000psi.



The Waverley brownall Monoflange provides an ideal alternative to multivalve systems. It is designed to give isolation, venting and instrument mounting in a single compact manifold. The design also incorporates an outside screw and yoke (OS & Y) arrangement for the primary isolation valve. The unit is supplied with flange connections for the process side and either twin (Ringlok®) ferrule OD ends or 1/2" NPT female connections for the instrument side.

## HIGH PRESSURE PRECISION PIPE FITTINGS

The Waverley brownall Precision Pipe fitting range offers a fitting with high integrity and strength. The fittings are UK manufactured to the highest standards from quality 316 forgings or 316 stainless steel bar stock and have a safe working pressure depending on size of up to 6000psi. The size range extends from 1/8" to 2" with either NPT or BSPT threads.

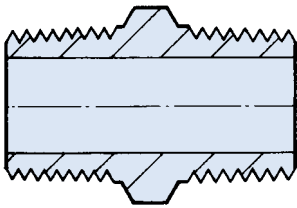

**Hexagon Nipple**  
BSPT or NPT



**Square Head Plug**  
NPT

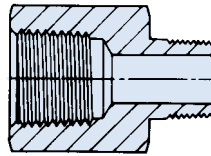

**Reducing Adaptor**  
BSPT or NPT

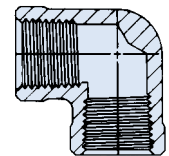

**Female Elbow**  
BSPT or NPT

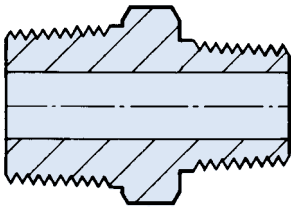

**Hexagon Reducing Nipple**  
BSPT or NPT

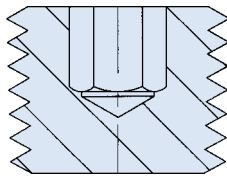

**Socket Head Plug**  
BSPT or NPT

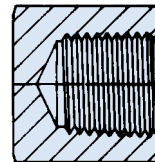

**Hexagon Pipe Cap**  
NPT

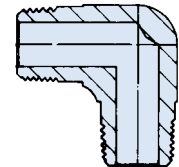

**Male Elbow**  
BSPT or NPT

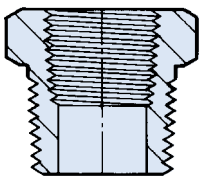

**Reducing Bush**  
BSPT or NPT

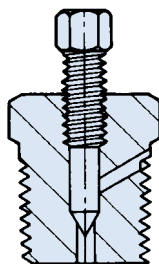

**Vent Plug**  
BSPT or NPT

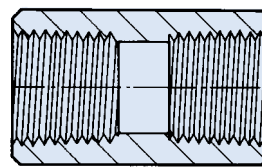

**Full Coupling**  
NPT

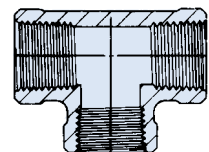

**Female Tee**  
BSPT or NPT

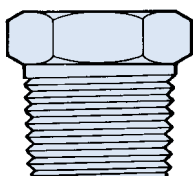

**Tapered Plug**  
BSPT or NPT

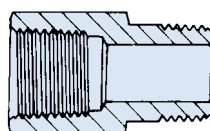

**Straight Adaptor**  
BSPT or NPT

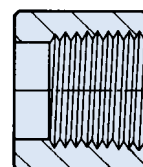

**Half Coupling**  
NPT

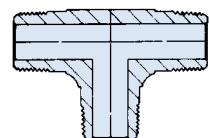

**Male Tee**  
BSPT or NPT

Waverley brownall offer a wide range of 60° BSP hose fittings and adaptors from 1/8" to 2" BSP. These fittings are all UK manufactured from 316 stainless steel bar stock and have a safe working pressure up to 3000psi.

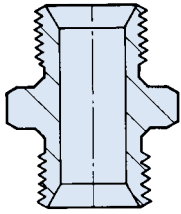

**BSP Male Union**

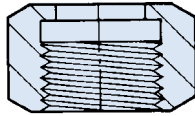

**Union Nut**

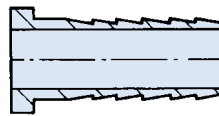

**Square Hose Adaptor**

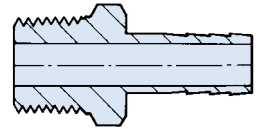

**BSPT or NPT  
Male Hose Adaptor**

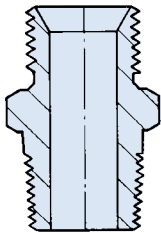

**BSPT or NPT  
Male Union**

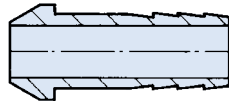

**60° Cone Adaptor**

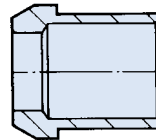

**Tube Nipple**

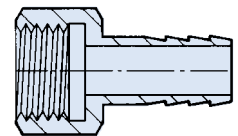

**BSP Female Hose Adaptor**

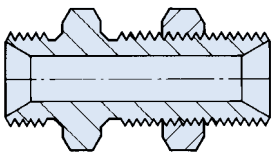

**BSP Bulkhead Union**

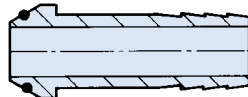

**Finger Tight Hose Adaptor**

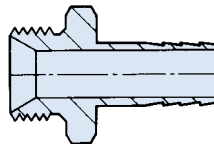

**BSP Male Hose Adaptor**

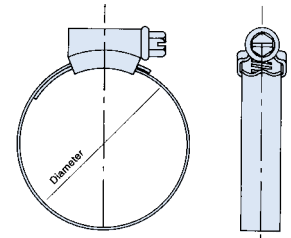

**Hose Clips**

## PLUGS BUSHES AND SEALS

The range of Waverley brownall plugs and bushes are precision made in the UK from 316 stainless steel bar stock, and are available from 1/8" to 2" BSP.

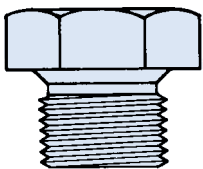

**BSP Plug**

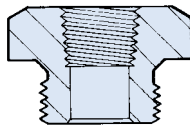

**BSP To NPT Screwed Bush**

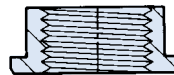

**Weld Boss**



**316 Seal Ring**

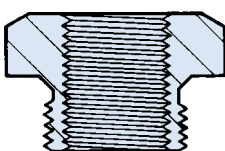

**BSP Screwed Bush**

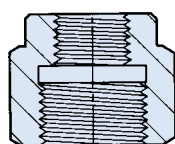

**Reducing Socket**

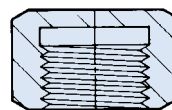

**Hexagon Cap**

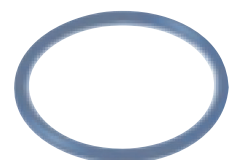

**PTFE and Nitrile Seals**

Waverley brownall offer a full range of quality low pressure 316 stainless steel screwed fittings. these BSP fittings are available ex stock in sizes ranging from 1/8" to 2" and have a safe working pressure of 150psi.

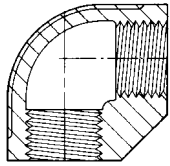

**90 Degree Elbow**

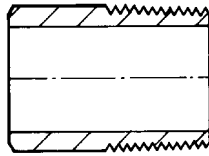

**Welding Nipple**

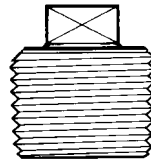

**Square Head Plug**

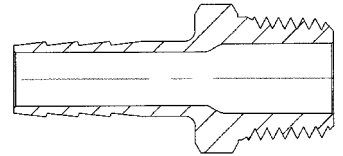

**Hose Connector (Nipple)**

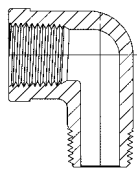

**Street Elbow**

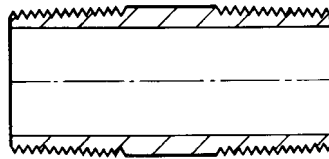

**Barrel Nipple**

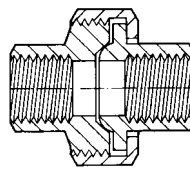

**Union F/F (Cone Seated)**

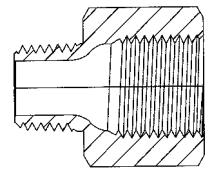

**Reducing Adaptor F/M**

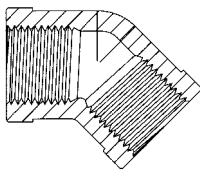

**45 Degree Elbow**

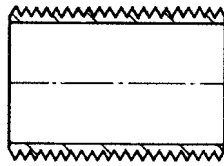

**Parallel Nipple**

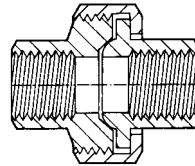

**Union F/F (Flat Type)**

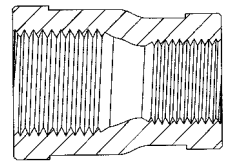

**Reducing Socket**

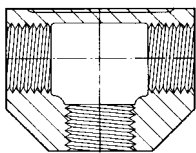

**Equal Tee**

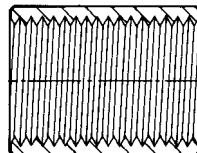

**Full Socket**

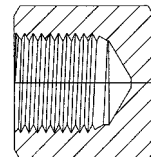

**Hexagon End Cap**

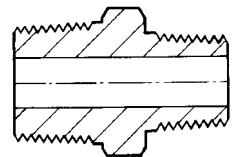

**Hexagon Reducing Nipple**

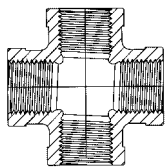

**Equal Cross**



**Half Socket**

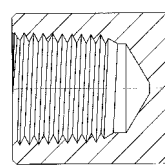

**Round End Cap**

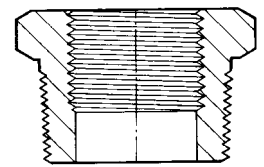

**Hexagon Reducing Bush**

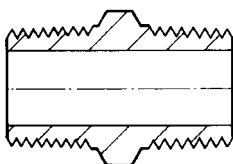

**Hexagon Nipple**

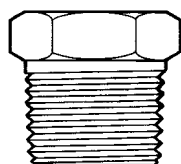

**Hexagon Head Plug**

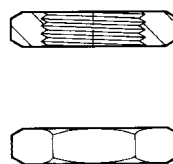

**Hexagon Back Nut**



**TUBE**

**FLANGES**



**SPECIAL SCREWED FITTINGS**

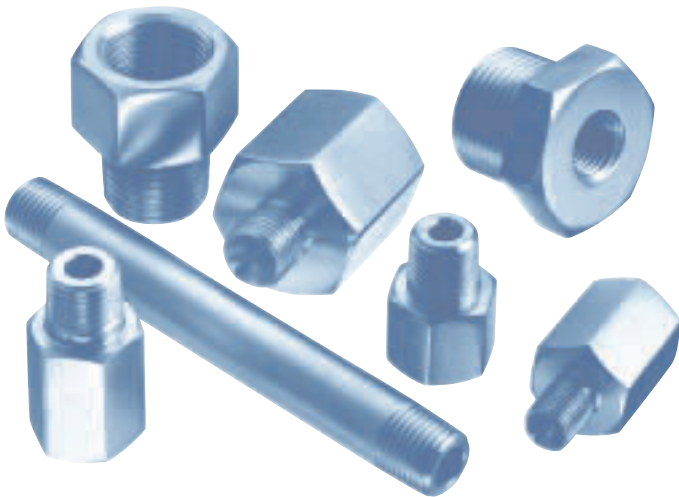

**PIPE CLAMPS**

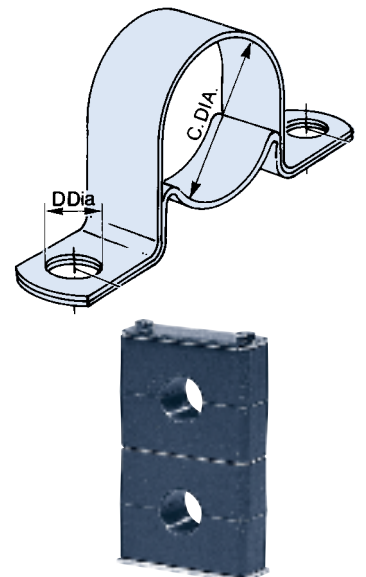
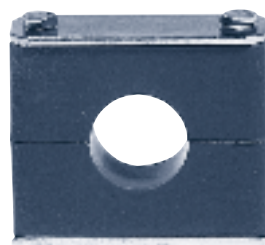



### Ring Binder Book

The complete Waverley brownall range is also shown in detail in a ring binder for ease of reference.



### Electronic Catalogue

The Waverley brownall electronic catalogue offers you a fast and accurate means of selecting the right 316 stainless steel fittings and valves for your instrumentation applications.



### LP Catalogue

The LP Brochure covers in detail all our 150lb class pipe fittings and the low cost cast ball valves plus full details of our 316 stainless steel LP ferrule range.

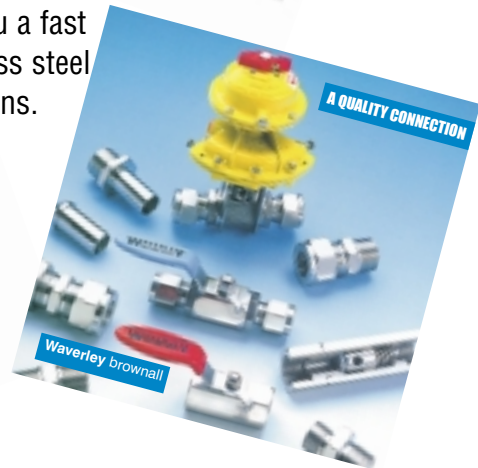



Providing Solutions

Waverley brownall Ltd  
46, The Vintners, Temple Farm Industrial Estate  
Southend-on-Sea, Essex SS2 5RZ  
Tel: +44 (0)1702 600014  
Fax: +44 (0)1702 613600  
email: [sales@waverleybrownall.co.uk](mailto:sales@waverleybrownall.co.uk)  
[www.waverleybrownall.co.uk](http://www.waverleybrownall.co.uk)