

imagine

BI-FOLD DOORS



The VEKA UK Group

Product Launch Document



Contents

4	Market Place	21	Discontinuations
6	Product Specification	22	Sales Literature
7	Features and Benefits	23	Photography
8	Technical manual	24	Price Lists
9	The ERA Guarantee	27	Marketing Communications
10	Bi-Fold Door Profile	28	PR
12	Gearing and Handle Assemblies		
18	Hardware Diagrams		
20	Colour Options		

The new Imagine Bi-Fold Door is a complete step change



It is the first product to be launched under the VEKA UK Group banner, and as such the attention to detail in this range is unparalleled. Its design, security measures, flexibility and even a robust insurance guarantee all combine to make it a world-class product.

Blurring the lines between where a home ends and a garden begins, Imagine Bi-Fold Doors create unique living spaces as versatile as they are beautiful. They are a stunning alternative to French or Patio Doors and can be specially installed so that the doors sit in or outside the property when folded back, creating a much tidier appearance. The Bi-Fold Doors are also available in a wide choice of woodgrain and coloured foils, from the popular Variations colour range, ensuring they enhance and complement any home.

Every part of our new Imagine range has been designed from scratch, meaning there's no making-do with existing parts or 'off the shelf' hardware. We've also collaborated with one of the top names in locks and security mechanisms to design an exclusive range of hardware including hinges, locks and handles that work in harmony with the range itself. The launch of our new range couldn't be more timely either.

Reports by independent industry research specialists D&G Consulting and Palmer Market Research show that by 2016, volume sales of PVC-U Bi-Fold Doors will have grown to 28% of the patio/sliding doors market – and 53% by value.

The market has never been more ready. To capitalise upon the launch of the Imagine Bi-Fold Door range, the company will embark on a major campaign to the industry, with the aim of increasing sales of the new range of colour finishes by creating demand. In addition to a significant trade advertising and PR campaign, the launch materials will also include consumer and trade brochures, which can be provided to the relevant stakeholders to best showcase the attributes of our new range.



Market Background

The UK Market for Bi-Fold doors is forecast to continue to grow strongly with D&G Consulting and Palmer Market Research predicting Bi-Folds accounting for 28% of the sliding and hinged door market by volume by 2016/17. Palmer forecasts that - Bi-Folds will account for 53% of this sector by value by 2017.

Forecast of the Patio Door market in home improvements in Great Britain to 2017 by Door Type

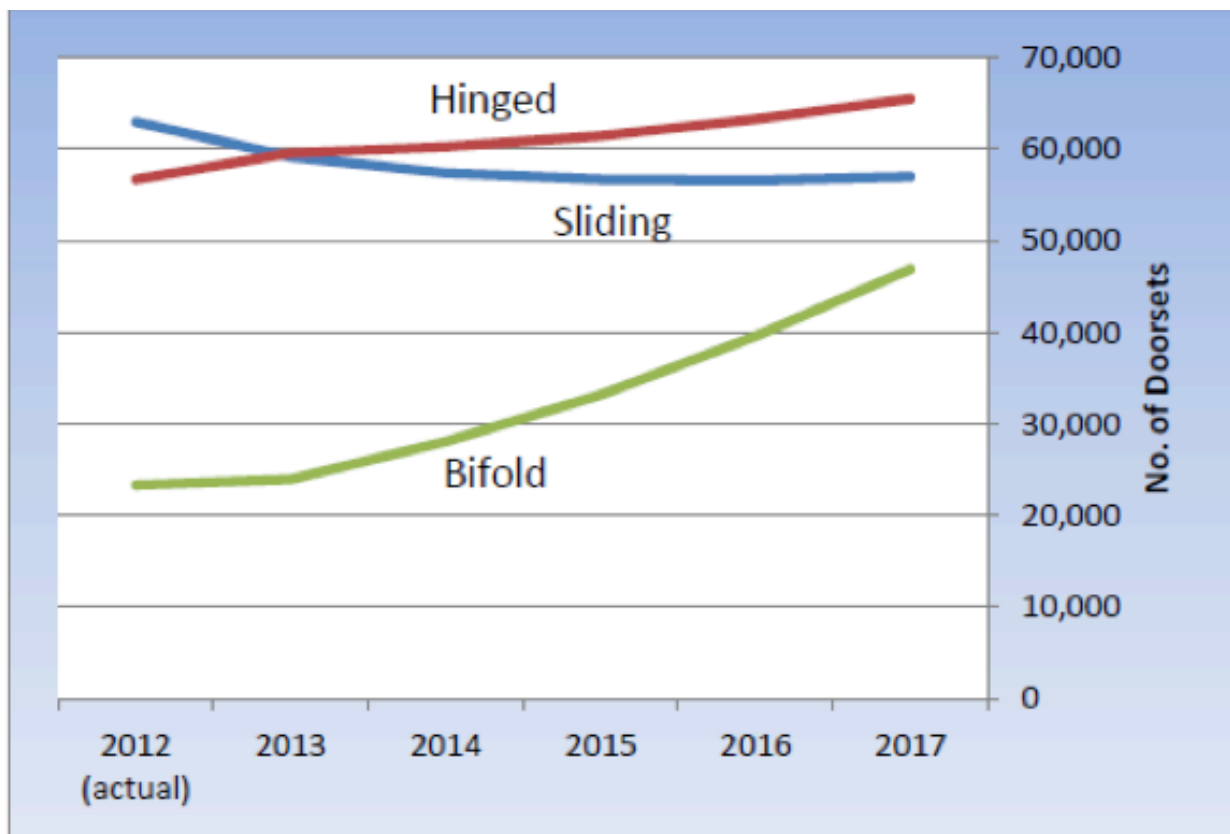

Frame materials of Patio Doors in Home Improvement in Great Britain by door type 2012

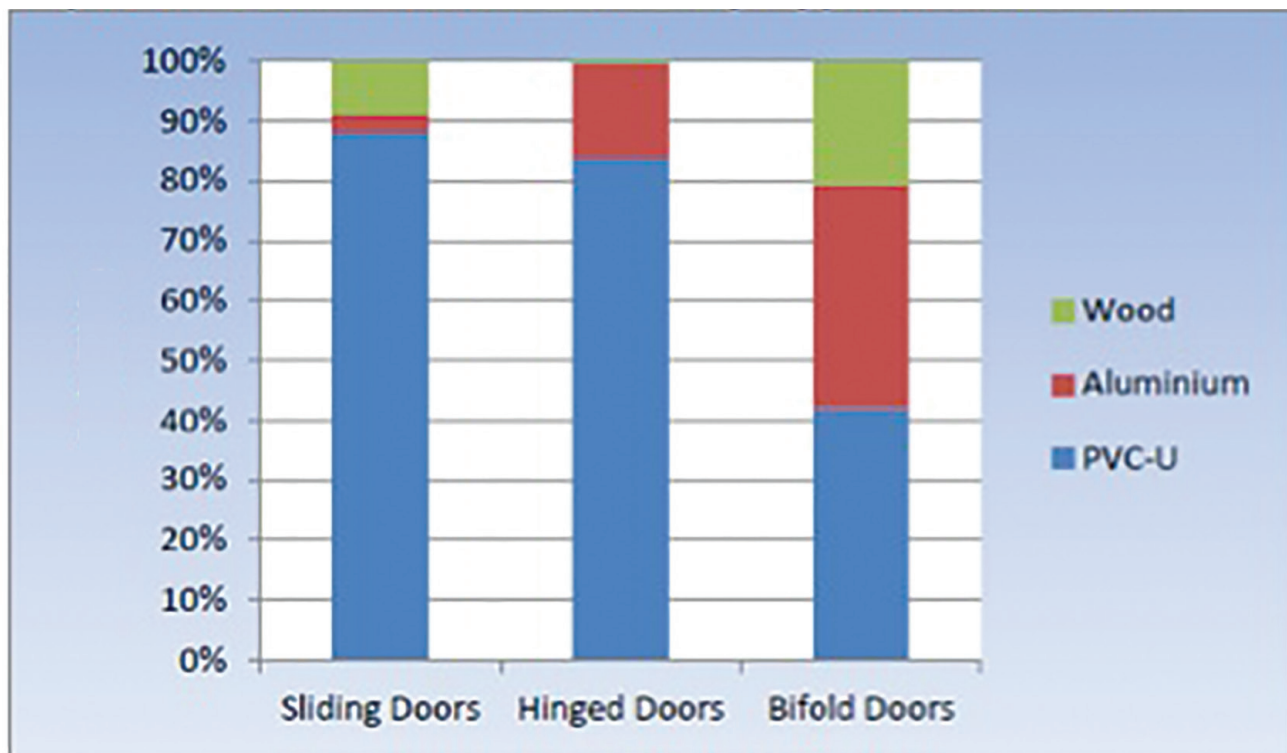

It is also worth noting that currently PVC-U Bi-Folds share the market with a disproportionately high proportion of Aluminium and Wood product compared to other product sectors. This is arguably due to some of the relatively poor PVC-U products that have been available over the years, and a number of fabricators and consumers have chosen other materials over PVC-U.

However with the emergence of much improved second generation PVC-U Bi-Folds and brand new products such as the Imagine Bi-Fold Door offering outstanding performance coupled with the usual PVC-U advantages. We fully expect PVC-U to gain more market share at the expense of Aluminium and Wood, as has been the case in other sectors.

Certainly, as you will find later in this document, the Imagine Bi-Fold Doors range delivers a package of features and benefits which will make it and outstanding amongst PVC-U product and a very attractive option where aluminium or wood may have been an historic preference

Product Specification

Door Configurations

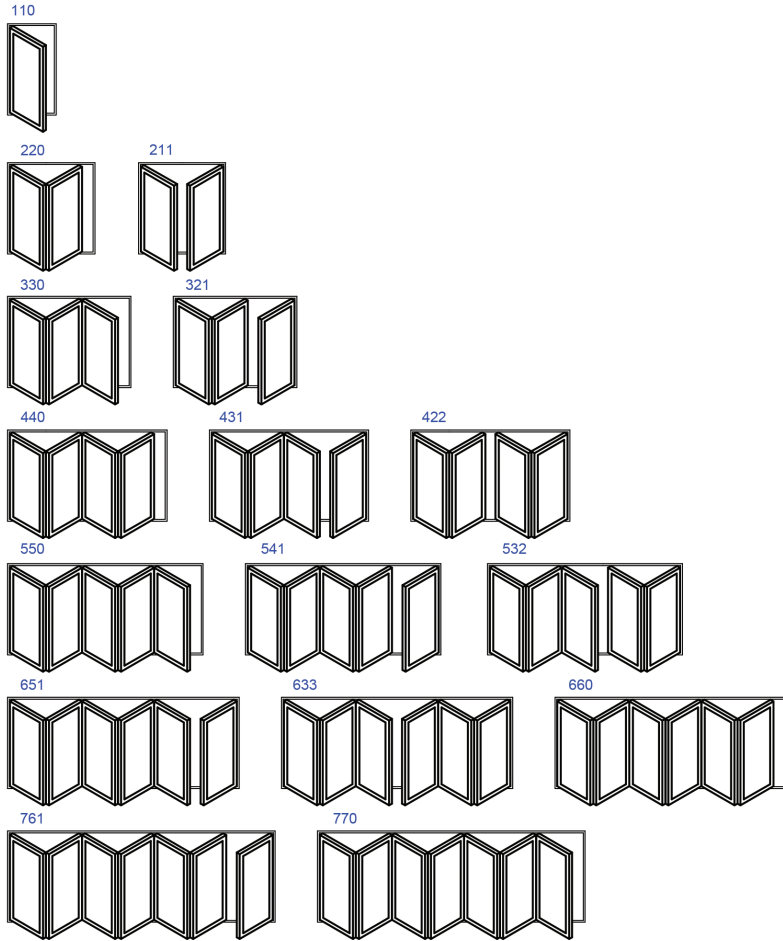

Maximum door width is 6000mm
 Maximum door height is 2400mm
 Maximum sash width is 1000mm
 Most common configurations are 3-3-0, 3-2-1 and 4-3-1

The number sequence is expressed as viewed from the outside, with number of sashes in total - number of folding sashes to the left - number of folding sashes to the right.

Imagine Bi-Fold Door Indicative Thermal Performance

The results quoted here are indicative ratings produced in-house by the VEKA Technical department.

Example One

- 28mm, 4-20-4 double glazed
- 1 leaf low iron glass
- 1 leaf soft coat
- Warm edge spacer
- Argon fill

Whole door U-Value = 1.35W/m²k
 Indicative DSER Rating = A 2

Example Two

- 44mm, 4-16-4-16-4 triple glazed
- 2 leaves float glass
- 1 leaf soft coat
- Warm edge spacer
- Argon fill

Whole door U-Value = 1.13W/m²k
 Indicative DSER Rating = A 4

Example Three

- 44mm, 4-16-4-16-4 triple glazed
- 1 leaf float glass
- 2 leaves soft coat
- Warm edge spacer
- Argon fill

Whole door U-Value = 0.94W/m²k
 Indicative DSER Rating = A +13

Features and Benefits



- The Imagine Bi-Fold Door has been designed in the UK for the UK market
- Designed "from the ground up", everything has been newly designed, not "making do" with existing parts.
- Profile and hardware will be supplied by the VEKA UK Group – single source supply for simplicity and improved lead-times
- Custom designed ERA hardware
- First VEKA UK Group product launched
- PAS24 and Secured by Design achievable from launch on standard doors using standard hardware – no modifications required
- Triple glazing ready – can accept up to 44mm units with sash weights handling up to 100kg
- Contemporary clean looks and slimmer sightlines
- In-line track – no unsightly fixing to outside of outerframe and improved weight distribution
- Fabricator and Installer friendly features (see hardware below)
- Outstanding thermal performance – U-values below 1.0 achievable with triple glazing
- Highest DSER A ratings achievable
- Backed by the ERA 5* Security Guarantee for homeowners' peace of mind
- Choice of sculptured or bevelled sashes and glazing beads
- Choice of 3 threshold options: standard outerframe, low threshold (Part M compliant when used with ramps) and ultra-low internal room divider
- Option of fully welded outerframe or mechanically jointed making it ideal for difficult to access properties
- Available in 16 different configurations, maximum 7 sashes, can be inward or outward opening, internally beaded
- Maximum width 6000mm, maximum door height 2400mm, maximum sash width 1000mm
- Stepped outerframe down to 70mm – ideal for coupling to existing frames in porches and conservatories
- 5 chamber sash and 6 chamber outerframe for excellent thermal performance
- Variations foils offer – Golden Oak and Rosewood ex-stock, 16 more colours available
- Fully tested to BS 6375: Part 1 Weather and BS 6375: Part 2 Durability

Hardware

- Developed in conjunction with ERA to and bespoke to the Imagine profile, designed to meet PAS24 and Secured by Design from launch
- Handles are suited for consistent and improved aesthetics
- Choice of gasket colour & hinges – black or white
- Handles available in white, black, chrome & gold
- A wide 38mm hardware groove to accept more substantial locks and provide a much neater appearance
- Fully adjustable hinges, so no need to take the doors off to adjust them – fully adjustable in situ
- 2D adjustable lock keep – so no need to remove the sash for adjustment and also quicker when setting the doors in the factory prior to installation
- Corner block, self-locating top & bottom hinge / roller unit – means you don't need to jig drill, less work for fabricators measuring/drilling. Only required to jig drill for the centre hinge
- Low profile handle design allows the tightest possible closure when folded back – only a 21mm gap between the fully opened leaves
- Door is designed to be fully DDA (Disability Discrimination Act) compliant where required, including handle heights
- Premium quality magnets keep the doors tidily in place once fully opened
- Choice of 4 colours of magnets
- Adjustable locks & shootbolts provides additional compression & security
- Optional key locking on all auxiliary doors
- The hinge fully wraps around into the profile which vastly increases strength & stability
- Dedicated lock provided in a 2-2 style door – not just relying on espags either side
- Hook Locks are Bi-Directional for extra security



Technical Manual

A comprehensive 112 page Technical Manual is available to support the Imagine Bi-Fold Doors range. A copy is included on the memory stick within the launch pack, and the master version will be password protected on the VEKA website. The Technical department are available to assist with any aspect of this manual.

Training

Fabricators of the Imagine Bi-fold Door will need to have completed specialist training at Burnley before fabrication can commence. This training can be used to make their own showroom display door and a certificate will be issued.



The ERA five star guarantee

By fitting high-security ERA components on our range, we are proud to be able to cover our products with the UK's most comprehensive home security guarantee.



Five major benefits to homeowners:

Savings on the cost of your home insurance

Fitting your doors with the highest levels of security means you can save money on your home insurance, year after year. Most insurers recognise that having high security hardware on your doors and windows reduces the risk of forced entry, therefore resulting in reduced premiums.

24/7 help

The Five Star Guarantee gives you access to a FREE call out service that operates 24 hours a day, 365 days a year. So you will have the reassurance of knowing that in the unlikely event of a forced entry through an Imagine door, someone will always come to secure your property. No questions asked.

Up to £1,000 excess paid

We're confident of the quality and reliability of our components and the security provided by them, that we guarantee them against forced entry for 10 years. We will even pay the excess on any home insurance claim due to the failure of one of our products - so you can rest assured that you're covered.

Up to £1,000 towards a repair or replacement

We are so confident that our latest products will outwit any would be burglars that, if the ERA Five Star Guarantee approved component fails, we will pay up to £1,000 towards the cost of replacing or repairing your Imagine door.

A £1,000 cheque to compensate you

In the unlikely event of a break-in succeeding through the failure of our ERA Five Star Guaranteed doors, you will be given a cheque for £1,000 to compensate you for the inconvenience caused.

To explain this Guarantee to both the installer and the homeowner, the following marketing materials are available. Branded specifically for the Imagine Bi-Fold Door range, literature includes the procedure required for registering an installation and, if need be, making a claim.

- Consumer leaflet – 16pp A5
- Fabricator Guide – 8pp A4
- Installer Flyer – 2pp A4
- Display posters x 5 sorts



Bi-Fold Door Profile

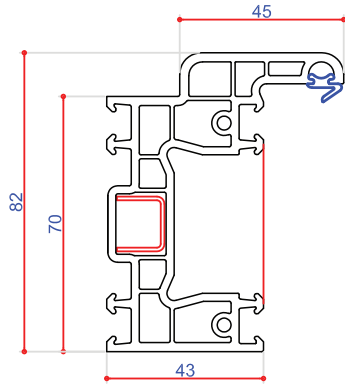

65mm Outer Frame 105174

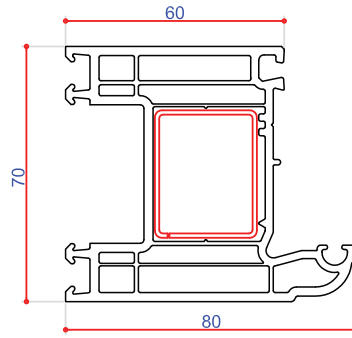

80mm Featured Sash 105175

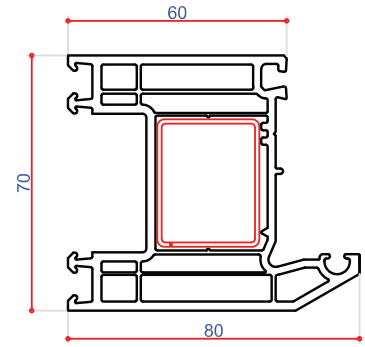

80mm Chamfered sash 105176

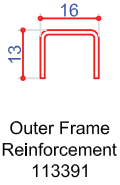

Outer Frame Reinforcement 113391

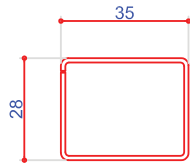

Sash Reinforcement 713191

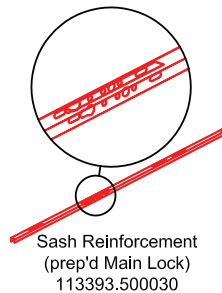

Sash Reinforcement (prep'd Main Lock) 113393.500030

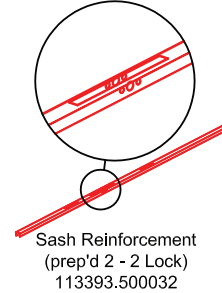

Sash Reinforcement (prep'd 2 - 2 Lock) 113393.500032

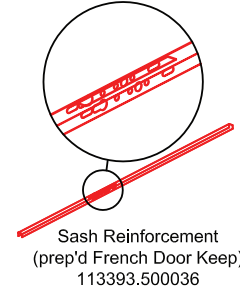

Sash Reinforcement (prep'd French Door Keep) 113393.500036



Moulded Gasket Corner 1 112447
#Available Black or White



Moulded Gasket Corner 2 112448
#Available Black or White

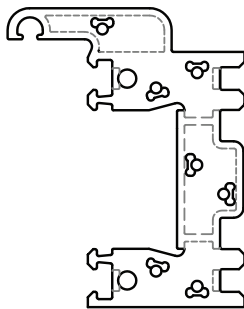
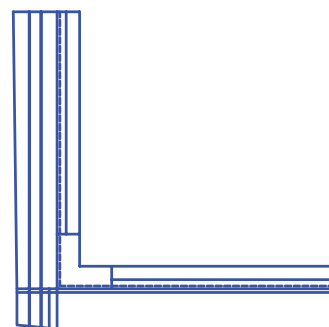
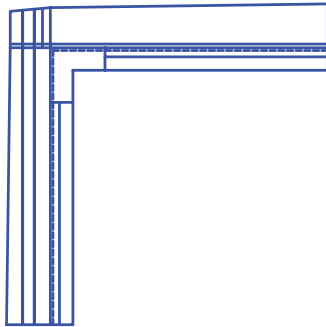

Thermally Broken Threshold Mechanical Joint 109998

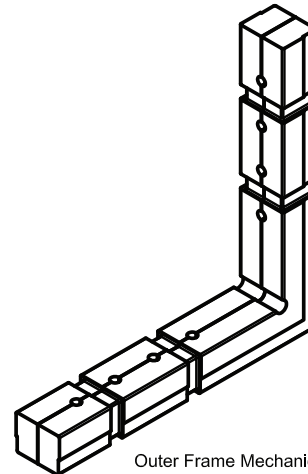
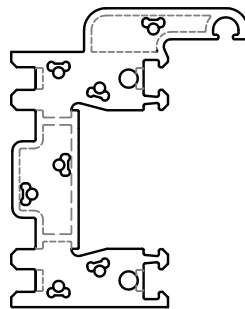

Outer Frame Mechanical Joint Moulded Cleat 141430

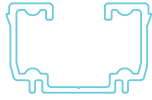

Track 104,393
Champagne Only

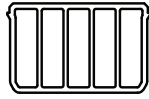

Outer Frame Thermal
Insert 105177
Available White,
Brown and, Caramel

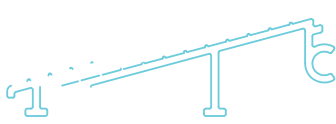

Threshold Ramp 104391
Champagne Only



Low Threshold 104392
Champagne Only

Threshold Blanking
Piece 104394
Champagne Only



Room Divider Threshold 104390
Champagne Only



28mm Feature Glazing
Bead 107153



28mm Chamfered
Glazing Bead 107154



32mm Glazing
Bead 107217



36mm Glazing
Bead 107218



40mm Glazing
Bead 107228



Moulded Gasket Corner 3 112449
#Available Black or White



Moulded Gasket Corner 4 112454
#Available Black or White



Traffic Door Gasket
112455
#Available Black or White

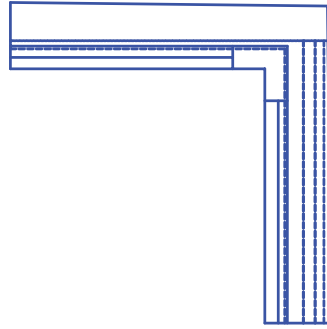
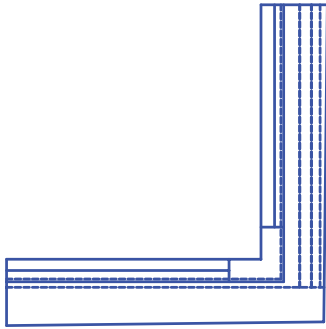

Sash Blanking Gasket
112453
#Available Black or White

Moulded Gasket Corner 3 112449
#Available Black or White

Moulded Gasket Corner 4 112454
#Available Black or White

Frame and Sash Seal
112451
#Available Black or White

Frame & Sash Flipper
Seal 112452
#Available Black or White

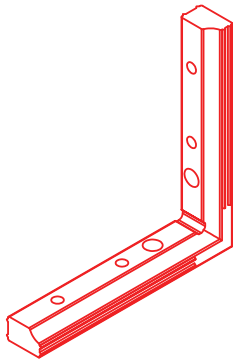

Outer Frame Mechanical
Joint Cleat 141429

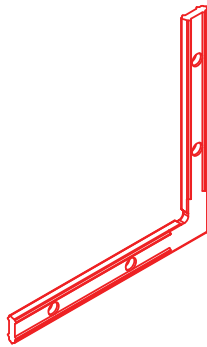

Outer Frame Mechanical
Joint Chevron 141431

KEY:

-  PVC Profile
-  Gasket
-  Steel
-  Aluminium

DO NOT SCALE the drawings shown are visual representations only. VEKA PLC has the right to alter the designs, specification & descriptions without prior notice as part of our policy of continuous development and improvements.

Bi-Fold Door Ancillaries

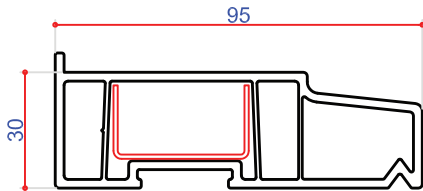

95mm Cill 110074
 Steel U Channel 35 x 19mm 113377
 End Cap 109074

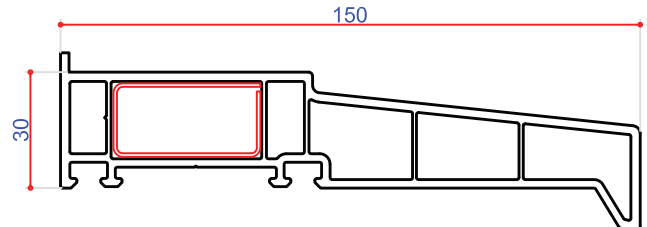

95mm Cill 110075
 Steel U 38 x 19 113317
 Steel Box 38 x 19 113245
 End Cap 109075

Straight Cill Joint 109085
 135° Cill Joint 109084
 90° Cill Joint 109089

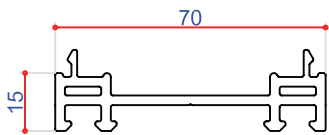

15mm Frame Extension 114028

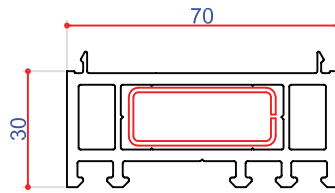

30mm Frame Extension 114014
 Steel Box 38 x 15mm 113073

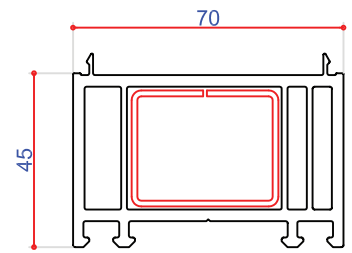

45mm Frame Extension 114202
 Steel Box 38 x 30mm 113271

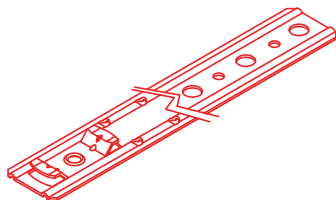

Frame Fixing Bracket
 141428
 available sizes 175, 200 & 250mm

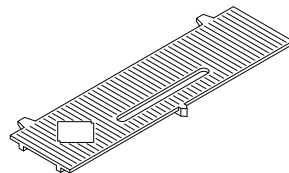

Clip-in Packer
 109377

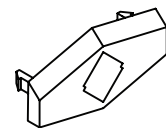

Drainage Cap
 109267

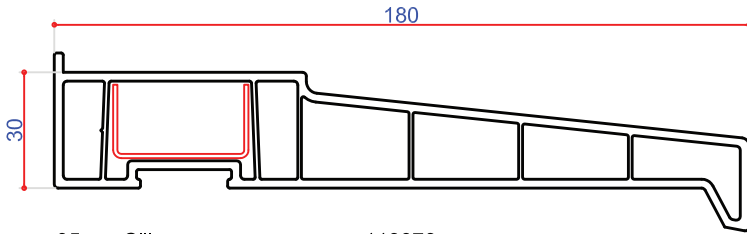

95mm Cill	110076
Steel U Channel 35 x 19mm	113377
End Cap	109090

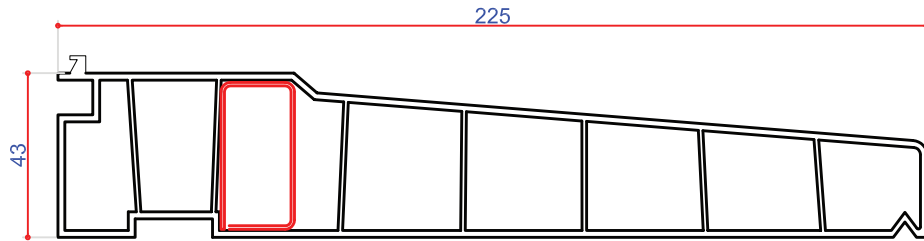

95mm Cill	110106
Steel Box 15 x 25mm	113048
Steel L Box 35 x 23mm	113345
End Cap	109647



Drip Bar	109122
End Cap	109141



Snap-on Head Drip	109230
-------------------	--------

KEY:









-  PVC Profile
-  Gasket
-  Steel
-  Aluminium

DO NOT SCALE the drawings shown are visual representations only. VEKA PLC has the right to alter the designs, specification & descriptions without prior notice as part of our policy of continuous development and improvements.

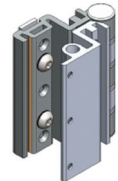
Gearing and Handle Assemblies

Images not to scale.

Picture	Assembly No.	Name	Colour	Veka Part No.
	17430	End Guide Block	Black	140001743010
	17694	Blank End Plate	Black	140001769410
	18089	Shootbolt end plate kit	Black	140001808910
	17696	Pivot end plate	Black	140001769610
	17953	Single Roller Kit	White Black	140001795301 140001795310
	18025	Lock Shoot Bolt	Black	140001802510
	18027	Espag Shoot Bolt	Black	140001802710

Picture	Assembly No.	Name	Colour	Part No.
	17655	Extended but hinge	White Black	140001765501 140001765510
	17703	'D' handle Butt Hinge	White Black	140001770301 140001770310
	17651	Std Butt Hinge	White Black	140001765101 140001765110
	17652	Espag Butt Hinge	White Black	140001765201 140001765210
	17952	Pivot Hinge Kit	White Black	140001795201 140001795210
	17547	Lock Bar Set (Size 1) Sash size 1840mm - 2100mm	Silver	140001754734
	17548	Lock Bar Set (Size 2) Sash size 2100mm - 2320mm	Silver	140001754834
	17730	Two-Two Lock	Silver	140001773034

Gearing and Handle Assemblies

Images not to scale.

Picture	Assembly No.	Name	Colour	Veka Part No.
	17693	Plastic Hinge Covers	White Black	140001769301 140001769310
	17526	3D Keep (Size 1) Sash size 1840 - 2320mm	Silver	140001752634
	17527	3D Keep (Size 2) Sash size 2100 - 2320mm	Silver	140001752734
	17542	French Lock Bar Set (Size 1) Sash size 1840 - 2100mm	Silver	140001754234
	17543	French Lock Bar Set (Size 2) Sash size 2100 - 2320mm	Silver	140001754334
	17645	Espag Bar Set (Size 1) Sash size 1840 - 2100mm	Silver	140001764534
	17739	Espag Bar Set (Size 2) Sash size 2100 - 2320mm	Silver	140001773934
	17735	3D Keep Two-Two	Silver	140001773534
	18090	3D Keep Infill Frame Side	Silver	140001809034

Picture	Assembly No.	Name	Colour	Part No.
	17998	Master/Slave Handle Set	White Black Chrome Gold	140001799801 140001799810 140001799834 140001799835
	18013	Espag Int Handle RH (viewed from outside)	White Black Chrome Gold	140001801301 140001801310 140001801334 140001801335
	18014	Espag Int Handle LH (viewed from outside)	White Black Chrome Gold	140001801401 140001801410 140001801434 140001801435
	17933	Escutcheon Set Pair	White Black Chrome Gold	140001793301 140001793310 140001793334 140001793335
	18088	Escutcheon Set INNER	White Black Chrome Gold	140001808801 140001808810 140001808834 140001808835
	18006	Auxillary Lock	N/A	140001800600
	18031	Magnet Set (Pair)	White Black Chrome Gold	140001803101 140001803110 140001803134 140001803135
	N/A	BS Kitemark 40-40 Cyl	Brass Chrome	140313503500 140313503400
	N/A	Half Cylinder	Brass Chrome	140313603500 140313603400

Product Codes & Packaging

Hardware	SAP item number	Image	Description	Finish	Packaging Qty
End Guides	140001743010		End Guide block Assy	Black	50
	140001769410		Blank end plate Assy	Black	50
	140001808910		Shootbolt end plate Kit	Black	50
	140001769610		Pivot end plate Assy	Black	50
Shoot Bolts	140001802510		Shootbolt Assy (Size 1)	Black	5
	140001802610		Shootbolt Assy (Size 2)	Black	5
	140001802710		Shootbolt Assy (Size 3)	Black	5
Hinges	140001765101		Std Butt hinge Assy	White	10
	140001765110		Std Butt hinge Assy	Black	10
Hinges	140001765201		Espag Butt hinge Assy	White	10
	140001765210		Espag Butt hinge Assy	Black	10
Hinges	140001765501		Extended Butt hinge Assy	White	10
	140001765510		Extended Butt hinge Assy	Black	10
Hinges	140001770301		'D' handle Butt hinge Assy	White	10
	140001770310		'D' handle Butt hinge Assy	Black	10
Roller Units	140001795201		Pivot hinge Kit	White	1
	140001795210		Pivot hinge Kit	Black	1
Roller Units	140001795301		Single roller Kit	White	1
	140001795310		Single roller Kit	Black	1
Handles	140001799801		Rose Handle set	White	5
	140001799810		Rose Handle set	Black	5
	140001799834		Rose Handle set	Chrome	5
	140001799835		Rose Handle set	Gold	5
Handles	140001801301		Espag Int.Handle RH Assy	White	10
	140001801310		Espag Int.Handle RH Assy	Black	10
	140001801334		Espag Int.Handle RH Assy	Chrome	10
	140001801335		Espag Int.Handle RH Assy	Gold	10
Handles	140001801401		Espag Int.Handle LH Assy	White	10
	140001801410		Espag Int.Handle LH Assy	Black	10
	140001801434		Espag Int.Handle LH Assy	Chrome	10
	140001801435		Espag Int.Handle LH Assy	Gold	10
Escutcheons	140001793301		Escutcheon set Pair	White	10
	140001793310		Escutcheon set Pair	Black	10
	140001793334		Escutcheon set Pair	Chrome	10
	140001793335		Escutcheon set Pair	Gold	10
	140001808801		Escutcheon set Inner	White	10
Ancillary items	140001808810		Escutcheon set Inner	Black	10
	140001808834		Escutcheon set Inner	Chrome	10
	140001808835		Escutcheon set Inner	Gold	10
Ancillary items	140001769301		Plastic hinge covers	White	50
	140001769310		Plastic hinge covers	Black	50
Ancillary items	140313503500		BS Kitemark 40-40 Cylinder	Brass	10
	140313503400		BS Kitemark 40-40 Cylinder	Chrome	10
Ancillary items	140313603500		Half Cylinder	Brass	10
	140313603400		Half Cylinder	Chrome	10

VEKA Product	SAP item number	Image
Outerframe	105177100101	
Channel Cover	105177180201	
	105177180701	
Track	104393900001	
Low Threshold	104392900001	
Threshold Ramp	104391900001	
Threshold	104394900001	
Blanking Piece		
Room Divider	104390900001	
Threshold		
Threshold Strip	709047100200	
Outerframe	113391100000	
Reinforcement		
Sash	713191000000	
Reinforcement		
Main Lock	113393500030	
Prepped Steel		
2-2 Lock	113393500032	
Prepped Steel		
French Door	113393500036	
Prepped Steel		
Traffic Door	112455000100	
Gasket	112455001000	
Sash Blanking	112453000000	
Gasket		
Frame & Sash	112451000000	
Seal	112451000100	
Frame & Sash	112452000000	
Flipper Seal		
Moulded Corner	112447100000	
Number 1	112447100100	
Moulded Corner	112448100000	
Number 2	112448100100	
Moulded Corner	112449100000	
Number 3	112449100100	
Moulded Corner	112454100000	
Number 4	112454100100	
Outerframe	109998100100	
Mechanical joint	109998100200	
Mouldings	109998100700	
Outerframe		
Mechanical Joint	141430000000	
Moulded Cleat		
Outerframe		
Mechanical Joint	141429000000	
Metal Cleat		
Outerframe		
Mechanical Joint	141431000000	
Metal Chevron		
Clip in	109377000100	
Glazing Packer		

Description	Finish	Length Mtr's/No Units
BIF o/f channel cover LT BW	White	6
BIF o/f channel cover LT BB	Brown	6
BIF o/f channel cover LT BC	Caramel	6
BIF folding door track LT Champagne	Champagne	6
BIF thermally broken thresh LT Champagne	Champagne	6
BIF threshold ramp LT Champagne	Champagne	6
BIF Threshold Blanking Piece	Champagne	6
BIF room divider threshold LT Champagne	Champagne	6
Threshold Strip - Brown	Brown	100
BIF o/f reinforcement LT	Galvanised Steel	6
Sash Reinforcement	Galvanised Steel	6
Prep'd Steel - Main Door Lock	Galvanised Steel	2.2
Prep'd Steel - GHS 2-2 Lock	Galvanised Steel	2.2
Prep'd Steel - GHS French Door Slave	Galvanised Steel	2.2
Folding dr sash traffic dr gasket,white	White	200
Folding dr sash traffic dr gasket,black	Black	200
BIF blanking gkt PK Black	Black	200
BIF sash & o/f seal PK Black	Black	100
BIF sash & o/f seal PK White	White	100
BIF o/frame flipper gkt PK Black	Black	75
Sash Moulded Gasket Corner - Black	Black	200
Sash Moulded Gasket Corner - White	White	200
Sash Moulded Gasket Corner - Black	Black	200
Sash Moulded Gasket Corner - White	White	200
Sash Moulded Gasket Corner - Black	Black	200
Sash Moulded Gasket Corner - White	White	200
Sash Moulded Gasket Corner - Black	Black	200
Sash Moulded Gasket Corner - White	White	200
BIF mech joint end cap PK White	White	50
BIF mech joint end cap PK Brown	Brown	50
BIF mech joint end cap PK Caramel	Caramel	50
BIF mech joint bracket	Natural	100
BIF outerframe cleat	Zinc Die Cast	20
BIF mech joint chevron	Zinc Die Cast	20
Uni 70_Clip in Glazing Packer	Black	1000

Hardware	SAP item number	Image	Description	Finish	Packaging Qty
Ancillary items	140001803101		Magnet set (Pair)	White	5
	140001803110		Magnet set (Pair)	Black	5
	140001803134		Magnet set (Pair)	Chrome	5
	140001803135		Magnet set (Pair)	Gold	5
Ancillary items	140001800600		Auxillary lock	N/A	10
Keeps	140001752634		3D keep Assy size 1	Silver	5
Keeps	140001752734		3D keep Assy size 2	Silver	5
Keeps	140001809034		3D keep infill, Frame side	Silver	5
Keeps	140001773534		3D keep Assy, Two-Two	Silver	5
Locks	140001754234		French Lock bar set (size 1)	Silver	5
Locks	140001754334		French Lock bar set (size 2)	Silver	5
Locks	140001754734		Lock bar set (size 1)	Silver	5
Locks	140001754834		Lock bar set (size 2)	Silver	5
Locks	140001764534		Espag bar set size 1	Silver	5
Locks	140001773934		Espag bar set size 2	Silver	5
Locks	140001773034		Two-Two lock Assy	Silver	5

VEKA Product	SAP item number	Image	Description	Finish	Length Mtr's/No Units
Outerframe	105174020912		BIF outerframe PK BC 2s G/oak	Golden Oak	6
	105174027012		BIF outerframe PK BB 2s R/wood	Rosewood	6
	105174030912		BIF outerframe PK BW 1s G/oak NB	Golden Oak	6
	105174037012		BIF outerframe PK BW 1s R/wood NB	Rosewood	6
	105174040912		BIF outerframe PK BW 1s G/oak BF	Golden Oak	6
	105174047012		BIF outerframe PK BW 1s R/wood BF	Rosewood	6
	105174100114		BIF outerframe LT BW	White	6
Sculptured Sash	105175020912		BIF 80mm sclp sash PK BC 2s G/oak	Golden Oak	6
	105175027012		BIF 80mm sclp sash PK BB 2s R/wood	Rosewood	6
	105175030912		BIF 80mm sclp sash PK BW 1s G/oak NB	Golden Oak	6
	105175037012		BIF 80mm sclp sash PK BW 1s R/wood NB	Rosewood	6
	105175100114		BIF 80mm sclp sash LT BW	White	6
Chamfered Sash	105176020912		BIF 80mm cham sash PK BC 2s G/oak	Golden Oak	6
	105176027012		BIF 80mm cham sash PK BB 2s R/wood	Rosewood	6
	105176030912		BIF 80mm cham sash PK BW 1s G/oak NB	Golden Oak	6
	105176037012		BIF 80mm cham sash PK BW 1s R/wood NB	Rosewood	6
	105176100114		BIF 80mm cham sash LT BW	White	6
Sculptured Bead	107153020940		BIF 28mm sclp bead PK BB 2s G/oak	Golden Oak	6
	107153027040		BIF 28mm sclp bead PK BB 2s R/wood	Rosewood	6
	107153100140		BIF 28mm sclp bead PK BW	White	6
Chamfered Bead	107154020940		BIF 28mm cham bead PK BB 2s G/oak	Golden Oak	6
	107154027040		BIF 28mm cham bead PK BB 2s R/wood	Rosewood	6
	107154100140		BIF 28mm cham bead PK BW	White	6



Hardware Diagram



Bi-Fold Door Hardware Layout



Door shown looking from inside
4-3-1 Configuration (viewed from the outside)



1



2



3



4



5



6



7



8



9



10
End Guide Block used on every corner



11



12



13



14



15



16



17



18



19



20

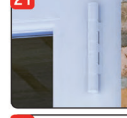

21



22



23

ERA

imagine
BI-FOLD DOORS



Bi-Fold Door Hardware Layout

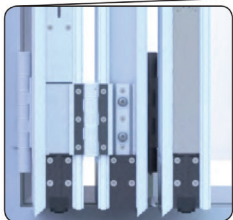
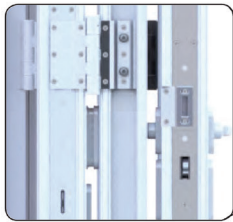

- | | | | | |
|---------------------------|---|------------------------------|-------------------------------|--------------------------|
| 1 Extended Hinge | 6 Handle | 11 Top Pivot Hinge | 16 Espag Hinge | 21 Extended Hinge |
| 2 Standard Hinge | 7 Security Escutcheon | 12 Bottom Pivot Hinge | 17 Espag Handle | 22 Standard Hinge |
| 3 Extended Hinge | 8 Shootbolts | 13 Standard Hinge | 18 Security Escutcheon | 23 Extended Hinge |
| 4 Shootbolts | 9 French door Lock | 14 Shootbolts | 19 Standard Hinge | |
| 5 Master Door Lock | 10 End Guide Block (All Corners) | 15 Espag Lock | 20 Shootbolts | |



The VEKA UK Group

Colour Options

SIDES ① ②

BASE MATERIAL

White Caramel Brown

X STOCK

Colour	Reference	Ral	Base
Golden Oak	9.2178 001-116700	8001	① ②
Rosewood	9.3202 002-116700	8015	① ②

4 WEEKS

Colour	Reference	Ral	Base
Irish Oak	9.3211 005-114800	1011	① ② ③
Anthracite Grey	9.3202 002-116700	7016	① ②
Cream	46835-101100	9001	① ②
Beck Brown	49116-101100	8022	① ②
Dark Green	6125 05-116700	6009	① ②
White	02.20.91.000001-116801	9010	① ②
Chartwell Green	49246-101100	-	① ②
Dark Red	3081 05-116700	3011	① ②
Wine Red	3005 05-116700	3005	① ②
Steel Blue	5150 05-116700	5011	① ②
Moss Green	6005 05-116700	6005	① ②
Slate Grey	49229-101100	7015	① ②
Basalt Grey	7012 05-116700	7012	① ②
Silver Grey	49124-101100	7001	① ②
Agate Grey	7038 05-116700	-	① ②
Siena PN	9.0049 237-114800	-	① ②

In line with the standard VEKA Variations colour options launched last year, the new Imagine Bi-Fold Door is available in an array of foiled woodgrains and colours.

Halo customers please note – Golden Oak and Rosewood are equivalent to Halo Cherry and Rosewood foils. The difference in the Rosewood is pretty imperceptible, but there is a very slight variation from the Cherry to the Golden Oak which you should be aware off. This change is specific to Imagine Bi-Fold Doors, and does not change the Halo foils offer on other products.

Physical samples of the Golden Oak and Rosewood foils are included in the launch pack folders. They are also viewable in the Variations swatches – if you have any questions please contact your Account Manager.



Discontinuations

The launch of the Imagine Bi-Fold Door entails all new profile and components and as such it will replace the previous Bi-Fold door offer from both VEKA and Halo. Whilst many of the profiles previously used to fabricate the VEKA or Halo Bi-Folds will still be available as they are used in other current products, the Fabrication manuals and technical support for the previous Bi-Folds will be withdrawn, making fabrication of the new Imagine Bi-Fold the only route forward supported by the VEKA UK Group



The VEKA UK Group

Sales Literature

To support the Imagine Bi-Fold Door launch, high quality literature will be available tailored for both installers/fabricators and also for the homeowner.

Consumer Brochure



Trade Brochure



Technical Manual

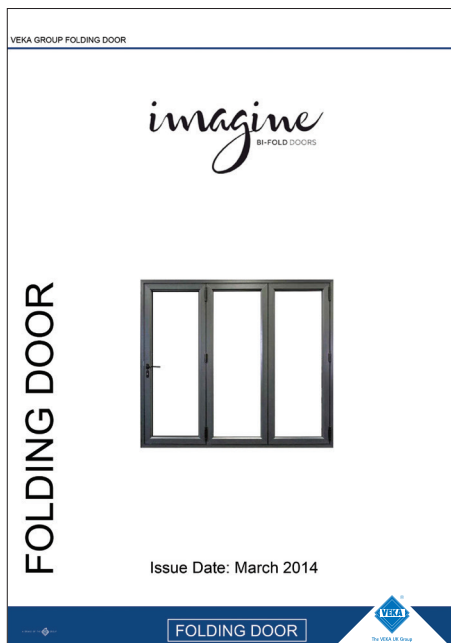

Photography

The images shown are just a selection of installations available for customers to use in their own marketing materials, showing the Imagine Bi-Fold Door range as they would appear in-home. If customers wish to access these images they should contact the VEKA Brand Manager on 01282 716611 or email rlegg@veka.com.

An installation video and short video clips demonstrating technical and hardware features are also being produced.

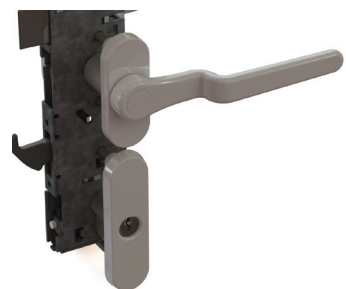
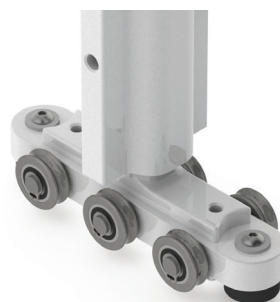
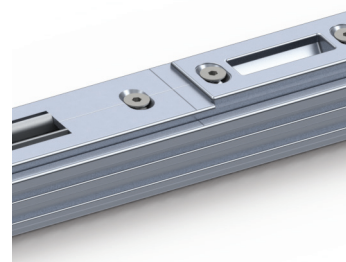
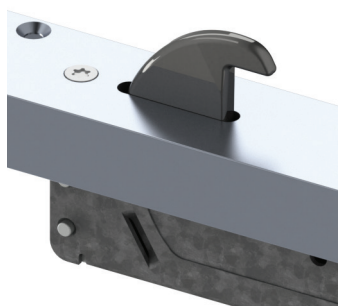

Marketing Communications



The Imagine Bi-Fold Door received fantastic feedback when it was first previewed at Fensterbau Frontale this year. It will next appear on the VEKA UK Group Stand (150) at the FIT Show, which will effectively be its wider Trade launch. Running up to the FIT Show, a teaser campaign is running through the trade press and via e-shots, with an invitation to see the Imagine Bi-Fold Door on the stand.

As you would expect for such an important launch, the VEKA UK Group will be running a sustained communications campaign to the Trade and beyond.

- Full Trade advertising schedule
- Extensive PR program – see press release in this document
- Repeated E-shot campaigns
- Promotion via the VEKA UK website and other third party sites
- Direct Mail
- Promotion via Twitter

We are confident that the marketing campaign, which is currently being put in place, will ensure that there is a huge amount of interest and enquiries about the Imagine Bi-Fold Door. In this growing market, we aim to create the level of demand this class leading product deserves.

If you have any specific requests with regards to marketing support please contact the marketing department on: 01282 716 611, or email rlegg@veka.com.



The VEKA UK Group

imagine
BI-FOLD DOORS the perfect Bi-Fold Door System

VEKA has further demonstrated its position as the industry leader in PVC-U systems with the unveiling of the innovative 'Imagine' Bi-Fold Door.

The technical experts at The VEKA UK Group chose to go back to the drawing board with this product and 're-imagine' what we have come to think of as a standard Bi-Fold Door.

The official launch follows successful appearances at both Fensterbau Frontale and the FIT Show.

Sales and Marketing Director Colin Torley explains: "The new Imagine Bi-Fold Door was on display at Fensterbau Frontale and visitors to the event were very impressed; we received some extremely positive feedback.

"The Imagine Bi-Fold Door has been designed in the UK, for the UK market and our Technical Team are extremely proud of it. The system has been designed 'from the ground up' so there are no compromises. When it comes to components, everything has been newly designed to avoid having to 'make do' with existing parts.

"The result is a technically-advanced bespoke product - available in numerous different configurations - with custom-designed hardware from ERA housed neatly within the profile.

"VEKA will be carrying the hardware as well as manufacturing the profile, so the Burnley HQ will act as a 'one-stop-shop' and customers can expect excellent lead times.

"The system has been designed with security in mind. It features ERA locks and can achieve the PAS24 and Secured by Design accreditations as standard, with no need for additional modification.

"Extremely energy-efficient, the Imagine Bi-Fold Door is being launched with the potential to achieve the highest DSER available. It has been designed to be 'future proof' thanks to the fact that it is triple glazing ready. With triple glazing fitted, the door is capable of achieving a U-value of below 1.0.

"VEKA is offering a choice of sculptured or bevelled sashes and glazing beads on this type of system. As you would expect from an industry-leading supplier, VEKA also offers a choice of three threshold options on its new Bi-Fold. Customers can choose a standard outerframe, a Part M low threshold option or an ultra-low internal room divider.

"The sashes for these doors will be wider and taller than most on the market, and will have slim sightlines on the profile.

"VEKA has always demonstrated an impressive level of attention to detail. This door illustrates our commitment to quality with details such as the premium quality magnets that keep the doors in place and prevent them creeping back when opened. Handles are low profile so sashes collect virtually flush against each other, meaning minimal loss of space.

"This system is so unique, there are virtually too many benefits to mention! Every aspect has been analysed and redesigned, where necessary, to create a Bi-Fold Door that could previously only be imagined! We're looking forward to sharing our innovations with customers old and new who will surely appreciate every little detail: from the fully adjustable hinges that can be altered in situ - to the reversible guide wheels and much, much more."

Price List

A printed Price list for all Imagine Bi-Fold profile, ancillaries and hardware is available



