

PURGE MONITORS



Pipe Beveling Machines
Pipe Cutting Machines
Grinding Machines
Pipe Stands and Clamps
Pipe Purging
Plate Bevelers
Heat Exchanger, Boiler & Bundle

 **GBC UK** 
THE CUTTING & BEVELLING EXPERTS



GBC INDUSTRIAL TOOLS LTD ARE THE 'PIPE EQUIPMENT SPECIALISTS' FOR THE SUPPLY OF PIPEWORK EQUIPMENT AND TOOLS.

Over the past 30 years our parent company GBC Industrial Tools Spa, has established itself as one of the world's leading manufacturers of portable pipework machinery, due to its consistent high level of quality, both in product and service. We are pleased to be part of that team.

GBC has established an extensive distribution network to industries across the world. These industries include:



- Petrochemical
- Offshore
- Power Generation
- Heat Exchange Manufacture/ Repair
- Boiler Industry
- Ship Building and Repair
- Nuclear
- General Fabrication
- Site Services

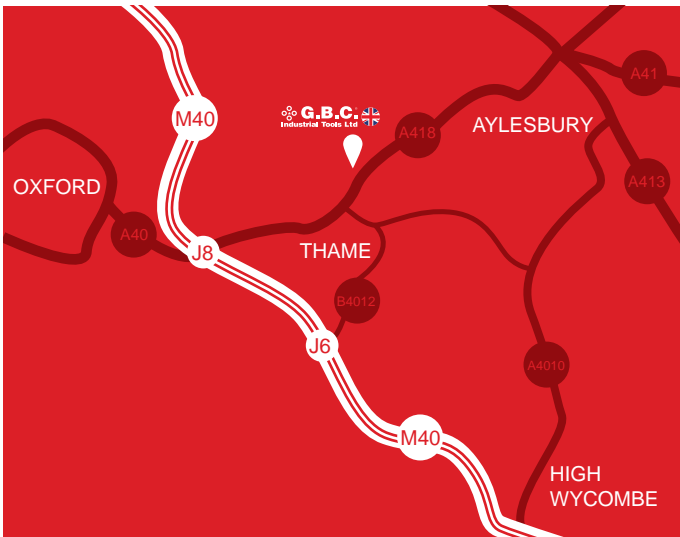

Registered address: 7 Drakes Drive, Crendon Business Park
Long Crendon, HP18 9FE

Registered in England & Wales. Registration no. 08966210
VAT no. 190019919

MasterPurge 100



**SELF
CALIBRATING**

Manufactured in the UK.



Digital display

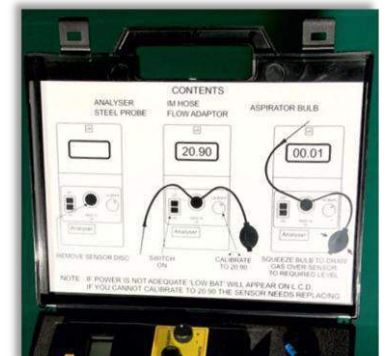

Step by step instructions inside the carrycase lid.

The MasterPurge 100 is our entry level weld purge monitor. It comes complete and ready to use straight from the carrycase. It is suitable for general stainless steel pipework applications. For more critical applications such as Titanium, Nuclear, food and chemical, please choose a higher spec model from the MasterPurge range.

Package includes: Oxygen Monitor
Hose
Flow adaptor
Stainless steel probe
Aspirator bulb
Carrycase
Operating instructions



Hand held. Portable

Measuring range: 20.9% to 0.01%
Sensor response: T90 < 15 secs
Operating Temp: -10 to 40 degrees C
Power source: P3 9 volt battery
Warranty: Sensor 12 months
Dims: Monitor: 150mm x 80mm x 55mm
Case: 270mm x 230mm x 55mm



Replacement Sensors and full range of spares available from stock.

MasterPurge 1000P



Solid aluminium case

Fully RFI & EMI shielded

- * **Push Button re-calibration for oxygen cell drift**
- * **Built in audible alarm to warn of purge loss - variable alarm level**
- * **Milled from solid aluminium case - fully RFI & EMI shielded**
- * **Resolution - 0.1 %**
- * **Accuracy - $\pm 1\%$ F.S.**
- * **Hand bulb pump with sampling tubes and stainless steel capillary**
- * **Re-chargeable batteries (charger included)**
- * **No zero calibration required**
- * **Two year oxygen cell life**
- * **Simple and economical oxygen cell replacement**
- * **Manufactured in UK**

Sensor - Electrolytic, partial pressure type
- Working life - 2 years

Alarm - Piezo buzzer - 80dba @ 30 cms.

Batteries - 900mAh 6v NiCad pack
- Time between charges - approx. 3 weeks
- Charge time - 14 hours

Measuring range - 0-25% oxygen in Argon, Helium, Argon/Hydrogen mixes, etc

Response time - Less than 20 seconds to 0.1%

Dimensions - 148mm x 80mm x 45mm

Weight - 600 gms

PRO OX-100 Kit



KIT CONTENTS

- PRO OX®-100 Monitor and Sensor
- Polycarbonate Carrying Case
- Neoprene Extension Tubing (5 ft. or 1.5 m) with Quick Connect Fittings
- Stainless Steel Probe
 - » Slender 0.08" (2 mm) Diameter
- Rechargeable Battery & Charger
- USB Cable
- Support Stand
- Phillips Head Screwdriver
- Quick Instruction Card

HANDHELD OXYGEN MONITOR PRO OX®-100 SPECIFICATIONS

Measurement Range:	0.00-21.0% Oxygen concentration by volume	Storage Temperature:	37.4°-68°F (3°-20°C)
Calibration:	20.9% (Oxygen concentration in air)	Sample Flow:	1.0 LPM maximum
Calibration Gas:	Ambient Air	Sample Pressure:	10.0 PSI (pounds-force per square inch) maximum
Display Resolution:	0.00-24.99% (2 decimal places LCD)	Power:	One 9V NiMH Cell Battery
Accuracy:	@ 99.995% Ar +/- 0.01%	Battery Life:	Up to 2 hours when operating in continuous sampling mode.
Response Time:	T ₉₀ < 15 seconds	Sensor Type:	Electrochemical Oxygen Sensor
Warm Up Time:	Negligible	Sensor Life:	12 months
Humidity:	0-95% non-condensing	Recommended Calibration Period:	Weekly, dependent upon use
Operating Temperature:	32°-122°F (0°-50°C)	PC Connection:	USB Type B

MasterPurge 5

This new oxygen analyzer is an innovative, handy and reasonably priced measurement device, with a durable, wear-proof zirconium sensor. Elaborate charging management and high-quality built-in components make this device the market leader in its sector. It has an internal position-sensor, which allows the digital display screen to rotate by 180°. The pump and the heating of the sensor are activated by strong lateral shaking. If the device doesn't get a measurement value after 10 minutes it automatically shuts down, therefore preserving battery and sensor capacity. It is coated by a shockproof silicone holster. A key ring is fixed on the bottom side to hang up the device on a pipeline or another item.



FEATURES

- Temperature-controlled zirconium sensor (1000 ppm - 5 ppm)
- Graphic-competent, coloured 1" OLED-display
- Power supply 110 VAC-240 VAC
- Internal Lithium Ion battery with 3,7 VDC, 4.300 mAh
- Integrated, free programmable signal-horn. The analyzer can be programmed on the PC or Android mobile-phone with the optional Bluetooth adapter.
- A green measurement value on the OLED display means "approved".
- Diffusion resistant FPM measurement hose
- Charging cable for car cigarette lighter available
- Display screen rotates when you turn the device due to position sensor
- Measuring up to 4 hours
- Ready to work in ca. 10 seconds

DATA

Electrical voltage supply:	Input: 100 – 240 VAC (50/60 Hz) Output: 12 VDC, 1000 mA
Weight:	447 g (without suitcase)
Dimensions (l x w x h):	145 mm x 85 mm x 48 mm
Range:	1000 - 5 ppm



MasterPurge Pro2 mobile

Oxygen Analyzer

- Temperature regulated zirconium sensor
- Graphicscompatible display (4 background colours)
- Plug-in power supply 110 VAC-240 VAC
- Internal akku with 7 VDC, 2750 mAh
- Integrated, free programmable horn
- Easy operated software
- Operator guidance in several languages
- Diffusion-proof special- FPM- measuring hose
- Charging cable for car-cigarette lighter available
- Measuring-data storable (Premium version)
- PC software for documentation
- Various surfaces for documentation or connection of external orbital welding equipment (Orbitec, AMI, ...)



The keypad is a very robust snap dome film. Stabile plastic plates are installed between the polycarbonate- and the conductor-film. This allows the operator a save pressure, also with heavy welders- or working-gloves. By pressing the keys, he gets a not overhearing confirmation signal. Furthermore a practicable software supports the operator with several information (5-fold signal tone before readiness to measure, signal tones as alert – no welding readiness).



DATA

Electrical voltage supply

Weight (kg)

Dimensions (L x W x H)

Range

Input: 100-240 VAC (50/60Hz)

Output: 12 VDC, 1000 mA

0,570

225 mm x 105 mm x 45 mm

1000 - 5 ppm

MasterPurge 1

The MasterPurge 1 Oxygen Monitor incorporates a maintenance-free ceramic sensor, which can accurately display oxygen levels as small as 1 ppm (part per million).

High specification welds are now commonplace in the pharmaceutical, dairy, aerospace, petrochemical and many other industries. This oxygen monitor enables welders to more accurately recognise when extremely low rest oxygen atmospheres in the weld environment are reached.

Features

- Robust zirconium cell
- 0 – 999 ppm measurement range
- Low maintenance
- Complete with carrycase



Technical Data

Measuring range	0 - 999 ppm O ₂
Temperature operating range	0 ⁰ C - 45 ⁰ C
Accuracy	+/- 0.3 mV Sensor EMF
Sensor warm-up time	Approx. 90 Seconds
Stabilisation time	15-20 Minutes
Response time	Approx. 2 Seconds for variations
Dimensions	140mm x 210mm x 225mm (H x W x L)
Required voltage	Multi Range 100 - 240 Volt AC
Warm-up load	Approx. 200 VA
Normal load	Approx. 40 VA
Measuring chamber Temp.	Approx. 700 ⁰ C
Gas temperature	Max. 50 ⁰ C
Gas flow	Approx. 50 l/h (1.8 ft ³ /h)
Moisture content	Zero. Moisture must be separated out.

N.B. NOT SUITABLE FOR USE WITH FORMING GASES

MasterPurge Pro2 plus

Oxygen Analyzer

- Temperature regulated, low-maintenance zirconium sensor
- Accuracy of measurement up to 0,5 ppm
- Graphics compatible display
- Internal akku for wireless measurements up to 90 min.
- Integrated, free programmable horn
- Date and time for documentation
- Easy operated software
- Diffusion proof special FPM measuring hose
- Digital flow sensor
- Several surfaces: RS 232, 0-5 VDC (Orbitec) , CAN-Bus, AUX (AMI)
- Calibration on the aerial oxygen for authorised personnel
- Internal memory up to 250 sets of parameters or external memory (PC-documentation)



Made in Germany

DATA

Electrical voltage supply
Weight (kg)
Dimensions (L x W x H)
Range

100-240 VAC (50 / 60 Hz) | Internal Akku: 12 VDC
3,2
240 mm x 215 mm x 85 mm (325mm with handle)
1000 - 1 ppm



GBC Rental

We are the leading supplier of rental pipework fabrication equipment and we have an unrivalled range and quantity of equipment available off the shelf; from pipe bevelling and cutting to tube pulling and expanding, including:

- Pipe and Plate Bevelling Machines
- Pipe Cutting Machines
- Pipe Clamps and Stands
- Bundle Pullers
- Tube Expanding Machines
- Rolling Motors for Tube Expanders
- Tube Pulling Machines
- Reciprocating Saws
- Orbital Pipe Saws
- Flange Facing Machines

Our hire fleet is constantly expanding and improving and is offered not only in the UK, but anywhere in the world.

CALL +44 (0) 1844 201 555 OR EMAIL HIRE@GBC-UK.COM



GBC Industrial Tools Ltd
7 Drakes Drive
Crendon Business Park
Long Crendon
HP18 9FE

T: 01844 201 555
F: 01844 201 454

sales@gbc-uk.com
www.gbc-uk.com