

View in your browser



**October 2017**  
Lathe Safety

### **The Spider - an innovative new tool for sanding and finishing parts quickly, easily and safely on conventional manual lathes**

There is no longer any need to undertake dangerous sanding operations by hand with risk of serious accidents caused by holding emery cloth or sanding pads. The Spider 50 and Spider 75 have been conceived in accordance with ISO 23125 Standards 6.2.1 (no use of hands during working operations) to ensure compliance.



#### **Why do you need the Spider?**

The Spider provides safe, controlled, accurate deburring, polishing, sanding or sizing of a wide range of cylindrical, tapered and threaded metal, alloy or wooden components without the use of hands, as instructed in the Standards.

---

**EXCERPTS FROM HSE L102 (REV1)**

“Manual lathes: Emery cloth should **NEVER** be applied directly by hand on manual metalworking lathes.”

“Every year there are serious accidents involving the use of emery cloth on metalworking lathes, resulting in injuries such as broken bones, dislocations, lacerations, amputations and occasionally death.”

“Emery cloth is often used to deburr, polish or size a wide range of cylindrical, tapered and threaded metal components while they are held in the rotating chuck jaws of a lathe. Accidents occur when hand-held emery cloth is entangled in the rotating parts of the machine or where the emery cloth is snagged on the rotating component dragging the operator into the danger zone.”

The full leaflet is available at: [www.hse.gov.uk/pubns/eis2.pdf](http://www.hse.gov.uk/pubns/eis2.pdf).

**WATCH OUR VIDEO:  
"Polishing using a Colchester Triumph 2000 Lathe"**







### How the Spider works

The Spider is simple to fit and provides easy sanding or polishing of turned components of different shapes and diameters owing to the tool design, with tension springs ensuring positive control. The sanding belt is easily rotated by means of a rotary crank wheel with a

The Spider is clamped into the lathe tool post in the same way as any cutting or parting tool. Turn the tool post backwards or forward to the required tension and left or right to sand or polish along your workpiece.

Turning the rotary crank handle on the Spider ensures your chosen abrasive is new or clean against the workpiece. The engineered profile of the belt sander's adjustable arms along with the tension spring allow for quick set-up to sand or polish bars of different diameters.





Both the Spider 50 and Spider 75 will work in conjunction with any of our interlocked chuck guards, however for the maximum possible sanding/polishing area we recommend the new TW guard and the Minor chuck guard. Both options will enable the sanding belt to be used right up against the chuck face and are available with built-in LED lighting.

*Spider 50 and Minor chuck guard*



*TW linear rail-mounted slide-and-lift chuck guard*



### **Specifications**

The Spider lathe sanding tool is available in two sizes and is supplied with three standard sand belts: (80 – 120 – 220-grade grit).

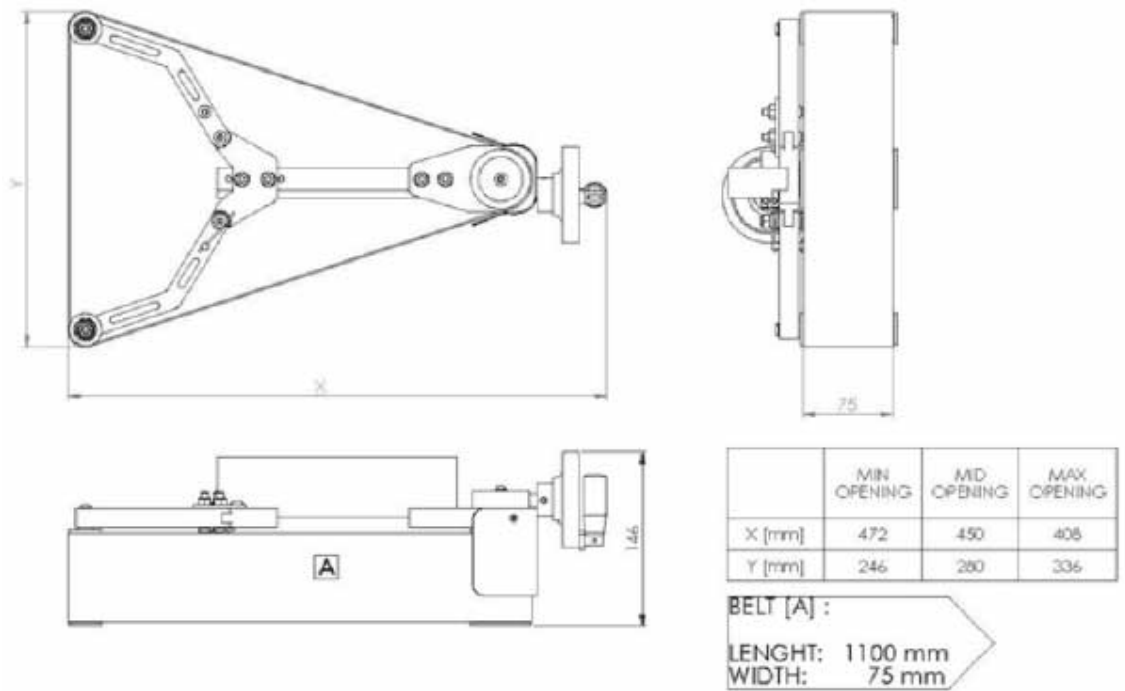
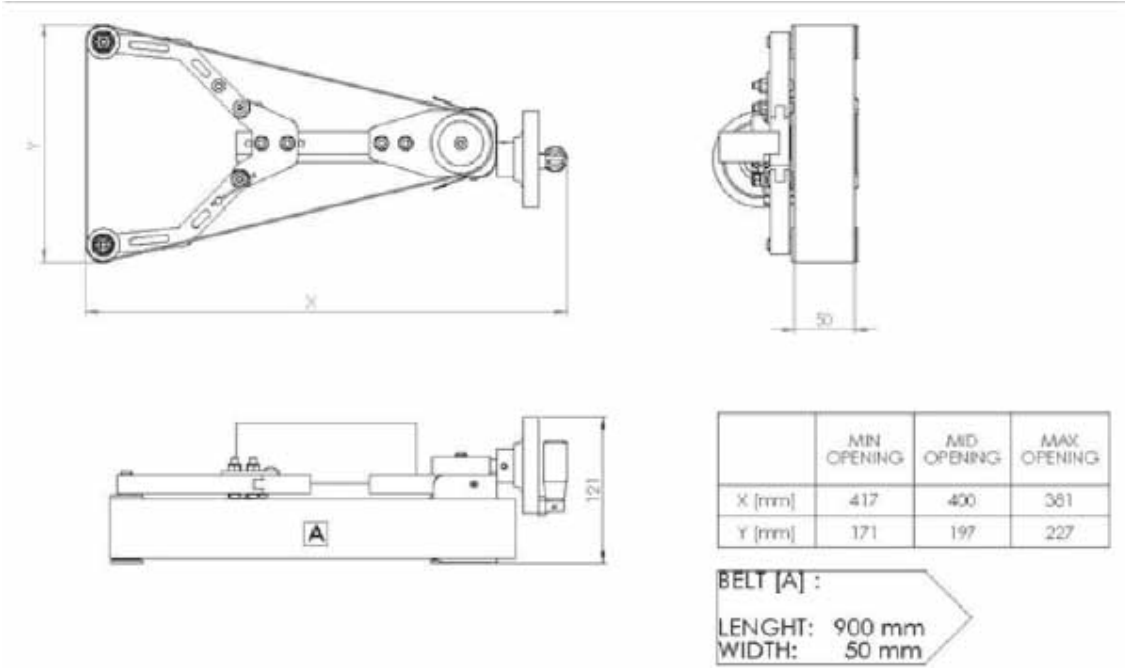

**WATCH OUR VIDEO:  
 "Sanding using a Harrison 1" Swing Lathe"**





**WATCH OUR VIDEO:  
"ISO 23125 6.2.1 Spider 50 from Machine Covers Ltd"**



For more information about the Spider please **email us**



This email was sent to you by Machine Covers Limited.  
Contact [info@machinecovers.co.uk](mailto:info@machinecovers.co.uk) or +44 (0)1452 770166 for more information

---

This email was sent to [natalie@twicecreative.com](mailto:natalie@twicecreative.com)  
[why did I get this?](#) [unsubscribe from this list](#) [update subscription preferences](#)  
Machine Covers · Stancombe Works · Stroud Road · Bisley, Gloucestershire GL6 7NQ · United Kingdom