



**SHORT MANUAL**  
[www.beka-max.co.uk](http://www.beka-max.co.uk)  
 0151 430 7158

**STEP 4**  
 Start up



The magnet cap is the key to make settings of BEKAONE.

**STEP 5**

**Additional lubrication**

An additional lubrication is necessary:  
 - for filling an empty BEKAONE  
 - for an intermediate lubrication

**STEP 1**

Preparing the lubricating point

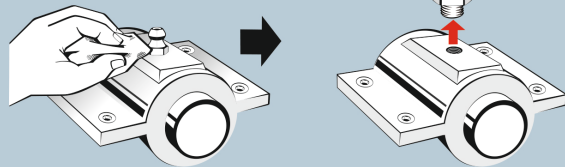

Clean components thoroughly!

**STEP 2**

Connecting elements

Connecting elements like hoses or fittings have to be prefilled.

Use the same lubricant as in the lubricator!

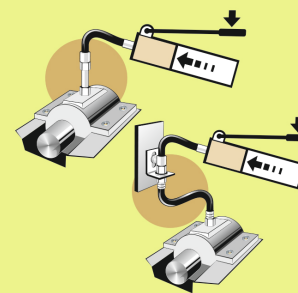

**STEP 3**

Filling



Fill up to "MAX" with lubricant

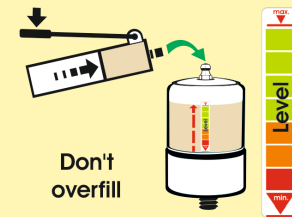

Don't overfill

**1.** Remove magnet cap



**2.** go to Activate Zone

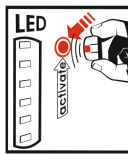

**3.** and place it on Activate Zone  
 Red LED flashes 5x

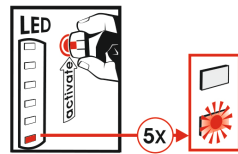

**4.** Remove magnet cap and wait approx. 1 - 2 sec

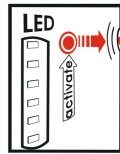

**5.** Go back to Activate Zone

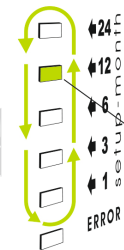

**6.** Green LED runs through LED strip

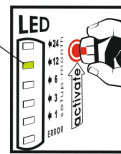

**7.** Remove magnet cap as soon as requested setting is reached

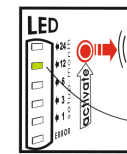

Example: 12 months

**8.** In case of error or if the settings should be changed:

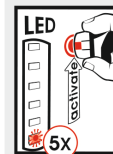

- Place magnet cap on Activate Zone
- Red LED flashes 5 times. Pump is switched off. Red LED confirms
- Switch on pump.

Activate Additional lubrication

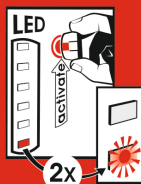

Red LED flashes 2 times  
 Pump starts delivering

As shown in picture

- Place magnet cap on Activate Zone
- LED flashes 2x
- Remove magnet cap
- Pump starts running (approx. 7sec)
- Approx. 4sec. break
- Pump starts running (approx. 7sec)

This procedure should be carried out 5 times until lubricant comes out without air bubbles.



Pump works approx. 7 sec  
 Pump works approx. 7 sec

Green LED lights corresponding to month setting



Lubricant has to come out without air bubbles



not OK



OK

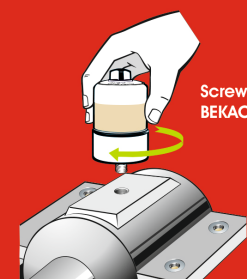

Screw in BEKAONE