

+44 (0)1706 758811

Beryllium Copper (BeCu) Fingerstrip Gaskets

EMC and Thermal Management
Solutions

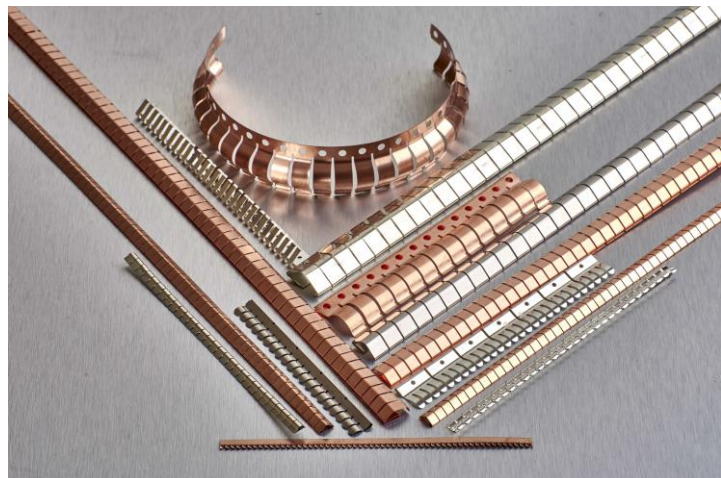

Fothershield

UNIT 3 GORRELLS WAY, TRANSPENNINE TRADING ESTATE,
ROCHDALE, LANCS, UK. OL11 2PX

E info@fothershield.co.uk

T +44 (0)1706 758811

W www.fothershield.co.uk

BERYLLIUM COPPER (BECU) FINGERSTRIP GASKETS

	Page
• Slot Mounted	5-10
• Track Mount	11-12
• Adhesive Mount	13-17
• Low Profile	18
• Twisted Series	19-21
• Enclosure Series	22-25
• Clip On Series	26-31
• Contact Series	32-35

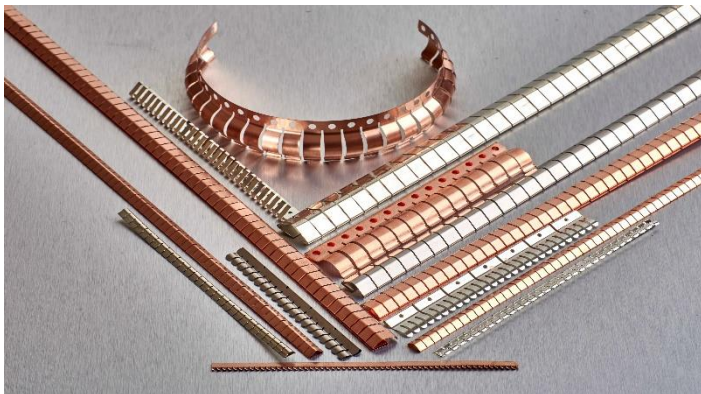

Fothershield's wide range of Beryllium Copper (BeCu) fingerstrip gaskets allows the customer to choose the right product for his application. You can be guaranteed the excellent service you deserve, so give us a call today and we'll find the perfect way to solve your problem.

Beryllium copper (BeCu) fingerstrip gaskets give extremely high electromagnetic and radio frequency (EMI/RFI) shielding effectiveness and are ideal for repeated opening and closing application and where high attenuation, together with mechanical strength and fatigue resistance is required.

Beryllium Copper has a high cycle time and conforms to large gap variations. It is a high performance metal which can easily be fabricated making it the perfect material for EMI shielding purposes.

The spring quality of beryllium copper fingerstrip is far superior to any other EMI shielding gasket and offers the highest EMI shielding effectiveness together with consistent performance due to the hard wearing nature of the beryllium copper alloy.

Advantages of Beryllium Copper (BeCu)

- Low compression force
- Highest strength copper alloy with high cycle life
- Maximum spring properties
- Excellent conductivity
- Conforms to large gap variations
- Dimensional stability
- Excellent for bi-directional applications
- Wide temperature variation and non-magnetic
- Resistance to stress relaxation
- Easy installation
- Non flammable
- Easy to plate
- Variety of mounting options, sizes and configurations
- RoHS compliant

Electrochemical Compatibility

To avoid galvanic action between contacting metals choosing materials within a single group in the table will provide the least corrosion due to galvanic action. Materials within adjacent groups may also be safely used together.

Group 1	Group 2	Group 3	Group 4
Magnesium	Aluminium	Cadmium Plating	Brass
Magnesium Alloys	Aluminium Alloys	Carbon Steel	Stainless Steel
Aluminium	Beryllium	Iron	Copper & Copper Alloys
Aluminium Alloys	Zinc & Zinc Plating	Nickel & Nickel Plating	Nickel/Copper Alloys
Beryllium	Chromium Plating	Tin & Tin Plating	Monel
Zinc & Zinc Plating	Cadmium Plating	Tin/Lead Solder	Silver
Chromium Plating	Carbon Steel	Brass	
	Iron	Stainless Steel	
	Nickel & Nickel Plating	Copper & Copper Alloys	
	Tin & Tin Plating	Monel	
	Tin/Lead Solder		

ANODIC
▶
 CATHODIC

Material Specifications

We use Alloy 25 (C17200) strip material to provide the highest strength copper alloy for use in our fingerstrip gaskets. Alloy 25 gives greater electrical conductivity than other high strength copper alloys. The material is most commonly used for EMI shielding gaskets, springs, grounding strips, connector parts, aerospace and military, battery contacts and coil springs.

Chemical Composition (Weight Percent)

Alloy	Beryllium	Nickel + Cobalt	Nickel + Cobalt + Iron	Copper
C17200	1.8-2.0	0.2% minimum	0.6% maximum	Balance

Physical Properties (Heat Treated)

Elastic Modulus	Melting Point (Solidus)	Electrical Conductivity/ Resistivity	Density	Thermal Expansion Coefficient	Thermal Conductivity (25°C)
19,000ksi	1600°F	22-25% IACS	0.302 lb/in. ³	9.7 x 10 ⁻⁶ in./in. °F	0.60 BTU/ft.hr°F
131Gpa	870°C	6.2 -7.8 μΩ – cm	8.36g/cm ³	17.0 x 10 ⁻⁶ °C	105W/mK

Mechanical Properties (Heat Treated)

Temper	Tensile Strength (MPa)	Yield Strength .2% offset (MPa)
¼HT	175 Min.	150 Min.

Manufacturing Tolerances (mm)

Pitch	±0.127
Length	±1.52
Spring Height	±0.51
Cut Length	±0.61

Plating Finish

Standard finish is 01, clean and bright finish. Standard plating thickness is 0.0025mm minimum. Gold plating standard thickness is 0.00127mm. The plating thickness may be varied to suit customers' need. Common finishes are tin, nickel and zinc. Other finishes available on request.

Shielding Performance

Shielding effectiveness is based on the recommended 25% gasket deflection and tested in accordance with MIL-STD-285 test procedure. Low compression fingerstrip offer comparable shielding effectiveness to standard product.

Gasket Material	H-Field (100 kHz)	E-Field (10 MHz)	Plane Wave (1 GHz)
Standard Fingerstrip	110 dB	100 dB	95 dB
Low Compression Fingerstrip	105 dB	95 dB	90 dB

Tape Specification

Non-conductive, double sided, acrylic pressure sensitive adhesive type 3M 9469PC or equivalent, 0.13mm thick, clear colour. Temperature range -40°C to 121°C. Shelf life 12 months.

Apply at room temperature to a clean, dry surface. Remove any oily residues with rubbing alcohol. Once the gasket is in position, press firmly to achieve a good bond. Repositioning the gasket may impair the effectiveness of the adhesive or damage the strip. 50% of ultimate strength will be achieved after 20 minutes, 90% after 24 hours and 100% after 72 hours. Elevated temperatures may increase ultimate bond strength more quickly.

The 3M tape is moisture, solvent and temperature tolerant and meets MIL standard specifications.



The beryllium copper sheet material is stamped out to produce BeCu fingerstrip gaskets from our wide range of gasket tools.

After removing any oils or greases the gaskets are heat treated, giving the gaskets their unique spring qualities.

Optional plating and self-adhesive backing is applied before cutting to size.

SLOT MOUNT SERIES GASKETS

SINGLE SLOT MOUNTED SERIES

The slot mounted series gaskets can be used in full lengths as EMI shielding gaskets, or cut to length to be used as ESD contacts. The gaskets can clip in to slots or can be mounted on tracks.

FS-MB1216

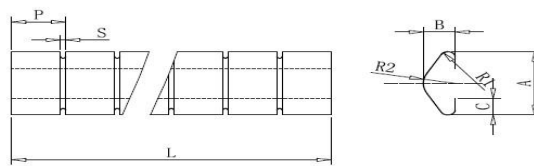

Part No.	A (mm)	B (mm)	C (mm)	R1 (mm)	R2 (mm)	Thick. (mm)	P (mm)	S (mm)	Length (mm)	Fingers	Finish
FS-MB1216-01	8.13	2.79	2.16	0.51	2.79	0.05	4.75	0.45	408	86	Bright
FS-MB1216-02	8.13	2.79	2.16	0.51	2.79	0.05	4.75	0.45	408	86	Tin
FS-MB1216-03	8.13	2.79	2.16	0.51	2.79	0.05	4.75	0.45	408	86	Nickel
FS-MB1216-04	8.13	2.79	2.16	0.51	2.79	0.05	4.75	0.45	408	86	Zinc

FS-MB1116

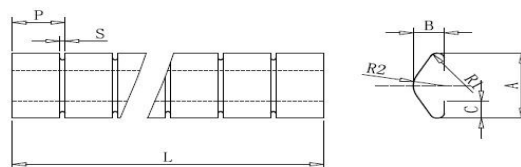
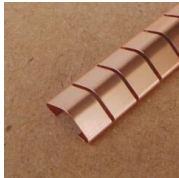

Part No.	A (mm)	B (mm)	C (mm)	R1 (mm)	R2 (mm)	Thick. (mm)	P (mm)	S (mm)	Length (mm)	Fingers	Finish
FS-MB1116-01	8.13	2.79	2.16	0.51	2.79	0.09	4.75	0.45	408	86	Bright
FS-MB1116-02	8.13	2.79	2.16	0.51	2.79	0.09	4.75	0.45	408	86	Tin
FS-MB1116-03	8.13	2.79	2.16	0.51	2.79	0.09	4.75	0.45	408	86	Nickel
FS-MB1116-04	8.13	2.79	2.16	0.51	2.79	0.09	4.75	0.45	408	86	Zinc

FS-MB1077

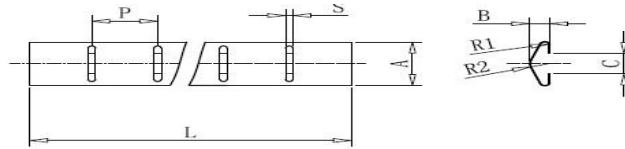

Part No.	A (mm)	B (mm)	C (mm)	R1 (mm)	R2 (mm)	Thick (mm)	P (mm)	S (mm)	Length (mm)	Fingers	Finish
FS-MB1077S-01	4.80	1.70	2.00	0.32	2.15	0.05	4.61	0.51	230	50	Bright
FS-MB1077-01	4.80	1.70	2.00	0.32	2.15	0.05	4.61	0.51	320	70	Bright
FS-MB1077-02	4.80	1.70	2.00	0.32	2.15	0.05	4.61	0.51	320	70	Tin
FS-MB1077-03	4.80	1.70	2.00	0.32	2.15	0.05	4.61	0.51	320	70	Nickel

FS-MB1721

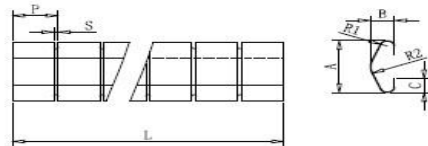
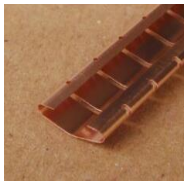

Part No.	A (mm)	B (mm)	C (mm)	R1 (mm)	R2 (mm)	Thick (mm)	P (mm)	S (mm)	Length (mm)	Fingers	Finish
FS-MB1721-01	8.13	2.79	2.16	0.95	2.79	0.09	4.75	0.45	408	87	Bright
FS-MB1721-02	8.13	2.79	2.16	0.95	2.79	0.09	4.75	0.45	408	87	Tin
FS-MB1721-03	8.13	2.79	2.16	0.95	2.79	0.09	4.75	0.45	408	87	Nickel
FS-MB2721-01	8.13	2.79	2.16	0.95	2.79	0.05	4.75	0.45	408	87	Bright
FS-MB2721-02	8.13	2.79	2.16	0.95	2.79	0.05	4.75	0.45	408	87	Tin
FS-MB2721-03	8.13	2.79	2.16	0.95	2.79	0.05	4.75	0.45	408	87	Nickel

FS-MB1728

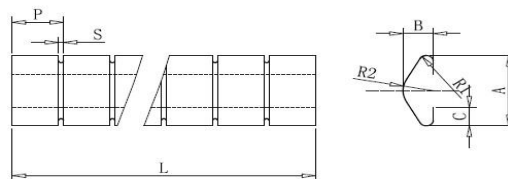

Part No.	A (mm)	B (mm)	C (mm)	R1 (mm)	R2 (mm)	Thick (mm)	P (mm)	S (mm)	Length (mm)	Fingers	Finish
FS-MB1728-01	9.40	3.40	2.40	0.51	2.79	0.08	6.35	0.63	228	36	Bright
FS-MB1728-02	9.40	3.40	2.40	0.51	2.79	0.08	6.35	0.63	228	36	Tin
FS-MB1728-03	9.40	3.40	2.40	0.51	2.79	0.08	6.35	0.63	228	36	Nickel
FS-MB2728-01	9.40	3.40	2.40	0.51	2.79	0.05	6.35	0.63	228	36	Bright
FS-MB2728-02	9.40	3.40	2.40	0.51	2.79	0.05	6.35	0.63	228	36	Tin
FS-MB2728-03	9.40	3.40	2.40	0.51	2.79	0.05	6.35	0.63	228	36	Nickel

FS-MB1957

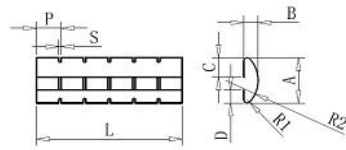

Part No.	A (mm)	B (mm)	C (mm)	D (mm)	R1 (mm)	R2 (mm)	Thick (mm)	P (mm)	S (mm)	L (mm)	Fingers	Finish
FS-MB1957-01	8.90	2.80	3.40	2.30	0.75	2.79	0.08	4.75	0.45	275	58	Bright
FS-MB1957-02	8.90	2.80	3.40	2.30	0.75	2.79	0.08	4.75	0.45	275	58	Tin
FS-MB1957-03	8.90	2.80	3.40	2.30	0.75	2.79	0.08	4.75	0.45	275	58	Nickel
FS-MB295701	8.90	2.80	3.40	2.30	0.75	2.79	0.05	4.75	0.45	270	57	Bright
FS-MB2957-02	8.90	2.80	3.40	2.30	0.75	2.79	0.05	4.75	0.45	270	57	Tin
FS-MB2957-03	8.90	2.80	3.40	2.30	0.75	2.79	0.05	4.75	0.45	270	57	Nickel

FS-MB1457

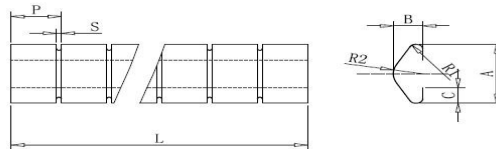

Part No.	A (mm)	B (mm)	C (mm)	D (mm)	R1 (mm)	R2 (mm)	Thick (mm)	P (mm)	S (mm)	L (mm)	Fingers	Finish
FS-MB1457-01	9.40	3.40	2.40	2.30	0.51	2.79	0.08	6.35	0.63	457	72	Bright
FS-MB1457-02	9.40	3.40	2.40	2.30	0.51	2.79	0.08	6.35	0.63	457	72	Tin
FS-MB1457-03	9.40	3.40	2.40	2.30	0.51	2.79	0.08	6.35	0.63	457	72	Nickel
FS-MB245701	9.40	3.40	2.40	2.30	0.51	2.79	0.05	6.35	0.63	457	72	Bright
FS-MB2457-02	9.40	3.40	2.40	2.30	0.51	2.79	0.05	6.35	0.63	457	72	Tin
FS-MB2457-03	9.40	3.40	2.40	2.30	0.51	2.79	0.05	6.35	0.63	457	72	Nickel

FS-MB1711

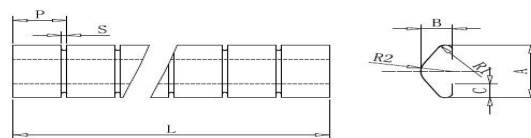

Part No.	A (mm)	B (mm)	C (mm)	R1 (mm)	R2 (mm)	Thick. (mm)	P (mm)	S (mm)	L (mm)	Fingers	Finish
FS-MB1711-01	15.20	5.59	3.56	1.00	4.56	0.13	7.16	0.63	406	57	Bright
FS-MB1711-02	15.20	5.59	3.56	1.00	4.56	0.13	7.16	0.63	406	57	Tin
FS-MB1711-03	15.20	5.59	3.56	1.00	4.56	0.13	7.16	0.63	406	57	Nickel
FS-MB2711-01	15.20	5.59	3.56	1.00	4.56	0.08	7.16	0.63	406	57	Bright
FS-MB2711-02	15.20	5.59	3.56	1.00	4.56	0.08	7.16	0.63	406	57	Tin
FS-MB2711-03	15.20	5.59	3.56	1.00	4.56	0.08	7.16	0.63	406	57	Nickel

FS-MB1533

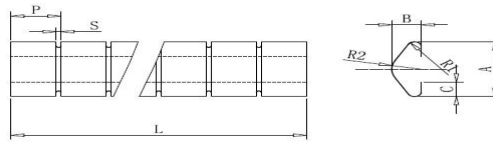

Part No.	A (mm)	B (mm)	C (mm)	R1 (mm)	R2 (mm)	Thick (mm)	P (mm)	S (mm)	L (mm)	Fingers	Finish
FS-MB1533-01	7.50	3.50	2.16	0.51	2.79	0.08	4.75	0.45	408	86	Bright
FS-MB1533-02	7.50	3.50	2.16	0.51	2.79	0.08	4.75	0.45	408	86	Tin
FS-MB1533-03	7.50	3.50	2.16	0.51	2.79	0.08	4.75	0.45	408	86	Nickel

DUAL SLOT MOUNTED SERIES

FS-MB1109

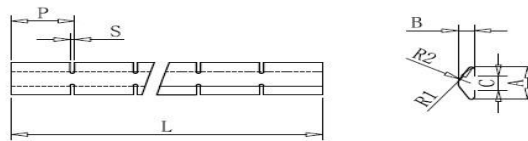

Part No.	A (mm)	B (mm)	C (mm)	R1 (mm)	R2 (mm)	Thick. (mm)	P (mm)	S (mm)	L (mm)	Fingers	Finish
FS-MB1109-01	4.85	1.70	2.16	0.32	2.15	0.05	6.48	0.51	233	36	Bright
FS-MB1109-02	4.85	1.70	2.16	0.32	2.15	0.05	6.48	0.51	233	36	Tin
FS-MB1109-03	4.85	1.70	2.16	0.32	2.15	0.05	6.48	0.51	233	36	Nickel

FS-MB1136

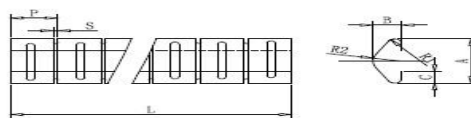

Part No.	A (mm)	B (mm)	C (mm)	R1 (mm)	R2 (mm)	Thick. (mm)	P (mm)	S (mm)	L (mm)	Fingers	Finish
FS-MB1136-01	8.13	2.79	2.16	0.51	2.79	0.09	4.75	0.45	413	87	Bright
FS-MB1136-02	8.13	2.79	2.16	0.51	2.79	0.09	4.75	0.45	413	87	Tin
FS-MB1136-03	8.13	2.79	2.16	0.51	2.79	0.09	4.75	0.45	413	87	Nickel

FS-MB1793

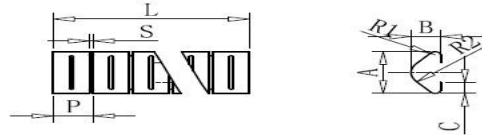

Part No.	A (mm)	B (mm)	C (mm)	R1 (mm)	R2 (mm)	Thick. (mm)	P (mm)	S (mm)	L (mm)	Fingers	Finish
FS-MB1793-01	8.25	3.50	2.16	0.51	2.79	0.09	4.75	0.45	413	87	Bright
FS-MB1793-02	8.25	3.50	2.16	0.51	2.79	0.09	4.75	0.45	413	87	Tin
FS-MB1793-03	8.25	3.50	2.16	0.51	2.79	0.09	4.75	0.45	413	87	Nickel
FS-MB2793-01	8.25	3.50	2.16	0.51	2.79	0.05	4.75	0.45	413	87	Bright
FS-MB2793-02	8.25	3.50	2.16	0.51	2.79	0.05	4.75	0.45	413	87	Tin
FS-MB2793-03	8.25	3.50	2.16	0.51	2.79	0.05	4.75	0.45	413	87	Nickel

FS-MB1756

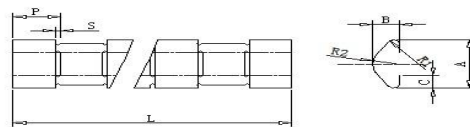

Part No.	A (mm)	B (mm)	C (mm)	R1 (mm)	R2 (mm)	Thick. (mm)	P (mm)	S (mm)	L (mm)	Fingers	Finish
FS-MB1756-01	8.13	2.79	2.16	0.51	2.79	0.09	4.75	0.45	413	87	Bright
FS-MB1756-02	8.13	2.79	2.16	0.51	2.79	0.09	4.75	0.45	413	87	Tin
FS-MB1756-03	8.13	2.79	2.16	0.51	2.79	0.09	4.75	0.45	413	87	Nickel
FS-MB2756-01	8.13	2.79	2.16	0.51	2.79	0.05	4.75	0.45	413	87	Bright
FS-MB2756-02	8.13	2.79	2.16	0.51	2.79	0.05	4.75	0.45	413	87	Tin
FS-MB2756-03	8.13	2.79	2.16	0.51	2.79	0.05	4.75	0.45	413	87	Nickel

FS-MB1798

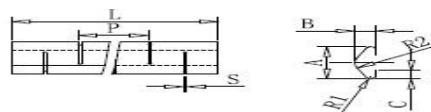

Part No.	A (mm)	B (mm)	C (mm)	R1 (mm)	R2 (mm)	Thick. (mm)	P (mm)	S (mm)	L (mm)	Fingers	Finish
FS-MB1798-01	8.13	2.79	2.16	0.51	2.79	0.09	9.50	0.45	413	87	Bright
FS-MB1798-02	8.13	2.79	2.16	0.51	2.79	0.09	9.50	0.45	413	87	Tin
FS-MB1798-03	8.13	2.79	2.16	0.51	2.79	0.09	9.50	0.45	413	87	Nickel
FS-MB2798-01	8.13	2.79	2.16	0.51	2.79	0.05	9.50	0.45	413	87	Bright
FS-MB2798-02	8.13	2.79	2.16	0.51	2.79	0.05	9.50	0.45	360	76	Tin
FS-MB2798-03	8.13	2.79	2.16	0.51	2.79	0.05	9.50	0.45	360	76	Nickel

FS-MB1061

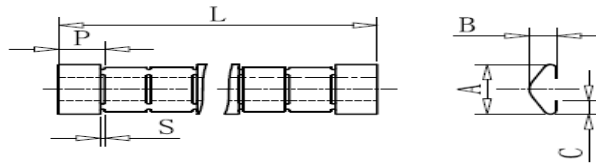

Part No.	A (mm)	B (mm)	C (mm)	R1 (mm)	R2 (mm)	Thick. (mm)	P (mm)	S (mm)	L (mm)	Fingers	Finish
FS-MB1061-01	8.13	2.79	2.16	0.51	2.79	0.09	4.75	0.45	413	87	Bright
FS-MB1061-02	8.13	2.79	2.16	0.51	2.79	0.09	4.75	0.45	413	87	Tin
FS-MB1061-03	8.13	2.79	2.16	0.51	2.79	0.09	4.75	0.45	413	87	Nickel
FS-MB2061-01	8.13	2.79	2.16	0.51	2.79	0.05	4.75	0.45	413	87	Bright
FS-MB2061-02	8.13	2.79	2.16	0.51	2.79	0.05	4.75	0.45	413	76	Tin
FS-MB2061-03	8.13	2.79	2.16	0.51	2.79	0.05	4.75	0.45	413	76	Nickel

FS-MB4524

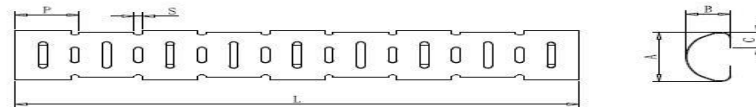

Part No.	A (mm)	B (mm)	C (mm)	R (mm)	Thick. (mm)	P (mm)	S (mm)	L (mm)	Fingers	Finish
FS-MB4524-01	8.13	2.79	2.16	0.51	0.09	4.75	0.45	413	87	Bright
FS-MB4524-02	8.13	2.79	2.16	0.51	0.09	4.75	0.45	413	87	Tin
FS-MB4524-03	8.13	2.79	2.16	0.51	0.09	4.75	0.45	413	87	Nickel

TRACK MOUNT SERIES

FS-MB1919

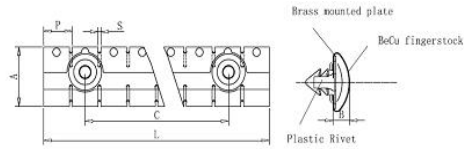

Part No.	A (mm)	B (mm)	C (mm)	Thick. (mm)	P (mm)	S (mm)	L (mm)	Track	Fingers	Finish
FS-MB1919-01	8.90	2.80	38.10	0.07	4.75	0.46	380	Brass	80	Bright
FS-MB1919-02	8.90	2.80	38.10	0.07	4.75	0.46	380	Brass	80	Tin
FS-MB1919-03	8.90	2.80	38.10	0.07	4.75	0.46	380	Brass	80	Nickel

*Symmetrical slot. Supplied with black or white rivets

FS-MB1958

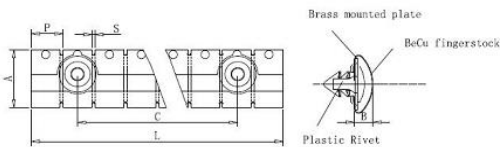

Part No.	A (mm)	B (mm)	C (mm)	Thick. (mm)	P (mm)	S (mm)	L (mm)	Track	Fingers	Finish
FS-MB1958-01	8.90	2.80	38.10	0.07	4.75	0.46	380	Brass	80	Bright
FS-MB1958-02	8.90	2.80	38.10	0.07	4.75	0.46	380	Brass	80	Tin
FS-MB1958-03	8.90	2.80	38.10	0.07	4.75	0.46	380	Brass	80	Nickel

*Single slot. Supplied with black or white rivets

FS-MB1955

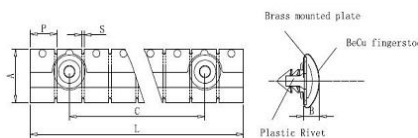

Part No.	A (mm)	B (mm)	C (mm)	Thick. (mm)	P (mm)	S (mm)	L (mm)	Track	Fingers	Finish
FS-MB1955-01	11.43	3.56	38.10	0.10	6.35	0.46	380	Brass	50	Bright
FS-MB1955-02	11.43	3.56	38.10	0.10	6.35	0.46	380	Brass	50	Tin
FS-MB1955-03	11.43	3.56	38.10	0.10	6.35	0.46	380	Brass	50	Nickel

*Single slot. Supplied with black or white rivets

FS-MB1952

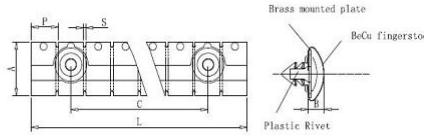

Part No.	A (mm)	B (mm)	C (mm)	Thick. (mm)	P (mm)	S (mm)	L (mm)	Track	Fingers	Finish
FS-MB1952-01	15.70	5.58	38.10	0.10	9.52	0.46	380	Brass	40	Bright
FS-MB1952-02	15.70	5.58	38.10	0.10	9.52	0.46	380	Brass	40	Tin
FS-MB1952-03	15.70	5.58	38.10	0.10	9.52	0.46	380	Brass	40	Nickel

*Single slot. Supplied with black or white rivets

ADHESIVE MOUNT SERIES

Adhesive mount gaskets are a general purpose gasket used in wiping and compression applications such as in enclosures, MRI doors and in shielded cabinets.

FS-MB1114



Part No.	A (mm)	B (mm)	C (mm)	Thick. (mm)	P (mm)	S (mm)	L (mm)	3M9469 Tape	Fingers	Finish
FS-MB1114-01	23.40	2.50	16.60	0.13	4.75	1.20	7620	9.50	1604	Bright
FS-MB1114-02	23.40	2.50	16.60	0.13	4.75	1.20	7620	9.50	1604	Tin
FS-MB1114-03	23.40	2.50	16.60	0.13	4.75	1.20	7620	9.50	1604	Nickel

FS-MB1012

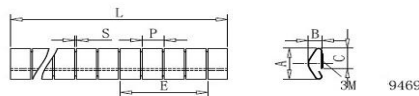

Part No.	A (mm)	B (mm)	C (mm)	E (mm)	Thick. (mm)	P (mm)	S (mm)	L (mm)	3M9469 Tape	Fingers	Finish
FS-MB1012-01	8.13	2.79	5.30	19.0	0.06	4.75	0.45	610	3.80	129	Bright
FS-MB1012-02	8.13	2.79	5.30	19.0	0.06	4.75	0.45	610	3.80	129	Tin
FS-MB1012-03	8.13	2.79	5.30	19.0	0.06	4.75	0.45	610	3.80	129	Nickel
FS-MB1012-03	8.13	2.79	5.30	19.0	0.06	4.75	0.45	7620	3.80	1604	Bright

FS-MB1540

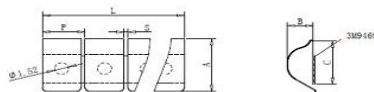

Part No.	A (mm)	B (mm)	C (mm)	Thick. (mm)	P (mm)	S (mm)	L (mm)	3M9469 Tape	Fingers	Finish
FS-MB1540-01	7.10	2.80	5.60	0.08	4.78	0.45	406	3.80	85	Bright
FS-MB1540-02	7.10	2.80	5.60	0.08	4.78	0.45	406	3.80	85	Tin
FS-MB1540-03	7.10	2.80	5.60	0.08	4.78	0.45	406	3.80	85	Nickel
FS-MB1540C-01	7.10	2.80	5.60	0.08	4.78	0.45	7620	3.80	1605	Bright

FS-MB1541

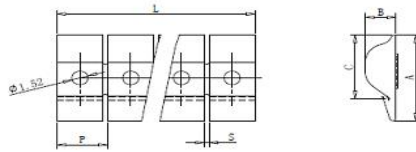

Part No.	A (mm)	B (mm)	C (mm)	Thick. (mm)	P (mm)	S (mm)	L (mm)	3M9469 Tape	Fingers	Finish
FS-MB1541-01	9.52	2.80	7.20	0.08	4.78	0.45	406	3.80	85	Bright
FS-MB1541-02	9.52	2.80	7.20	0.08	4.78	0.45	406	3.80	85	Tin
FS-MB1541-03	9.52	2.80	7.20	0.08	4.78	0.45	406	3.80	85	Nickel
FS-MB1541C-01	9.52	2.80	7.20	0.08	4.78	0.45	7620	3.80	1605	Bright

FS-MB1542

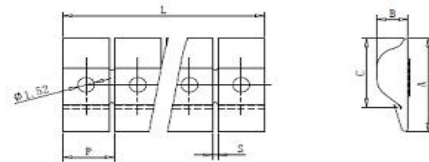

Part No.	A (mm)	B (mm)	C (mm)	Thick. (mm)	P (mm)	S (mm)	L (mm)	3M9469 Tape	Fingers	Finish
FS-MB1542-01	6.35	2.10	4.70	0.06	4.78	0.45	406	3.80	85	Bright
FS-MB1542-02	6.35	2.10	4.70	0.06	4.78	0.45	406	3.80	85	Tin
FS-MB1542-03	6.35	2.10	4.70	0.06	4.78	0.45	406	3.80	85	Nickel
FS-MB1542C-01	6.35	2.10	4.70	0.06	4.78	0.45	7620	3.80	1605	Bright

FS-MB1520

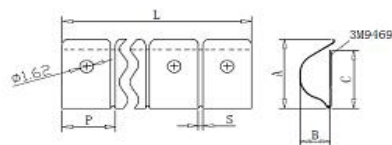

Part No.	A (mm)	B (mm)	C (mm)	Thick. (mm)	P (mm)	S (mm)	L (mm)	3M9469 Tape	Fingers	Finish
FS-MB1520-01	8.90	3.56	7.60	0.08	6.35	0.56	406	4.70	64	Bright
FS-MB1520-02	8.90	3.56	7.60	0.08	6.35	0.56	406	4.70	64	Tin
FS-MB1520-03	8.90	3.56	7.60	0.08	6.35	0.56	406	4.70	64	Nickel
FS-MB1520C-01	8.90	3.56	7.60	0.08	6.35	0.56	7620	4.70	1200	Bright

FS-MB1521

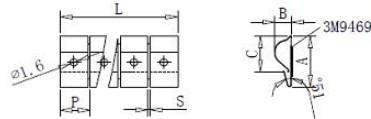
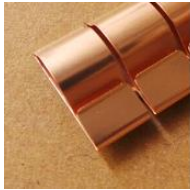

Part No.	A (mm)	B (mm)	C (mm)	Thick. (mm)	P (mm)	S (mm)	L (mm)	3M9469 Tape	Fingers	Finish
FS-MB1521-01	13.00	3.56	9.30	0.08	6.35	0.56	406	4.70	64	Bright
FS-MB1521-02	13.00	3.56	9.30	0.08	6.35	0.56	406	4.70	64	Tin
FS-MB1521-03	13.00	3.56	9.30	0.08	6.35	0.56	406	4.70	64	Nickel
FS-MB1521C-01	13.00	3.56	9.30	0.08	6.35	0.56	7620	4.70	1200	Bright

FS-MB1500

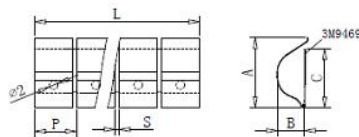

Part No.	A (mm)	B (mm)	C (mm)	Thick. (mm)	P (mm)	S (mm)	L (mm)	3M9469 Tape	Fingers	Finish
FS-MB1500-01	15.10	5.80	12.70	0.10	9.52	0.82	610	6.30	64	Bright
FS-MB1500-02	15.10	5.80	12.70	0.10	9.52	0.82	610	6.30	64	Tin
FS-MB1500-03	15.10	5.80	12.70	0.10	9.52	0.82	610	6.30	64	Nickel
FS-MB1500C-01	15.10	5.80	12.70	0.10	9.52	0.82	7620	6.30	800	Bright

FS-MB1185

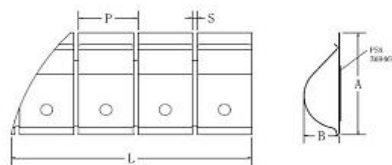

Part No.	A (mm)	B (mm)	Thick. (mm)	P (mm)	S (mm)	L (mm)	3M9469 Tape	Fingers	Finish
FS-MB1185-01	18.30	5.90	0.08	9.80	0.80	610	9.60	63	Bright
FS-MB1185-02	18.30	5.90	0.08	9.80	0.80	610	9.60	63	Tin
FS-MB1185-03	18.30	5.90	0.08	9.80	0.80	610	9.60	63	Nickel
FS-MB1185C-01	18.30	5.90	0.08	9.80	0.80	7620	9.60	778	Bright

FS-MB1078

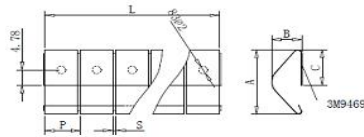

Part No.	A (mm)	B (mm)	C (mm)	Thick. (mm)	P (mm)	S (mm)	L (mm)	3M9469 Tape	Fingers	Finish
FS-MB1078-01	20.30	8.10	11.20	0.10	9.52	0.81	610	9.60	64	Bright
FS-MB1078-02	20.30	8.10	11.20	0.10	9.52	0.81	610	9.60	64	Tin
FS-MB1078-03	20.30	8.10	11.20	0.10	9.52	0.81	610	9.60	64	Nickel
FS-MB1078C-01	20.30	8.10	11.20	0.10	9.52	0.81	7620	9.60	800	Bright

FS-MB1538

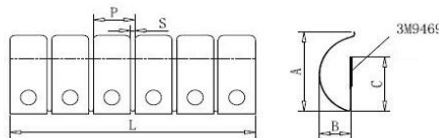

Part No.	A (mm)	B (mm)	C (mm)	Thick. (mm)	P (mm)	S (mm)	L (mm)	3M9469 Tape	Fingers	Finish
FS-MB1538-01	19.30	6.60	13.50	0.10	9.52	1.00	610	6.30	64	Bright
FS-MB1538-02	19.30	6.60	13.50	0.10	9.52	1.00	610	6.30	64	Tin
FS-MB1538-03	19.30	6.60	13.50	0.10	9.52	1.00	610	6.30	64	Nickel
FS-MB1538C-01	19.30	6.60	13.50	0.10	9.52	1.00	7620	6.30	800	Bright

FS-MB1537

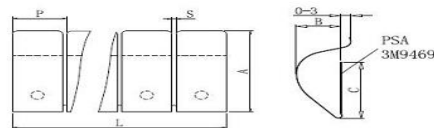

Part No.	A (mm)	B (mm)	C (mm)	Thick. (mm)	P (mm)	S (mm)	L (mm)	3M9469 Tape	Fingers	Finish
FS-MB1537-01	28.50	10.30	20.00	0.15	12.70	1.00	610	9.60	48	Bright
FS-MB1537-02	28.50	10.30	20.00	0.15	12.70	1.00	610	9.60	48	Tin
FS-MB1537-03	28.50	10.30	20.00	0.15	12.70	1.00	610	9.60	48	Nickel
FS-MB1537C-01	28.50	10.30	20.00	0.15	12.70	1.00	7620	9.60	600	Bright

FS-MB1782

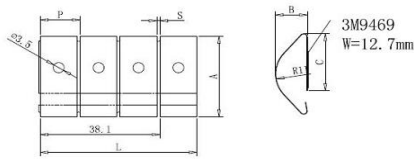
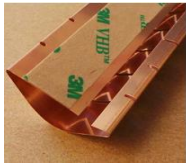

Part No.	A (mm)	B (mm)	C (mm)	Thick. (mm)	P (mm)	S (mm)	L (mm)	3M9469 Tape	Fingers	Finish
FS-MB1782-01	28.00	10.10	19.80	0.13	12.70	1.00	610	6.30	48	Bright
FS-MB1782-02	28.00	10.10	19.80	0.13	12.70	1.00	610	6.30	48	Tin
FS-MB1782-03	28.00	10.10	19.80	0.13	12.70	1.00	610	6.30	48	Nickel
FS-MB1782C-01	28.00	10.10	19.80	0.13	12.70	1.00	7620	6.30	600	Bright

FS-MB1014

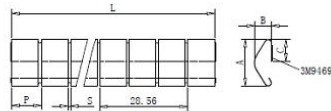

Part No.	A (mm)	B (mm)	C (mm)	Thick. (mm)	P (mm)	S (mm)	L (mm)	3M9469 Tape	Fingers	Finish
FS-MB1014-01	15.20	5.60	7.10	0.09	9.52	0.81	610	6.30	64	Bright
FS-MB1014-02	15.20	5.60	7.10	0.09	9.52	0.81	610	6.30	64	Tin
FS-MB1014-03	15.20	5.60	7.10	0.09	9.52	0.81	610	6.30	64	Nickel
FS-MB1014C-01	15.20	5.60	7.10	0.09	9.52	0.81	7620	6.30	800	Bright

LOW PROFILE SERIES

FS-MB1743

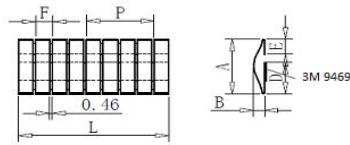
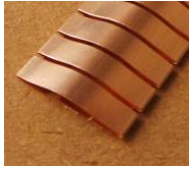

Part No.	A (mm)	B (mm)	D (mm)	Thick. (mm)	P (mm)	E (mm)	F (mm)	L (mm)	3M9469 Tape	Fingers	Finish
FS-MB1743-01	11.43	2.03	6.60	0.09	12.70	3.04	3.18	406	3.80		Bright
FS-MB1743-02	11.43	2.03	6.60	0.09	12.70	3.04	3.18	406	3.80		Tin
FS-MB1743-03	11.43	2.03	6.60	0.09	12.70	3.04	3.18	406	3.80		Nickel
FS-MB1743C-01	11.43	2.03	6.60	0.09	12.70	3.04	3.18	7620	3.80		Bright

FS-MB1071

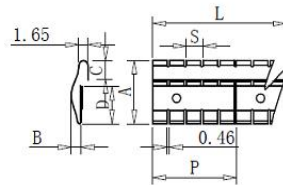

Part No.	A (mm)	B (mm)	C (mm)	D (mm)	Thick. (mm)	P (mm)	S (mm)	L (mm)	3M9469 Tape	Fingers	Finish
FS-MB1071-01	11.43	1.60	3.40	6.78	0.09	15.80	3.17	406	3.80		Bright
FS-MB1071-02	11.43	1.60	3.40	6.78	0.09	15.80	3.17	406	3.80		Tin
FS-MB1071-03	11.43	1.60	3.40	6.78	0.09	15.80	3.17	406	3.80		Nickel
FS-MB1071C-01	11.43	1.60	3.40	6.78	0.09	15.80	3.17	7620	3.80		Bright

TWISTED SERIES GASKETS

Designed for demanding compression applications and narrow gap filling, the twisted series gaskets can compress to their material thickness, and give excellent shielding performance.

FS-MB1550

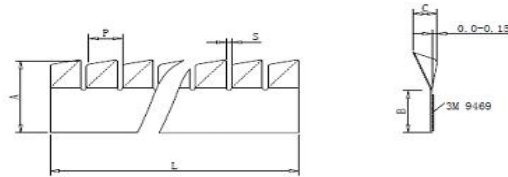
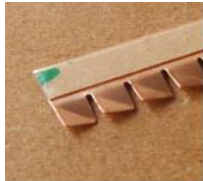

Part No.	A (mm)	B (mm)	C (mm)	Thick. (mm)	P (mm)	S (mm)	L (mm)	3M9469 Tape	Fingers	Finish
FS-MB1550-01	5.90	3.50	0.77	0.08	2.42	0.40	610	2.80	252	Bright
FS-MB1550-02	5.90	3.50	0.77	0.08	2.42	0.40	610	2.80	252	Tin
FS-MB1550-03	5.90	3.50	0.77	0.08	2.42	0.40	610	2.80	252	Nickel
FS-MB1550C-01	5.90	3.50	0.77	0.08	2.42	0.40	7620	2.80	3188	Bright
FS-MB2550-01	5.90	3.50	0.77	0.05	2.42	0.40	610	2.80	252	Bright
FS-MB2550-02	5.90	3.50	0.77	0.05	2.42	0.40	610	2.80	252	Tin
FS-MB2550-03	5.90	3.50	0.77	0.05	2.42	0.40	610	2.80	252	Nickel
FS-MB2550C-01	5.90	3.50	0.77	0.05	2.42	0.40	7620	2.80	3188	Bright

FS-MB1551

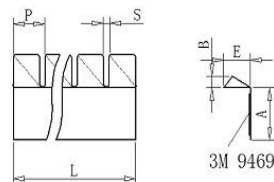

Part No.	A (mm)	B (mm)	E (mm)	Thick. (mm)	P (mm)	S (mm)	L (mm)	3M9469 Tape	Fingers	Finish
FS-MB1551-01	4.00	0.77	2.10	0.08	2.42	0.40	610	2.80	252	Bright
FS-MB1551-02	4.00	0.77	2.10	0.08	2.42	0.40	610	2.80	252	Tin
FS-MB1551-03	4.00	0.77	2.10	0.08	2.42	0.40	610	2.80	252	Nickel
FS-MB1551C-01	4.00	0.77	2.10	0.08	2.42	0.40	7620	2.80	3188	Bright
FS-MB2551-01	4.00	0.77	2.10	0.05	2.42	0.40	610	2.80	252	Bright
FS-MB2551-02	4.00	0.77	2.10	0.05	2.42	0.40	610	2.80	252	Tin
FS-MB2551-03	4.00	0.77	2.10	0.05	2.42	0.40	610	2.80	252	Nickel
FS-MB2551C-01	4.00	0.77	2.10	0.05	2.42	0.40	7620	2.80	31	Bright
FS-MS1551-01	4.00	0.77	2.10	0.08	2.42	0.40	610	2.80	252	S/Steel
FS-MS1551C-01	4.00	0.77	2.10	0.08	2.42	0.40	7620	2.80	3188	S/Steel

FS-MB1555

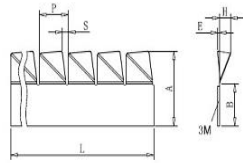
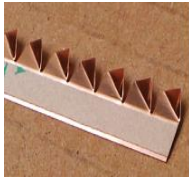

Part No.	A (mm)	B (mm)	E (mm)	Thick. (mm)	P (mm)	S (mm)	L (mm)	3M9469 Tape	Fingers	Finish
FS-MB1555-01	8.64	4.58	0.30	0.08	4.20	0.40	610	3.80	145	Bright
FS-MB1555-02	8.64	4.58	0.30	0.08	4.20	0.40	610	3.80	145	Tin
FS-MB1555-03	8.64	4.58	0.30	0.08	4.20	0.40	610	3.80	145	Nickel
FS-MB1551C-01	8.64	4.58	0.30	0.08	4.20	0.40	7620	3.80	1815	Bright
FS-MB2555-01	8.64	4.58	0.30	0.05	4.20	0.40	610	3.80	145	Bright
FS-MB2555-02	8.64	4.58	0.30	0.05	4.20	0.40	610	3.80	145	Tin
FS-MB2555-03	8.64	4.58	0.30	0.05	4.20	0.40	610	3.80	145	Nickel
FS-MB2555C-01	8.64	4.58	0.30	0.05	4.20	0.40	7620	3.80	1815	Bright

FS-MB1560

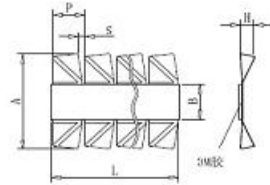

Part No.	A (mm)	B (mm)	H (mm)	Thick. (mm)	P (mm)	S (mm)	L (mm)	3M9469 Tape	Fingers	Finish
FS-MB1560-01	12.70	4.70	1.75	0.08	4.20	0.40	610	4.60	145	Bright
FS-MB1560-02	12.70	4.70	1.75	0.08	4.20	0.40	610	4.60	145	Tin
FS-MB1560-03	12.70	4.70	1.75	0.08	4.20	0.40	610	4.60	145	Nickel
FS-MB1560C-01	12.70	4.70	1.75	0.08	4.20	0.40	7620	4.60	1815	Bright

FS-MB1558

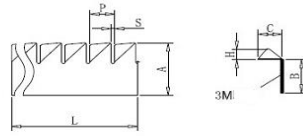
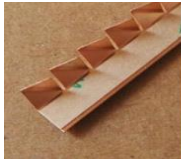

Part No.	A (mm)	B (mm)	C (mm)	H (mm)	Thick. (mm)	P (mm)	S (mm)	L (mm)	3M9469 Tape	Fingers	Finish
FS-MB1558-01	7.75	5.00	2.87	1.75	0.08	4.20	0.40	610	4.60	145	Bright
FS-MB1558-02	7.75	5.00	2.87	1.75	0.08	4.20	0.40	610	4.60	145	Tin
FS-MB1558-03	7.75	5.00	2.87	1.75	0.08	4.20	0.40	610	4.60	145	Nickel
FS-MB1558C-01	7.75	5.00	2.87	1.75	0.08	4.20	0.40	7620	4.60	1815	Bright

FS-MB1559

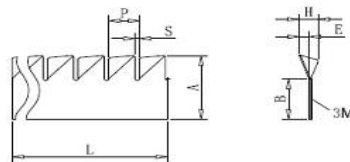

Part No.	A (mm)	B (mm)	E (mm)	H (mm)	Thick. (mm)	P (mm)	S (mm)	L (mm)	3M9469 Tape	Fingers	Finish
FS-MB1559-01	7.75	4.50	0.30	1.75	0.08	4.20	0.40	610	3.80	145	Bright
FS-MB1559-02	7.75	4.50	0.30	1.75	0.08	4.20	0.40	610	3.80	145	Tin
FS-MB1559-03	7.75	4.50	0.30	1.75	0.08	4.20	0.40	610	3.80	145	Nickel

ENCLOSURE SERIES

FS-MB1535

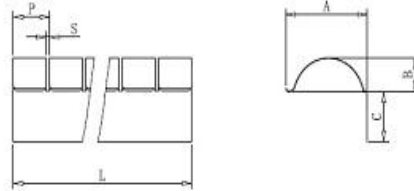

Part No.	A (mm)	B (mm)	C (mm)	Thick. (mm)	P (mm)	S (mm)	L (mm)	Fingers	Finish
FS-MB1535-01	19.80	6.35	12.00	0.13	9.52	1.01	305	32	Bright

FS-MB1640

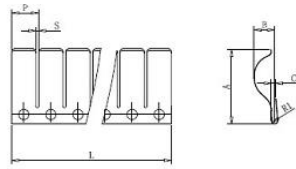
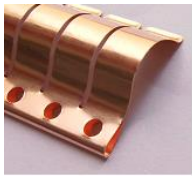

Part No.	A (mm)	B (mm)	C (mm)	R1 (mm)	Thick. (mm)	P (mm)	S (mm)	L (mm)	Fingers	Finish
FS-MB1640-01	27.70	6.60	1.00	1.80	0.13	5.08	1.01	406	43	Bright
FS-MB1640-02	27.70	6.60	1.00	1.80	0.13	5.08	1.01	406	43	Tin
FS-MB1640-03	27.70	6.60	1.00	1.80	0.13	5.08	1.01	406	43	Nickel
FS-MB1640MODA-01	27.70	6.60	1.00	2.29	0.13	5.08	1.01	406	43	Bright
FS-MB1640MODA-02	27.70	6.60	1.00	2.29	0.13	5.08	1.01	406	43	Tin
FS-MB1640MODA-03	27.70	6.60	1.00	2.29	0.13	5.08	1.01	406	43	Nickel

FS-MB1438

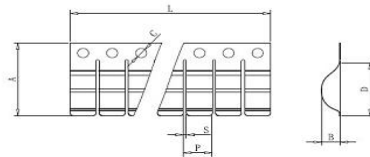

Part No.	A (mm)	B (mm)	C (mm)	D (mm)	Thick. (mm)	P (mm)	S (mm)	L (mm)	Fingers	Finish
FS-MB1438-01	26.80	6.35	3.50	19.80	0.13	9.52	1.00	305	32	Bright
FS-MB1438-01	26.80	6.35	3.50	19.80	0.13	9.52	1.00	610	64	Bright
FS-MB1438C-01	26.80	6.35	3.50	19.80	0.13	9.52	1.00	7620	800	Bright
FS-MB1438-02	26.80	6.35	3.50	19.80	0.13	9.52	1.00	610	800	Tin
FS-MB1438-03	26.80	6.35	3.50	19.80	0.13	9.52	1.00	610	800	Nickel

FS-MB1396

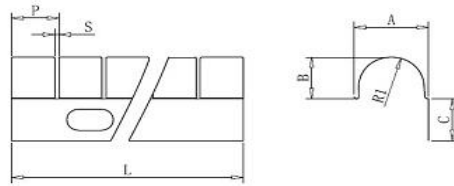

Part No.	A (mm)	B (mm)	C (mm)	R1 (mm)	Thick. (mm)	P (mm)	S (mm)	L (mm)	Fingers	Finish
FS-MB1396-01	16.00	8.50	10.70	8.00	0.13	10.20	0.90	396	39	Bright
FS-MB1396-02	16.00	8.50	10.70	8.00	0.13	10.20	0.90	396	39	Tin
FS-MB1396-03	16.00	8.50	10.70	8.00	0.13	10.20	0.90	396	39	Nickel
FS-MB1396C-01	16.00	8.50	10.70	8.00	0.13	10.20	0.90	7620	747	Bright

FS-MB1178

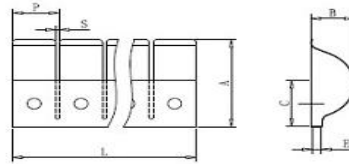

Part No.	A (mm)	B (mm)	C (mm)	E (mm)	Thick. (mm)	P (mm)	S (mm)	L (mm)	Fingers	Finish
FS-MB1178-01	28.50	11.00	15.20	3.00	0.20	12.00	1.00	203	17	Bright
FS-MB1178-02	28.50	11.00	15.20	3.00	0.20	12.00	1.00	203	17	Tin
FS-MB1178-03	28.50	11.00	15.20	3.00	0.20	12.00	1.00	203	17	Nickel

FS-MB1440

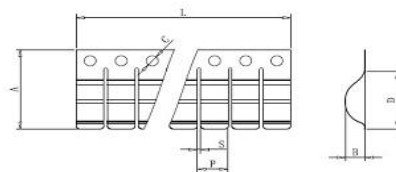
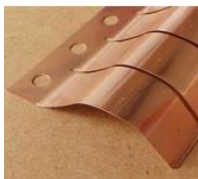

Part No.	A (mm)	B (mm)	C (mm)	D (mm)	Thick. (mm)	P (mm)	S (mm)	L (mm)	Fingers	Finish
FS-MB1440-01	41.60	10.80	3.50	32.30	0.15	12.70	1.00	610	48	Bright
FS-MB1440-02	41.60	10.80	3.50	32.30	0.15	12.70	1.00	610	48	Tin
FS-MB1440-03	41.60	10.80	3.50	32.30	0.15	12.70	1.00	610	48	Nickel
FS-MB1440C-01	41.60	10.80	3.50	32.30	0.15	12.70	1.00	7620	600	Bright

FS-MBCA40

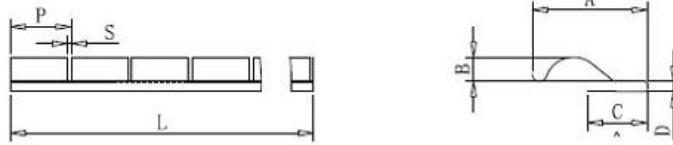

Part No.	A (mm)	B (mm)	C (mm)	D (mm)	Thick. (mm)	P (mm)	S (mm)	L (mm)	Fingers	Finish
FS-MBCA40-01	17.00	4.00	10.00	1.70	0.10	10.00	0.60	200	20	Bright
FS-MBCA40-02	17.00	4.00	10.00	1.70	0.10	10.00	0.60	200	20	Tin
FS-MBCA40-03	17.00	4.00	10.00	1.70	0.10	10.00	0.60	200	20	Nickel

FS-MBCA35

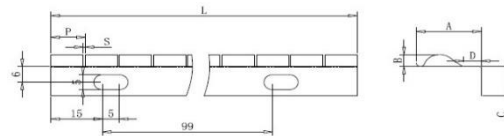

Part No.	A (mm)	B (mm)	C (mm)	D (mm)	Thick. (mm)	P (mm)	S (mm)	L (mm)	Fingers	Finish
FS-MBCA35-01	19.00	4.00	10.50	5.00	0.10	10.00	0.60	200	20	Bright
FS-MBCA35-02	19.00	4.00	10.50	5.00	0.10	10.00	0.60	200	20	Tin
FS-MBCA35-03	19.00	4.00	10.50	5.00	0.10	10.00	0.60	200	20	Nickel

FS-MB1535L

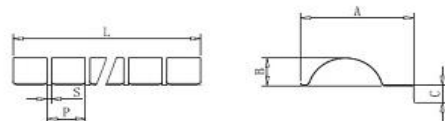

Part No.	A (mm)	B (mm)	C (mm)	Thick. (mm)	P (mm)	S (mm)	L (mm)	Fingers	Finish
FS-MB1535L-01	28.50	6.60	4.81	0.13	9.52	0.60	305	32	Bright
FS-MB1535L-01	28.50	6.60	4.81	0.13	9.52	0.60	406	42	Bright
FS-MB1535L-02	28.50	6.60	4.81	0.13	9.52	0.60	406	42	Tin
FS-MB1535L-03	28.50	6.60	4.81	0.13	9.52	0.60	406	42	Nickel

FS-MB1534

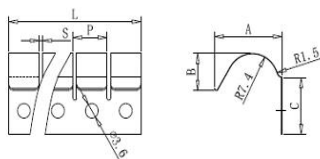

Part No.	A (mm)	B (mm)	C (mm)	Thick. (mm)	P (mm)	S (mm)	L (mm)	Fingers	Finish
FS-MB1534-01	19.00	10.00	14.00	0.10	9.52	1.01	610	64	Bright
FS-MB1534C-01	19.00	10.00	14.00	0.10	9.52	1.01	7620	800	Bright
FS-MB1534-02	19.00	10.00	14.00	0.10	9.52	1.01	610	64	Tin
FS-MB1534-03	19.00	10.00	14.00	0.10	9.52	1.01	610	64	Nickel

FS-MBT788

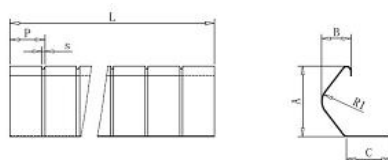

Part No.	A (mm)	B (mm)	C (mm)	R1 (mm)	Thick. (mm)	P (mm)	S (mm)	L (mm)	Fingers	Finish
FS-MBT788-01	20.30	8.13	13.00	6.00	0.13	10.00	0.60	305	32	Bright

FS-KA40

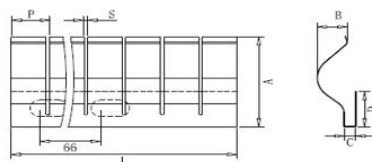

Part No.	A (mm)	B (mm)	C (mm)	D (mm)	Thick. (mm)	P (mm)	S (mm)	L (mm)	Fingers	Finish
FS-MBKA40-01	27.50	7.50	3.00	10.70	0.15	10.00	1.00	199	20	Bright

FS-LD40

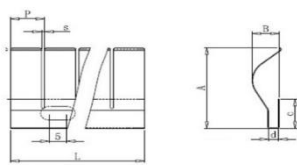

Part No.	A (mm)	B (mm)	C (mm)	D (mm)	Thick. (mm)	P (mm)	S (mm)	L (mm)	Fingers	Finish
FS-MBLD40-01	26.50	10.00	10.70	3.00	0.15	10.00	1.00	406	41	Bright

CLIP ON SERIES

Used in enclosures, cabinets, and on printed circuit boards (PCBs), as an ESD contact and an EMI shield, the clip on gaskets are edge mounted.

FS-MB1613

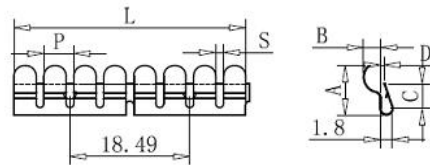

Part No.	A (mm)	B (mm)	C (mm)	D (mm)	Thick. (mm)	P (mm)	S (mm)	L (mm)	Fingers	Finish
FS-MB1613-01	7.90	2.54	4.75	0.50	0.13	4.62	1.20	406	88	Bright
FS-MB1613-02	7.90	2.54	4.75	0.50	0.13	4.62	1.20	406	88	Tin
FS-MB1613-03	7.90	2.54	4.75	0.50	0.13	4.62	1.20	406	88	Nickel

FS-MB1605

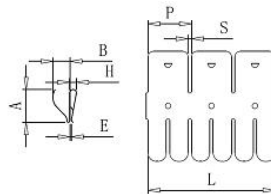

Part No.	A (mm)	B (mm)	H (mm)	E (mm)	Thick. (mm)	P (mm)	S (mm)	L (mm)	Fingers	Finish
FS-MB1605-01	9.52	5.08	1.75	0.30	0.13	5.33	1.00	406	32	Bright
FS-MB1605-02	9.52	5.08	1.75	0.30	0.13	5.33	1.00	610	48	Tin
FS-MB1605-03	9.52	5.08	1.75	0.30	0.13	5.33	1.00	610	48	Nickel

*MB1605 is supplied with T Lance. For D Lance please use code MB1606
Supplied in 12.70mm increments.

FS-MB1645

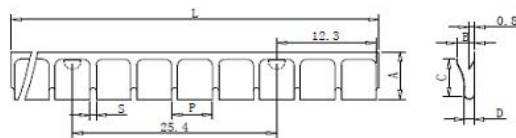

Part No.	A (mm)	B (mm)	C (mm)	D (mm)	Thick. (mm)	P (mm)	S (mm)	L (mm)	Fingers	Finish
FS-MB1645-01	6.35	1.80	5.30	1.20	0.08	5.08	0.76	610	120	Bright
FS-MB1645-02	6.35	1.80	5.30	1.20	0.08	5.08	0.76	610	120	Tin
FS-MB1645-03	6.35	1.80	5.30	1.20	0.08	5.08	0.76	610	120	Nickel
FS-MB1645C-01	6.35	1.80	5.30	1.20	0.08	5.08	0.76	7620	1500	Bright

FS-MB1374

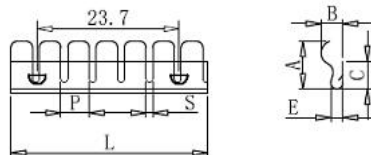

Part No.	A (mm)	B (mm)	C (mm)	E (mm)	Thick. (mm)	P (mm)	S (mm)	L (mm)	Fingers	Finish
FS-MB1374-01	7.70	3.70	5.50	1.60	0.13	4.75	1.15	293	62	Bright
FS-MB1374-02	7.70	3.70	5.50	1.60	0.13	4.75	1.15	293	620	Tin
FS-MB1374-03	7.70	3.70	5.50	1.60	0.13	4.75	1.15	293	62	Nickel

*D Lance at 23.7mm intervals

FS-MB1612

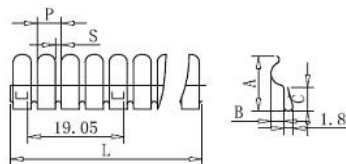

Part No.	A (mm)	B (mm)	C (mm)	Thick. (mm)	P (mm)	S (mm)	L (mm)	Fingers	Finish
FS-MB1612-01	11.07	2.54	4.75	0.13	4.75	1.19	406	86	Bright
FS-MB1612-02	11.07	2.54	4.75	0.13	4.75	1.19	610	129	Tin
FS-MB1612-03	11.07	2.54	4.75	0.13	4.75	1.19	610	129	Nickel
FS-MB1612C-01	11.07	2.54	4.75	0.13	4.75	1.19	7620	1604	Bright

FS-MB1637

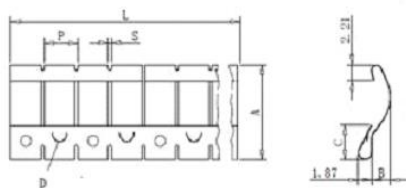

Part No.	A (mm)	B (mm)	C (mm)	Thick. (mm)	P (mm)	S (mm)	L (mm)	Fingers	Finish
FS-MB1637-01	13.00	2.78	4.78	0.09	4.78	0.45	406	85	Bright
FS-MB1637-02	13.00	2.78	4.78	0.09	4.78	0.45	406	85	Tin
FS-MB1637-03	13.00	2.78	4.78	0.09	4.78	0.45	406	85	Nickel
FS-MB1637C-01	13.00	2.78	4.78	0.09	4.78	0.45	7620	1594	Bright

FS-MB1874

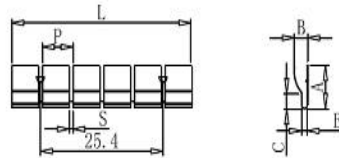
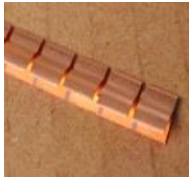

Part No.	A (mm)	B (mm)	C (mm)	E (mm)	Thick. (mm)	P (mm)	S (mm)	L (mm)	Fingers	Finish
FS-MB1874-01	7.10	2.60	2.30	1.15	0.09	6.35	0.60	610	96	Bright
FS-MB1874-02	7.10	2.60	2.30	1.15	0.09	6.35	0.60	610	96	Tin
FS-MB1874-03	7.10	2.60	2.30	1.15	0.09	6.35	0.60	610	96	Nickel
FS-MB1874C-01	7.10	2.60	2.30	1.15	0.09	6.35	0.60	7620	1200	Bright

*D Lance at 25.4mm intervals

FS-MB1655

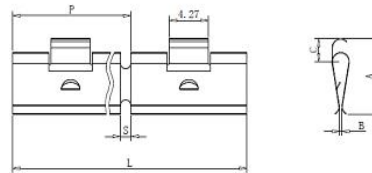
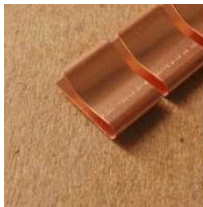

Part No.	A (mm)	B (mm)	C (mm)	Thick. (mm)	P (mm)	S (mm)	L (mm)	Fingers	Finish
FS-MB1655-01	7.74	0.25	1.40	0.09	13.84	1.15	610	44	Bright
FS-MB1655-02	7.74	0.25	1.40	0.09	13.84	1.15	610	44	Tin
FS-MB1655-03	7.74	0.25	1.40	0.09	13.84	1.15	610	44	Nickel
FS-MB1655C-01	7.74	0.25	1.40	0.09	13.84	1.15	7620	551	Bright

FS-MB1656

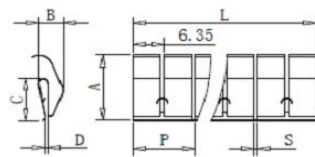

Part No.	A (mm)	B (mm)	C (mm)	D (mm)	Thick. (mm)	P (mm)	S (mm)	L (mm)	Fingers	Finish
FS-MB1656-01	13.80	5.10	8.90	0.30	0.10	12.70	0.76	406	32	Bright
FS-MB1656-02	13.80	5.10	8.90	0.30	0.10	12.70	0.76	406	32	Tin
FS-MB1656-03	13.80	5.10	8.90	0.30	0.10	12.70	0.76	406	32	Nickel

FS-MB1263

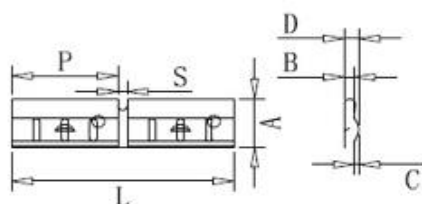

Part No.	A (mm)	B (mm)	C (mm)	D (mm)	Thick. (mm)	P (mm)	S (mm)	L (mm)	Fingers	Finish
FS-MB1263-01	6.00	1.10	0.55	1.70	0.08	12.70	1.10	406	30	Bright
FS-MB1263-02	6.00	1.10	0.55	1.70	0.08	12.70	1.10	406	30	Tin
FS-MB1263-03	6.00	1.10	0.55	1.70	0.08	12.70	1.10	406	30	Nickel
FS-MB1263C-01	6.00	1.10	0.55	1.70	0.08	12.70	1.10	7620	553	Bright

FS-MB1610

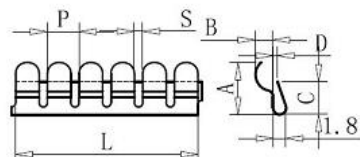

Part No.	A (mm)	B (mm)	C (mm)	D (mm)	Thick. (mm)	P (mm)	S (mm)	L (mm)	Fingers	Finish
FS-MB1610-01	7.54	2.54	4.75	0.50	0.13	4.62	1.20	406	88	Bright
FS-MB1610-02	7.54	2.54	4.75	0.50	0.13	4.62	1.20	406	88	Tin
FS-MB1610-03	7.54	2.54	4.75	0.50	0.13	4.62	1.20	406	88	Nickel

FS-MB4012

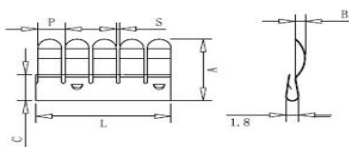

Part No.	A (mm)	B (mm)	C (mm)	Thick. (mm)	P (mm)	S (mm)	L (mm)	Fingers	Finish
FS-MB4012-01	12.00	1.65	5.10	0.13	4.25	0.55	407	96	Bright
FS-MB4012-02	12.00	1.65	5.10	0.13	4.25	0.55	407	96	Tin
FS-MB4012-03	12.00	1.65	5.10	0.13	4.25	0.55	407	96	Nickel

FS-MB1502

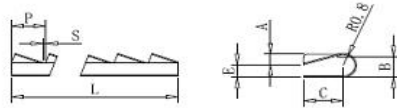

Part No.	A (mm)	B (mm)	C (mm)	E (mm)	Thick. (mm)	P (mm)	S (mm)	L (mm)	Fingers	Finish
FS-MB1502-01	0.75	1.80	2.80	0.90	0.08	2.42	0.38	406	168	Bright
FS-MB1502-02	0.75	1.80	2.80	0.90	0.08	2.42	0.38	406	168	Tin
FS-MB1502-03	0.75	1.80	2.80	0.90	0.08	2.42	0.38	406	168	Nickel

FS-MB5000

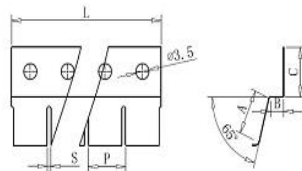

Part No.	A (mm)	B (mm)	C (mm)	Thick. (mm)	P (mm)	S (mm)	L (mm)	Fingers	Finish
FS-MB5000-01	11.00	4.00	11.00	0.10	10.00	1.00	500	50	Bright
FS-MB5000-02	11.00	4.00	11.00	0.10	10.00	1.00	500	50	Tin
FS-MB5000-03	11.00	4.00	11.00	0.10	10.00	1.00	500	50	Nickel

FS-MB1866

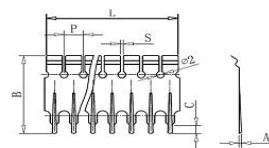

Part No.	A (mm)	B (mm)	Thick. (mm)	P (mm)	S (mm)	L (mm)	Fingers	Finish
FS-MB1866-01	0.78	24.00	0.13	5.00	0.80	7620	1524	Bright
FS-MB1866C-01	0.78	24.00	0.13	5.00	0.80	610	122	Bright

FS-MB1602

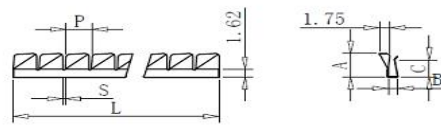

Part No.	A (mm)	B (mm)	C (mm)	Thick. (mm)	P (mm)	S (mm)	L (mm)	Fingers	Finish
FS-MB1602-01	4.78	1.50	3.60	0.08	4.20	0.40	406	93	Bright
FS-MB1602-02	4.78	1.50	3.60	0.08	4.20	0.40	406	93	Tin
FS-MB1602-03	4.78	1.50	3.60	0.08	4.20	0.40	406	93	Nickel

FS-MB1136

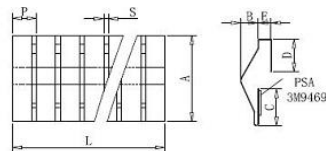
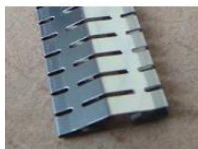

Part No.	A (mm)	B (mm)	C (mm)	E (mm)	Thick. (mm)	P (mm)	S (mm)	L (mm)	Fingers	Finish
FS-MS1136-SS	11.40	2.40	5.10	1.70	0.08	3.18	0.60	368	116	S/Steel

FS-MB1934

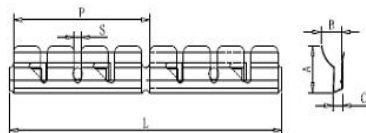

Part No.	A (mm)	B (mm)	C (mm)	Thick. (mm)	P (mm)	S (mm)	L (mm)	Fingers	Finish
FS-MS1934-SS	5.80	3.10	1.35	0.10	20.20	1.00	610	31	S/Steel
FS-MS1934C-SS	5.80	3.10	1.35	0.10	20.20	1.00	7620	381	S/Steel

FS-MB4833

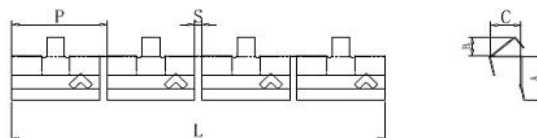

Part No.	A (mm)	B (mm)	C (mm)	Thick. (mm)	P (mm)	S (mm)	L (mm)	Fingers	Finish
FS-MS4833-SS	4.90	2.15	3.30	0.10	10.20	0.80	610	60	S/Steel
FS-MS4833C-SS	4.90	2.15	3.30	0.10	10.20	0.80	7620	762	S/Steel

CONTACT SERIES

Primarily used for grounding and EMI shielding in high frequency applications, the contact gaskets are available in a wide range of sizes. These gaskets may also be supplied cut to length.

FS-MB1221

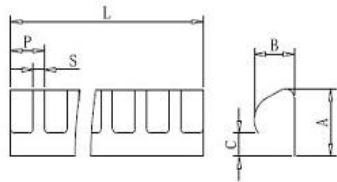

Part No.	A (mm)	B (mm)	C (mm)	Thick. (mm)	P (mm)	S (mm)	L (mm)	Fingers	Finish
FS-MB1221-01	3.20	1.75	0.80	0.10	1.50	0.40	305	204	Bright
FS-MB1221-02	3.20	1.75	0.80	0.10	1.50	0.40	305	204	Tin
FS-MB1221-03	3.20	1.75	0.80	0.10	1.50	0.40	305	204	Nickel
FS-MB1221C-01	3.20	1.75	0.80	0.10	1.50	0.40	7620	5080	Bright

FS-MB2320

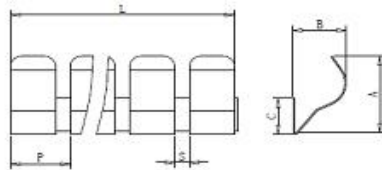

Part No.	A (mm)	B (mm)	C (mm)	Thick. (mm)	P (mm)	S (mm)	L (mm)	Fingers	Finish
FS-MB2320-01	10.90	7.10	5.00	0.08	8.00	2.00	610	77	Bright
FS-MB2320-02	10.90	7.10	5.00	0.08	8.00	2.00	610	77	Tin
FS-MB2320-03	10.90	7.10	5.00	0.08	8.00	2.00	610	77	Nickel

FS-MB1135

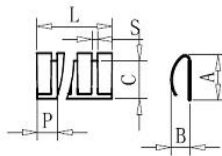
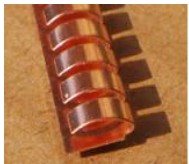

Part No.	A (mm)	B (mm)	C (mm)	Thick. (mm)	P (mm)	S (mm)	L (mm)	Fingers	Finish
FS-MB1135-01	7.13	3.30	5.90	0.25	3.42	0.96	406	119	Bright
FS-MB1135-02	7.13	3.30	5.90	0.25	3.42	0.96	406	119	Tin
FS-MB1135-03	7.13	3.30	5.90	0.25	3.42	0.96	406	119	Nickel
FS-MB1135C-01	7.13	3.30	5.90	0.25	3.42	0.96	7620	2228	Bright

FS-MB1137

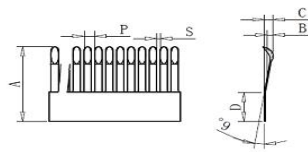
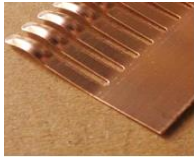

Part No.	A (mm)	B (mm)	C (mm)	Thick. (mm)	P (mm)	S (mm)	L (mm)	Fingers	Finish
FS-MB1137-01	20.00	1.50	2.80	0.25	2.38	0.80	406	170	Bright
FS-MB1137-02	20.00	1.50	2.80	0.25	2.38	0.80	406	170	Tin
FS-MB1137-03	20.00	1.50	2.80	0.25	2.38	0.80	406	170	Nickel
FS-MB1137C-01	20.00	1.50	2.80	0.25	2.38	0.80	7620	2228	Bright

FS-MB1360

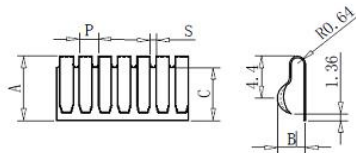

Part No.	A (mm)	B (mm)	C (mm)	Thick. (mm)	P (mm)	S (mm)	L (mm)	Fingers	Finish
FS-MB1360-01	6.74	2.78	5.56	0.15	1.90	0.64	406	204	Bright
FS-MB1360-02	6.74	2.78	5.56	0.15	1.90	0.64	406	204	Tin
FS-MB1360-03	6.74	2.78	5.56	0.15	1.90	0.64	406	204	Nickel
FS-MB1360C-01	6.74	2.78	5.56	0.15	1.90	0.64	7620	5080	Bright

FS-MB1629

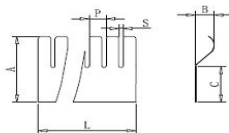

Part No.	A (mm)	B (mm)	C (mm)	Thick. (mm)	P (mm)	S (mm)	L (mm)	Fingers	Finish
FS-MB1629-01	22.10	5.25	12.20	0.10	4.78	1.20	406	86	Bright
FS-MB1629-02	22.10	5.25	12.20	0.10	4.78	1.20	406	86	Tin
FS-MB1629-03	22.10	5.25	12.20	0.10	4.78	1.20	406	86	Nickel
FS-MB1629C-01	22.10	5.25	12.20	0.10	4.78	1.20	7620	1594	Bright

FS-MB1609

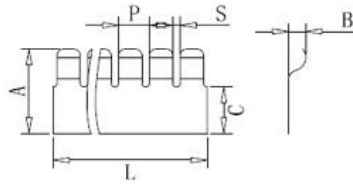
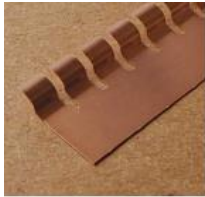

Part No.	A (mm)	B (mm)	C (mm)	Thick. (mm)	P (mm)	S (mm)	L (mm)	Fingers	Finish
FS-MB1609-01	13.40	2.80	7.30	0.10	4.78	1.20	406	85	Bright
FS-MB1609-02	13.40	2.80	7.30	0.10	4.78	1.20	406	85	Tin
FS-MB1609-03	13.40	2.80	7.30	0.10	4.78	1.20	406	85	Nickel
FS-MB1609C-01	13.40	2.80	7.30	0.10	4.78	1.20	7620	1594	Bright

FS-MB1258

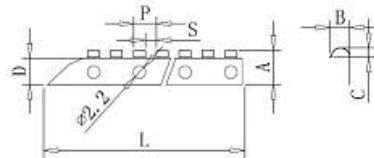

Part No.	A (mm)	B (mm)	C (mm)	D (mm)	Thick. (mm)	P (mm)	S (mm)	L (mm)	Fingers	Finish
FS-MB1258-01	6.30	3.20	1.70	4.80	0.10	4.00	2.00	610	150	Bright
FS-MB1258-02	6.30	3.20	1.70	4.80	0.10	4.00	2.00	610	150	Tin
FS-MB1258-03	6.30	3.20	1.70	4.80	0.10	4.00	2.00	610	150	Nickel
FS-MB1258C-01	6.30	3.20	1.70	4.80	0.10	4.00	2.00	7620	2500	Bright

FS-MB6118

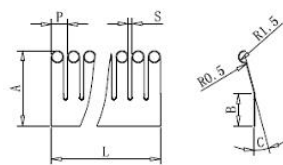
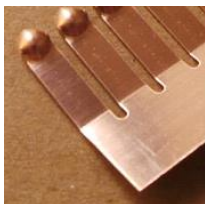

Part No.	A (mm)	B (mm)	C (mm)	Thick. (mm)	P (mm)	S (mm)	L (mm)	Fingers	Finish
FS-MB6118-01	18.20	8.00	15.00	0.20	4.00	1.00	610	85	Bright
FS-MB6118C-01	18.20	8.00	15.00	0.20	4.00	1.00	7620	85	Bright

FS-MB1008

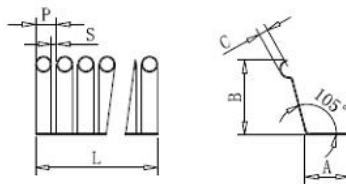

Part No.	A (mm)	B (mm)	C (mm)	Thick. (mm)	P (mm)	S (mm)	L (mm)	Fingers	Finish
FS-M1008-01	8.00	15.00	1.50	0.20	4.00	1.00	610	153	Bright
FS-MB1008C-01	8.00	15.00	1.50	0.20	4.00	1.00	7620	1905	Bright

FS-MB1436

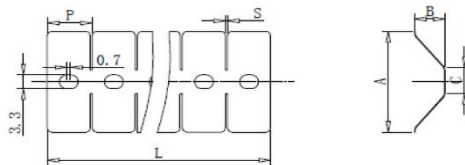

Part No.	A (mm)	B (mm)	C (mm)	Thick. (mm)	P (mm)	S (mm)	L (mm)	Fingers	Finish
FS-M1436-01	23.80	6.35	6.20	0.10	9.52	0.45	610	64	Bright

FS-MB1975

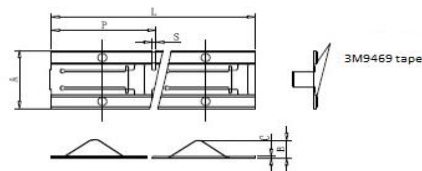
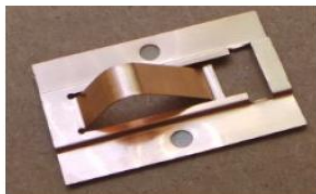

Part No.	A (mm)	B (mm)	C (mm)	Thick. (mm)	P (mm)	S (mm)	L (mm)	Fingers	Finish
FS-MB1975-01	20.30	6.35	1.20	0.127	31.75	1.20	610	19	Bright
FS-MB1975-02	20.30	6.35	1.20	0.127	31.75	1.20	610	19	Tin
FS-MB1975-03	20.30	6.35	1.20	0.127	31.75	1.20	610	19	Nickel

All technical data herein is accurate to the best of our knowledge based on our most up to date testing information and material specifications. This information is not presented as a warranty or guarantee and is not intended to be all inclusive as to conditions of use. The data herein represents typical properties and is not to be used as a basis for a specification.