

BOHN

PRESSES 博信机械



C Frame Single Crank Power Presses - Model C1

Raybould Machine Tools Ltd

web: www.raybould.com e-mail: slr@raybould.com

tel: 01384 565997

THE BOXIN C1 RANGE



The Boxin C1 range are a robust mono block construction power press with stress-relieved welded steel frames and a heavy duty drive gear that runs in a self-contained oil bath thus reducing wear. The crankshafts are manufactured from a forging that is machined and ground rated at 150% overload to provide a higher energy rating.

The C1 design is such that extra steel is built in the 'C' section of the frames to reduce angular deflection. Together with a cast slide body featuring 6-point full length adjustable machined guides providing outstanding position repeat-ability allowing for a longer tool life.

The OMPI Hi Torque low noise combination dry clutch & brake operates in conjunction with a Ross dual safety solenoid valve together with a Mitsubishi plc control, PILZ safety monitoring and user friendly touchscreen operator HMI.

With hydraulic overload protection, variable speed drive, automatic lubrication systems and a centralised maintenance centre built into the main operator panel the C1 is a highly versatile and productive range of power presses.



STANDARD FEATURES



CE Approved

Robust mono-block fabricated steel frame

Frames are stress relieved after welding

Drive gears run in self-contained oil bath

Forged & machined crankshafts are rated for 150% capacity

Motorised slide adjustment with die height readout (60 ton plus)

Adjustable six-point full length machined slide guides

T-Slotted bolster & slide for die clamping

Inverter variable speed drive

Ross DM Series dual safety solenoid valve

Hi Torque low noise OMPI combination dry clutch & brake (Wet clutch available as an option)

Mitsubishi PLC Control with HMI

PILZ safety monitoring

Rotary encoder with spare channels

Brake monitor

User friendly operator controls

Pendant or Floor mounted main operator panel

Additional Space in the MOP

Mobile T-Stand twin push button operator station

Automatic lubrication system

Hydraulic Overload Protection System (H.O.L.P.)

Air balanced slide

Adjustable safety die block electrically interlocked

Flywheel brake for quick stopping of the flywheel

allowing safe and quick entry to the tool area

Automatic lubrication system

Electrically monitored lubrication distribution blocks

Bijur automatic air-counter balance oiling system

Air ejector

Air receptacle

Air pressure switch monitored at control

Air counter balance cylinders for upper die weight

Pre-cut counter

Pre-set counter

Die light

Anti vibration press mounts

BUILD QUALITY

BUILT TO JIS1 STANDARD



**MONOBLOCK
FRAME**



**FORGED,
MACHINED &
GROUND
CRANKSHAFT**



**HYDRAULIC
OVERLOAD
PROTECTION**



**IN-HOUSE
MACHINING**

Every Boxin Press is built to meet or exceed JIS 1st Class standards. JIS 1st Class represents the most exacting and demanding industrial manufacturing standard in the world. Machines that meet these strict guidelines must pass a rigorous inspection with hundreds of designated benchmarks for materials and operation. The adherence to JIS 1st Class represents a commitment to building the best metal forming presses in the world; constantly seeking new ways in the development of ever higher standards of reliability and quality.

C1 SPECIFICATION

AVAILABLE FROM 10 TO 340 TONS

机型	MODEL		C1-90		C1-130		C1-180		C1-230		C1-280		C1-340	
型式	TYPE		V型	H型	V型	H型	V型	H型	V型	H型	V型	H型	V型	V型
公称压力	Capacity Tons	Tons	90		130		180		230		280		340	
能力发生点	Rated tonnage point	mm	5	3	7	3.2	7	3.2	7	3.2	8	3.5	8	3.5
行程数	连续 Continuous	S.P.M	35-80	80-120	30-60	30-90	20-50	40-70	20-50	50-70	20-40	40-60	20-40	40-50
Stroke Per Minute	断续 Intermittent	S.P.M	30		25		20		20		15		15	
行程	Stroke Length	mm	150	70	180	80	200	90	200	100	200	100	200	100
最大模高	Die height(S.D.A.U)	mm	340	380	350	400	450	500	450	500	450	500	500	550
滑块调整量	Slide adjustment	mm	80		80		100		110		120		120	
台盘面积	Bolster area(LR×FB)	mm	1000×550×90		1150×600×120		1250×800×150		1400×820×170		1500×820×170		1500×840×180	
滑块面积	Slide area(LR×FB)	mm	560×420×70		650×470×80		700×550×90		850×630×90		950×700×90		950×700×90	
模孔	Shank hole	mm	Ø50		Ø50		Ø65		Ø65		Ø65		Ø65	
台盘孔	Hole of bolster plate	mm	360×180		400×200		440×220		480×240		480×260		520×260	
主电动机	Main motor	kw×P	7.5×4		15×4		15×4		18.5×4		22.5×4		30×4	
滑块调整机构	Slide adjustment	kw×P	0.37×4		0.37×4		0.75×4		0.37×4		1×4		1.5×4	
	型式MODEL		SA-6.3		SA-6.3		SA-10		SA-14		SA-14		SA-14	
模垫	能力 Capacity	Tons	6.3		6.3		10		14		14		14	
Die Cushion	行程 Stroke	mm	70		80		80		100		100		100	
	面积 Pad area	mm	450×310		500×350		650×420		710×480		710×480		810×480	
使用空气压力	Air pressure	Mpa	0.55		0.55		0.55		0.55		0.55		0.55	
精度	Precision		GB(JIS)级		GB(JIS)级		GB(JIS)级		GB(JIS)级		GB(JIS)级		GB(JIS)级	
机器(长宽×高)	Machine dimension	L×W×H	1780×1180×3000		1700×1200×3100		2000×1300×3600		2200×1400×3900		2300×1600×4100		2800×1880×4500	
机器重量	Machine Weight	kg	6800		9800		16000		21000		25500		29000	

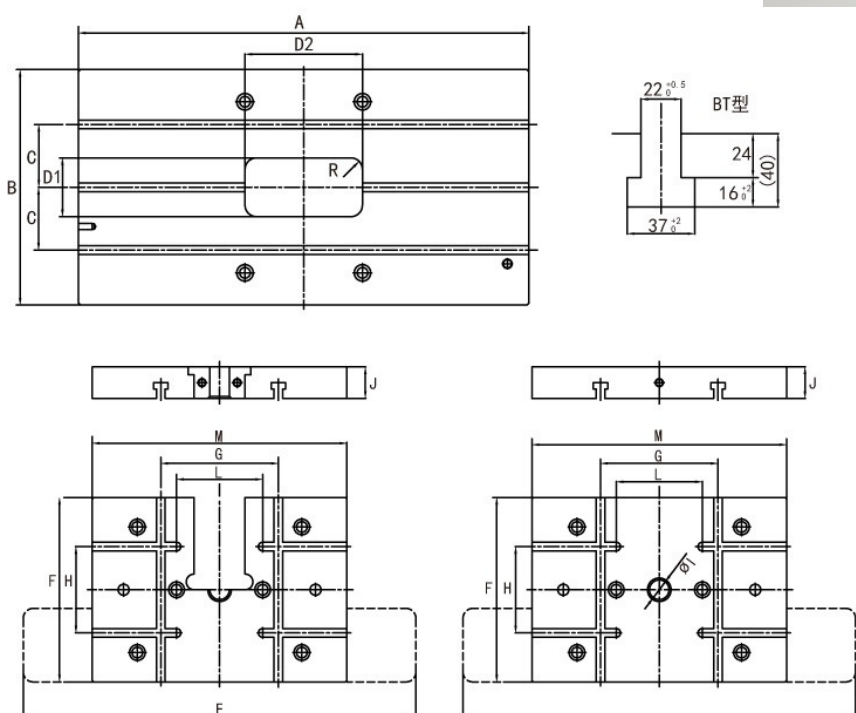

Ton\mm	C1-90	C1-130	C1-180	C1-230	C1-280	C1-340
A	1000	1150	1250	1400	1500	1500
B	550	600	800	820	820	840
C	150	160	220	280	280	280
D1	180	200	220	240	240	260
D2	360	400	440	450	460	480
F	420	470	550	630	700	700
G	300	300	300	420	420	420
H	180	220	220	300	300	300
ØI	50	50	65	65	65	65
J	70	80	90	90	90	90
K	450	490	520	640	640	640
L	220	220	200	200	200	200
E	770	910	990	1130	1130	1130
M	560	650	700	850	950	950
ØH	23	28	28	35	35	35
T型槽	BT	BT	BT	BT	BT	BT

DATA SHEETS

AVAILABLE FROM 10 TO 340 TONS

Ton\mm	C1-90	C1-130	C1-180	C1-230	C1-280	C1-340
aa	1025	1170	1270	1390	1520	1720
ac	560	720	800	810	880	970
ae	601	706	750	830	880	920
ag	825	960	1050	1170	1300	1310
ba	1585	1700	2000	2145	2245	2400
bd	280	305	405	415	415	425
hb	795	830	910	1030	1080	1110
hc	245	329	330	340	350	400
hh	830	884	979	1099	1149	1155
he	2850	3060	3580	3865	4035	4235
hf	1750	1780	1780	1780	1780	1780
hp	150	130	325	150	150	120

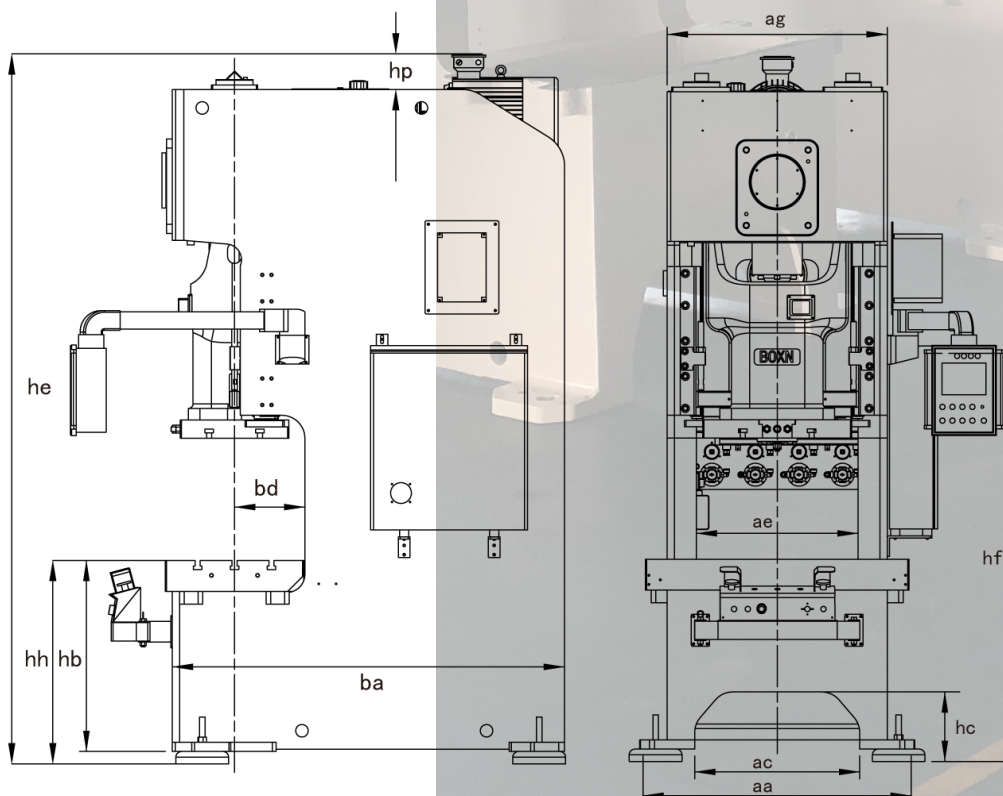

NINGBO BOXIN MACHINERY CO LTD



NingBo Boxin Presses offers a comprehensive range of mechanical presses from 10 tons to 1800 tons capacity:

- C Frame Open Fronted Single Crank Presses 10 to 340 tons
- Semi Closed H Frame Double Sided Presses 80 to 315 tons
- C Frame Open Fronted Double Crank Presses 110 to 250 tons
 - Straight Sided Single Crank Presses 200 to 600 tons
 - Straight Sided Double Crank Presses 110 to 600 tons
- Straight Sided Double Crank Power Presses 300 to 1800 tons
 - Straight Sided Eccentric Gear Presses 400 to 1800 tons

NingBo Boxin Machinery Co. Ltd is a Hong Kong owned enterprise specialised in the manufacture of high precision presses since 2006. Their manufacturing facility is located near the beautiful port of Beilun Ningbo, China

Boxin utilise the latest technology and advanced design and are a leading manufacturer and supplier of innovative, CE approved, high quality and cost effective power presses



BOXIN PRESSES

Boxin build on average 100 presses per month ensuring a continual supply and machines on short delivery timescales.

In 2012 Boxin commenced cooperation with an established leading American power press manufacturer. This collaboration has assisted Boxin with numerous ideas regarding design, accuracy standards, quality and safety. With the support of the American manufacturer Boxin has achieved 40 patents which have led to exports to the areas of Europe and North America.

Some of their major customers are TOYOTA, PANASONIC, CHNT, MAZDA, AUX, GEELY, BYD and MIDEA.

Boxin strives to continually improve their range of machines with the latest concepts, service and world-class facilities for manufacturing the highest quality machines.

ANY QUESTIONS?

TEL: 01384 565997
MAIL: SLR@RAYBOULD.COM

RAYBOULD MACHINE TOOLS LTD
MACARTHUR ROAD
CRADLEY HEATH
WEST MIDLANDS
B64 7RP
ENGLAND
WWW.RAYBOULD.COM

