

# Chemical Seal Gauge With Bolted Seal



## Model 14B

### Application:

These seals are combined for use with pressure gauges or transmitters, and are intended for use in the Chemical Industry

### Nominal Dial Sizes:

63mm, 100mm 160mm, 200mm & 250mm

### Accuracy:

1.6%

### Pressure Rating:

Up to 600 bar maximum

This instrument can be fitted with a variety of flanges or threads, different applications require different solutions, please contact us for advice

## Specifications

### Case & Bezel:

304 St. St with Bayonet locking bezel  
Weatherproof construction

### Connection & Element:

AISI 316 Stainless Steel

### Movement:

Stainless Steel

### Dial:

White Aluminium with black markings

### Pointer:

Black Oxidised Aluminium

### Window:

Glass

### Optional Specifications

PTFE lining with PTFE protected diaphragm

(pressure only) for vacuum

diaphragm is PFA coated

Perspex window

Liquid filling

Customer logo

Male threads

Electrical contacts

Remote type with St St capillary, flush

panel or surface mounting

# Chemical Seal Gauge With Bolted Seal

Type identification assistant

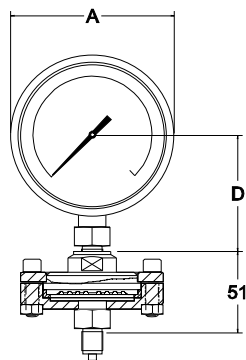
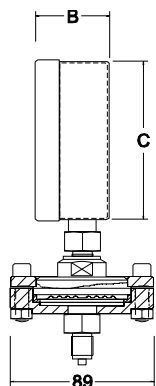

Model: 14BT10

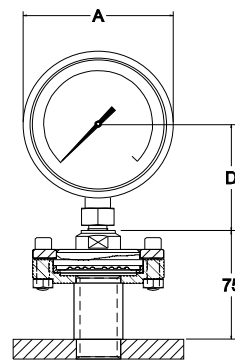
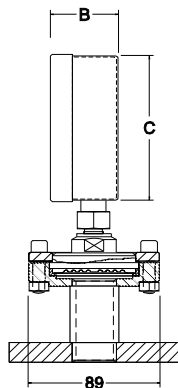

Model: 14BF10

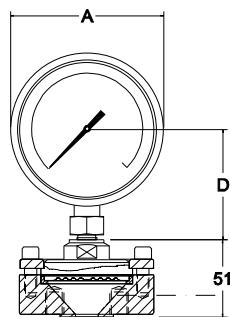
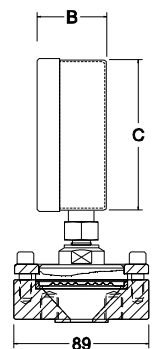

Model: 14BF20

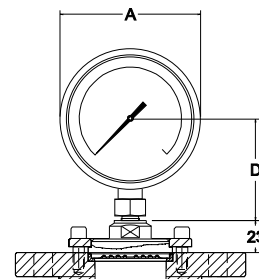
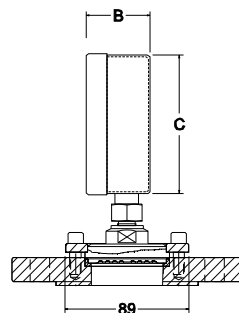

Model: 14BF30

## Ordering information

State: Pressure gauge model / Nominal size / Scale range / Size of connection / Optional extras required

## Example

14BF10/100mm/0-10bar/1"ANSI 150 flange  
100mm (4")  
Stainless Steel Case / Stainless Steel wetted parts, 0-10bar, with 1" ANSI 150 flange.

Dial Size	A	B	C	D
100mm	112	48.5	99	72
160mm	162	48.5	148	90