

# Chemical Seal Gauge with Welded Seal



## Model 14W

### Application:

These seals are combined for use with pressure gauges or transmitters, and are intended for use in the Chemical Industry

### Nominal Dial Size:

100mm & 160mm

### Accuracy:

1.6%

**Pressure Rating:** Up to 400 bar maximum

This instrument can be fitted with a variety of flanges or threads, different applications require different solutions, please contact us for advice

## Specifications

### Standard Case & Bezel:

100mm 304 St. St with Bayonet locking bezel weatherproof

**Construction:** Connection & Element: AISI 316 Stainless Steel, Monel, Tantalum, Hastelloy, Titanium

### Movement:

Stainless Steel

### Dial:

White Aluminium with black markings

### Pointer:

Black Oxidised Aluminium

### Window:

Glass

### Optional Specifications

### Gauge:

63 or 150mm case, Dual scales Glycerine Filled head

**Electrical Contacts:** Single or dual

### Process Connection:

Various male or female thread to suit customer requirements

### Filling liquid:

Special filling liquids available –To suit process conditions

# Chemical Seal Gauge with Welded Seal

Type identification assistant

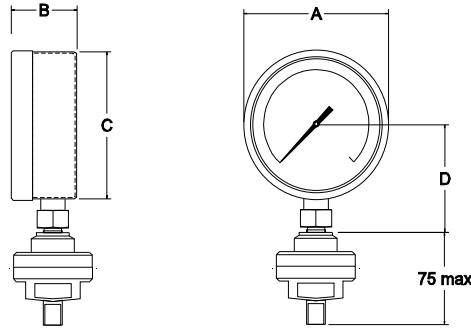

Model 14WT10

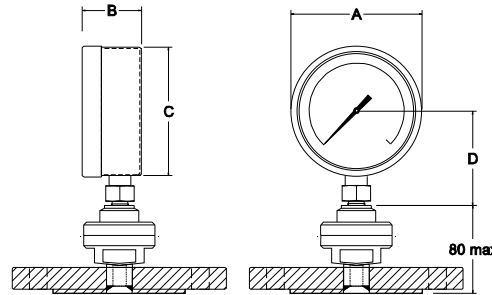

Model 14WF10

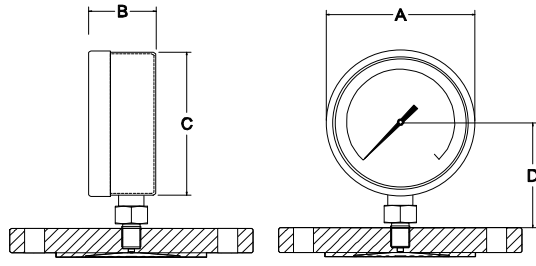

Model 14WF20

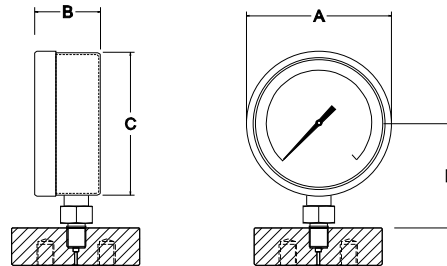

Model 14WF30

### Ordering information

State:- Pressure gauge model / Nominal size / Scale range / Size of connection / Optional extras required

### Example

14WT10/100mm/0-10bar/1/2"bsp

100mm (4")

Stainless Steel Case / Stainless Steel wetted parts, 0-10bar, with 1/2"bsp male connection.

Dial Size	A	B	C	D
63mm	70	35	60	45
100mm	112	48.5	99	72
160mm	162	48.5	148	90