



Operable Wall Systems Ltd



Operable Walls
Folding Walls
Concertina Vinyl Partitions
Frameless Glass Walls

Monowa Operable Walls provide a quality tailor-made solution to create flexible working space in offices, hotels, theatres, schools, churches, conference centres and many other buildings and environments.

Bespoke Service

Our technical staff have comprehensive training in every aspect of our product specifications and site situations which enable them to advise on individual requirements and to propose the most cost-effective solution. Detailed quotations and technical drawings are available within 24 hours.

Nationwide Coverage

Our team of Technical Representatives are strategically located to respond rapidly when advice and quotations are required. This combined with our network of trained installers enables Monowa to offer a complete sales, design and installation package covering the whole of the UK.

Service

Monowa's total commitment to customer service ensures a rapid turnaround from design to completion. Depending on size and specification, delivery can be made within a week.

Installation

Monowa's comprehensive installation package includes a full site survey, offloading and hauling of materials, secondary support framework, acoustic baffles and a full after sales service.

Quality and Value

Monowa promise to provide a quality product to your specification, on time and at a competitive price.

Operable Wall Systems



Monowa provide a quality bespoke solution to create flexible environments

Series 100 Operable Wall Systems



Monowa's top of the range Operable Walls offer endless variations of surface finish, acoustic solutions and track layout to give the end user maximum space utilisation and performance.

Construction

Panels are built with high density boards surrounded by aluminium profiles, these form the side profiles, top and bottom acoustic shoe receiver profiles and a male profile clip at the leading edge of the panel. The internal cavity is insulated using layers of sound absorbing materials as required to achieve the specified acoustic building spec.

Effortless operation with our Eazislide™ roller systems and QuickSet™ locking mechanisms



Operation

The panels are fixed in place through a simple half turn of the removable handle inserted into the profile on the panel edge which operates spring loaded seals. Magnetic seals on vertical panel profiles allow easy alignment of adjacent panels. Each seal exerts a pressure of approximately 150 kilograms per linear metre. Final sideways closure is by an internally mounted vertical nose section finished to match the panel face. All moving seals are designed to take up minor deviations in the opening.



Single Point System

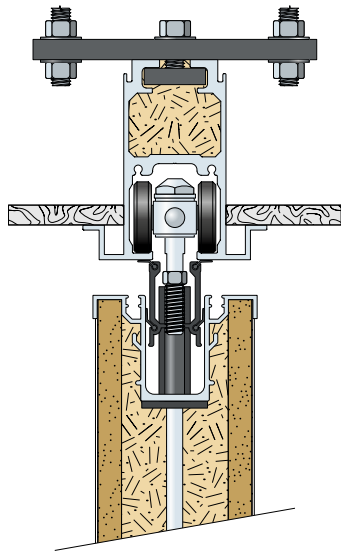

Twin Point System

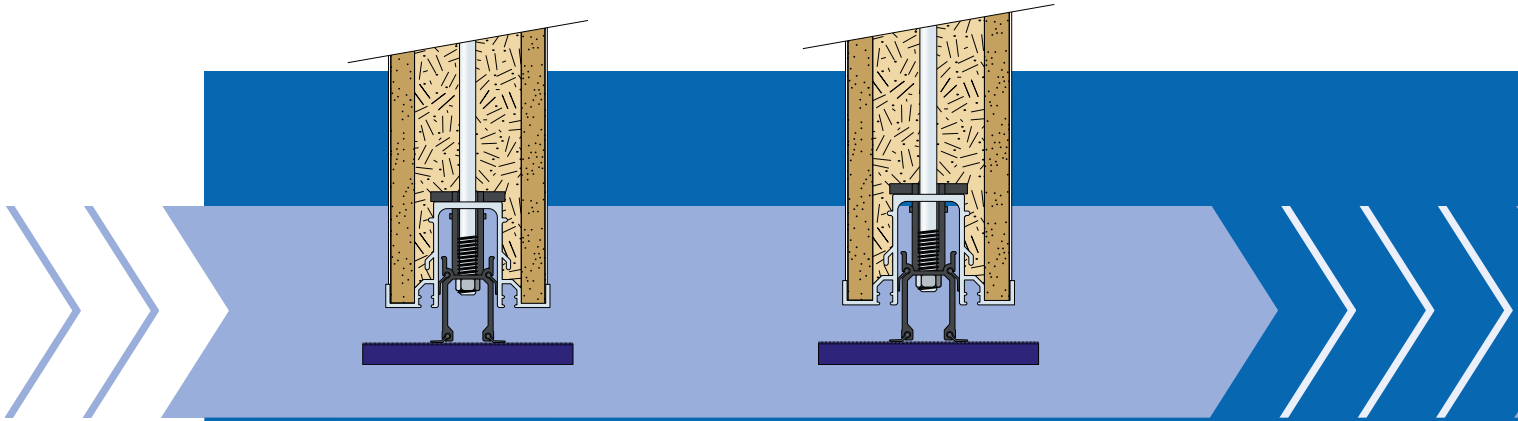
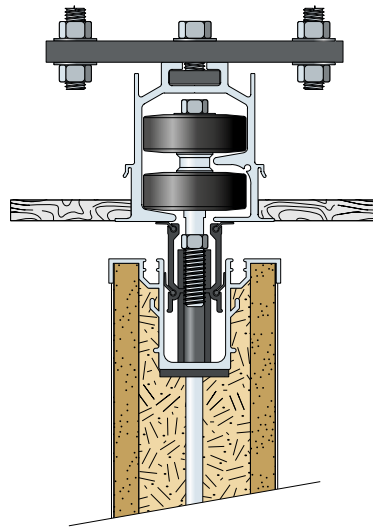

Telescopic & Wall Jamb Details

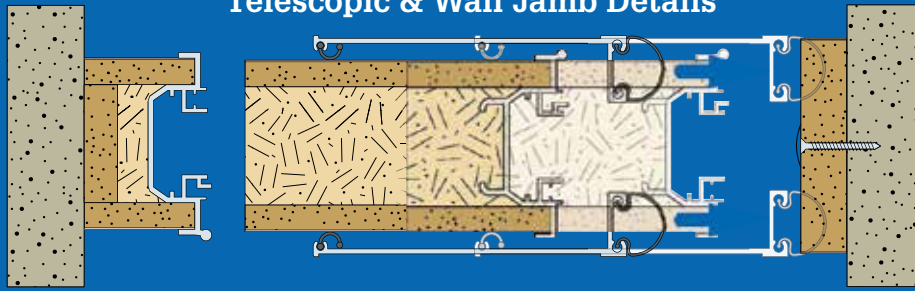

Operable Wall Configurations...

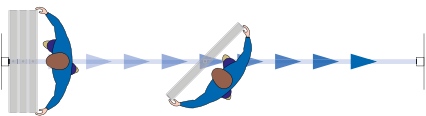

Single Point System

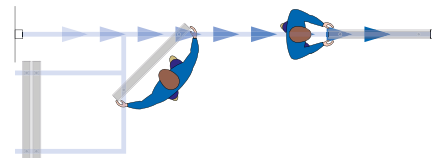

Twin Point Offset Remote Stack

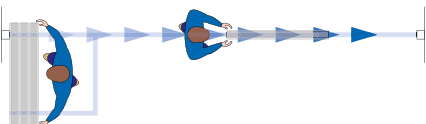

Twin Point Offset Stack

There are many two point track arrangements available according to situation and are available upon request.

Standard Colour Range



White
131/5

Almond
U73/6

Light Grey
U210/6

Beech
H800

Oak
HN334

Maple
HL18

Birch
H4404

Ash
HN225



Technical Information

Build Specification Sound Reduction Range:

Rw35dB, Rw42dB, Rw46dB, Rw50dB & Rw53dB, Rw55dB

Weight Range:

35 Kg to 70 Kg per square metre

Maximum Height:

Up to 10,000 mm

Maximum Panel Width:

Up to 1200mm Panel Width

Panel Thickness:

Varies according to sound reduction rating

Maximum Opening Width:

40,000mm. Suitable head support MUST be in place, for example steel beams or concrete soffit

Fire Ratings:

Class 'A' or 'B' Surface Spread of Flame when combined with suitable surface finishes and substrates.

Panel Finishes:

Include: Melamine, Timber, Laminate, Vinyl, Paint, Glazed or left ready for own decoration, on high density particle board.

Panel Profiles:

Satin Anodised Aluminium (SAA as standard)

Track Options:

Single Point track in aluminium EPC in RAL 9016
Twin Point track in aluminium EPC in RAL 9016, made to bespoke configurations to client spec and design.

Series 75 Folding Wall Systems



Special features include a floor supported version for situations where structural support from above is not available.

Details

Access doors can be incorporated in all partitions without additional cost. The systems offer a competitively priced solution for all design requirements.

The same professional design, supply and installation services are available together with the full range of product specifications.

Simple to operate, with an internal espagnolette locking mechanism. allowing for rapid and easy layout changes. The choice of finishes, sound reduction levels and track systems allow a complete bespoke package to be offered.



Operation

Simple to operate, with an internal espagnolette locking mechanism. allowing for rapid and easy layout changes. The choice of finishes, sound reduction levels and track systems allow a complete bespoke package to be offered.

System Details

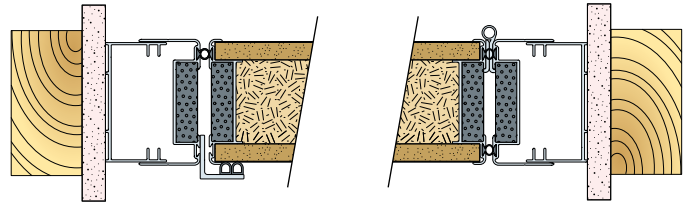
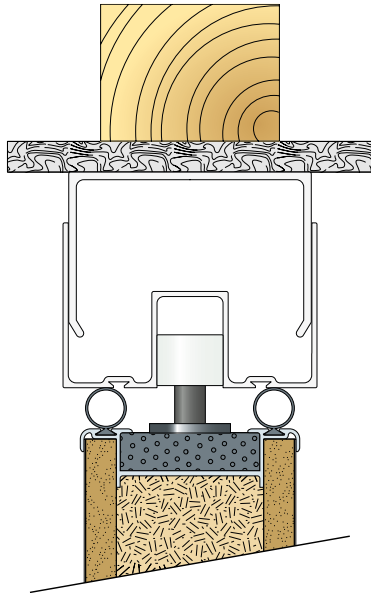

Wall Jamb Details

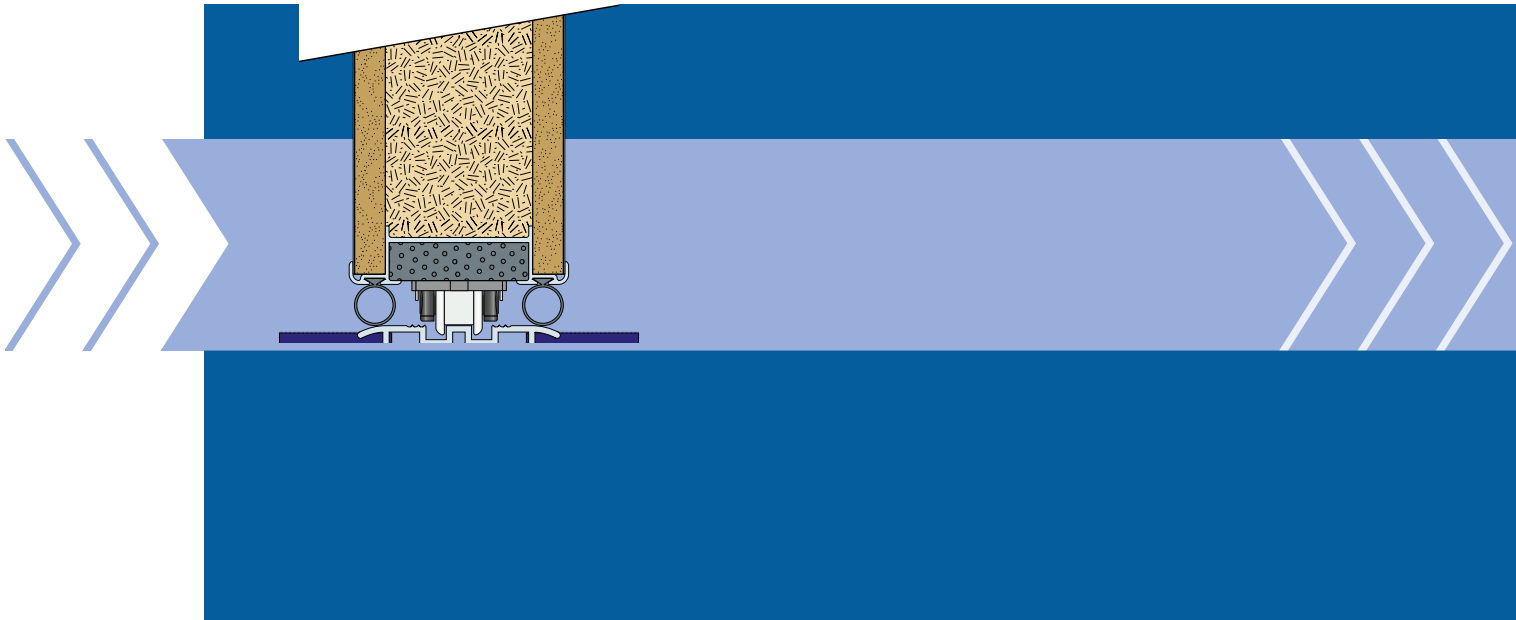

Multifold Configurations...

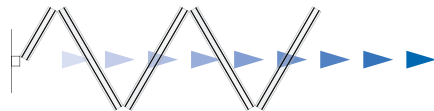

Centre fold - Single wing

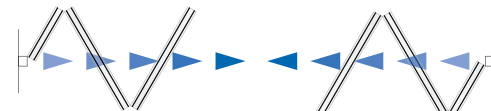

Centre fold - Bi-parting

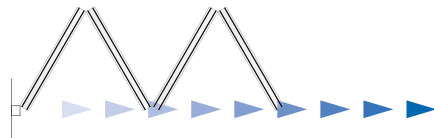

End fold - Single wing

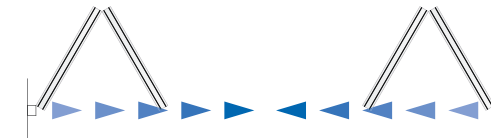

End fold - Bi-parting

Standard Colour Range



White
131/5

Almond
U73/6

Light Grey
U210/6

Beech
H800

Oak
HN334

Maple
HL18

Birch
H4404

Ash
HN225



Technical Information

Build Specification Sound Reduction Range:

Rw - 30dB, 35dB, 37dB, 42dB, 45dB & 50dB

Weight Range:

30 Kgs to 60 Kgs per square metre

Maximum Height:

Up to 3,500mm

Maximum Panel Width:

900mm up to Rw 42 dB sound reduction

850mm for Rw 45 dB sound reduction

Panel Thickness:

Varies according to sound reduction rating

Maximum Opening Width:

Varies according to panel width/weight. Wider openings may be constructed using floating units

Fire Ratings:

Class 0 Surface Spread of Flame when combined with suitable surface finishes and substrates.

Panel Finishes:

Include: Melamine, Timber, Laminate, Vinyl, Paint, Glazed or left ready for own decoration, on high density particle board.

Panel Profiles:

Satin Anodised Aluminium (SAA)

Track Options:

Bottom rolling with top guide (low profile aluminium floor track 80mm x 5m, with polymer rollers) with adjustable top guide roller track at the head, powdercoated white for maximum durability.

Series 50 Vinyl Wall Systems



Monowa Concertina Vinyl Partitions are a low cost, high quality alternative where space flexibility is required on a tight budget. Supported from above in a strong steel track, the partitions are faced in heavy duty vinyl which is very hard wearing and easily cleaned.

All Monowa Concertina Vinyl Partitions are bespoke and acoustic performance can be enhanced by the inclusion of various internal linings. Sweep strips create a continuous seal with the floor and ceiling and these are an aid to reducing heating costs in unoccupied parts of a building. Monowa offer a complete design, supply and installation service. Sound reduction range:

Rw 15dB, Rw 24dB, Rw 30dB, Rw 35dB.

Series 10 Glass Wall Systems



Glass walls are excellent aesthetic dividers, offering many applications. The elements move on a top track via two parallel ball bearing trolleys. The panels are stacked according to requirements and are locked into position with a foot pedal.

The top and bottom profiles are of natural anodised aluminium, brass or steel. The glass is hardened safety glass 10mm or hardened laminated glass 5+5mm.

The maximum height of the elements is 3600mm, maximum width is 1200mm. Weight is 25-35kg/m². The elements can also be provided with ABLOY security locks. on levels and track systems allow a complete bespoke package to be offered.

Single Point System

Twin Point System

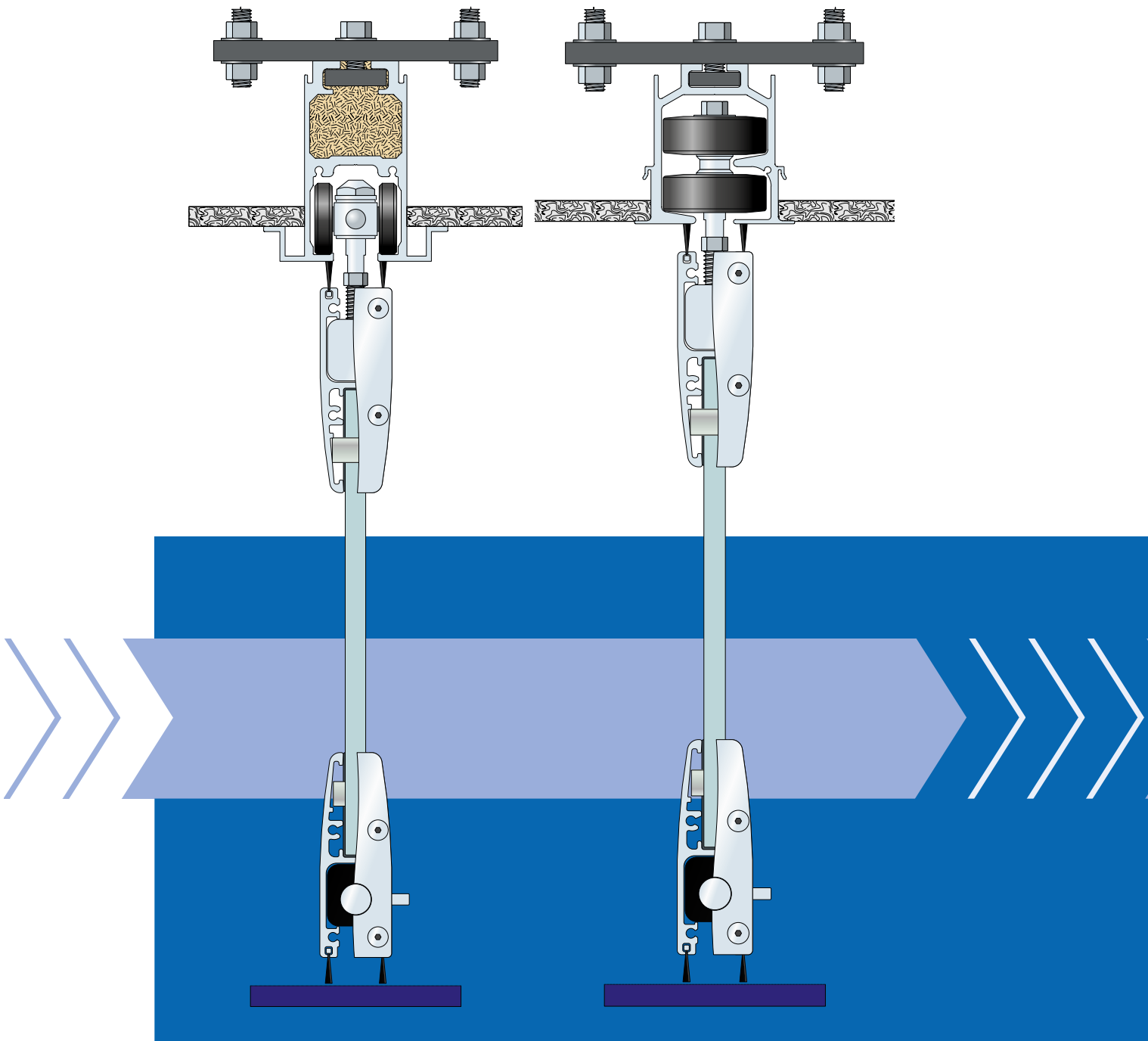

Frameless Glass Wall Configurations...

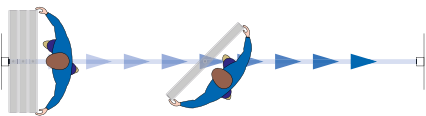

Single Point System

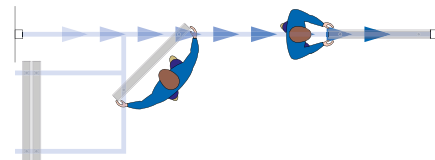

Twin Point Offset Remote Stack

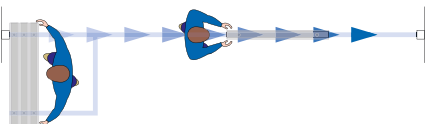

Twin Point Offset Stack

There are many two point track arrangements available according to situation and are available upon request.



Technical Information

Build Specification Sound Reduction Range:

Whilst an $R_w - 25\text{dB}$ may be achieved a 10mm glass panel will not be as effective as our other walls due to it's very nature.

Weight Range:

28 Kgs per square metre.

Maximum Height:

Up to 3,600mm.

Maximum Panel Width:

From 500mm to 1200mm.

Panel Thickness:

10mm toughened safety glass.

Maximum Panel Width:

From 500mm to 1200mm.

Fire Ratings:

N/A.

Panel Finishes:

Clear, Frosted & Tinted (manifestation to be supplied and applied by others)

Panel Profiles:

Satin Anodised Aluminium (SAA as standard).

Track Options:

Single Point track in aluminium EPC in RAL 9016.

Twin Point track in aluminium EPC in RAL 9016, made to bespoke configurations to client spec and design.



Operable Wall Systems Ltd

monowa.co.uk
sales@monowa.co.uk
01923 244 258

Monowa Operable Wall Systems Ltd. 16 Lower Plantation, Rickmansworth, Hertfordshire WD3 1PD

