

# AF 0010

## SEMI AUTOMATIC LIQUID FILLING MACHINE

The AF 0010 offers small to medium scale filling operations with an unparalleled flexibility for a wide range of products. The compact and modular design allows the AF 0010 to be operated either as a stand alone unit or automated as part of a multihead filling system at a future date.



### MACHINE FEATURES

- Electronically controlled dose and pump speed adjustment.
- Accurate dispensing with excellent repeatability.
- Complete nozzle range to suit all filling medias.
- Simple operation with fast product change over.
- Tool free removable product contact parts.
- Fill volume adjustment without the need to stop the machine.
- Constructed in compliance with FDA approved materials.
- Optional full IQ/OQ Validation support documentation.
- Small machine footprint.

# YOUR PARTNER IN PACKAGING

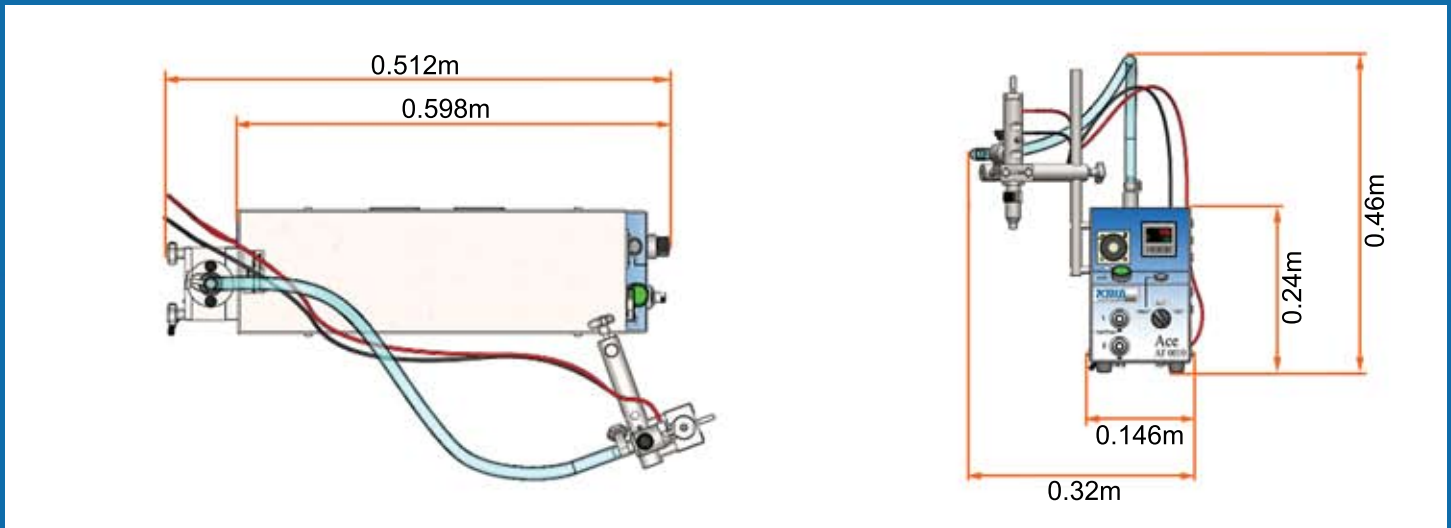

## TECHNICAL SPECIFICATION

Filling Range:	10ml - 5L
Filling Accuracy:	+/- 0.5%
Filling Speed:	Operator(s) dependent
Filling Technology:	Volumetric
Electrical Control System:	Omron
Electrical Component Build:	Telemecanique, Omron, Parvalux
Pneumatic Component Build:	SMC
Electrical Requirement:	220/240V 50 Hz 1Ph or 110/120V 60 Hz
Build Standard:	cGMP, CE marked in accordance with Machinery Directive 2006/42/EC
Nett Weight:	26Kg

## OPERATION

The AF 0010 is operated using a control panel where the dose and product flow rate can be adjusted along with single shot and dual speed filling modes. When filling begins liquid is pumped under pressure past a non-return valve and out of the dispensing nozzle.

Filling is a pre determined value. When the correct number of pulses given by the pump drive is reached the pump head stops and the filling cycle is complete. The operator then manually changes the bottles over and initiates the next filling cycle using either an optional foot switch or a preset delay operation.