



CMR Electrical Ltd
Bolton House
Five Chimneys Lane
Hadlow Down
East Sussex
TN22 4DX
Tel: 01825 733600

Single and Two Zone Over temperature alarm type RTA



The RTA2 has been designed to monitor critical areas for high temperature via remote thermostats. Any number of thermostats can be connected to the control unit to give a common room over temperature alarm (RTA1) or two zones of temperature alarm (RTA2).

Complete with an audible warning device, mute push button, flashing 8mm red alarm lamp and 8mm Control live green lamp, on units fitted with the sensor monitoring circuit additional 8mm red (fault) /green (Normal) lamps are fitted to each zone.

Once an over temperature alarm has been raised, the RTA red "Alarm" lamp will start to flash and the audible warning device will start. The unit will remain in this condition even if the room temperature returns back to normal. Only muting the alarm will stop the sounder and de-latch the alarm. If the room temperature has returned to normal before pressing the "Mute Alarm" button the alarm lamp will extinguish indicating that the temperature is normal. However if the room is still over temperature only the audible warning will stop leaving the lamp permanently on. Only when the room has returned back to its normal temperature will the lamp extinguish.

All RTA units have a common alarm set of volt free contacts output for onward signalling to Building Management Systems, telephone dialler or control systems.

Single or two Zone Alarm Unit

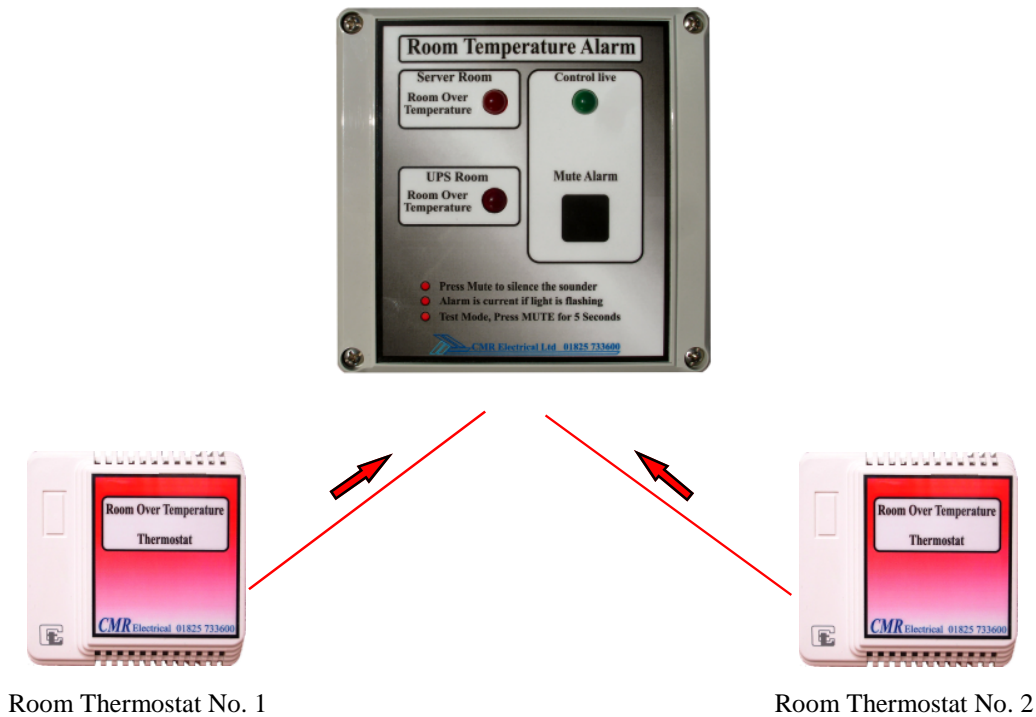

Features

- Large 8mm indication LED lamps for ease of Alarm identification from a distance
- On board audible warning device to alert local operators of a problem
- Alarms latched until Mute operated to give indication of transient Alarms
- Individual zone alarm relays to onward signal to a BMS
- Lamps, relay and Horn test Facility to ensure that the unit is working correctly
- Small size foot print, wall or surface mounted

Specification

Housing type	ABS Plastic
Mounting	Wall, flush or surface
Size	122mm wide x 120mm high x 58mm deep
Colour	Light grey
Input power	50 Hz single phase 230VAC +/- 10%
Burden	< 3VA
Power termination	Internal 3 way terminal block
Voltage to Thermostats	12VDC
Connections to thermostat	Internal terminal block
Access	Top, bottom or back
Output contacts	1 x Volt Free 3 amp changeover