

Kingsclere

INDUSTRIES

Reception



Car Park



Deliveries



POST MOUNTED SIGN SYSTEMS

INTRODUCTION

FIRST IMPRESSIONS

When attracting new custom, your Company sign is often the primary thing to be noticed, so first impressions are paramount. Location, design, colour and layout will all enhance your sign and promote the best impression of your company.

We offer the most versatile combinations of aluminium signage which, combined with our extensive range of vinyl coverings, paint finishes or digital prints, will allow the flexibility you need. All delivered with a speed, quality and efficiency to ensure your satisfaction.



HOW TO CHOOSE YOUR POST MOUNTED SIGN

Use these sign ideas to help create the perfect post mounted sign for your needs. All our systems are made to order, offering you choice on every aspect. For wall mounted and other signage needs consult our alternative brochures.

ASK FOR HELP

Your Sign Advisor will be able to assist you in compiling measurements and options to suit your needs. They will be able to tailor your requirements to accommodate your budget, style and graphics.

If you haven't seen exactly what you require, we can also make a bespoke system to match your needs. Talk it through with your Sign Advisor and ask for advice.



OUR ASSURANCES

- We are experienced in creating signs for a multitude of locations, ranging from the smallest garden fence to multi-national corporate headquarters.
- We offer fitting advice and stock all fixings to suit, to ensure you have a reliable and comprehensive sign arrangement.
- We comply with road traffic regulations on wind tolerances for all our post mounted signs.
- Our 3mm aluminium is completely recyclable and the little wastage we have is all reprocessed at government approved sites.

For a professional approach to your sign needs, consult a professional team.

Use these sign ideas in conjunction with your Sign Advisor for successful results.

RECTANGULAR	CIRCLE	QUADRANT	CENTRAL	HALF CIRCLE	TRIANGLE	WHITE	USE COLOUR
SHARP	SMOOTH	HALF SQUARE	SQUARE	DIAGONAL	ALWAYS	CH	NET
SHARP	SMOOTH	HALF SQUARE	SQUARE	DIAGONAL	ALWAYS	CH	NET
SHARP	SMOOTH	HALF SQUARE	SQUARE	DIAGONAL	ALWAYS	CH	NET

PRODUCT OVERVIEW

	PLATE & POST 3mm aluminium plate mounted in front of posts
	PLAZA 3mm aluminium folded trays between posts
	AS760 & AS500 3mm aluminium plate between posts
	MODULAR A robust post and plank system
	CORNICHE 3mm aluminium plate attached to front of posts with stand-off connectors
	HOOPED Formed tubes with aluminium plate or trays between
	FINGERPOSTS 3mm aluminium and 16mm plank pointer arms
	INFORMATION & EXTRAS Mounting options, colour charts, Road signs, Fixings and Posts

KEY

PLATE & POST

3mm Aluminium plate mounted in front of posts

PLATE

Made from 3mm aluminium sheet

SIZE

Larger sizes achieved by using multiple panels
Maximum plate size in one piece 3000mm x 1500mm, portrait or landscape - or any size in between
There is no minimum panel size

COLOUR

Covered with one of 24 vinyl laminates, or your supplied laminate
Powder coated in one of 107 stock RAL or BS colours or in your client's corporate colour
Special marble or wood effect paint finishes
Mill finish for you to paint
All plates are powder coated grey to the reverse to prevent oxidation

SHAPES

Standard shapes available
Custom shaped to your files
Six standard radius corners

POSTS

There are two aluminium post profiles available to mount the panels on, depending upon your application

SIZE

The maximum post length is 6000mm from stock
Up to 10000mm special order (Steel only)

COLOUR

Grey, white or mill finish posts available from stock
Powder coated to one of 107 stock RAL or BS colours

OPTIONS

Capped posts, coloured caps to match paint colours
Angled weld feature
Five finials for round or square posts
Base embellisher

MOUNTING OPTIONS

Can be single plates or double sided plates on posts
Can be mounted in "V" formation at 90°

All plate and post signs are delivered ready to assemble. All you need is a 13mm spanner

Next day despatch in mill or standard laminated finishes

POSTS & FINIALS		FINISHES				OTHER	
<input type="checkbox"/>	SQUARE	<input type="checkbox"/>	CIRCLE	<input type="checkbox"/>	WHITE	<input type="checkbox"/>	ONE COLOUR
<input type="checkbox"/>	DIAGONAL	<input type="checkbox"/>	DIAGONAL	<input type="checkbox"/>	<input type="checkbox"/>	<input type="checkbox"/>	TWO COLOURS
<input type="checkbox"/>	ROUND	<input type="checkbox"/>	ELLIPSE	<input type="checkbox"/>	<input type="checkbox"/>	<input type="checkbox"/>	TEXTURED
<input type="checkbox"/>	WALL SQUARE	<input type="checkbox"/>	DIAGONAL	<input type="checkbox"/>	<input type="checkbox"/>	<input type="checkbox"/>	POWDER
<input type="checkbox"/>	WALL ROUND	<input type="checkbox"/>	DIAGONAL	<input type="checkbox"/>	<input type="checkbox"/>	<input type="checkbox"/>	MILL FINISH
<input type="checkbox"/>	WALL SQUARE	<input type="checkbox"/>	DIAGONAL	<input type="checkbox"/>	<input type="checkbox"/>	<input type="checkbox"/>	LEAD
<input type="checkbox"/>	WALL ROUND	<input type="checkbox"/>	ELLIPSE	<input type="checkbox"/>	<input type="checkbox"/>	<input type="checkbox"/>	WALL
<input type="checkbox"/>	WALL SQUARE	<input type="checkbox"/>	DIAGONAL	<input type="checkbox"/>	<input type="checkbox"/>	<input type="checkbox"/>	CHROME
<input type="checkbox"/>	WALL ROUND	<input type="checkbox"/>	ELLIPSE	<input type="checkbox"/>	<input type="checkbox"/>	<input type="checkbox"/>	WOOD
<input type="checkbox"/>	WALL SQUARE	<input type="checkbox"/>	DIAGONAL	<input type="checkbox"/>	<input type="checkbox"/>	<input type="checkbox"/>	WALL
<input type="checkbox"/>	WALL ROUND	<input type="checkbox"/>	ELLIPSE	<input type="checkbox"/>	<input type="checkbox"/>	<input type="checkbox"/>	WALL

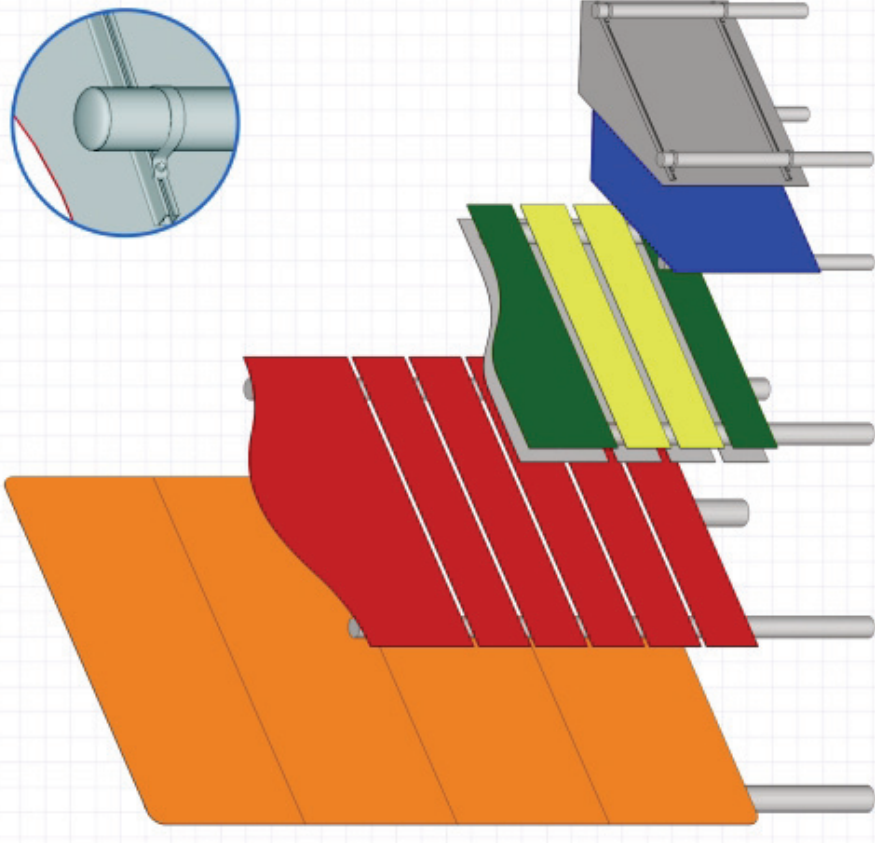

PLAZA

PLAZA

3mm Aluminium foiled tray between posts

TRAYS

Made from 3mm aluminium sheet

SIZE

Minimum tray size 120mm x 120mm

Maximum tray size 2950mm x 1425mm, portrait or landscape in one section

Larger sizes achieved by using multiple trays

COLOUR

Powder coated in one of 107 stock RAL or BS colours

in your client's corporate colour

Special marble or wood effect paint finishes

Mill finish for you to paint

SHAPES

Standard shapes available

Custom shaped to your files

Raised add-ons in matching or contrasting colours

OPTIONS

Double sided using an insert backing tray

Fret cut with letters or shapes

Available with LED illumination

POSTS

There are five aluminium post profiles available to mount the trays on, depending upon your application

SIZE

The maximum post length is 6000mm

COLOUR

Grey, white or mill finish posts available from stock

Powder coated to one of 107 stock RAL or BS colours to the same

specifications as the trays, or in a contrasting colour

OPTIONS

Capped posts, coloured caps to match paint colours

Angled weld feature

Five finials for round or square posts

Base embellisher

MOUNTING OPTIONS

Can be single or double sided in between posts

Can be mounted in 'V' formation, triangular or square configuration

All trays and posts are delivered pre-drilled to suit panel configuration

All you need to assemble is a 13mm spanner

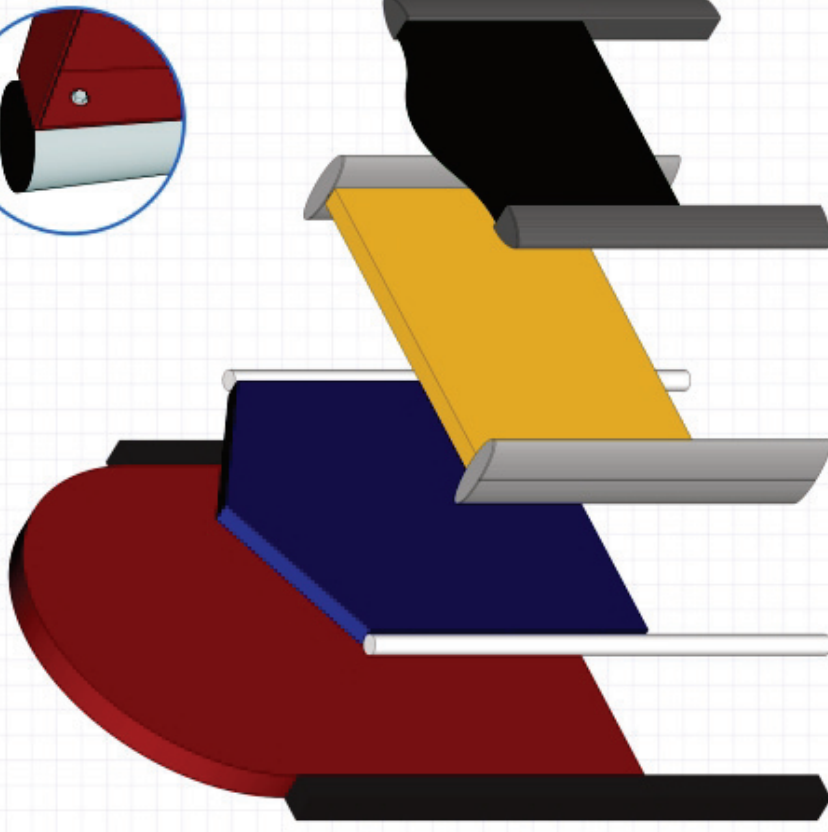
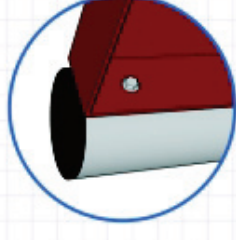

AS760 & AS500

3mm Aluminium plate between posts. A low cost double sided sign system

PLATES

Made from 3mm aluminium sheet with post sockets at the ends

SIZE

There is no minimum sheet size
Maximum plate size 3050mm x 1200mm portrait - or any size in between

COLOUR

Powder coated in one of 107 stock RAL or BS colours or in your client's corporate colour
Special marble or wood effect paint finishes
Mill finish for you to paint

SHAPES

Standard shapes available
Custom shaped to your files

POSTS

There is a choice of 50mm or 76mm round aluminium posts available to mount the sign panels

SIZE

The maximum post length is 6000mm

COLOUR

Grey, white or mill finish posts available from stock
Powder coated to one of 107 stock RAL or BS colours to the same specifications as the panels, or in a contrasting colour

OPTIONS

Capped posts, coloured caps to match paint colours
Angled weld feature
Four finials for round posts
Base embellisher

All panels and posts are delivered pre-drilled to suit panel configuration
All you need to assemble is a 16mm hex key

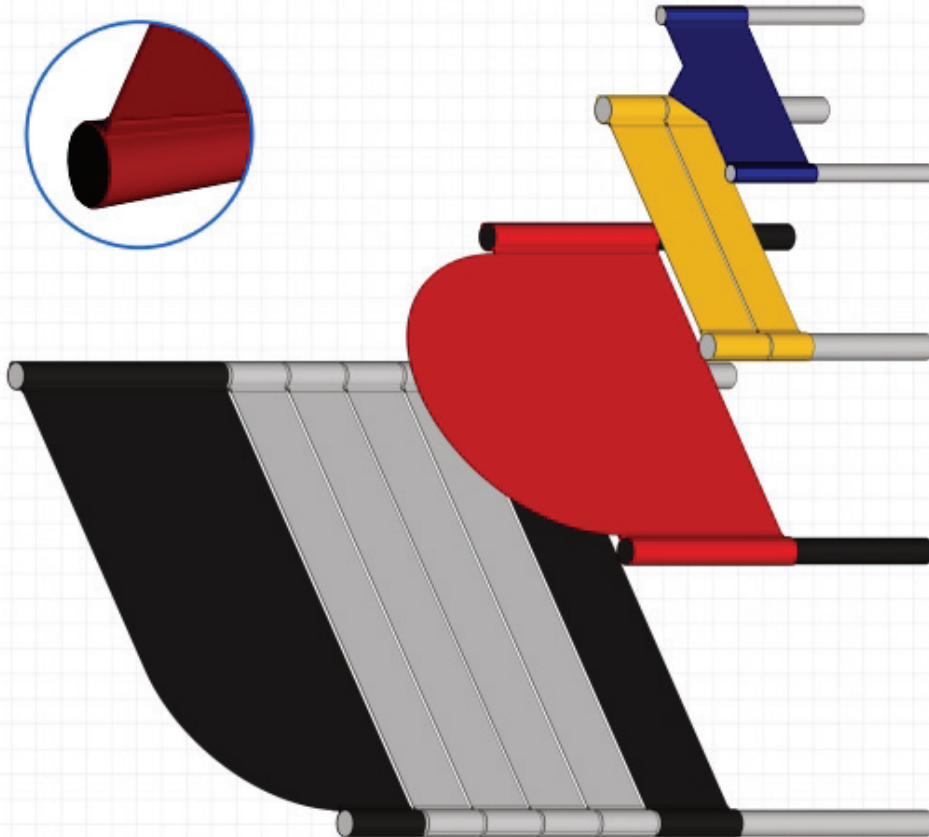

POSTS & FINIALS

<input checked="" type="checkbox"/> SQUARE	<input checked="" type="checkbox"/> CIRCLE	<input checked="" type="checkbox"/> CHAMFANT	<input checked="" type="checkbox"/> CATHEDRAL	<input checked="" type="checkbox"/> ELIPSE	<input checked="" type="checkbox"/> KEVIN'S HANDB	<input checked="" type="checkbox"/> MOUNTAIN	<input checked="" type="checkbox"/> ALPINE	<input checked="" type="checkbox"/> CORNER	<input checked="" type="checkbox"/> RAIL SQUARE	<input checked="" type="checkbox"/> RAIL ROUND	<input checked="" type="checkbox"/> BOTHC
<input checked="" type="checkbox"/> SQUARE	<input checked="" type="checkbox"/> CIRCLE	<input checked="" type="checkbox"/> CHAMFANT	<input checked="" type="checkbox"/> CATHEDRAL	<input checked="" type="checkbox"/> ELIPSE	<input checked="" type="checkbox"/> KEVIN'S HANDB	<input checked="" type="checkbox"/> MOUNTAIN	<input checked="" type="checkbox"/> ALPINE	<input checked="" type="checkbox"/> CORNER	<input checked="" type="checkbox"/> RAIL SQUARE	<input checked="" type="checkbox"/> RAIL ROUND	<input checked="" type="checkbox"/> BOTHC

FINISHES

<input checked="" type="checkbox"/> WHITE	<input checked="" type="checkbox"/> ONE COLOUR	<input checked="" type="checkbox"/> TWO COLOURS	<input checked="" type="checkbox"/> CHROME	<input checked="" type="checkbox"/> WET	<input checked="" type="checkbox"/> MILL FINISH	<input checked="" type="checkbox"/> POWDER	<input checked="" type="checkbox"/> TEXTURED	<input checked="" type="checkbox"/> VINYL	<input checked="" type="checkbox"/> LED
<input checked="" type="checkbox"/> WHITE	<input checked="" type="checkbox"/> ONE COLOUR	<input checked="" type="checkbox"/> TWO COLOURS	<input checked="" type="checkbox"/> CHROME	<input checked="" type="checkbox"/> WET	<input checked="" type="checkbox"/> MILL FINISH	<input checked="" type="checkbox"/> POWDER	<input checked="" type="checkbox"/> TEXTURED	<input checked="" type="checkbox"/> VINYL	<input checked="" type="checkbox"/> LED

Height of individual sign panel	Max recommended width
Less than 150mm	Not recommended
150mm to 200mm	600mm
201mm to 300mm	890mm
301mm to 3050mm	1196mm



MODULAR

MODULAR
A robust post and plank sign system

PLANKS
Aluminium extrusions of 16mm depth

SIZE
Planks are available in four heights: 50mm, 100mm, 165mm and 300mm
Suitable for widths of up to 2000mm wide
Larger sizes, up to 3000mm high, can be achieved by using multiple planks

COLOUR
Powder coated white from stock
Powder coated in one of 107 stock RAL or BS colours or in your client's corporate colour
Special marble or wood effect paint finishes
Mill finish for you to paint

POSTS
There are two aluminium post profiles available to mount the planks in

SIZE
The maximum post length is 5700mm

COLOUR
Posts are available painted to the same specifications as the planks, or in a contrasting colour

OPTIONS
White or black plastic caps as standard
Aluminium caps powder coated to match post colour
Five finials for round or square posts
Base embellisher

MOUNTING OPTIONS
Modular is a very flexible sign system
The four plank options can be configured in any combination with any size gaps between the planks for mounting

All posts are delivered pre-drilled to suit configuration. All you need to assemble is a cross-head screwdriver.

POSTS & FINIALS		FINISHES				CAPS			

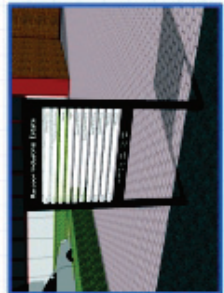
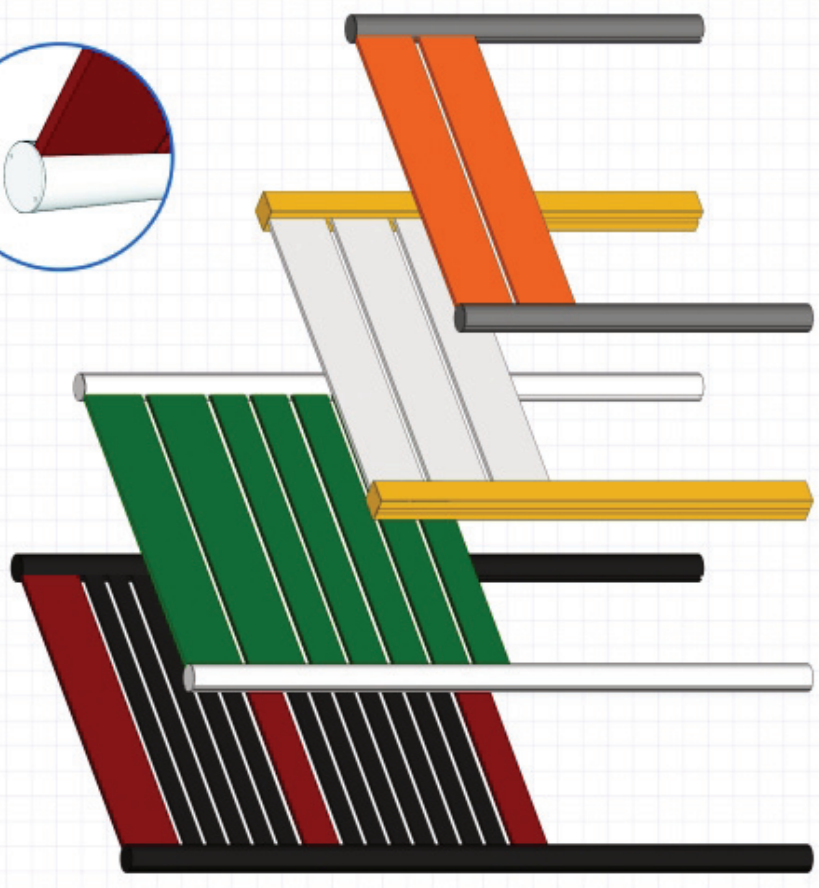
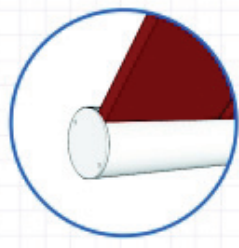

CORNICHE

CORNICHE

3mm Aluminium plate attached to posts with stand-off connectors

PLATES

Made from 3mm aluminium sheet

SIZE

There is no minimum sheet size
Maximum plate size 3050mm x 1200mm portrait - or any size in between

COLOUR

Covered with one of 24 vinyl laminates, or your supplied laminate
Powder coated in one of 107 stock RAL or BS colours or in your client's corporate colour
Special marble or wood effect paint finishes
Mill finish for you to paint
All plates are powder coated grey to the reverse to prevent oxidation

SHAPES

Standard shapes available
Custom shaped to your files

POSTS

There is a choice of any post section for these signs, mounted using stand-off connectors

SIZE

The maximum post length is 6000mm
Panel restrictions as AS760 chart on page 8

COLOUR

Grey, white or mill finish posts available from stock
Powder coated to one of 107 stock RAL or BS colours to the same specifications as the panels, or in a contrasting colour

OPTIONS

Capped posts, coloured caps to match paint colours
Angled weld feature
Finals for square and round posts
Base embellisher
Stand-off connectors are available in 3 stock finishes; Mill, Silver anodised or black anodised, they can also be powder coated to any RAL or BS colour

All panels and posts are delivered pre-drilled to suit panel configuration.
All you need to assemble is a cross-headed screwdriver

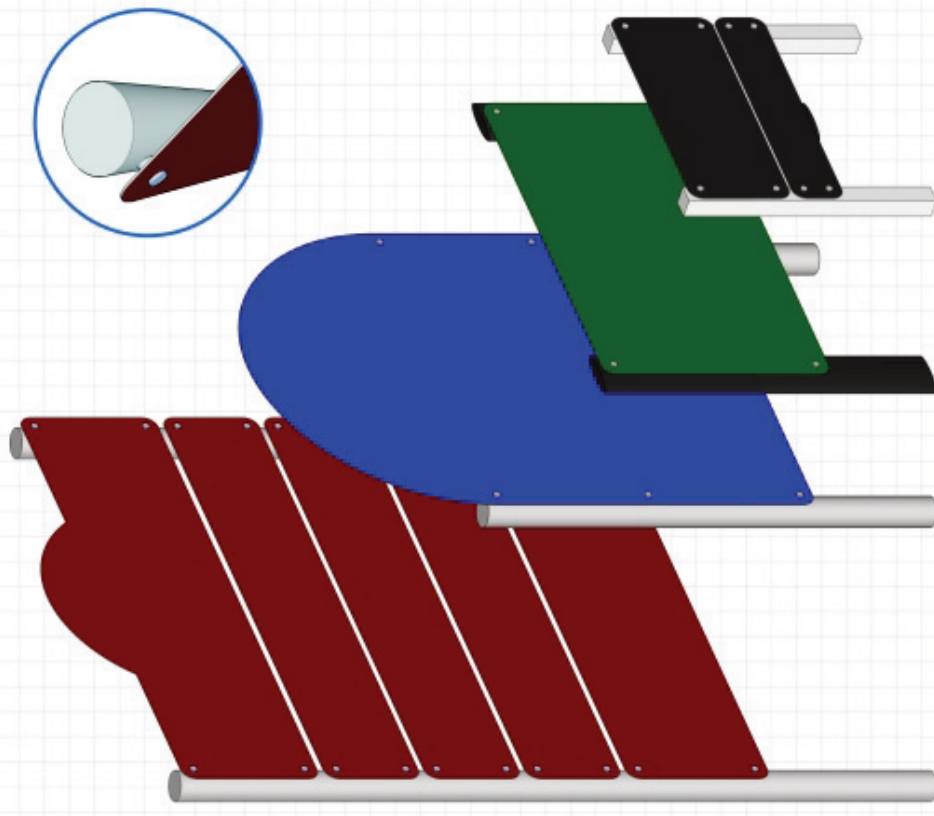

FINALS			FINISHES		
	SQUARE	<input type="checkbox"/>		WHITE	<input type="checkbox"/>
	CIRCLE	<input type="checkbox"/>		MILL FINISH	<input type="checkbox"/>
	BALL ROUND	<input type="checkbox"/>		POWDER	<input type="checkbox"/>
	BALL SQUARE	<input type="checkbox"/>		TEXTURED	<input type="checkbox"/>
	DOTS	<input type="checkbox"/>		CH	<input type="checkbox"/>
	EMBELLISHER	<input type="checkbox"/>		WELDED	<input type="checkbox"/>
	ALPINE	<input type="checkbox"/>		LED	<input checked="" type="checkbox"/>
	CONCAVE	<input type="checkbox"/>		MILL FINISH	<input type="checkbox"/>
	CONVEX	<input type="checkbox"/>		POWDER	<input type="checkbox"/>
	CHARCUT	<input type="checkbox"/>		TEXTURED	<input type="checkbox"/>
	EMBELLISHER	<input type="checkbox"/>		CH	<input type="checkbox"/>
	ALPINE	<input type="checkbox"/>		WELDED	<input type="checkbox"/>
	CONCAVE	<input type="checkbox"/>		LED	<input checked="" type="checkbox"/>
	CONVEX	<input type="checkbox"/>			

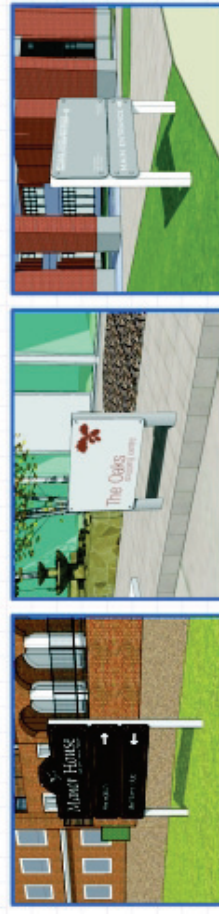

HOOPED

HOOPED SIGNS

Formed tube signs

PLANKS OR TRAYS

Aluminium plates with folded lugs or trays with nut inserts

SIZE

Maximum sheet size is 3050 x 1525mm for flat plate
Maximum tray size is 2950 x 1425 with 50mm returns

COLOUR

Powder coated in one of 107 stock RAL or BS colours or in your client's corporate colour
Special marble or wood effect paint finishes
Mill finish for you to paint

POSTS

Hooped signs can only use 50 or 76mm round posts

SIZE

The maximum post length is 6000mm
Panel restriction for flat panel as AS760 chart on page 8

COLOUR

Posts are available painted to the same specifications as the planks, or in a contrasting colour

OPTIONS

Base embellishers available for 76mm option

MOUNTING OPTIONS

Folded lugs are used to secure flat plate to the formed tube
Holes are drilled into the returns of the tray and secured using nut-inserts on the formed tube.
All you need to assemble is a 13mm spanner



POSTS & FINALS		FINISHES	
<input checked="" type="checkbox"/> SQUARE	<input checked="" type="checkbox"/> CIRCLE	<input checked="" type="checkbox"/> WHITE	<input checked="" type="checkbox"/> MILL FINISH
<input checked="" type="checkbox"/> DIAGONAL	<input checked="" type="checkbox"/> QUADRANT	<input checked="" type="checkbox"/> ONE COLOUR	<input checked="" type="checkbox"/> POWDER
<input checked="" type="checkbox"/> CUBITERNAL	<input checked="" type="checkbox"/> CUBITERNAL	<input checked="" type="checkbox"/> TWO COLOURS	<input checked="" type="checkbox"/> TEXTURED
<input checked="" type="checkbox"/> ELLIPSE	<input checked="" type="checkbox"/> OVALS & ARCS	<input checked="" type="checkbox"/> DIE COLOUR	<input checked="" type="checkbox"/> WAVE
<input checked="" type="checkbox"/> ALPINE	<input checked="" type="checkbox"/> EMBELLISHER	<input checked="" type="checkbox"/> DIBRANE	<input checked="" type="checkbox"/> LED
<input checked="" type="checkbox"/> DOMED	<input checked="" type="checkbox"/> SQUARE	<input checked="" type="checkbox"/> CH	
<input checked="" type="checkbox"/> SQUARE	<input checked="" type="checkbox"/> SQUARE	<input checked="" type="checkbox"/> WET	



AS760 & AS980 FINGERPOSTS

Directional signage available in two looks

PLANKS

16mm aluminium extrusion on AS980 or 3mm aluminium plate on AS760

SIZE

Extrusion is only available in 165mm on the AS980 fingerpost
Plate on the AS760 option can be any size

COLOUR

AS760 can be vinyl faced
Powder coated in one of 107 stock RAL or BS colours or
in your client's corporate colour
Special marble or wood effect paint finishes
Mill finish for you to paint
AS980 comes mill finished or powder coated

POSTS

Both options use 76mm posts

SIZE

The maximum post length is 6000mm

COLOUR

Posts are available painted to the same specifications as the finger arms,
or in a contrasting colour

OPTIONS

Coloured internal post caps are available
Five finials and base embellisher

MOUNTING OPTIONS

AS980 extrusion allows for up to three fingers per level
AS760 allows only one finger per level
All you need to assemble is a 16mm hex key

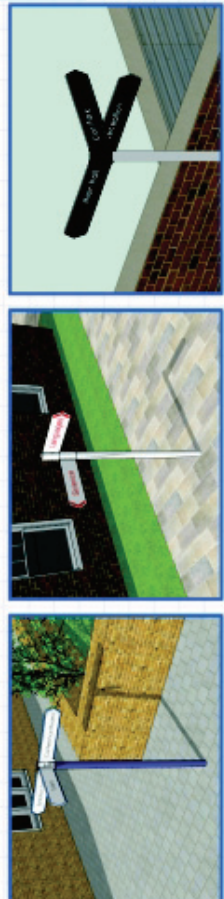
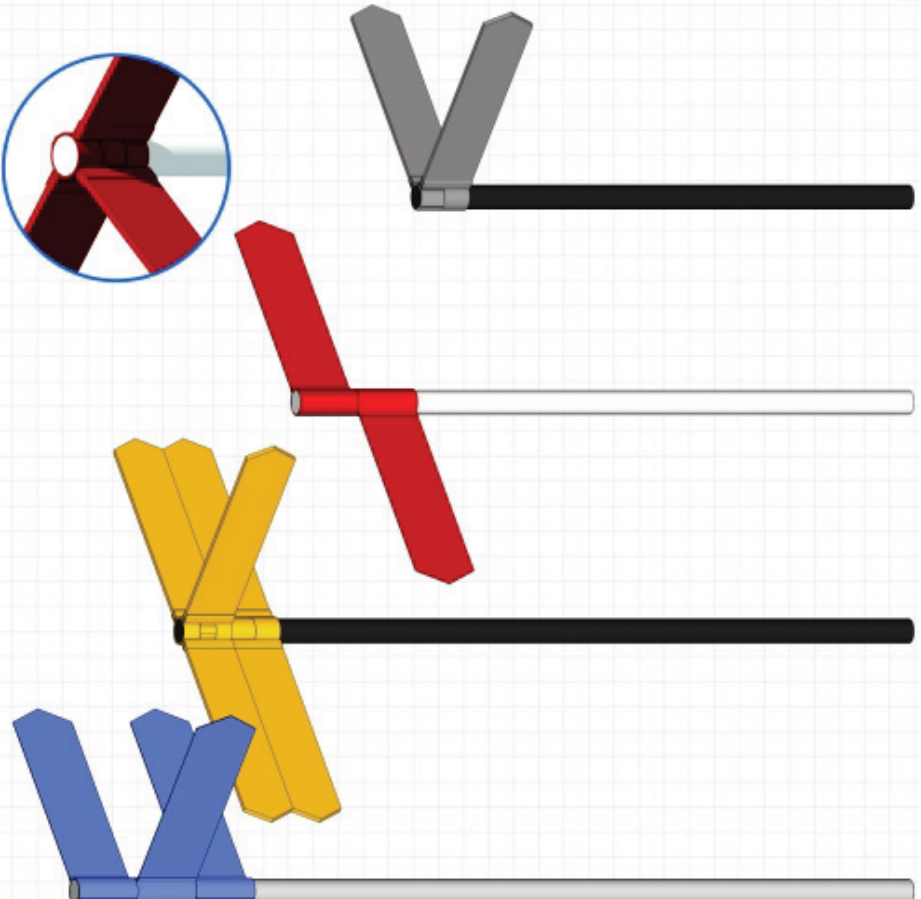

POSTS & FINIALS		FINISHES	
<input checked="" type="checkbox"/> SQUARE	<input checked="" type="checkbox"/> FINIAL	<input checked="" type="checkbox"/> WHITE	<input checked="" type="checkbox"/> MILL FINISH
<input checked="" type="checkbox"/> ROUND	<input checked="" type="checkbox"/> FINIAL	<input checked="" type="checkbox"/> ONE COLOUR	<input checked="" type="checkbox"/> POWDER
<input checked="" type="checkbox"/> SQUARE	<input checked="" type="checkbox"/> FINIAL	<input checked="" type="checkbox"/> TWO COLOURS	<input checked="" type="checkbox"/> TEXTURED
<input checked="" type="checkbox"/> ROUND	<input checked="" type="checkbox"/> FINIAL	<input checked="" type="checkbox"/> CHROME	<input checked="" type="checkbox"/> VENEER
<input checked="" type="checkbox"/> SQUARE	<input checked="" type="checkbox"/> FINIAL	<input checked="" type="checkbox"/> WET	<input checked="" type="checkbox"/> LED

POST MOUNTED SIGNS MOUNTING OPTIONS

Ways to mount post mounted signs

FRONT FACING

Standard front facing signs. All of our sign systems are suitable for this.



DOUBLE SIDED

Two-sided sign options, suitable for text or graphics to be viewed on both sides.

Systems suitable for this are: Plaza, AS760, AS500, Plate & Post, Modular & Corniche.



V-MOUNTING

Signs mounted in a V formation, so text and graphics are viewable from multiple angles.

Sign systems for this are: Plaza, Plate & Post and Corniche.



INLINE MOUNTING

Inline mounting is where you have multiple panels, spaced by posts all inline with each other to form a long sign with multiple supports.

Our Plaza and Plate & Post systems are suitable for this.



OTHER MOUNTING OPTIONS

Other mounting options for plaza, Plate and Post and Corniche.

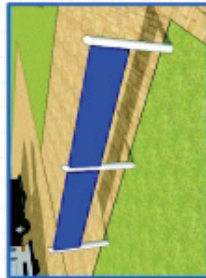
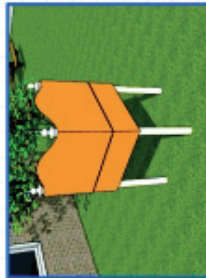

A GUIDE TO VIEWING DISTANCES

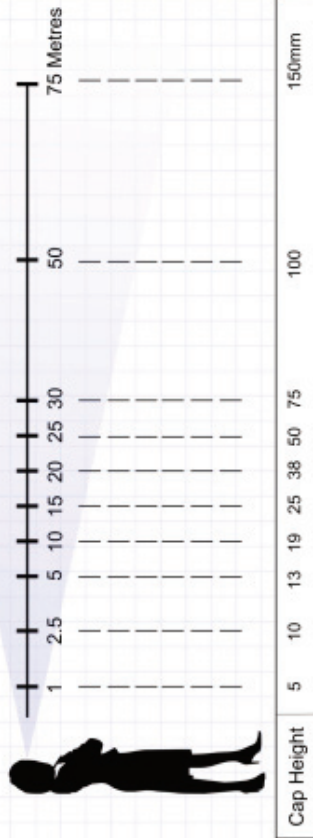

CONCRETE PAD FOUNDATION & POST PLANTING DEPTH GUIDE

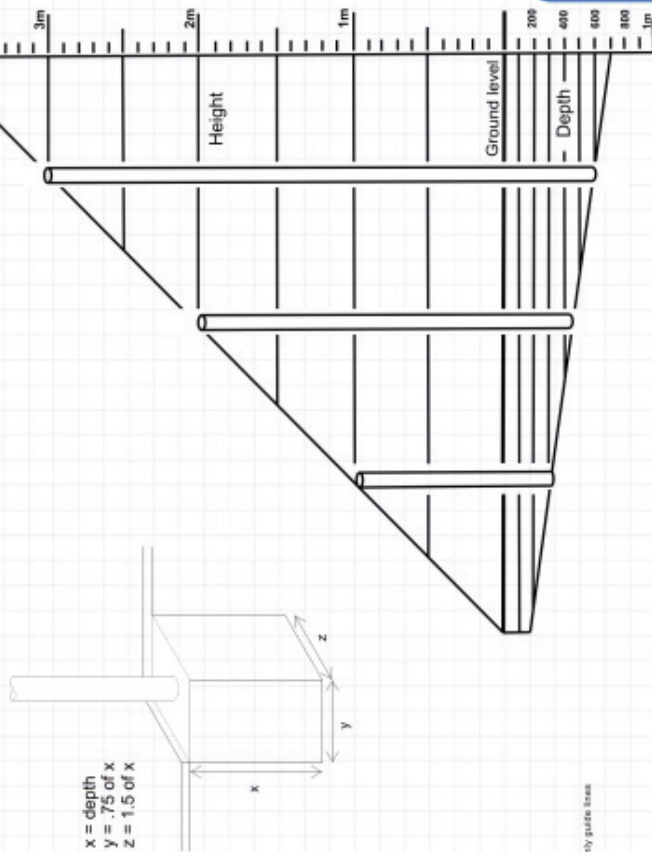

These are only guide lines

'D' CLIPS & STANDARD CLIPS

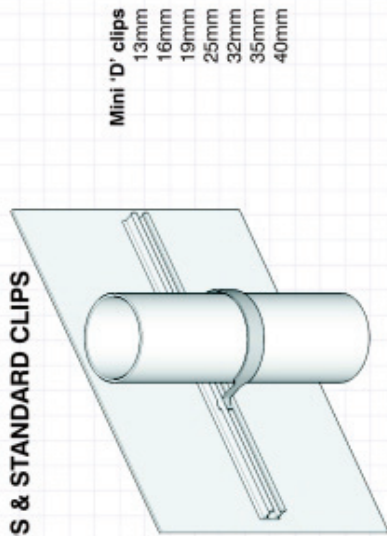

Mini 'D' clips
 13mm
 16mm
 19mm
 25mm
 32mm
 35mm
 40mm

'D' clips
 50mm
 60mm
 76mm
 89mm
 102mm
 114mm
 127mm
 140mm

2 bolt clips
 168mm
 194mm
 219mm
 244mm
 273mm

SCREW BANDING

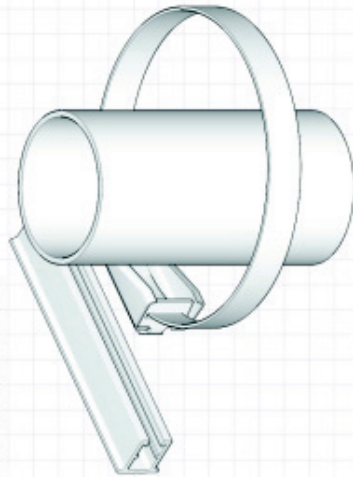

Comes in two sizes.
 Banding tools are also available
 24"
 36"

BACK TO BACK CLIPS

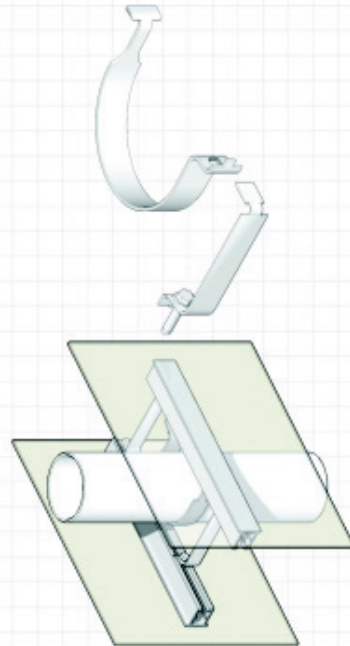

'D' clips
 50mm
 60mm
 76mm
 89mm
 102mm
 114mm
 127mm
 140mm

2 bolt clips
 168mm
 194mm
 219mm
 244mm
 273mm

ASHBY FINIALS

Available in a variety of designs and sizes.
 Powder coated to any standard RAL or BS colour.

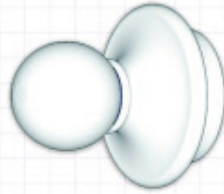

ROUND BALL (50mm)*

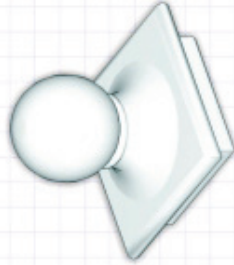

SQUARE BALL (50x50mm)*



DOME (76mm)

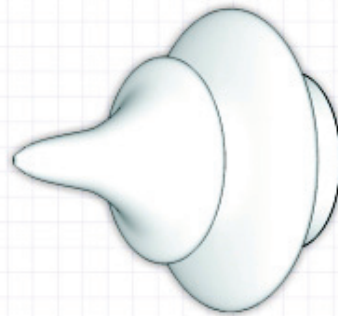

GOTHIC (76mm)

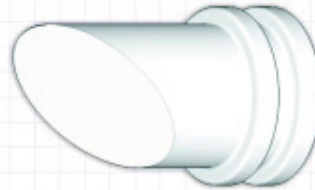

ALPINE (76mm)

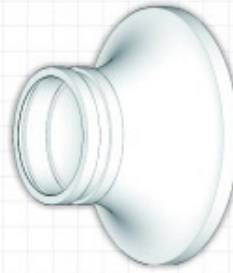

BASE EMBUSHER (76mm)



ROAD TRAFFIC BLANKS



Circles
300mm
450mm
600mm
750mm



Triangles
300mm
450mm
600mm
750mm

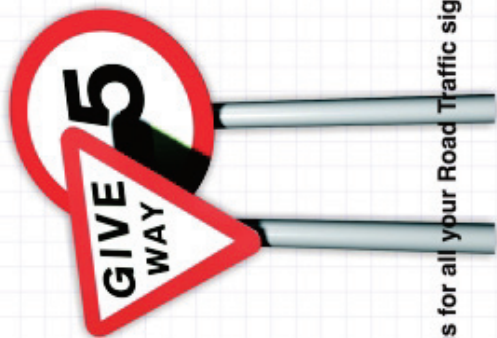

Call us for all your Road Traffic signage

We have the ability to manufacture any sign detailed in the Road Traffic and General Directions, in accordance with the Department of Transport. We can also manufacture non-standard Roadsigns that are not to be used on the Public Highways.

Ask your sign advisor if you have specific requirements.

COLOUR REFERENCES

Code	Colour description	RAL paint ref.	MACTAC vinyl ref.
AS01	LIGHT BLUE	5012	9839-10
AS02	MEDIUM BLUE	5005	9839-11
AS03	DARK BLUE	5002	9839-12
AS04	LIGHT GREEN	6029	9849-10
AS05	DARK GREEN	6005	9849-00
AS06	WHITE	9016	9829-00
AS07	BURGUNDY	3004	9859-05
AS08	RED	3020	9859-04

Other colours available on request.

ALUMINIUM SIGN POSTS

Mill finish, White and Grey in stock and available on next day delivery. Further information on Non-standard colours please call our sales team.

Base plates, Clips, Finales and more fixings for posts are available.

- A** Ellipse
50mm, 70mm, 80mm, 114mm & 140mm
- B** Round
500mm, 750mm & 1000mm
- C** Square
500mm, 750mm & 1000mm
- D** Square Modular
- E** Quadrant
- F** Cathedral
- G** Round Modular
- H** AS500
- I** AS760
- J** AS980

