

# North East Time Recorders Limited

## L100 Fingerprint Door Locks & Dead Locks -

- The new L100 Fingerprint Door Lock and L100-D Dead Lock are ideal for both home and office environments.
- Designed for internal use and ideal for server rooms, store rooms, finance offices, wine cellars or any other door you want to secure.
- Built around the latest Anviz fingerprint algorithm for unsurpassed reliability and fast recognition.
- Simple DIY installation, battery powered so no cabling required.
- Quick and easy to enroll new fingerprints, can be done within 5 seconds.
- Special temporary enrolment feature makes it extremely simple for visitor management.
- Built in RFID / proximity card reader provides greater convenience for the elder and young family members as well as office staff who have cards already.



The new L100 is a single latch door lock with fingerprint authentication technology. Authorised users can easily open the lock with the touch of a finger. This amazing product replaces keyed locking mechanisms with a fingerprint sensor which recognises who is allowed and not allowed to enter. Once your fingerprint is enrolled, all you will have to do is scan your fingerprint to gain access.

- Professional and elegant design, compact and stylish.
- Stores up to 100 fingerprints and RFID cards.
- Battery powered (4 x AA batteries) will last 5000 uses.
- Robust zinc alloy construction, secure and reliable.
- Anviz optical fingerprint reader - scratch-proof, unbreakable and durable.
- LED indicator and inbuilt musical buzzer.
- Identification method: fingerprint or RFID / Proximity card.
- Backup mechanical key for emergency open and external 9V battery for emergency use.
- Temporary user management for babysitters, cleaners and other visitors.
- Open door override can be set on the lock when needed during meetings etc.
- Mini USB port to download logs to a PC.
- 2 year warranty.

## Installation

- Reversible door handle (door lock version).
- Independent clutch motor design.
- Single latch for easy installation.
- Includes latch assembly and fittings.
- Battery powered (4 x AA).

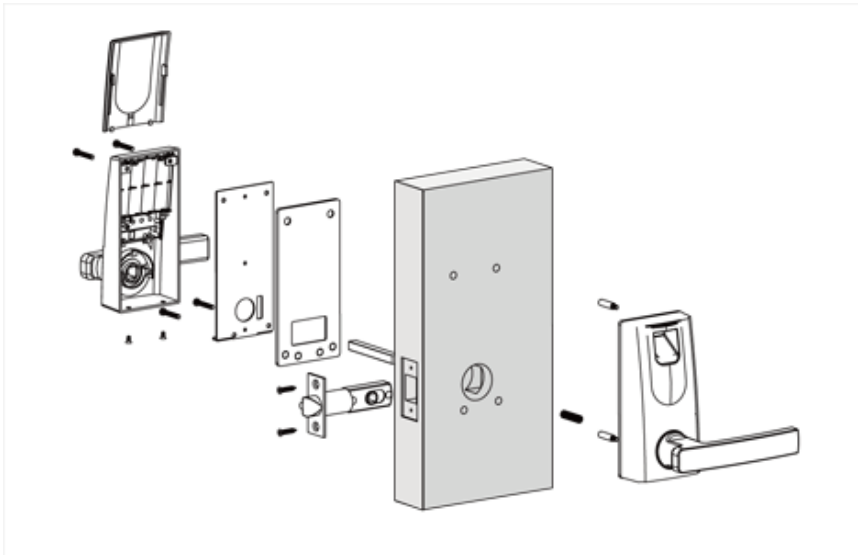

## What's in the box



- L100 Door Lock / L100-D Dead Lock (picture shows door lock)
- Door latch and fittings
- 4 x AA batteries
- 1 x 9V battery (emergency override)
- 3 override keys
- 2 RFID fobs
- Installation instructions

## Tech specs

Item	Description
Sensor	Anviz optical sensor
Identification Method	Fingerprint, Card
Identification Time	<1 second
Register Method	Fingerprint enroll (twice)
Fingerprint Capacity	100 FP, 100 Card
FRR / FAR	0.001% / 0.00001%
Power	DC 6V(1.5V*4)
Temperature / Humidity	-20°C to 60°C / 20% to 80%
Casing Material	strong zinc alloy
Size	70(w) x 150(h) x 80(d) mm