

STAUFF

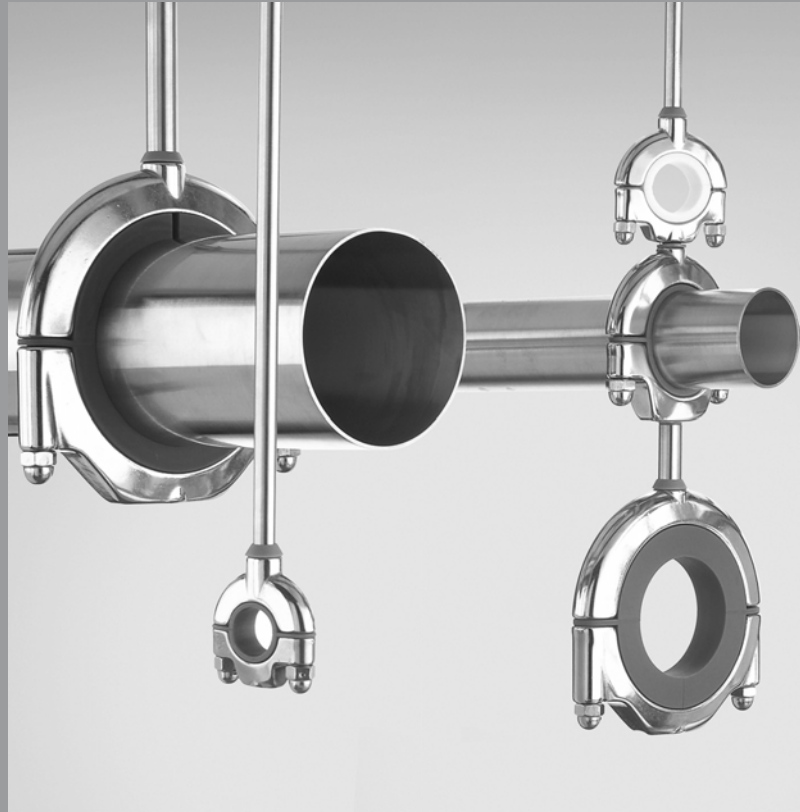

PROCESS PRODUCTS



Hi-Clean Stainless Steel Series

Patent Approved and ASME-BPE Compliant Design

Local solutions for
individual customers
worldwide

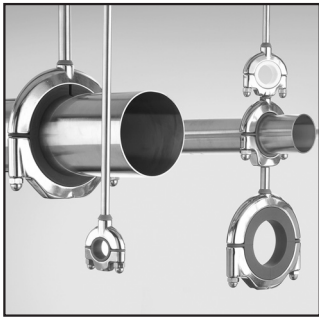

50 Years of Experience
Worldwide Distribution
Prompt Delivery

The STAUFF group of companies has a long track record of developing, manufacturing and marketing fluid technology related components for general plant and machine building and ranks amongst the world's leading companies, particularly in the field of industrial pipe, tube and hose clamps.

The extensive product range has now been extended with pipe and tube supports that have been designed specifically for use in industrial clean and ultra-clean rooms that require highest standards in terms of hygiene and design.

This Hi-Clean series is primarily used in the following industrie applications:

- Food Applications
- Industrial Clean Rooms
- Process Engineering
- Pharmaceutical Applications
- Chemical / Petrochemical Industry

Characteristics

- patent approved design
- all the components are designed to comply with the specifications and guidelines as defined by ASME-BPE, the *BioProcess Equipment Committee of the American Society of Mechanical Engineers*
- appropriately rounded-off edges and corners to prevent dirt adhesion, no exposed threads or threads covered with acorn nuts
- plastic components as defined with the specifications of the FDA, the *Food and Drug Administration*

General Informations / Terms of Liability

The outlined particulars are approximate values and are only valid as references, which are not binding, also with regard to possible protection of third parties, and they do not exempt you from your own examination of suitability of the products delivered by us. Therefore, these values can only be used in a limited sense for construction purposes. The application of the products is carried out outside our control possibilities and, therefore, is exclusively subject to your own area of responsibility. If, however, liability should be possible, it would be limited for all damages to the value of the goods supplied by us and in use by you. It goes without saying, that we guarantee the perfect quality of our products according to our general sales and delivery conditions.

Because of technical advances, dimensions subject to change without notification.
This catalog supercedes all previous catalogues.

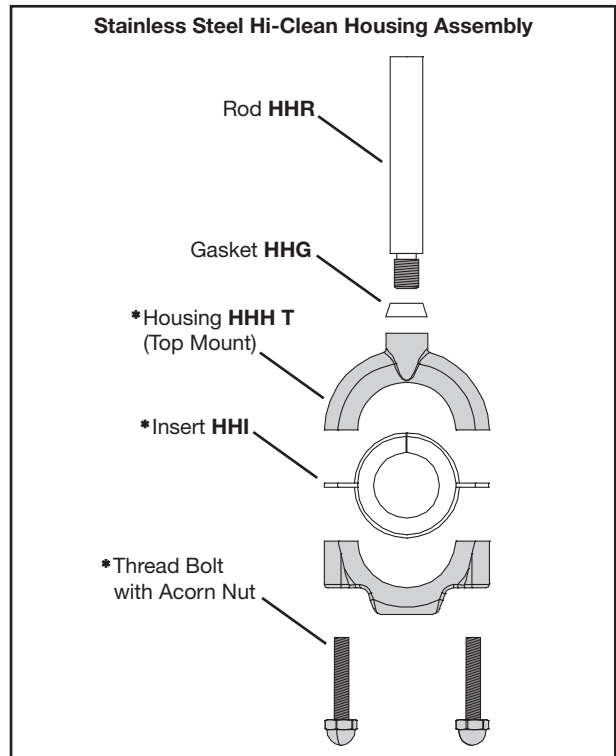

*belongs to the Scope of Delivery

Index

Hi-Clean Stainless Steel Series	Page
Profile / General Informations / Terms of Liability	2
Further STAUFF Process Products	3
Components - Order Codes	4
Components - Dimensions	5
Hi-Clean Accessories - Inserts	6
Complete Parts - Order Codes	7



PROCESS PRODUCTS

Pipe and Tube Supports for use with Process, Food and Pharmaceutical Applications

Hi-Clean Plastic Series

Characteristics

- Smooth Clamping Surface for Sanitary, Clean in Place (CIP) Installations
- Body Material
 - **Polypropylene (PP-Blue)**
 - **Santoprene (SA-Natural)**
- Support Hardware
- Material of metal parts
 - **304 Stainless Steel**
 - **316 Stainless Steel** (special order)
 - **Carbon Steel** (special order)
- Modular Design for Multiple Mounting Configurations
- Santoprene (SA) is FDA Approved



High Quality fittings for the use in the Process and Control Technology, Pharmaceutical, Chemical, Petrochemical Industry, Offshore and Marine, Power Generation and Shipbuilding

Twin Ferrule Compression Fittings

Characteristics

- Highest level of safety
- Low tightening torques
- Different sizes available (1/16" to 2")
- All fittings are available in inch or metric dimensions
- Material
 - **316 Stainless Steel**
- Effective metallic seal, ensuring total freedom from leaks for fluid and gaseous media in the vacuum and high-pressure sectors



Measuring systems for pressure monitoring of fluid and gaseous media; venting and sampling of fluid and gaseous pressure systems

Stainless Steel Test Coupling SKK

Characteristics

- Coupling at system pressure level
- Monitoring and control of pressure
- Maximum working pressure 630 bar
- Venting
- Sampling in high- and low-pressure systems
- Filling of accumulators (special filling-version)
- In case of ultimate tightness requirements for gaseous media, a special Gas-type is available
- Material of metal parts
 - **Stainless Steel**
- Material of seals
 - **NBR**
 - **FPM**
 - **EPDM**

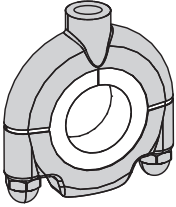
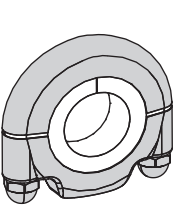
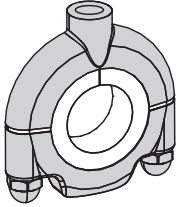
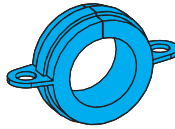
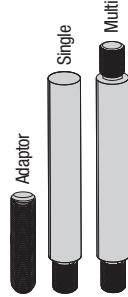

ASME-BPE compliant

Material			Hi-Clean Housing Stainless Steel Series HHH (including thread bolt and acorn nut)			Stainless Steel Series - Accessories	
Housing			Top Mount HHH T	Bottom Mount HHH B	Multiple-Run HHH M	Insert HHI	Rod HHR
Stainless Steel A2 -1.4308 (AISI 304) W4							
Stainless Steel A4 (standard) -1.4408 (AISI 316) W5							
Rod							
Stainless Steel A2 -1.4301 (AISI 304) W4							
Stainless Steel A4 (standard) -1.4571 (AISI 316) W5							
Inserts							
Material Shore-Hardness Code							
Silicon (blue) 70° Shore A SL							
Pipe Anchor PTFE (white) 50°-65° Shore D TF							
Pipe Guide							
Type of Thread							
Metric Thread Code M							
UNC Thread Code U							
ORDERING INFORMATION			HHH T ***	HHH B ***	HHH M ***	HHI ****	HHR * ** * ** *
STAUFF Group	Outside Diameter Pipe / Tube / Hose in mm	Outside Diameter Pipe / Tube / Hose in inch	STAUFF Group Type of Thread Material	STAUFF Group Type of Thread Material	STAUFF Group Type of Thread Material	STAUFF Group Outside Diameters in mm Material	Type of Rod STAUFF Group / Multi Length in mm Type of Thread Material
1	6,4	1/4	HHH T 1 ***	HHH B 1 ***	HHH M 1 ***	HHI 106,4 ****	HHR * 1-3 **** *
	9,5	3/8				HHI 109,5 ****	
	12					HHI 112 ****	
	12,7	1/2				HHI 112,7 ****	
	15,9	5/8				HHI 115,9 ****	
	17,3					HHI 117,3 ****	
	19	3/4				HHI 119 ****	
	21,3					HHI 121,3 ****	
22,2	7/8				HHI 122,2 ****		
2	25,4	1	HHH T 2 ***	HHH B 2 ***	HHH M 2 ***	HHI 225,4 ****	
	26,7					HHI 226,7 ****	
	28,6	1 1/8				HHI 228,6 ****	
	31,8	1 1/4				HHI 231,8 ****	
	33,7					HHI 233,7 ****	
	34,9	1 3/8				HHI 234,9 ****	
3	38,1	1 1/2	HHH T 3 ***	HHH B 3 ***	HHH M 3 ***	HHI 338,1 ****	
	41,3	1 5/8				HHI 341,3 ****	
	42,2	1 2/3				HHI 342,2 ****	
	48,3					HHI 348,3 ****	
	50,8	2				HHI 350,8 ****	
	54*1	2 1/8				*1 HHI 354 ****	
4	60,3	2 3/8	HHH T 4 ***	HHH B 4 ***	HHH M 4 ***	HHI 460,3 ****	
	63,5	2 1/2				HHI 463,5 ****	
	66,7					HHI 466,7 ****	
	73,2					HHI 473,2 ****	
	76,1	3				HHI 476,1 ****	
	79,4	3 1/8				HHI 479,4 ****	
	88,9	3 1/2				HHI 488,9 ****	
	101,6	4				HHI 5101,6 ****	
104,8		HHI 5104,8 ****					
114,3	4 1/2	HHI 5114,3 ****					
6	152,4	6	HHH T 6 ***	HHH B 6 ***	HHH M 6 ***	HHI 6152,4 ****	
	168,4					HHI 6168,4 ****	

*1 To retain the material thickness of the insert, the next bigger clamp housing size is to be selected when a PTFE insert is used.

ASME-BPE compliant

Hi-Clean Housing Stainless Steel Series HHH																				Stainless Steel Series - Accessories														
Top Mount HHH T								Bottom Mount HHH B								Multiple-Run HHH M								Insert HHI		Rod HHR Single Multi								
HHH T **** *								HHH B **** *								HHH M **** *								HHI **** *		HHR * ** * ** * *								
Insert		L	H	S	H	H1	H2	Width	G	Insert		L	H	S	H	H1	H2	Width	G	Insert		L	H	S	H	H1	H2	Width	G	Ø in mm	Ø in inch	Length * ₂	Thread	
Pipe Anchor	Pipe Guide									Pipe Anchor	Pipe Guide									Pipe Anchor	Pipe Guide													
		51,3	55,7	1,6	54,1	23,1	31	16	3/8"-16 M10			51,3	49,6	1,6	48	23,1	24,9	16	3/8"-16 M10			51,3	55,7	1,6	54,1	23,1	31	16	3/8"-16 M10	6,4	1/4	000 = Adaptor 006 = 152mm 012 = 305mm 024 = 610mm	3/8"-16 M10	
																															9,5			3/8
																															12			
																															12,7			1/2
																															15,9			5/8
																															17,3			
																															19			3/4
																															21,3			
																															22,2			7/8
																															25,4			1
																															26,7			
																															28,6	1 1/8		
																															31,8	1 1/4		
																															33,7			
																															34,9	1 3/8		
																															38,1	1 1/2		
																															41,3	1 5/8		
																															42,2	1 2/3		
																															48,3			
																															50,8	2		
																															54	2 1/8		
																															60,3	2 3/8		
																															63,5	2 1/2		
																															66,7			
																															73,2			
																															76,1	3		
																															79,4	3 1/8		
																															88,9	3 1/2		
																															101,6	4		
																															104,8			
																															114,3	4 1/2		
																															152,4	6		
																															168,4			

All Dimensions in mm.

*₂ When ordering a stacking adaptor (direct mounting of two housings on each other), please indicate "000" as length.

Ordering example: "HHR M * ** * 000 * **"

The following inserts are recommended to be used depending on the selected tube type listed.

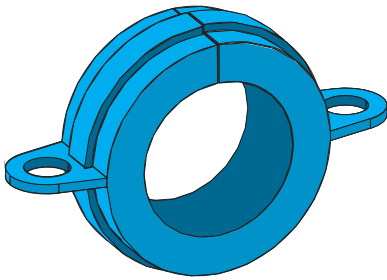

Pipe Anchor (Silicon, blue)

Nominal Size		Tube OD	Copper Tube OD	Pipe OD	DIN 11850 Tubes for the food, chemical and pharmaceutical industry Stainless Steel tubes	ISO 4200 Plain and steel tubes, welded and seamless
Inch	Metr.					
1/4	8	HHI-106,4-SL	HHI-109,5-SL	HHI-112,7-SL	HHI-109,5-SL	HHI-112,7-SL
3/8	10	HHI-109,5-SL	HHI-112,7-SL	HHI-117,3-SL	HHI-112-SL	HHI-117,3-SL
1/2	15	HHI-112,7-SL	HHI-115,9-SL	HHI-121,3-SL	HHI-119-SL	HHI-121,3-SL
3/4	20	HHI-119-SL	HHI-122,2-SL	HHI-226,7-SL	HHI-122,2-SL	HHI-226,7-SL
1	25	HHI-225,4-SL	HHI-228,6-SL	HHI-233,7-SL	HHI-228,6-SL	HHI-233,7-SL
1 1/4	32	HHI-231,8-SL	HHI-234,9-SL	HHI-342,2-SL	HHI-234,9-SL	HHI-342,2-SL
1 1/2	40	HHI-338,1-SL	HHI-341,3-SL	HHI-348,3-SL	HHI-341,3-SL	HHI-348,3-SL
2	50	HHI-350,8-SL	HHI-354-SL	HHI-460,3-SL	HHI-354-SL	HHI-460,3-SL
2 1/2	65	HHI-463,5-SL	HHI-466,7-SL	HHI-473,2-SL		HHI-476,1-SL
3	80	HHI-476,1-SL	HHI-479,4-SL	HHI-488,9-SL		HHI-488,9-SL
4	100	HHI-5101,6-SL	HHI-5104,8-SL	HHI-5114,3-SL	HHI-5104,8-SL	HHI-5114,3-SL
6	150	HHI-6152,4-SL		HHI-6168,4-SL	HHI-6152,4-SL	HHI-6152,4-SL

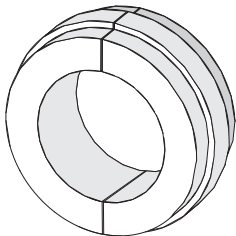

Pipe Guide (PTFE, white)

Nominal Size		Tube OD	Copper Tube OD	Pipe OD	DIN 11850 Tubes for the food, chemical and pharmaceutical industry Stainless Steel tubes	ISO 4200 Plain and steel tubes, welded and seamless
Inch	Metr.					
1/2	15	HHI-112,7-TF	HHI-115,9-TF	HHI-121,3-TF	HHI-119-TF	HHI-121,3-TF
3/4	20	HHI-119-TF	HHI-122,2-TF	HHI-226,7-TF		
1	25	HHI-225,4-TF	HHI-228,6-TF	HHI-233,7-TF		
1 1/4	32	HHI-231,8-TF		HHI-342,2-TF		
1 1/2	40	HHI-338,1-TF		HHI-348,3-TF		HHI-348,3-TF
2	50	HHI-350,8-TF	HHI-454-TF *	HHI-460,3-TF	HHI-454-TF	HHI-460,3-TF
2 1/2	65	HHI-463,5-TF	HHI-466,7-TF	HHI-473,2-TF		HHI-476,1-TF
3	80	HHI-476,1-TF	HHI-479,4-TF	HHI-488,9-TF		HHI-488,9-TF
4	100	HHI-5101,6-TF	HHI-5104,8-TF	HHI-5114,3-TF	HHI-5104,8-TF	HHI-5114,3-TF
6	150	HHI-6152,4-TF	HHI-6155,6-TF	HHI-6168,4-TF		

Other sizes are available on request.

* To retain the material thickness of the insert, the next bigger clamp housing size is to be selected when a PTFE insert is used.

ASME-BPE compliant

Hi-Clean Housing - Stainless Steel Series

① HHH ② * ③ ***,* ④ ** ⑤ * ⑥ W* ⑦ **

①	② TYPE OF INSTALLATION	③ STAUFF GROUP & HOUSING SIZE	④ MATERIAL OF INSERT	⑤ TYPE OF THREAD	⑥ MATERIAL OF METAL PARTS	⑦ ASSEMBLING & PACKAGING																					
HHH Hi-Clean Housing	T Top Mount B Bottom Mount M Multiple-Run	<table border="1"> <thead> <tr> <th>STAUFF Group</th> <th>Tube O.D. in mm</th> <th>Material Code Housing</th> </tr> </thead> <tbody> <tr> <td>1</td> <td>6,4 9,5</td> <td>106,4 109,5</td> </tr> <tr> <td>2</td> <td>...</td> <td>...</td> </tr> <tr> <td>3</td> <td>48,3</td> <td>348,3</td> </tr> <tr> <td>4</td> <td>...</td> <td>...</td> </tr> <tr> <td>5</td> <td>...</td> <td>...</td> </tr> <tr> <td>6</td> <td>...</td> <td>...</td> </tr> </tbody> </table>	STAUFF Group	Tube O.D. in mm	Material Code Housing	1	6,4 9,5	106,4 109,5	2	3	48,3	348,3	4	5	6	SL Silicon (Pipe Anchor) TF PTFE (Pipe Guide)	M Metric Thread U UNC Thread	W4 1.4308 (AISI 304) W5 1.4408 (AISI 316)	#A assembled / supplied separately #V24 Packaging Unit 24 Pieces (Gr. 1-2) #V12 Packaging Unit 12 Pieces (Gr. 3) #V6 Packaging Unit 6 Pieces (Gr. 4-5) #V1 Packaging Unit 1 Piece (Gr. 6)
STAUFF Group	Tube O.D. in mm	Material Code Housing																									
1	6,4 9,5	106,4 109,5																									
2																									
3	48,3	348,3																									
4																									
5																									
6																									

Ordering example: HHH T 106,4 SL U W5#A

Hi-Clean Rod HHR

① HHR ② * ③ ***/** ④ **** ⑤ * ⑥ **

①	② TYPE OF ROD	③ STAUFF GROUP SINGLE	④ LENGTH OF ROD	⑤ TYPE OF THREAD	⑥ MATERIAL OF METAL PARTS										
HHR Hi-Clean Rod	S Single M Multi	<table border="1"> <tr><td>1-3</td></tr> <tr><td>4</td></tr> <tr><td>5</td></tr> <tr><td>6</td></tr> </table>	1-3	4	5	6	000 Adaptor 006 152 mm 012 305 mm 024 610 mm	M Metric Thread U UNC Thread	W4 1.4301 (AISI 304) W5 1.4571 (AISI 316)						
1-3															
4															
5															
6															
		③ STAUFF GROUP MULTI													
		<table border="1"> <thead> <tr> <th>1. Housing Size</th> <th>2. Housing Size</th> </tr> </thead> <tbody> <tr><td>1-3</td><td>1-3</td></tr> <tr><td>4</td><td>4</td></tr> <tr><td>5</td><td>5</td></tr> <tr><td>6</td><td>6</td></tr> </tbody> </table>	1. Housing Size	2. Housing Size	1-3	1-3	4	4	5	5	6	6			
1. Housing Size	2. Housing Size														
1-3	1-3														
4	4														
5	5														
6	6														

Ordering example - Rod: HHR S 1-3 006 U W5
Ordering example - Adaptor: HHR M 1-3 000 U W5

Hi-Clean Insert HHI

① HHI ② *** ③ **

①	③ STAUFF GROUP & HOUSING SIZE	④ MATERIAL OF INSERT																					
HHI Hi-Clean Insert	<table border="1"> <thead> <tr> <th>STAUFF Group</th> <th>Tube O.D. in mm</th> <th>Material Code Housing</th> </tr> </thead> <tbody> <tr> <td>1</td> <td>6,4 9,5</td> <td>106,4 109,5</td> </tr> <tr> <td>2</td> <td>...</td> <td>...</td> </tr> <tr> <td>3</td> <td>48,3</td> <td>348,3</td> </tr> <tr> <td>4</td> <td>...</td> <td>...</td> </tr> <tr> <td>5</td> <td>...</td> <td>...</td> </tr> <tr> <td>6</td> <td>...</td> <td>...</td> </tr> </tbody> </table>	STAUFF Group	Tube O.D. in mm	Material Code Housing	1	6,4 9,5	106,4 109,5	2	3	48,3	348,3	4	5	6	SL Silicon (Pipe Anchor) TF PTFE (Pipe Guide)
STAUFF Group	Tube O.D. in mm	Material Code Housing																					
1	6,4 9,5	106,4 109,5																					
2																					
3	48,3	348,3																					
4																					
5																					
6																					

Ordering example: HHI 106,4 SL

Hi-Clean Gasket HHG

① HHG ② *** ③ **

①	③ STAUFF GROUP ROD	④ MATERIAL OF GASKET					
HHG Hi-Clean Gasket Suitable for Hi-Clean Rod	<table border="1"> <tr><th>STAUFF Group</th></tr> <tr><td>1-3</td></tr> <tr><td>4</td></tr> <tr><td>5</td></tr> <tr><td>6</td></tr> </table>	STAUFF Group	1-3	4	5	6	SL Silicon
STAUFF Group							
1-3							
4							
5							
6							

Ordering example: HHG 1-3 SL

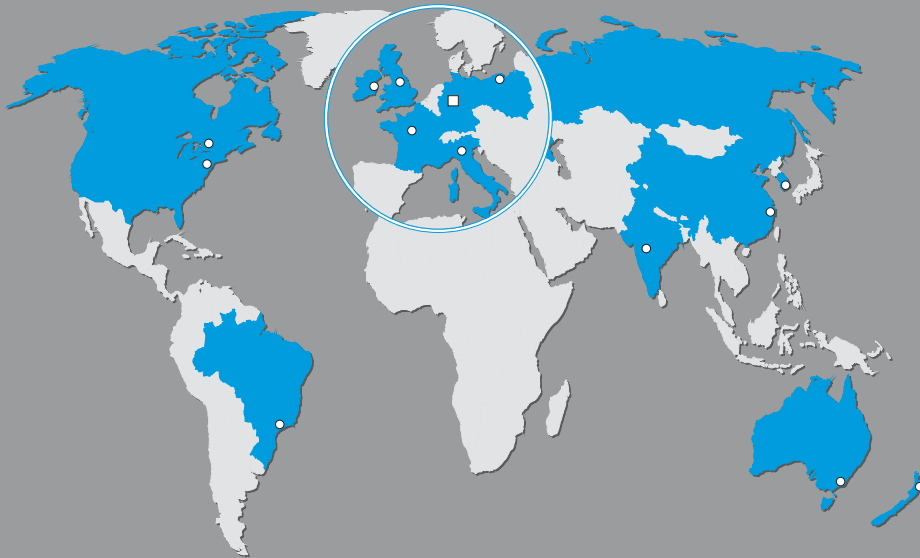

AUSTRALIA

STAUFF Corporation Pty. Ltd.
P. O. Box 227
Unanderra, NSW, 2526
24-26 Doyle Avenue
Unanderra, Wollongong, NSW, 2526
Tel.: +61 2 4271 18 77
Fax: +61 2 4271 84 32
sales@stauff.com.au

INDIA

STAUFF India Pvt. Ltd.
Gat. No. 2340
Pune Nagar Road, Wagholi
Pune, 412207
Tel.: +91 20 6620 2473
Fax: +91 20 2705 1567
sales@stauffindia.com

POLAND

STAUFF Polska Sp. z o.o.
Miszewko 43 A
80-297 Banino
Tel.: +48 58 660 11 60
Fax: +48 58 629 79 52
sales@stauff.pl

BRAZIL

STAUFF Brasil Ltda.
Avenida Gupê 10767
Galpão 2 - Bloco A
Barueri - São Paulo
CEP 06422-120
Tel.: +55 11 47 72 72 00
Fax: +55 11 47 72 72 10
stauff@stauffbrasil.com

ITALY

STAUFF Italia s.r.l.
Viale Nuova Valassina 78
angolo Via Baragiola sn
20033 Desio (MI)
Tel.: +39 0362 63 80 70
Fax: +39 0362 63 80 69
sales@stauff.it

RUSSIAN FEDERATION

STAUFF LLC
Office 205, Building 7
Scharikopodschipnikovskaya 11
Moscow, 115088
Tel.: +7 495 987 36 29
+7 495 223 89 61
Fax: +7 495 679 90 48
sales@stauff.ru

CANADA

STAUFF Canada Ltd.
866 Milner Avenue
Scarborough
Ontario M1B 5N7
Tel.: +1 416 282 46 08
Fax: +1 416 282 30 39
sales@stauffcanada.com

IRELAND

STAUFF Ireland Ltd.
Unit B3
Weatherwell Business Park
Clondalkin
Dublin 22
Tel.: +353 1457 4936
Fax: +353 1467 0687
sales@stauff.ie

UNITED KINGDOM

STAUFF UK
Unit B3
500, Carlisle Street East
Off Downgate Drive
Sheffield, S4 8BS
Tel.: +44 114 251 85 18
Fax: +44 114 251 85 19
sales@stauff.co.uk

CHINA

STAUFF International Trading
(Shanghai) Co., Ltd.
No. 41-42, Lane 369, Chuang Ye Road
Jushuo Industrial Zone, Kang Qiao
Shanghai, 201319
Tel.: +86 21 68 18 70 00
Fax: +86 21 68 18 71 36
info@stauff.com.cn

KOREA

STAUFF Korea Ltd.
1500-12, Dadae-Dong
Saha-Ku
Pusan, 604-826
Tel.: +82 51 266 6666
Fax.: +82 51 266 8866
info@stauff.co.kr

UNITED STATES

STAUFF Corporation
7 Wm. Demarest Place
Waldwick, 07463-1542
New Jersey
Tel.: +1 201 444 78 00
Fax: +1 201 444 78 52
sales@stauffusa.com

FRANCE

STAUFF S.A.S.
230, Avenue du Grain d'Or
Z.I. de Vineuil - Blois Sud
41354 Vineuil-cedex
Tel.: +33 2 54 50 55 50
Fax: +33 2 54 42 29 19
direction@stauffsa.com

NEW ZEALAND

STAUFF Corporation (NZ) Ltd.
P. O. Box 58517
Greenmount, Auckland
Unit D, 103 Harris Road
East Tamaki, Auckland
Tel.: +64 9 271 48 12
Fax: +64 9 271 48 32
info@stauff.co.nz

Globally available through wholly-owned branches and distributors in all industrial countries.

GERMANY

WALTER STAUFFENBERG GmbH & Co. KG

P.O.Box 1745
D-58777 Werdohl
Im Ehrenfeld 4
D-58791 Werdohl
Tel.: +49 23 92 916-0
Fax: +49 23 92 2505
sales@stauff.com
www.stauff.com

