

STAUFF CLAMPS

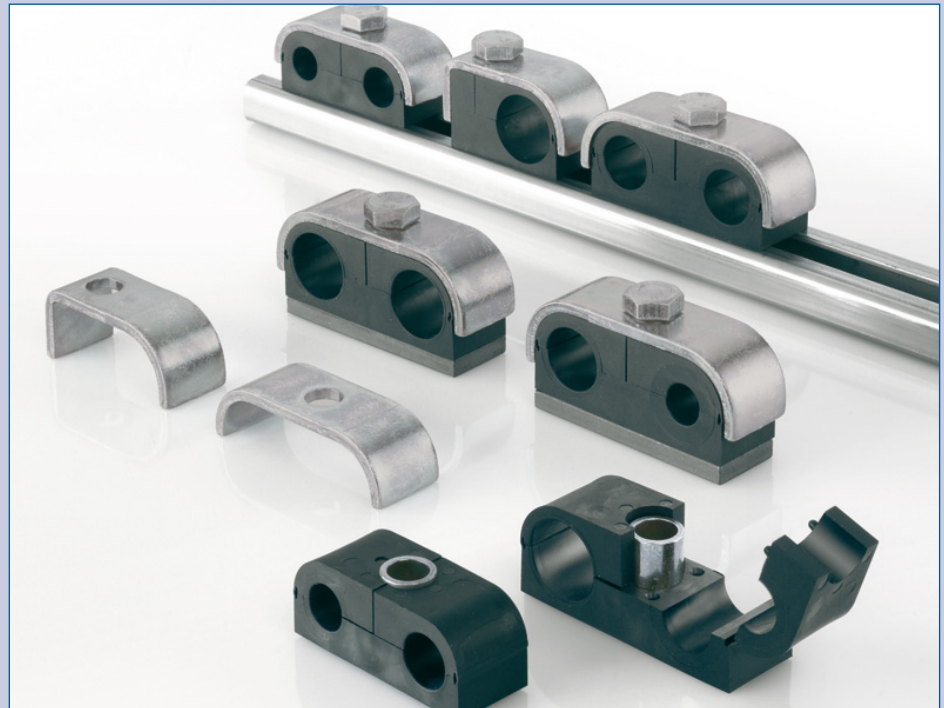

**LBBU Multi Purpose
single and twin medium weight clamps**

Stauff Anglia Limited

405 Coppersmith Way | Wymondham | Norfolk NR18 0WY

T: 01953 857158 F: 01953 857159 E: Sales@stauffanglia.co.uk

www.stauffanglia.co.uk

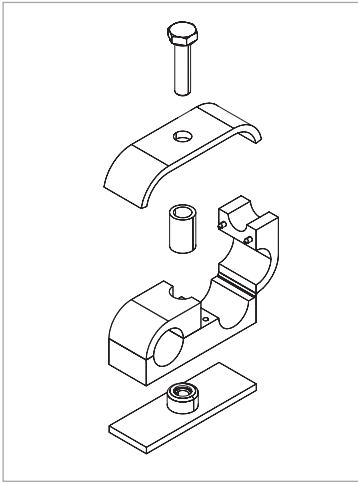

FEATURES

- compact design
- quick and easy installation
- vibration and noise reducing
- UV, ozone and weathering resistant

MATERIALS AND SURFACES

- **Clamp Body:** thermoplastic elastomer (87 Shore-A)
- **Weld Plate:** steel, phosphated (W2)
- **Hexagon Rail:** steel, untreated (W1)
- **Cover Plate and Accessories:** steel, zinc/nickel coated* (W3)
- Further materials and surface finishings are available upon request.

TYPES

- **STAUFF Group 1 and Group 2:** single-line clamps
- **STAUFF Group 1D and Group 2D:** double-line clamps with identical diameters, also available with different diameters (upon request)

APPLICATIONS

- perfect for the vibration and noise reducing installation of pipes, tubes, hoses and cables for applications in which space is limited (Hydraulics and Pneumatics, Mechanical and Plant Engineering, Instrumentation)

Clamp Body
Groups 1 and 2

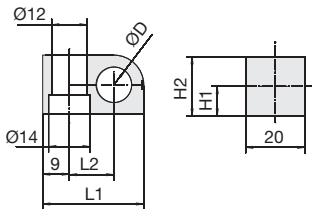

Clamp Body
Groups 1D and 2D

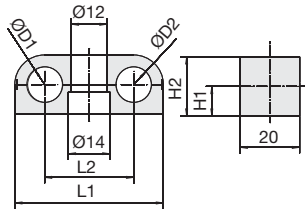

Weld Plate LBBU-SP
Groups 1 and 2

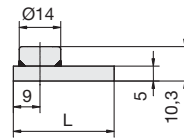

Cover Plate LBBU-DP
Groups 1 and 2

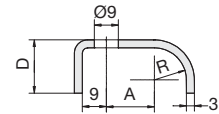

Weld Plate LBBU-SP
Groups 1D and 2D

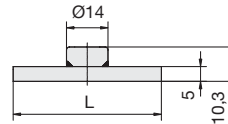

Cover Plate LBBU-DP
Groups 1D and 2D

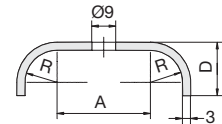

MATERIALS & SURFACES (Delivery Standard)		Clamp Body with Film Hinge				Weld Plate LBBU-SP			Cover Plate LBBU-DP			
		SA 87 Shore-A				W2 steel, phosphated			W3 steel, zinc/nickel coated*			
STAUFF Group	diameter ØD1 / ØD2 in mm (inch)	L1	L2	H1	H2	Thread	L	Width	A	R	D	Width
1	6 - 6,4 (1/4) - 8 (5/16) 9,5 (3/8) - 10 - 11 12 - 12,7	34	15	10	20	M8 (UNC 5/16"-18 on request)	34	20	15	10	16	20
2	4 - 6 - 6,4 (1/4) 8 (5/16) - 9,5 (3/8) - 10 11 - 12 - 12,7 (1/2) 13,5 - 14 - 15 16 (5/8) - 17,2 - 18 19 (3/4) - 20	39	18	12	24	M8 (UNC 5/16"-18 on request)	39	20	18	12	20	20
1D	4 - 6 - 6,4 (1/4) 8 (5/16) - 9,5 (3/8) - 10 11 - 12 - 12,7 (1/2)	50	30	10	20	M8 (UNC 5/16"-18 on request)	50	20	30	10	16	20
2D	8 (5/16) - 9,5 (3/8) - 10 12 - 12,7 (1/2) - 13,5 14 - 15 - 16 (5/8) 17,2 - 18	59	35	12	24	M8 (UNC 5/16"-18 on request)	59	20	35	12	20	20

All dimensions in mm. Further diameters are available upon request.

TYPE OF MOUNTING SP with Weld Plate LBBU-SP

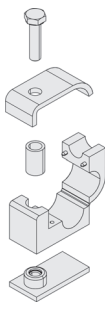

Ordering Codes for Clamp Combinations

- example for STAUFF Group 2:
LBBU SP 216 SA-DP-AS M8 W10
- example for STAUFF Group 2D:
LBBU SP 216/16 SA-DP-AS M8 W10

consisting of:
Hexagon Head Bolt AS
Cover Plate LBBU-DP
Sleeve LBBU-HUE
Clamp Body LBBU
Weld Plate LBBU-SP

TYPE OF MOUNTING SM with Hexagon Rail Nut SM

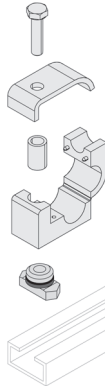

Ordering Codes for Clamp Combinations

- example for STAUFF Group 2:
LBBU SM 216 SA-DP-AS M8 W3
- example for STAUFF Group 2D:
LBBU SM 216/16 SA-DP-AS M8 W3

consisting of:
Hexagon Head Bolt AS
Cover Plate LBBU-DP
Sleeve LBBU-HUE
Clamp Body LBBU
Hexagon Rail Nut SM

Mounting Rail to be ordered separately.

TYPE OF MOUNTING PM for Panel Mounting**

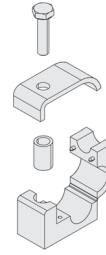

Ordering Codes for Clamp Combinations

- example for STAUFF Group 2:
LBBU PM 216 SA-DP-AS M8 W3
- example for STAUFF Group 2D:
LBBU PM 216/16 SA-DP-AS M8 W3

consisting of:
Hexagon Head Bolt AS
Cover Plate LBBU-DP
Sleeve LBBU-HUE
Clamp Body LBBU

without Weld Plate
without Hexagon Rail Nut

Sleeve LBBU-HUE

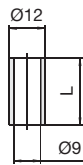

Hexagon Head Bolt AS

DIN EN 4014/4017 (DIN 931/933)

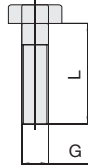

Hexagon Rail Nut SM

identical to Twin Series Hexagon Rail Nut SM 2-5D according to DIN 3015, Part 3

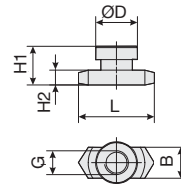

Mounting Rail TS

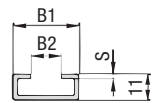

TS 11

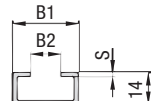

TS 14

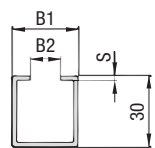

TS 30

Sleeve LBBU-HUE		Hexagon Head Bolt AS		Hexagon Rail Nut SM					Mounting Rail TS						
W3 steel, zinc/nickel coated*		W3 steel, zinc/nickel coated*		W3 steel, zinc/nickel coated*					W1 steel, untreated						
L		G x L		L	B	H1	H2	ØD	G	Nominal Size	B1	B2	S		
Type of Mounting SP 13,5	Type of Mounting SM 12,8	Type of Mounting PM 18,8	Type of Mounting SP M8 x 25 (UNC 5/16"-18x1" on request)	Type of Mounting SM M8 x 25 (UNC 5/16"-18x1" on request)	Type of Mounting PM** M8 x 30 (UNC 5/16"-18x1"1/4 on request)										
Type of Mounting SP 17,5	Type of Mounting SM 16,8	Type of Mounting PM 22,7	Type of Mounting SP M8 x 28 (UNC 5/16"-18x1"1/8 on request)	Type of Mounting SM M8 x 28 (UNC 5/16"-18x1"1/8 on request)	Type of Mounting PM** M8 x 35 (UNC 5/16"-18x1"3/8 on request)	25,5	10,4	13	5	14	M8	TS 11 TS 14 TS 30	28	11	2
Type of Mounting SP 13,5	Type of Mounting SM 12,8	Type of Mounting PM 18,8	Type of Mounting SP M8 x 25 (UNC 5/16"-18x1" on request)	Type of Mounting SM M8 x 25 (UNC 5/16"-18x1" on request)	Type of Mounting PM** M8 x 30 (UNC 5/16"-18x1"1/4 on request)										
Type of Mounting SP 17,5	Type of Mounting SM 16,8	Type of Mounting PM 22,7	Type of Mounting SP M8 x 28 (UNC 5/16"-18x1"1/8 on request)	Type of Mounting SM M8 x 28 (UNC 5/16"-18x1"1/8 on request)	Type of Mounting PM** M8 x 35 (UNC 5/16"-18x1"3/8 on request)										

All dimensions in mm. Further diameters are available upon request.

** Note: PM bolt lengths designed for a substructure integrated thread.

Ordering Codes

Clamp Body **LBBU 2 15/15 SA M8**

↓
Clamp Body LBBU
↓
STAUFF Group
↓
Diameter ØD in mm
↓
Material
↓
Through Hole for Bolts M8

Weld Plate **LBBU-SP 2D M8 W2**

↓
Weld Plate LBBU-SP
↓
STAUFF Group
↓
Thread Type (M8)
↓
Material & Surface

Cover Plate **LBBU-DP 2D M8 W3**

↓
Cover Plate LBBU-DP
↓
STAUFF Group
↓
Through Hole for Bolts M8
↓
Material & Surface

Sleeve **LBBU-HUE 2/2D SP M8 W3**

↓
Sleeve LBBU-HUE
↓
STAUFF Group
↓
Type of Mounting (SP, SM or PM)
↓
Through Hole for Bolts M8
↓
Material & Surface

Hexagon Head Bolt **AS M8x28 W3**

↓
Hexagon Head Bolt AS
↓
Bolt Dimensions G x L
↓
Material & Surface

Hexagon Rail Nut **SM 2-5D M W3**

↓
Hexagon Rail Nut SM
↓
Thread Type (M8)
↓
Material & Surface

Mounting Rail **TS 11 - 1 W1**

↓
Mounting Rail TS
↓
Height in mm
↓
Length in m (1m or 2m)
↓
Material & Surface

MATERIAL - CLAMP BODY

SA thermoplastic elastomer (87 Shore-A)

MATERIALS & SURFACES - METAL PARTS

W1 steel, untreated

W2 steel, phosphated

W3 steel, zinc/nickel coated*

THREADS AND THROUGH HOLES

M8 Metric Thread M8
for parts without thread: through hole suitable for M8

U5/16 UNC Thread 5/16"-18 (on request)
for parts without thread: through hole suitable for 5/16"-18 UNC