

technical characteristics

	CSP Plastics	CSM Metals
Table area	345 x 300 mm	345 x 300 mm
Materials recommended	Plastics (ABS, PS, PVC,...)	Metals (Aluminium, brass,...)
Maximum thickness	2.4 mm max.	1 mm max. 2 mm max.
Maximum width	320 mm	320 mm 155 mm
Outside stop	200 mm max.	200 mm max.
Inside stop	250 mm max.	250 mm max.
Dimensions	530 x 380 x 240 mm	530 x 380 x 240 mm
Net weight	11 kg	11 kg

CSC For corners

Thick rigid, warp-proof profiled aluminium table with coated surface for resistance against wear.

Maximum thickness	
Aluminium	0.8 mm
Brass	0.8 mm
Plastics (ABS - PVC - PS type)	3 mm
Blades	machined, ground and coated
Dimensions	240 x 150 x 120 mm
Table thickness	9.5 mm
Net weight	1.5 kg

Gravograph endeavours to offer the highest technology available at all times. This information is therefore not contractually binding and may be modified without prior notice.

CSP CSM CSC



table shears for engraving materials

CSP CSM

- Perfect manageability.
- Total safety provided by a fixed gear case and guard.
- Optimised precision :
 - Outside millimetre scale stop: 200 mm max.,
 - Inside millimetre scale stop : 250 mm max.,
 - Stop for angle cutting with graduated protractor (from 0 to 90°).
- Cutting forces reduction by stops tranference.
- Dimensions : 530 x 380 x 240 mm.

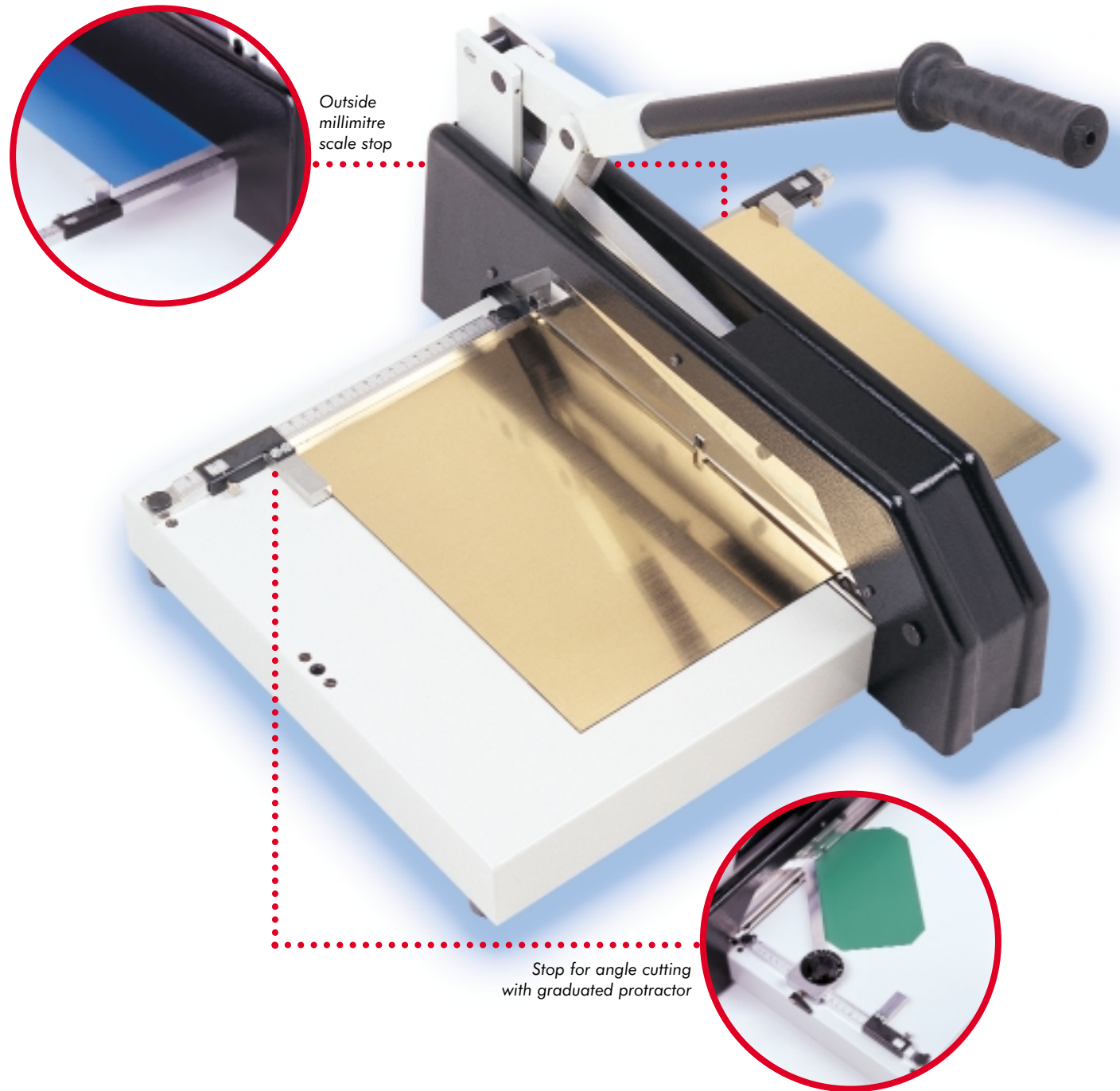

CSC

- A practical, compact and easy to use tool.
- 13 blade profiles to achieve different shapes on all types of materials (plastics, aluminium, brass).
- Dimensions : 240 x 150 x 120 mm.

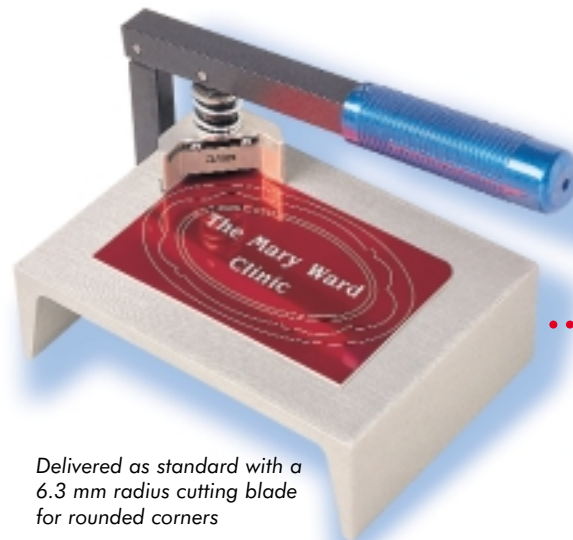

Delivered as standard with a 6.3 mm radius cutting blade for rounded corners

Blade profiles available

Dimensions : +/- 0.2 mm tolerance

Blade N°1	Blade N°5	Blade N°8	Blade N°11
Blade N°3	Blade N°6	Blade N°9	Blade N°12
Blade N°4	Blade N°7	Blade N°10	Blade N°13